



# INDIANA AVENUE FROM MYERS ST TO HARRISON ST REMOVAL OF SEGMENT OF NO PARKING ANY TIME ZONE

-  Proposed Removal of Segment of No Parking Any Time Zone
-  No Parking Any Time Zone To Remain In Effect

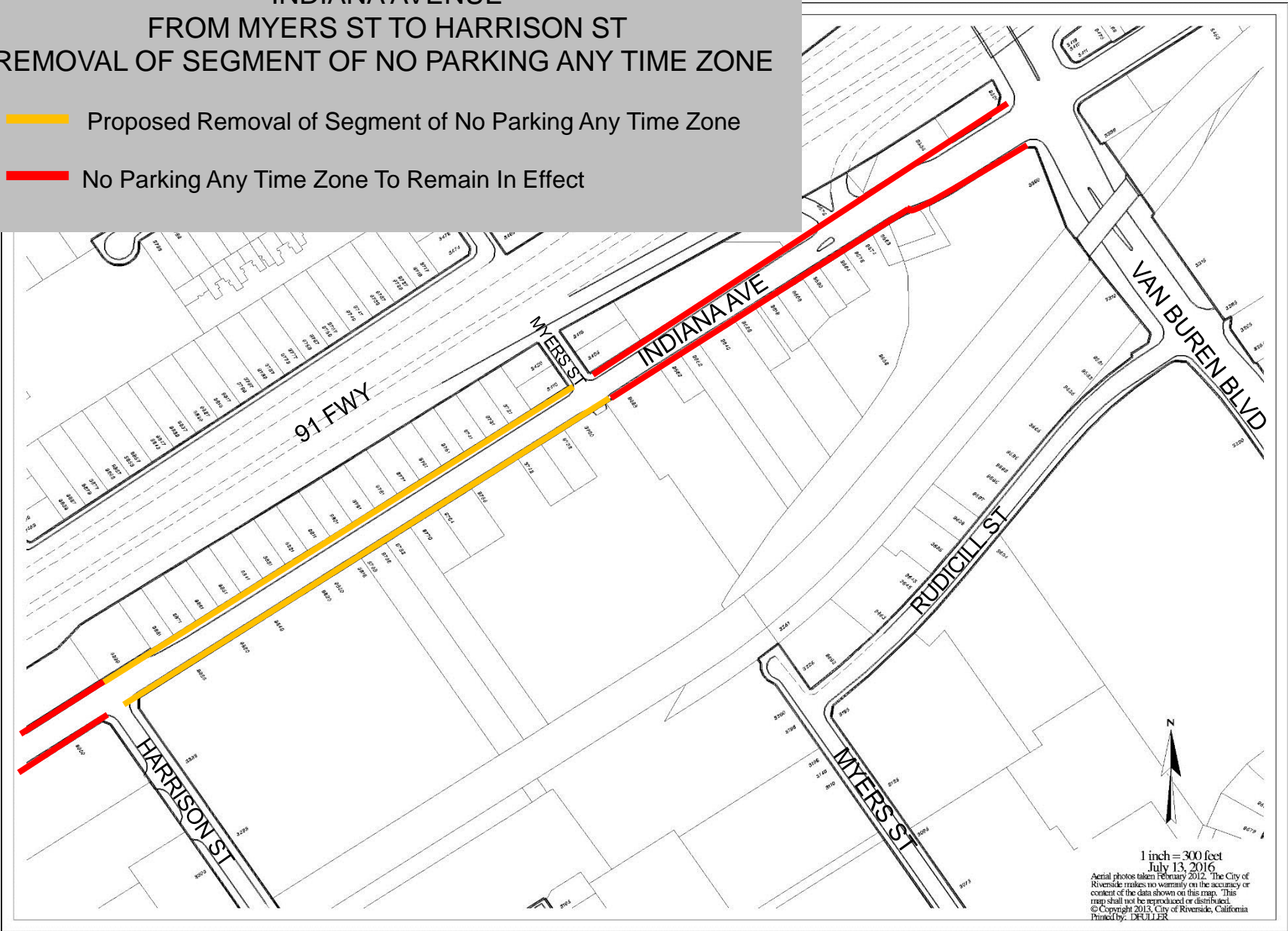

1 inch = 300 feet  
July 13, 2016  
Aerial photos taken February 2012. The City of Riverside makes no warranty on the accuracy or content of the data shown on this map. This map shall not be reproduced or distributed.  
© Copyright 2013, City of Riverside, California  
Printed by: DUKLER