

RESOLUTION NO. 22912

1
2
3
4
5
6
7
8
9
10
11
12
13
14
15
16
17
18
19
20
21
22
23
24
25
26
27
28

A RESOLUTION OF THE CITY COUNCIL OF THE CITY OF RIVERSIDE, CALIFORNIA, DECLARING ITS INTENT TO AMEND THE BOUNDARIES OF THE ARLINGTON BUSINESS IMPROVEMENT DISTRICT, DECLARING ITS INTENTION TO LEVY AN ANNUAL ASSESSMENT IN THE ARLINGTON BUSINESS IMPROVEMENT DISTRICT FOR THE FISCAL YEAR 2015-2016, GENERALLY DESCRIBING THE IMPROVEMENTS AND ACTIVITIES TO BE UNDERTAKEN, AND FIXING THE TIME AND PLACE FOR A PUBLIC HEARING BEFORE THE CITY COUNCIL OF THE CITY OF RIVERSIDE ON THE PROPOSED AMENDMENT AND ON THE LEVY OF THE PROPOSED ASSESSMENT PURSUANT TO SECTION 36534 OF THE CALIFORNIA STREETS AND HIGHWAYS CODE.

WHEREAS, the Arlington Business Improvement District in the Arlington area of the City of Riverside (the “District”) was established by Ordinance No. 6626 for (a) general business promotions, (b) business activities, (c) promotion of events, (d) advertising to promote area businesses, (e) landscaping, (f) clean-up activities, and (g) physical improvements; and

WHEREAS, the District is located in the Arlington business area of the City of Riverside, and is described as generally between Arlington Avenue on the north, along Van Buren to Lincoln on the south, and a portion along Magnolia Avenue from Tyler on the west to Jackson Street on the east; said area is more fully shown on the plat of the area, attached hereto as Exhibit “A”, entitled “Arlington BID”; and

WHEREAS, the City Council of the City of Riverside has received the annual report of the Arlington Business Partnership (“Report”), acting as the advisory board of the District for the fiscal year of 2015/2016; and

WHEREAS, the report of the Arlington Business Partnership as submitted to the City Council in September 2015 more fully details the improvements and activities which shall be provided, as well as the proposed assessments to be levied, for the fiscal year beginning November 1, 2015; and

WHEREAS, the Report is on file with the City Clerk.

NOW, THEREFORE, BE IT RESOLVED by the City Council of the City of Riverside, California, pursuant to Section 36534 of the California Streets & Highways Code, as follows:

Section 1: It is the intention of the City Council to levy and collect an assessment within the District for the fiscal year beginning November 1, 2015, at a rate not to exceed the current rate of 90% of the annual City Business Tax charge and not to exceed \$400.00 per business.

1 I, Colleen J. Nicol, City Clerk of the City of Riverside, California, hereby certify that the
2 foregoing resolution was duly and regularly introduced and adopted at a meeting of the City Council
3 of said City at its meeting held on the _____ day of _____ 2015, by the following vote,
4 to wit:

5 Ayes:

6 Noes:

7 Absent:

8 Abstain:

9 IN WITNESS WHEREOF I have hereunto set my hand and affixed the official seal of the
10 City of Riverside, California, this ____ day of _____ 2015.

11 _____
12 COLLEEN J. NICOL
13 City Clerk of the City of Riverside
14
15
16
17
18
19
20

21 O:\Cycom\WPDocs\D010\P020\00253063.DOCX
22 CA: 15-1666
23
24
25
26
27

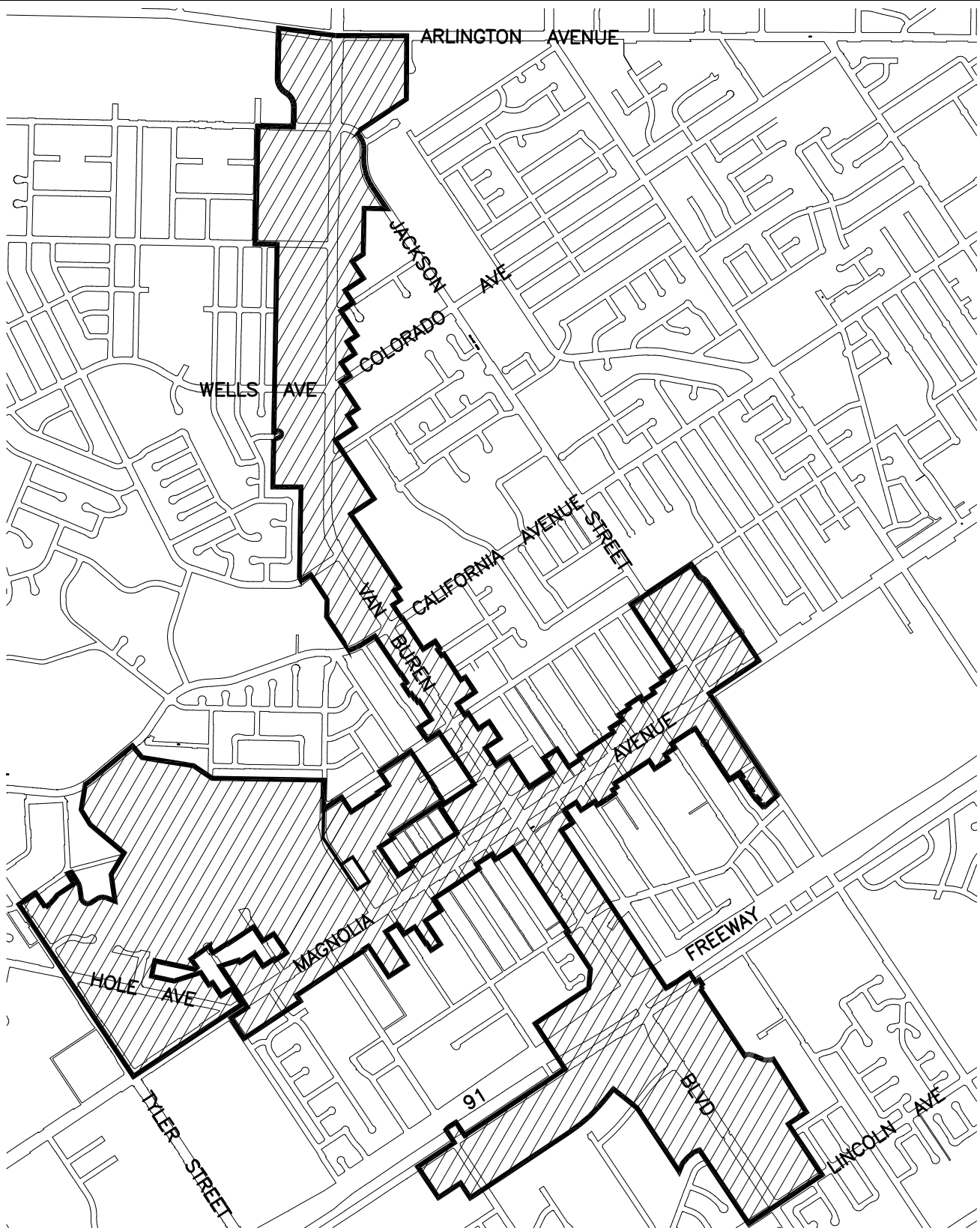

• CITY OF RIVERSIDE, CALIFORNIA •

THIS PLAT IS SOLELY AN AID IN LOCATING THE PARCEL(S) DESCRIBED IN THE ATTACHED DOCUMENT. IT IS NOT A PART OF THE WRITTEN DESCRIPTION THEREIN.

SHEET 1 OF 8

SCALE: NTS

DRAWN BY: CURT

DATE: 8/20/15

SUBJECT: ARLINGTON BID REVISION

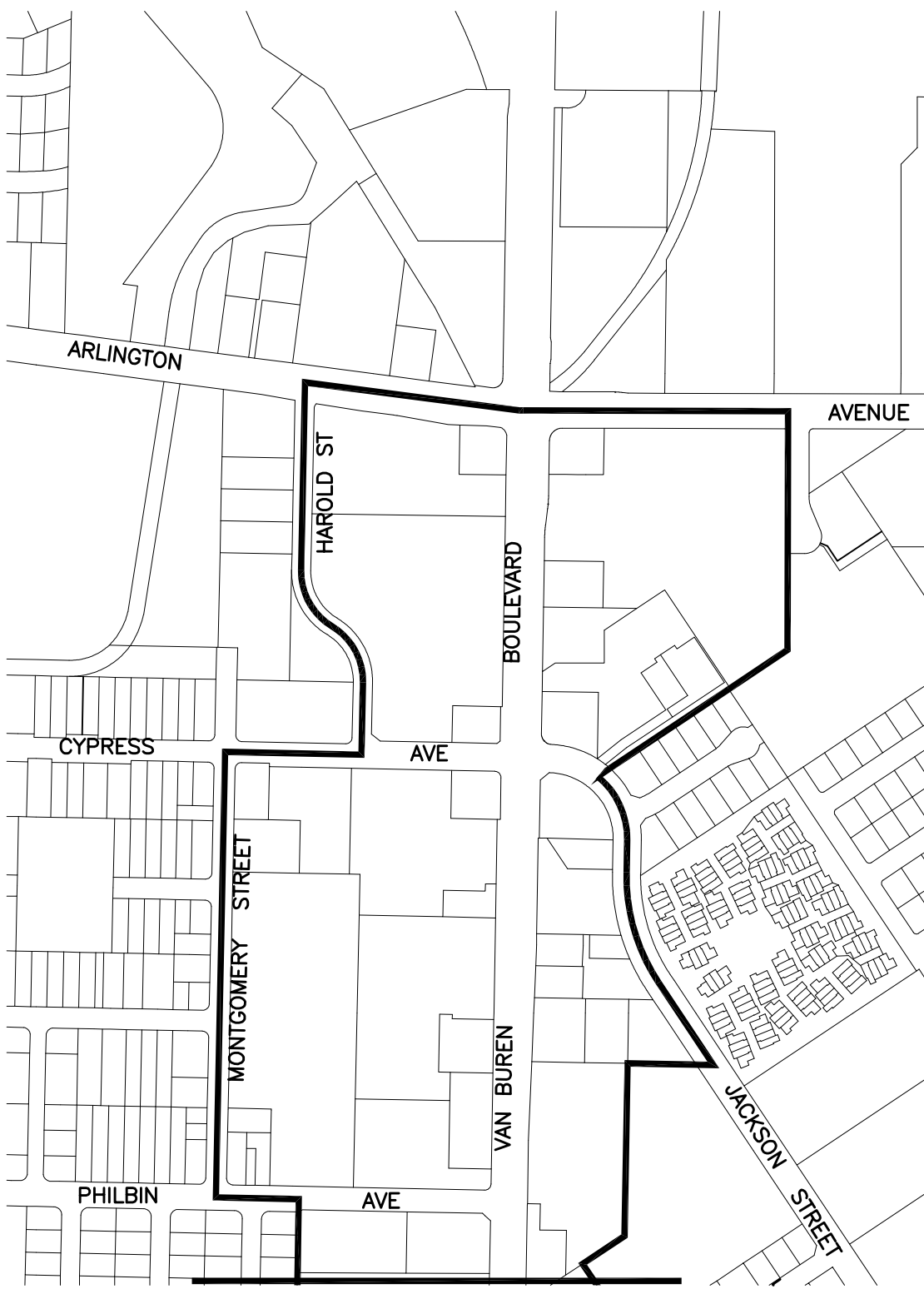

MATCHLINE SEE SHEET 3

• CITY OF RIVERSIDE, CALIFORNIA •

THIS PLAT IS SOLELY AN AID IN LOCATING THE PARCEL(S) DESCRIBED IN THE ATTACHED DOCUMENT. IT IS NOT A PART OF THE WRITTEN DESCRIPTION THEREIN.

SHEET 2 OF 8

SCALE: 1"=500' DRAWN BY: CURT DATE: 8/20/15 SUBJECT: ARLINGTON BID REVISION

MATCHLINE SEE SHEET 2

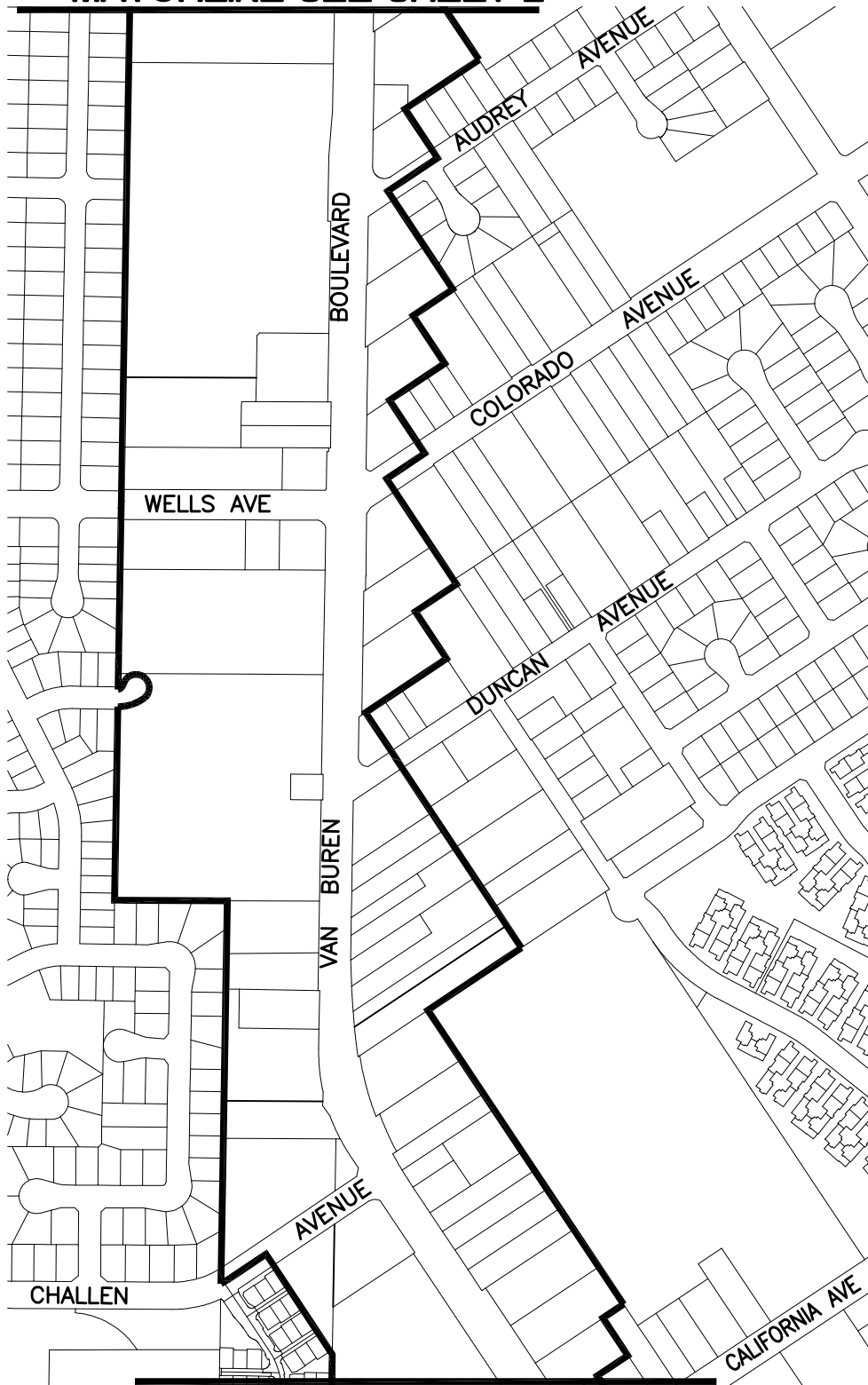

MATCHLINE SEE SHEET 4

• CITY OF RIVERSIDE, CALIFORNIA •

THIS PLAT IS SOLELY AN AID IN LOCATING THE PARCEL(S) DESCRIBED IN THE ATTACHED DOCUMENT. IT IS NOT A PART OF THE WRITTEN DESCRIPTION THEREIN.

SHEET 3 OF 8

SCALE: 1"=500'

DRAWN BY: CURT

DATE: 8/20/15

SUBJECT: ARLINGTON BID REVISION

MATCHLINE SEE SHEET 3

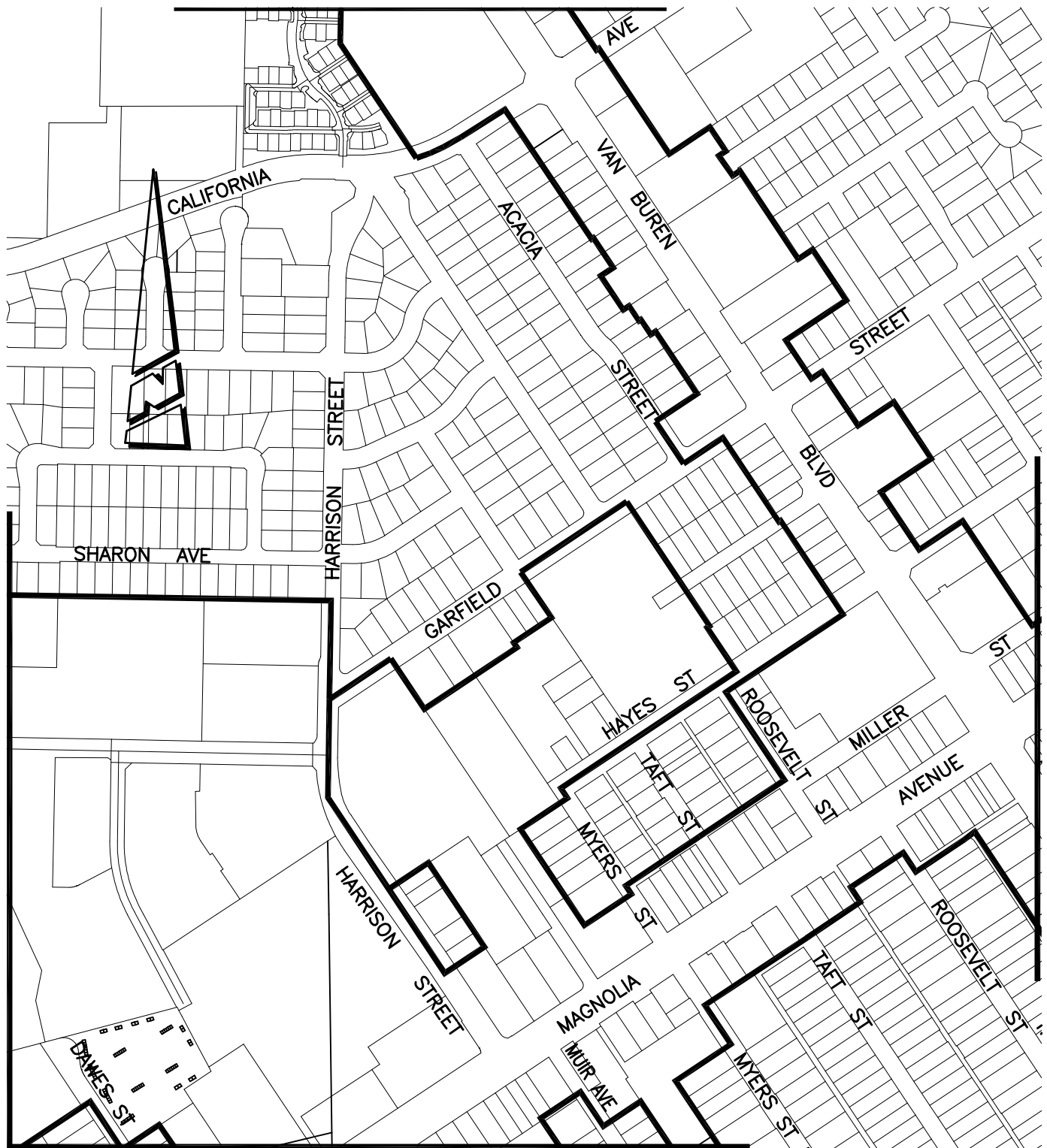

MATCHLINE SEE SHEET 6

MATCHLINE SEE SHEET 7

MATCHLINE SEE SHEET 5

• CITY OF RIVERSIDE, CALIFORNIA •

THIS PLAT IS SOLELY AN AID IN LOCATING THE PARCEL(S) DESCRIBED IN THE ATTACHED DOCUMENT. IT IS NOT A PART OF THE WRITTEN DESCRIPTION THEREIN.

SHEET 4 OF 8

SCALE: 1"=500'

DRAWN BY: CURT

DATE: 8/20/15

SUBJECT: ARLINGTON BID REVISION

MATCHLINE SEE SHEET 4

MATCHLINE SEE SHEET 5



MATCHLINE SEE SHEET 8

• CITY OF RIVERSIDE, CALIFORNIA •

THIS PLAT IS SOLELY AN AID IN LOCATING THE PARCEL(S) DESCRIBED IN THE ATTACHED DOCUMENT. IT IS NOT A PART OF THE WRITTEN DESCRIPTION THEREIN.

SHEET 5 OF 8

SCALE: 1"=500'

DRAWN BY: CURT

DATE: 8/20/15

SUBJECT: ARLINGTON BID REVISION

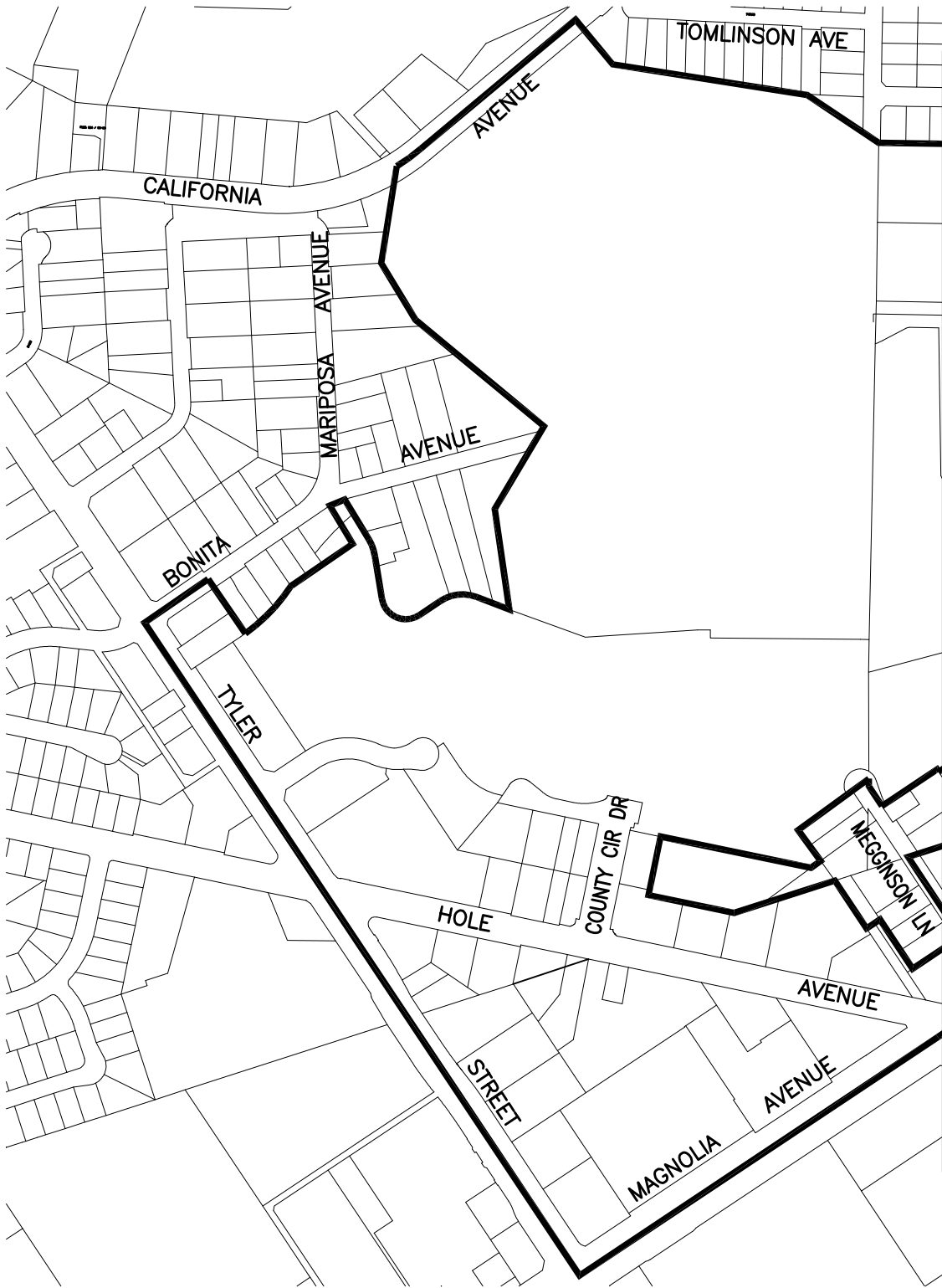

MATCHLINE SEE SHEET 4

MATCHLINE SEE SHEET 5

• CITY OF RIVERSIDE, CALIFORNIA •

THIS PLAT IS SOLELY AN AID IN LOCATING THE PARCEL(S) DESCRIBED IN THE ATTACHED DOCUMENT. IT IS NOT A PART OF THE WRITTEN DESCRIPTION THEREIN.

SHEET 6 OF 8

SCALE: 1"=500'

DRAWN BY: CURT

DATE: 8/20/15

SUBJECT: ARLINGTON BID REVISION

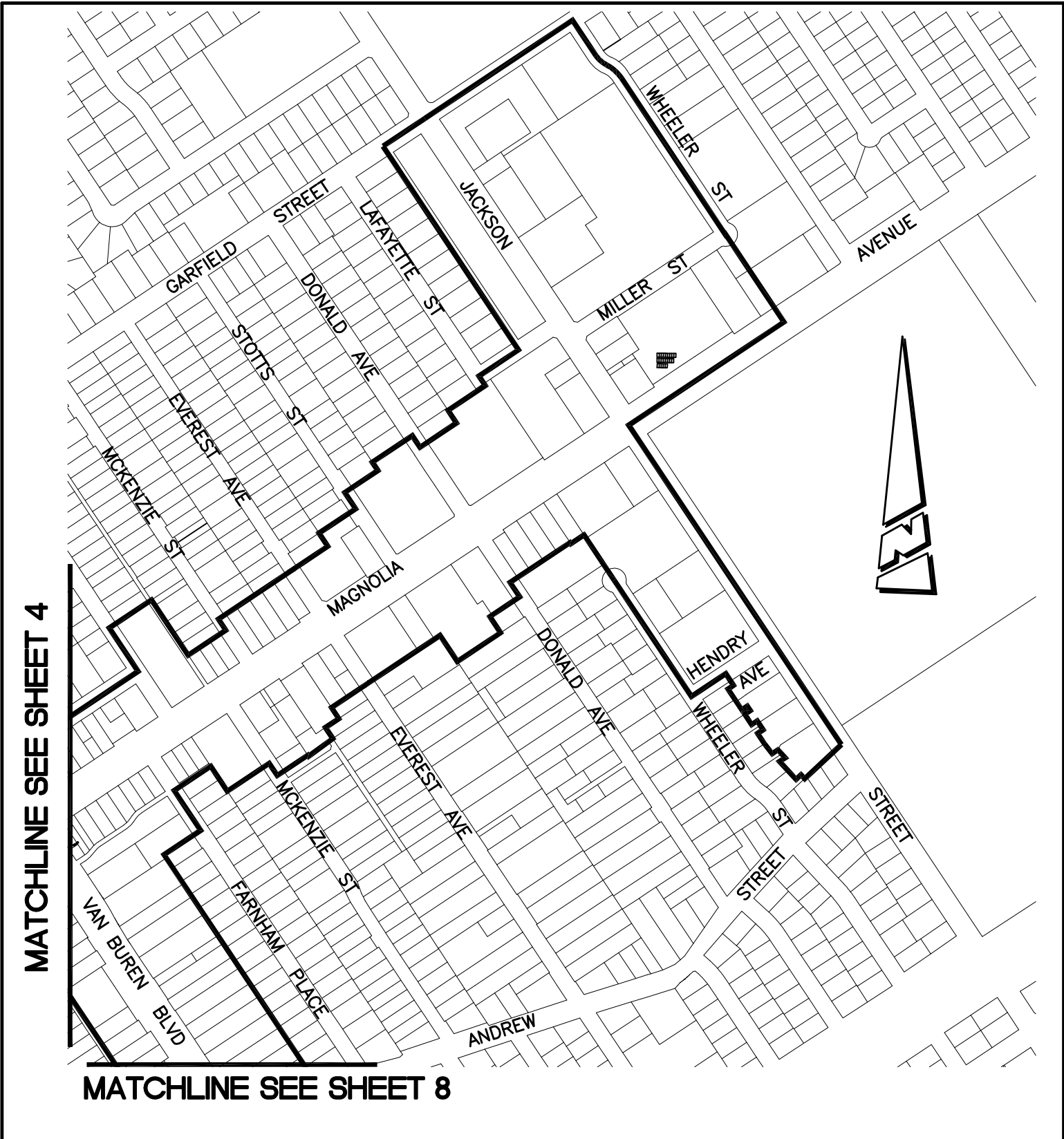

MATCHLINE SEE SHEET 4

MATCHLINE SEE SHEET 8

• CITY OF RIVERSIDE, CALIFORNIA •

THIS PLAT IS SOLELY AN AID IN LOCATING THE PARCEL(S) DESCRIBED IN THE ATTACHED DOCUMENT. IT IS NOT A PART OF THE WRITTEN DESCRIPTION THEREIN.

SHEET 7 OF 8

SCALE: 1"=500' DRAWN BY: CURT DATE: 8/20/15 SUBJECT: ARLINGTON BID REVISION

MATCHLINE SEE SHEET 7

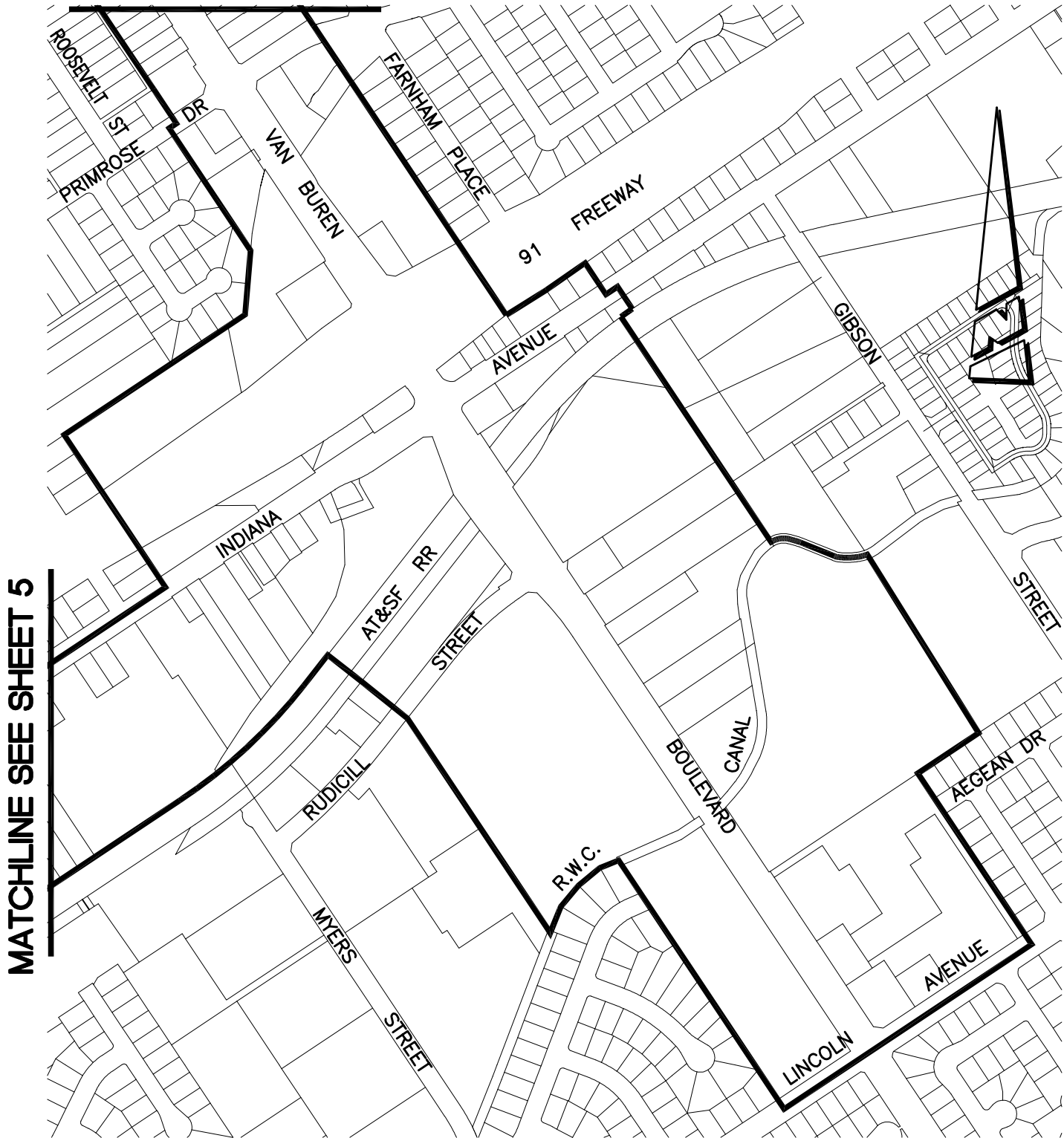

MATCHLINE SEE SHEET 5

• CITY OF RIVERSIDE, CALIFORNIA •

THIS PLAT IS SOLELY AN AID IN LOCATING THE PARCEL(S) DESCRIBED IN THE ATTACHED DOCUMENT. IT IS NOT A PART OF THE WRITTEN DESCRIPTION THEREIN.

SHEET 8 OF 8

SCALE: 1"=500'

DRAWN BY: CURT

DATE: 8/20/15

SUBJECT: ARLINGTON BID REVISION