

Museum of Riverside Board Memorandum

City of Arts & Innovation

TO: MUSEUM OF RIVERSIDE BOARD **DATE: JANUARY 25, 2023**
FROM: MUSEUM COLLECTIONS COMMITTEE **WARDS: ALL**
**SUBJECT: ACCESSION INTO THE PERMANENT COLLECTION ONE HISTORIC BIBLE
AND FOUR LOTS OF ARCHIVAL ITEMS FROM FIVE DONORS**

ISSUE:

To approve a recommendation to accession into the permanent collection one historic Bible and four lots of archival items from five donors.

RECOMMENDATION:

That the Museum of Riverside Board recommends that City Council approve accession into the permanent collection one historic Bible and four lots of archival items from five donors.

BACKGROUND:

"Riverside Homes" pamphlet

In February 2021, a member of the staff of the March Field Air Museum discovered an item in their files that they considered a better fit to the Museum of Riverside's (Museum) collection. The pamphlet was transferred to the Museum of Riverside on February 17, 2021. A record search indicated that the Museum did not already hold a copy of this item, and staff determined to recommend it for the permanent archival collection.

Commemorative U.S. Post Office envelopes

On July 20, 2022, a private donor mailed to the Museum a donation of two special issue U.S. Post Office envelopes postmarked 1938. A record search indicated that the Museum did not already hold an example of these items, and staff determined to recommend them for the permanent archival collection.

Chamber of Commerce map

On August 4, 2022, an anonymous private donor mailed a copy of a map of Riverside issued by the Chamber of Commerce in 1956. A record search indicated that the Museum did not already hold a copy of this item, and staff determined to recommend it for the permanent archival collection.

Bible

In August 2022, a Jarvis family descendant offered to the Museum the Jarvis Family Bible, with earliest entries dating from 1847. The Museum holds other records relating to the Jarvis family in Riverside.

Lemon Street postcard

In November 2022, Museum staff were informed that a postcard of Lemon Street, circa 1907-1915, was available for purchase on eBay. A private donor acquired this item and donated it to the Museum. A record search indicated that the Museum did not already hold a copy of this item, and staff determined to recommend it for the permanent archival collection.

At its meeting on August 10, 2022, the Museum of Riverside's Collections Committee unanimously supported the recommendation to accession the "Riverside Homes" pamphlet, commemorative U.S. Post Office envelopes, and 1956 Chamber of Commerce map of Riverside.

At its meeting on October 12, 2022, the Museum of Riverside's Collections Committee unanimously supported the recommendation to accession the Jarvis Family Bible.

At its meeting on December 14, 2022, the Museum of Riverside's Collections Committee unanimously supported the recommendation to accession the 1907-1915 Lemon Street postcard.

DISCUSSION:

"Riverside Homes," a booklet published by the Chamber of Commerce in 1934, includes home planning advice and sample home design drawings. It is in good condition and aligns with one of the Museum's target collecting areas, local architectural history.

The two special issue U.S. Post Office envelopes postmarked 1938 are from the same issue but are addressed and stamped differently. They feature a drawing that honors Riverside's first air mail flights in 1930 and thus relate to aviation industry as it developed in Riverside. Documents relating to the evolving commercial and industrial environment in Riverside are a target collecting area. The envelopes are in good condition.

The Chamber of Commerce map printed in 1956 is a large, fold-out road map, approximately 25 x 31 inches. It includes an extensive list of Riverside businesses and notes that the population of Riverside at that time was 70,000. This item relates to the target collecting area of Riverside directories and local commercial history. It is in good condition.

The Jarvis Family Bible records generations of members of the prominent Riverside Jarvis family, beginning in the 1840s. The family descendant who has donated the Bible notes that the "Jarvis Family Bible was in possession of my great grandfather, John T. Jarvis, and was kept at his home on the corner of 12th and Redwood (the Jarvis Family home is Riverside City Landmark #78). ... [M]y Great Grandfather was Riverside County Assessor (1895-99), Riverside Councilman (1915-25), Riverside Mayor (1926-27)." The Museum possesses few family Bibles, and the Jarvis Family Bible will be a fine resource for genealogical research and local historians.

The Lemon Street postcard was never used and is in good condition. It is estimated to date between 1907 and 1915 and was printed by the Albertype Company of Brooklyn, New York. It

may represent the block between Hewitt and Twogood, a surmise that requires further research. This item aligns with the Museum's collecting goal to acquire historic imagery relating to Riverside's neighborhoods and their evolution over time.

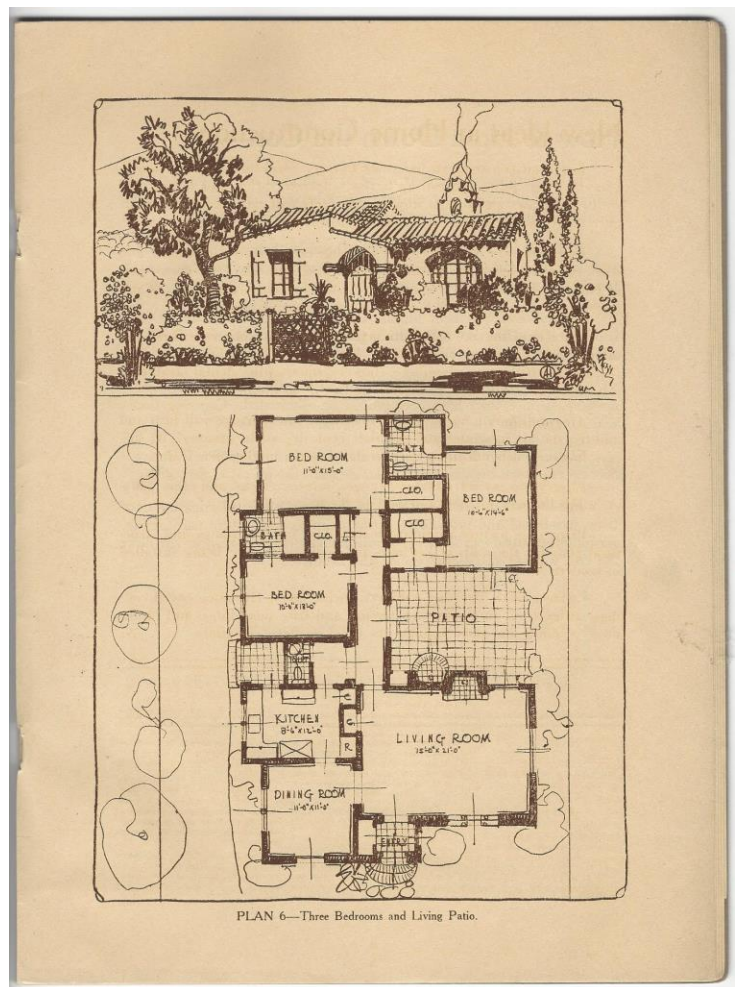
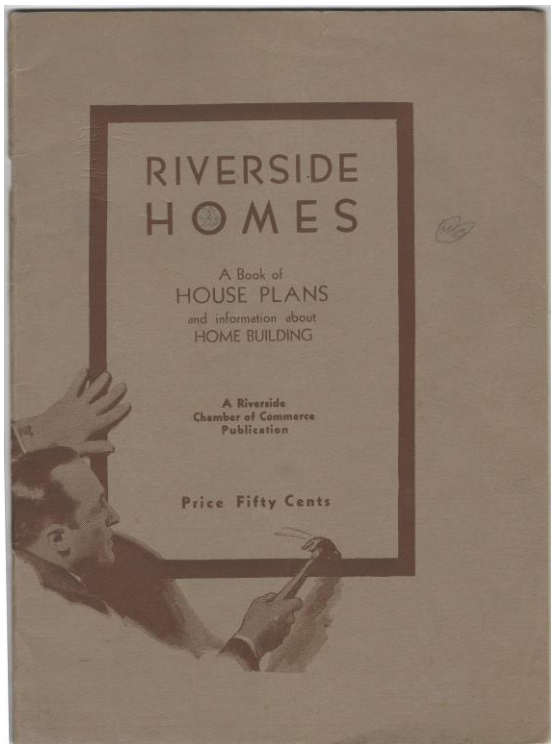



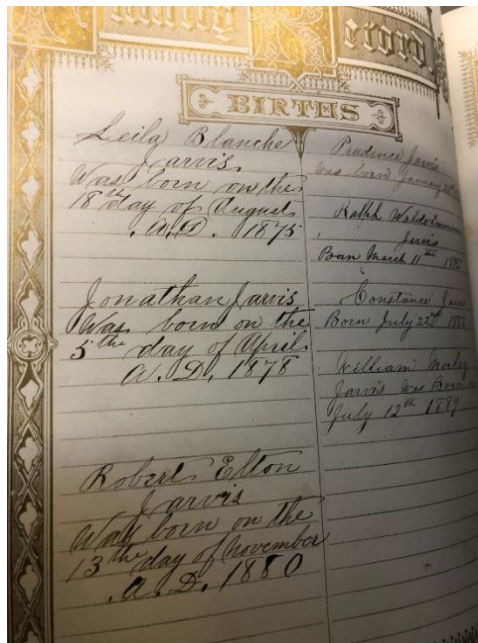
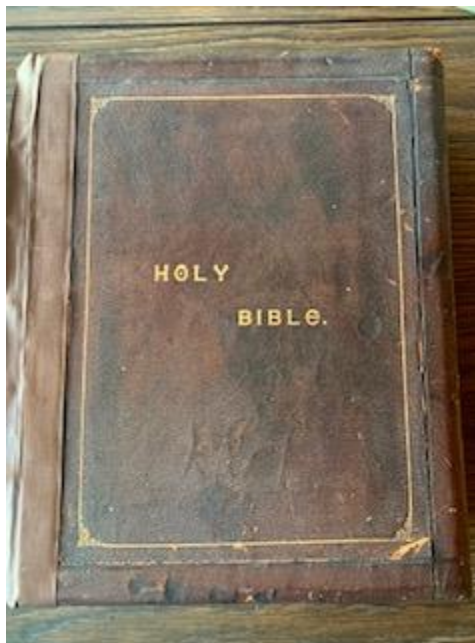
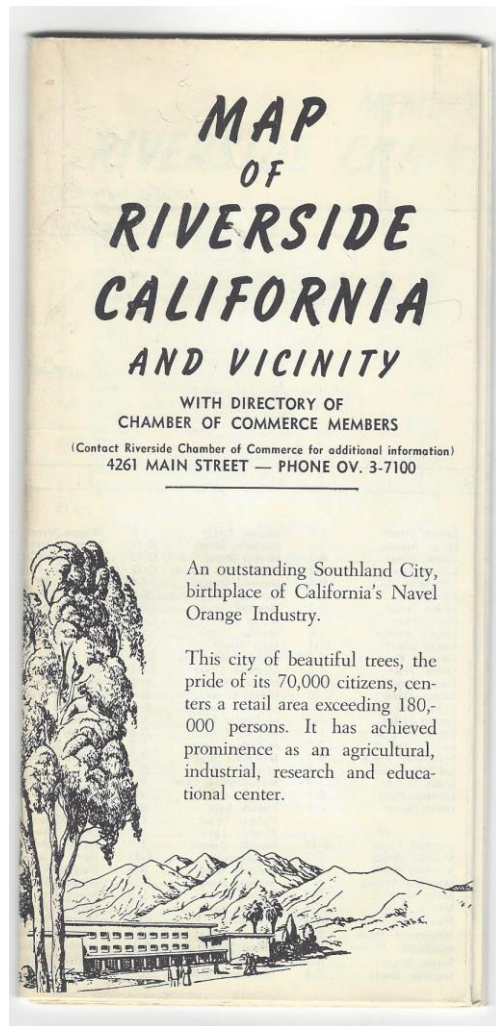



STRATEGIC PLAN ALIGNMENT:

The activities of the Museum of Riverside align with the Strategic Priority, “Arts, Culture and Recreation” and in particular Goal No. 1.1 (strengthening Riverside’s portfolio of arts, culture, recreation, senior, and lifelong learning programs and amenities), Goal No. 1.2 (enhancing equitable access to arts, culture, and recreational service offerings and facilities), and Goal No. 1.5 (supporting programs and amenities to further develop literacy, health, and education of children, youth, and seniors throughout the community).

Museum programs further support the Strategic Priority, “Community Well-Being.” Specific goals supported by Museum programs and partnerships include Goal No. 2.3, which includes strengthening neighborhood identities, and Goal No. 2.5, which points to fostering relationships between community members and partner organizations.

1. **Community Trust** – The Museum’s Collections Committee is composed of Museum staff, Museum Board members, and members of the Riverside community. Strengthening the Museum’s collections in accordance with the Museum’s Collection Development Plan and with the involvement of community members builds community trust and supports the Museum’s mission.
2. **Equity** – New collection resources enrich the stories that the Museum can tell across all neighborhoods through exhibitions and programs that are offered equitably.
3. **Fiscal Responsibility** – These proposed new accessions came to the Museum by donation and pose minimal demands on current storage and recordkeeping resources.

4. **Innovation** – New accessions into the Museum’s permanent collection expand the diversity and flexibility of collection resources, enabling more programming options.
5. **Sustainability & Resiliency** – Strengthening the Museum’s collections in accordance with the Museum’s Collection Development Plan, collection management policies, and mission enhances the City’s ability to preserve Riverside’s history for the future in a considered and judicious manner.

FISCAL IMPACT:

There is no fiscal impact associated with this report.

Prepared by:	Robyn G. Peterson, Ph.D., Museum Director
Approved by:	Kris Martinez, Assistant City Manager