

OWNER
HOSPITAL CORPORATION OF AMERICA (HCA)
2545 PARK PLAZA, BUILDING 3-2
NASHVILLE, TN 37203

FACILITY
RIVERSIDE COMMUNITY HOSPITAL
4445 MAGNOLIA AVENUE
RIVERSIDE, CA 92501

**ARCHITECT/
INTERIOR DESIGNER**
HKS ARCHITECTS, INC.
10880 WILSHIRE BLVD, #1850
LOS ANGELES, CA 90024

**CIVIL ENGINEER/
LANDSCAPE ARCHITECT**
KIMLEY-HORN AND ASSOCIATES, INC.
1100 W. TOWN & COUNTRY ROAD, SUITE 700
ORANGE, CA 92668

STRUCTURAL ENGINEER
KPFF
700 S FLOWER STREET, SUITE 2100
LOS ANGELES, CA 90017

MEP/LOW VOLTAGE ENGINEER
WSP USA
3102 OAK LAWN AVE, SUITE 450
DALLAS, TX 75219

PARKING CONSULTANT
HWA PARKING
9600 GREAT HILLS TRAIL, SUITE 150W
AUSTIN, TX 78759

HCA DESIGN MANAGER
ZACH WIDEMAN

HCA CONSTRUCTION MANAGER
RUSSELL MAASS



**NEW BROCKTON
PARKING GARAGE**



KEY PLAN

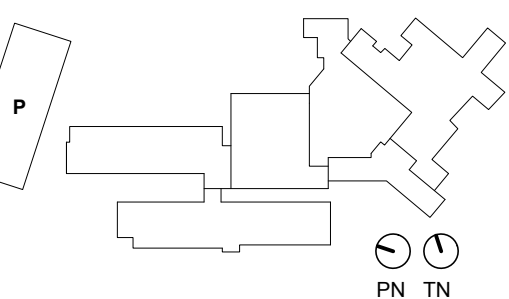

REVISION NO.	DESCRIPTION	DATE
--------------	-------------	------

HKS PROJECT NUMBER
26153.100
HCA PROJECT NUMBER
0715000049
DATE
11/08/2024
ISSUE
PLANNING SUBMITTAL

SHEET TITLE
**PLOT PLAN
SECTIONS**

NOTE: REFER TO C2.0 – GRADING
PLAN FOR GRADING ELEVATIONS

REFER TO ARCHITECTURAL SITE
PLAN FOR BUILDING HEIGHTS AND
DIMENSIONS

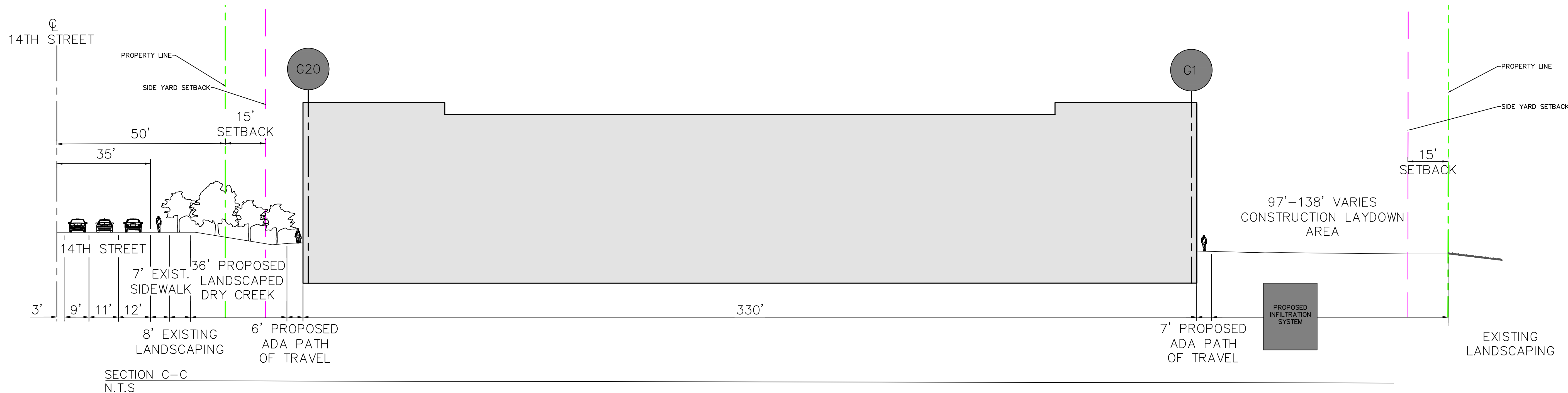
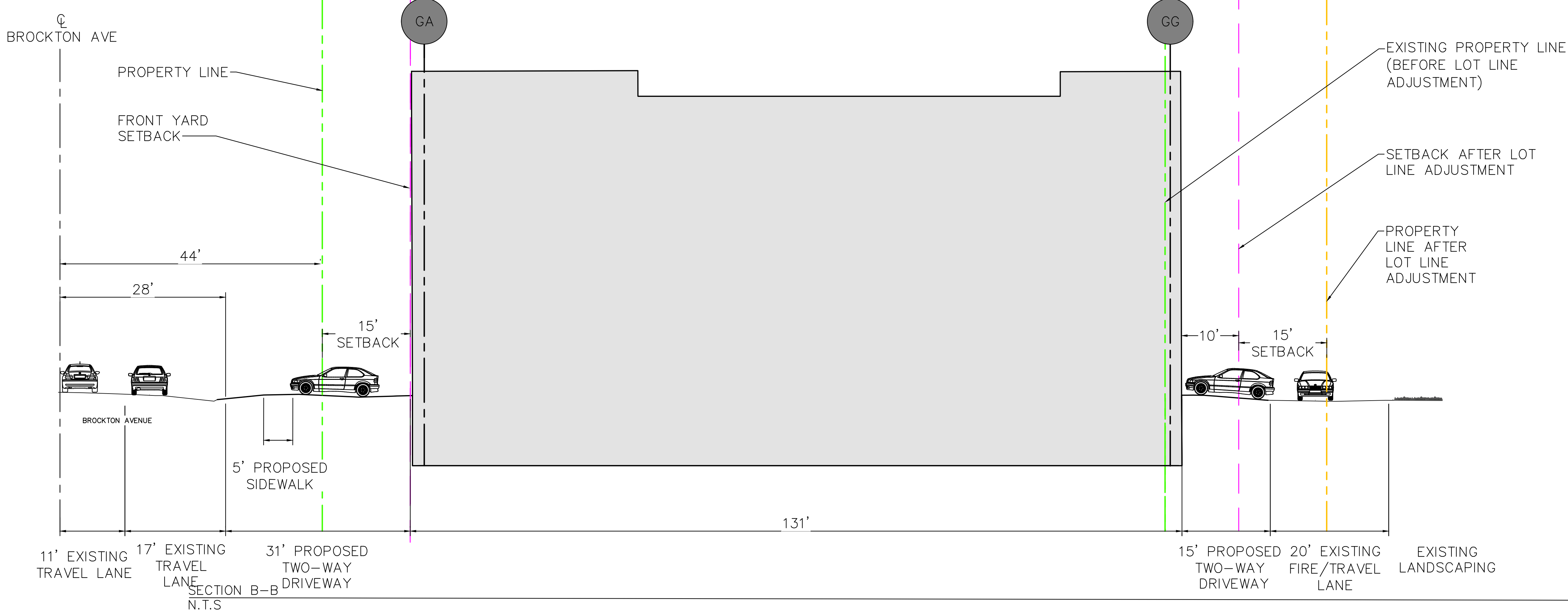
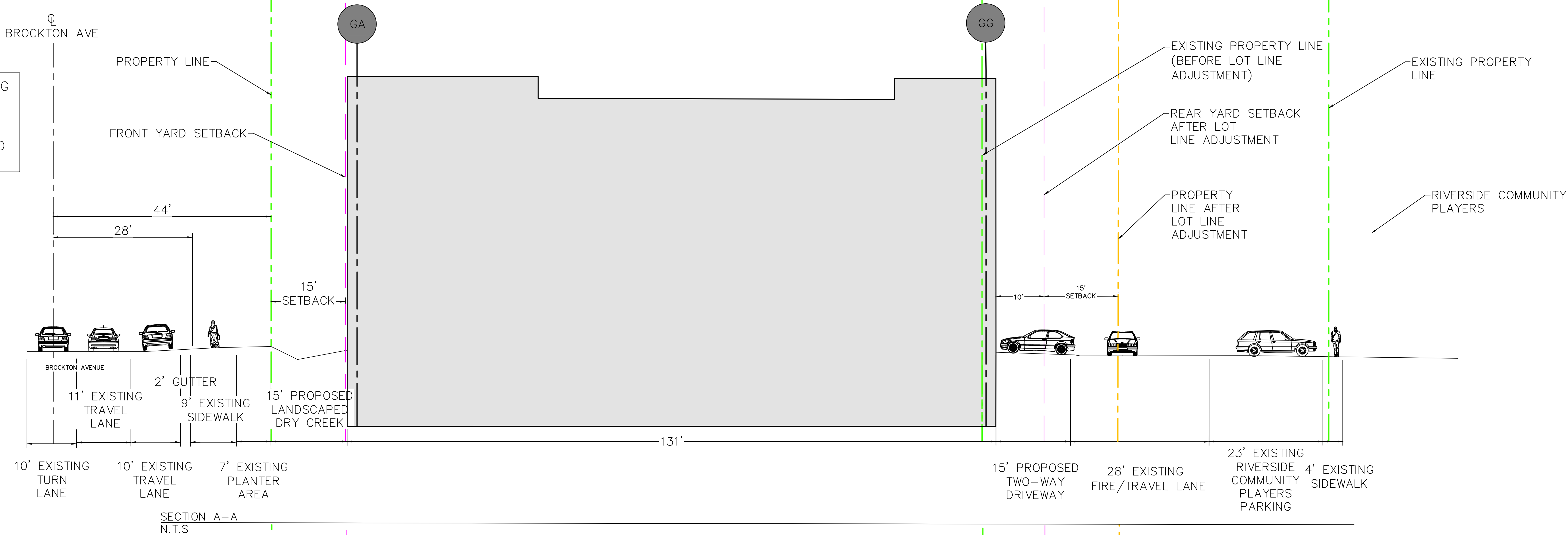

NOTE: REFER TO C1.0 – PLOT PLAN FOR PROPERTY INFORMATION.

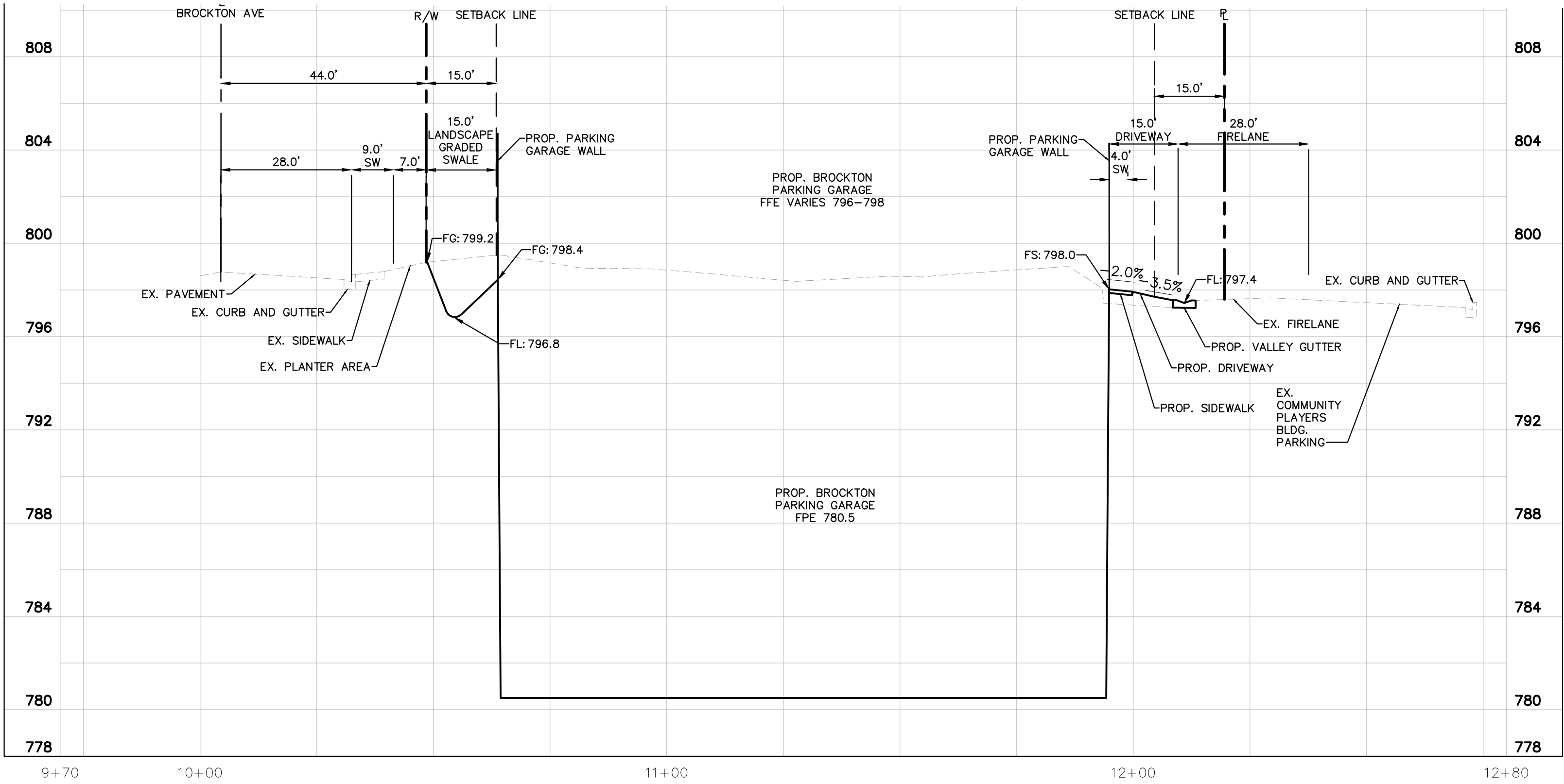

SECTION A-A:

SCALE: V: 1" = 4'
H: 1" = 20'

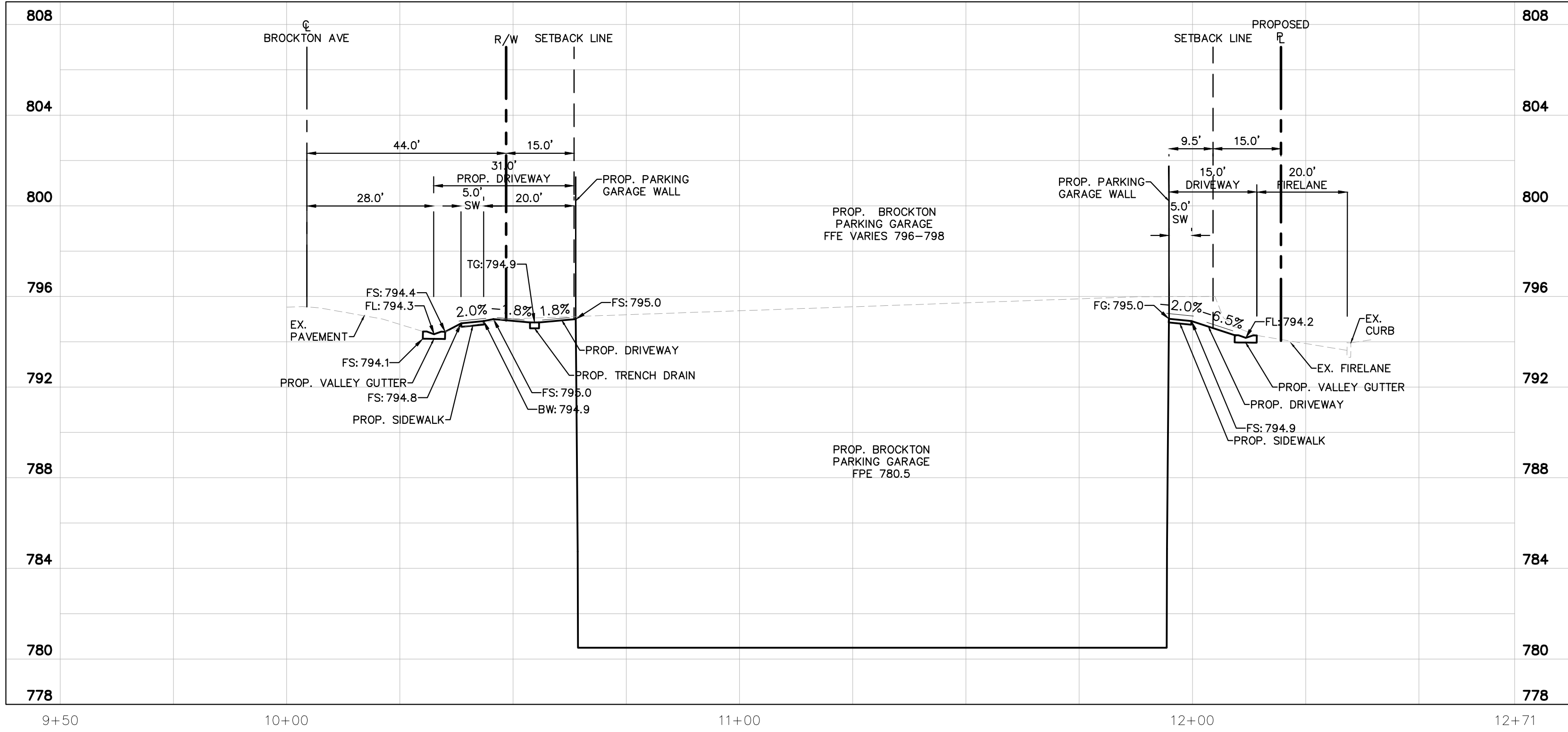

SECTION B-B:

SCALE: V: 1" = 4'
H: 1" = 20'

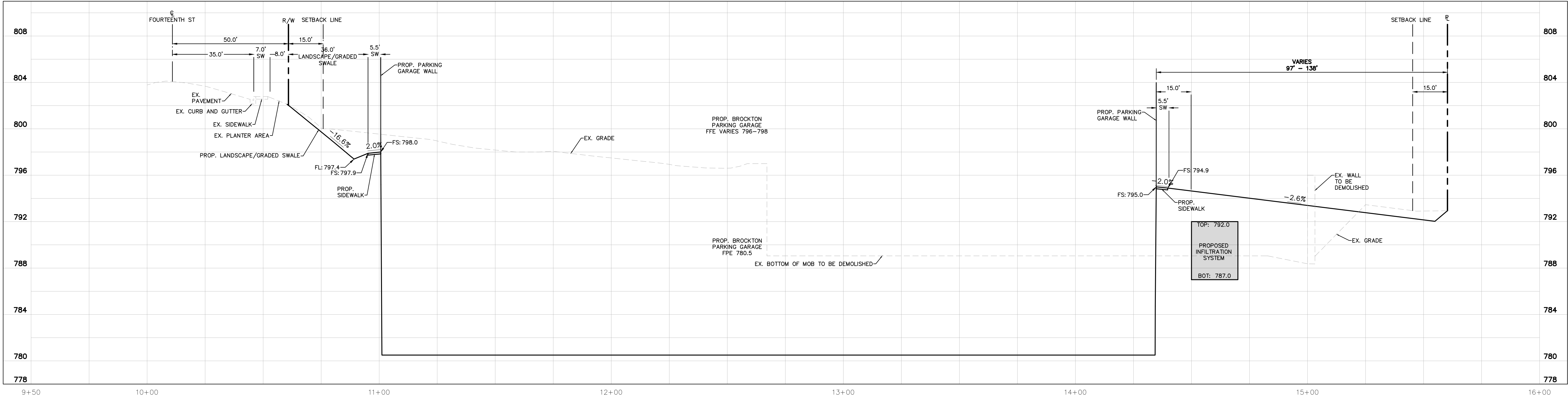

SECTION C-C:

SCALE: V: 1" = 4'
H: 1" = 20'

HKS

OWNER
HOSPITAL CORPORATION OF AMERICA (HCA)
2545 PARK PLAZA, BUILDING 3-2
NASHVILLE, TN 37203

FACILITY
RIVERSIDE COMMUNITY HOSPITAL
4445 MAGNOLIA AVENUE
RIVERSIDE, CA 92501

**ARCHITECT/
INTERIOR DESIGNER**
HKS ARCHITECTS, INC.
10880 WILSHIRE BLVD, #1850
LOS ANGELES, CA 90034

**CIVIL ENGINEER/
LANDSCAPE ARCHITECT**
KIMLEY-HORN AND ASSOCIATES, INC.
1100 W. TOWN & COUNTRY ROAD, SUITE 700
ORANGE, CA 92665

STRUCTURAL ENGINEER
KPFF
700 S FLOWER STREET, SUITE 2100
LOS ANGELES, CA 90017

MEP/LOW VOLTAGE ENGINEER
WSP USA
3102 OAK LAWN AVE, SUITE 450
DALLAS, TX 75219

PARKING CONSULTANT
HWA PARKING
9600 GREAT HILLS TRAIL, SUITE 150W
AUSTIN, TX 78759

HCA DESIGN MANAGER
ZACH WIDEMAN

HCA CONSTRUCTION MANAGER
RUSSELL MAASS



**NEW BROCKTON
PARKING GARAGE**



KEY PLAN

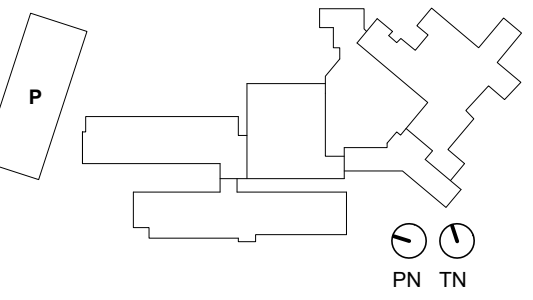

REVISION NO.	DESCRIPTION	DATE

HKS PROJECT NUMBER
26153.100
HCA PROJECT NUMBER
0715000049
DATE
11/08/2024
ISSUE
PLANNING SUBMITTAL

SHEET TITLE
**GRADING
SECTIONS**

SHEET NO.

C2.1

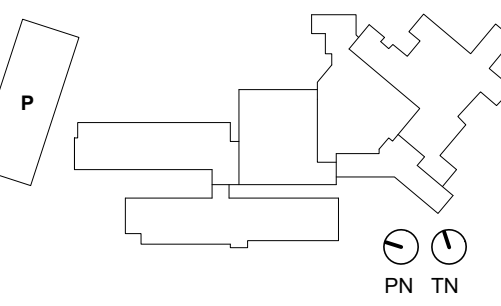

REVISION NO.	DESCRIPTION	DATE

HKS PROJECT NUMBER
26153.100
HCA PROJECT NUMBER
0715000049

DATE
11/08/2024
ISSUE
PLANNING SUBMITTAL

SHEET TITLE
**GRADING
SECTIONS**

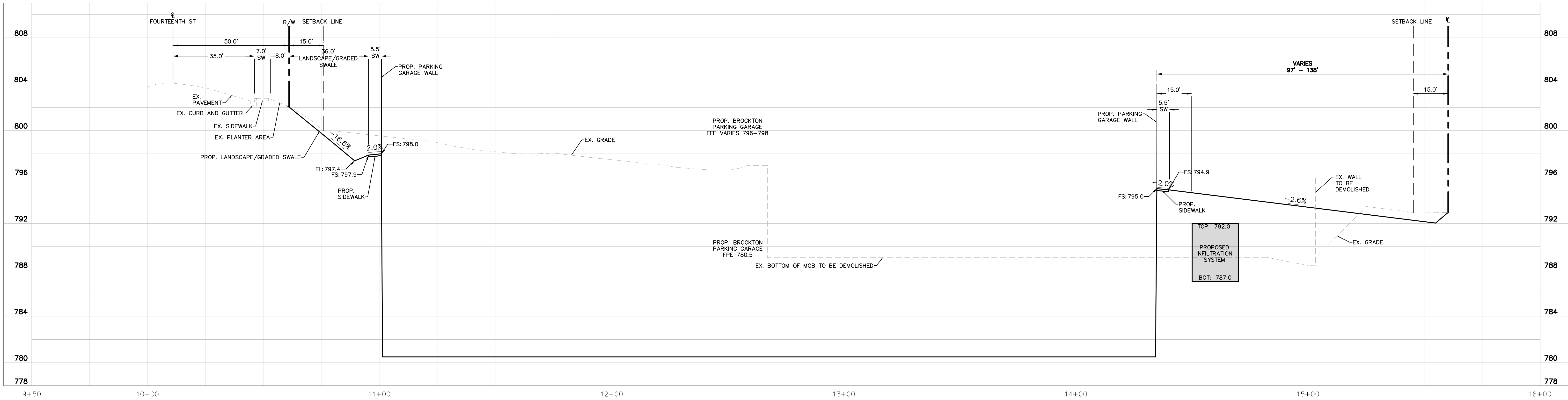

SECTION C-C:

SCALE: V: 1" = 4'
H: 1" = 20'

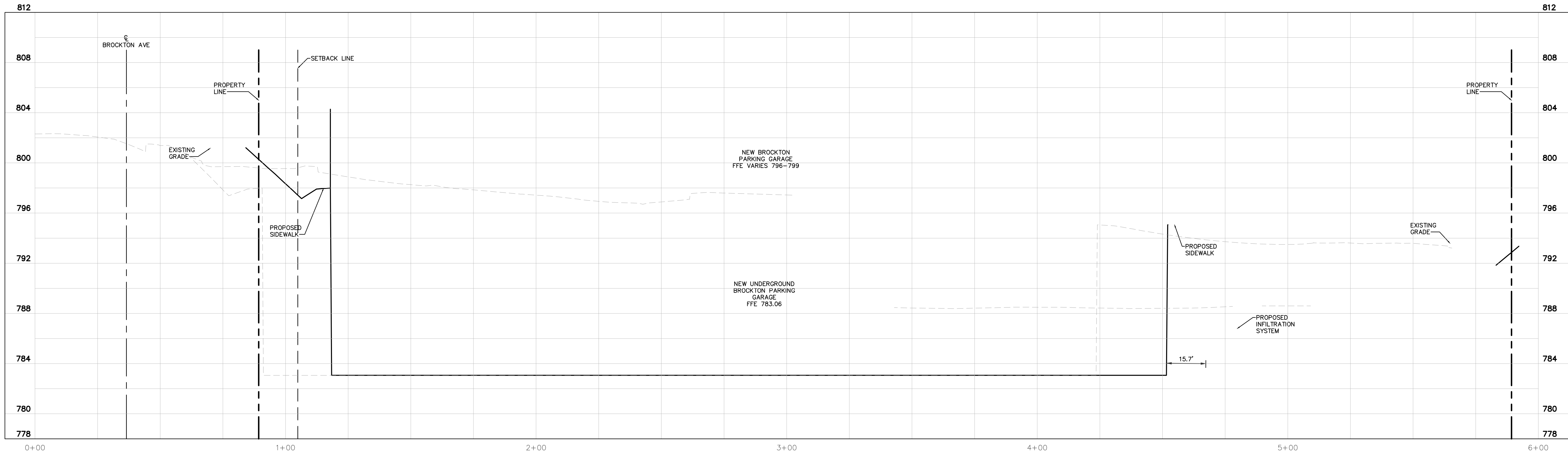

SECTION D-D:

SCALE: V: 1" = 4'
H: 1" = 20'

