

ALL IDEAS, DESIGNS, PLANS, AND SPECIFICATIONS AND OTHER PROJECT DOCUMENTS, INCLUDING ALL DOCUMENTS ON ELECTRONIC MEDIA ARE THE PROPERTY OF TREVIN SCHALL ARCHITECT INC. AND MAY NOT BE REPRODUCED OR USED WITHOUT THE WRITTEN PERMISSION OF TREVIN SCHALL ARCHITECT INC.

Jan 28, 2016 - 2:13pm Trevin Schall
C:\Users\Trevin\OneDrive\Trevin Schall\Architects\2015 - Schall Architects\2015099 - 5188 Arlington Avenue\2015099 - Site Plan CUP.dwg
Layout Name: Site Plan

1 SITE PLAN
1"=40'-0"

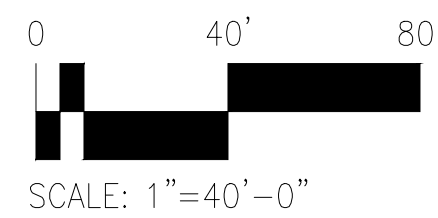
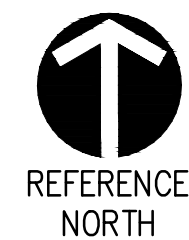
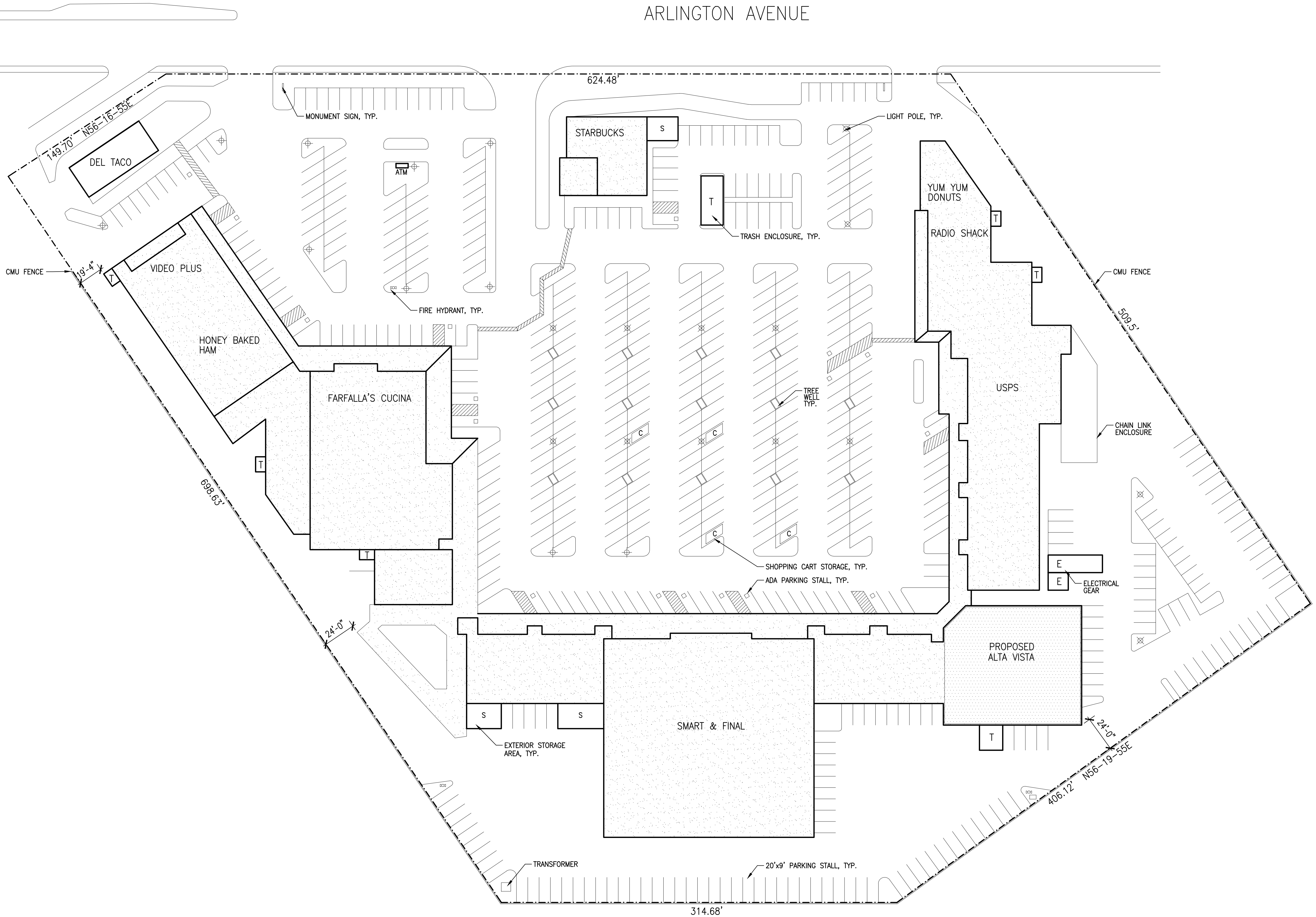

**SCHALL
ARCHITECTS**

5173 WARING ROAD, SUITE 91
SAN DIEGO, CA 92120-2705
P 858.815.3503 F 619.255.3991
www.schallarchitects.com

ALL IDEAS, DESIGNS, PLANS & SPECIFICATIONS & OTHER PROJECT DOCUMENTS, INCLUDING ALL DOCUMENTS ON ELECTRONIC MEDIA ARE THE PROPERTY OF TREVIN SCHALL ARCHITECT INC. & MAY NOT BE REPRODUCED OR USED WITHOUT WRITTEN PERMISSION FROM TREVIN SCHALL ARCHITECT INC. © COPYRIGHT TREVIN SCHALL ARCHITECT INC. ALL RIGHTS RESERVED

OCTOBER 21, 2015

HERITAGE PLAZA
ALTA VISTA
5188 ARLINGTON AVENUE
RIVERSIDE, CALIFORNIA 92504

PROJECT NO:
2015099

SHEET TITLE
SITE PLAN

SHEET NO:

A0.1