

EXHIBIT "A"
LEGAL DESCRIPTION-CHANGE OF ZONE
FROM: R-1-7000 SINGLE FAMILY RESIDENTIAL ZONE
TO: R-1-7000-CS - SINGLE FAMILY RESIDENTIAL-COMMERCIAL STORAGE
OVERLAY ZONE

APN: 226-332-022, 226-332-023

The Northerly 100.00 feet of the Southerly 183.00 feet of the South Three-Quarters of the South Half of the Northeast Quarter of the Northeast Quarter of Section 33, Township 2 South, Range 5 West, San Bernardino Meridian, in the City of Riverside, Riverside County, State of California.

EXCEPTING THEREFROM the Easterly 40.00 feet which is in Palm Avenue.

Containing 2.963 acres, more or less.

This description was prepared by me or under by direction.



William Rohal L.S. 8805

11-29-2017
Date

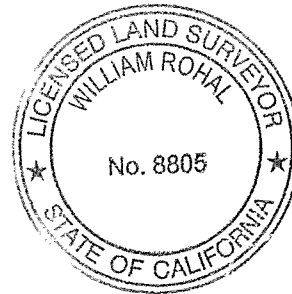

DESCRIPTION APPROVAL:

 11/30/17
CURTIS C. STEPHENS, L.S. 7519 DATE
CITY SURVEYOR

FROM: R-1-7000 SINGLE FAMILY RESIDENTIAL ZONE
TO: R-1-7000-CS - SINGLE FAMILY RESIDENTIAL-COMMERCIAL STORAGE
OVERLAY ZONE

COVER STREET

W.F. STEVENSON TRACT
MB 20/85

EMERSON STREET

W.F. STEVENSON TRACT NO. 2
MB 22/1

ARCH WAY

PALM AVENUE

GARDENA DRIVE

HYSOM TRACT
MB 22/22

37'

100'

40'

183'

APN 226-332-022
APN 226-332-023

2.963 AC

33'

DEWEY AVENUE

SCALE: 1" = 200'

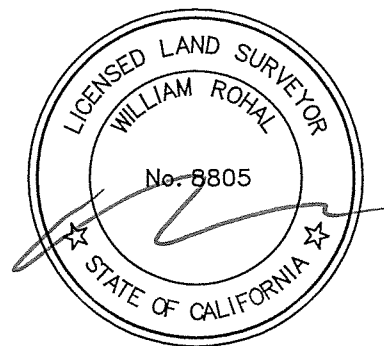

RICK
ENGINEERING COMPANY
Riverside

1770 IOWA AVENUE - SUITE 100
RIVERSIDE, CA 92507
951.782.0707
(FAX) 951.782.0723

rickengineering.com

San Diego - Orange - San Luis Obispo - Bakersfield - Sacramento - Phoenix - Tucson

CHANGE OF ZONE

SCALE: 1"=200' | DATE: SEPT. 19. 2017