

PRELIMINARY GRADING PLAN

IN THE CITY OF RIVERSIDE, CALIFORNIA
GUTHRIE INDUSTRIAL

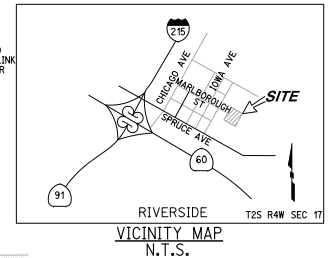
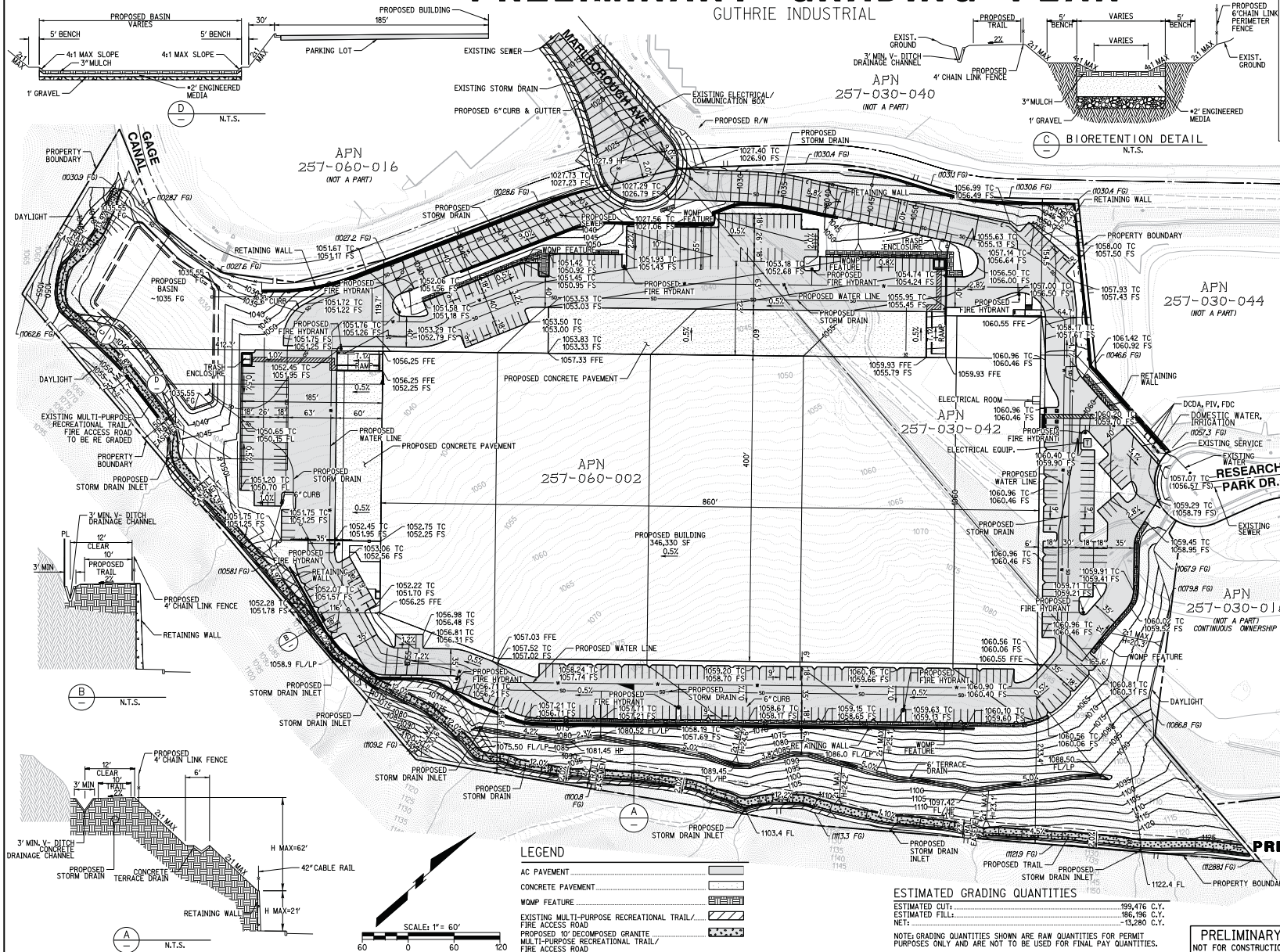

APPLICANT/OWNER/DEVELOPER

GUTHRIE PERICLES, LLC
1451 RESEARCH PARK DRIVE - SUITE 200
RIVERSIDE, CA 92507
ATTN: DOUGLAS THOMPSON
PHONE: (951) 784-7238

ENGINEER

RICK ENGINEERING COMPANY
1770 IOWA AVENUE, SUITE 100
RIVERSIDE, CA 92507
PHONE: (951) 782-0707
FAX: (951) 782-0723
ATTN: RICHARD O'NEILL

ASSESSOR'S PARCEL NUMBER

257-030-042 & 257-060-002

SITE ADDRESS

750 MALBOROUGH AVE.
RIVERSIDE, CA 92507

PARKING COUNT

STANDARD STALLS	375
ADA STALLS	4
55' TRAILER STALLS	12
TOTAL	391

TOPOGRAPHY LEGEND

EXISTING BOLLARD	⊙
EXISTING CATCH BASIN	⊙
EXISTING ELECTRICAL MANHOLE	⊙
EXISTING FIRE HYDRANT	⊙
EXISTING LIGHT	⊙
EXISTING PALM TREE	⊙
EXISTING SEWER MANHOLE	⊙
EXISTING STORM DRAIN MANHOLE	⊙
EXISTING SIGN	⊙
EXISTING WATER METER	⊙
EXISTING WALL	⊙
EXISTING TREE	⊙
PROJECT BOUNDARY	---

ABBREVIATIONS

PROPERTY LINE	PL
RIGHT-OF-WAY	R/W
POST INDICATOR VALVE	PIV
FIRE DETECTOR CHECK	FDC

PRELIMINARY GRADING PLAN GUTHRIE INDUSTRIAL

CITY OF RIVERSIDE
IN THE COUNTY OF RIVERSIDE, CALIFORNIA
SHEET 1 OF 1

DATE PREPARED: JANUARY 12, 2018
1770 IOWA AVENUE - SUITE 100
RIVERSIDE, CA 92507
PHONE: (951) 782-0707
FAX: (951) 782-0723
ATTN: RICHARD O'NEILL

PRELIMINARY
NOT FOR CONSTRUCTION

ESTIMATED GRADING QUANTITIES

ESTIMATED CUT:	199,476 C.Y.
ESTIMATED FILL:	186,196 C.Y.
NET:	-13,280 C.Y.

NOTE: GRADING QUANTITIES SHOWN ARE RAW QUANTITIES FOR PERMIT PURPOSES ONLY AND ARE NOT TO BE USED FOR FINAL PAY QUANTITIES.

LEGEND

AC PAVEMENT	---
CONCRETE PAVEMENT	---
WOMP FEATURE	---
EXISTING MULTI-PURPOSE RECREATIONAL TRAIL/FIRE ACCESS ROAD	---
PROPOSED 10' DECOMPOSED GRANITE MULTI-PURPOSE RECREATIONAL TRAIL/FIRE ACCESS ROAD	---

SCALE: 1" = 60'

01/17/2018 11:41 AM 1770 IOWA AVE 01/18/2018

PLOT DATE: 15-JAN-2018 JIN 17794