

CARNATION COURT
BOTH SIDES OF ENTIRE STREET
REMOVAL OF EXISTING PREFERENTIAL PARKING ZONE (PPZ)

 Proposed Removal of PPZ

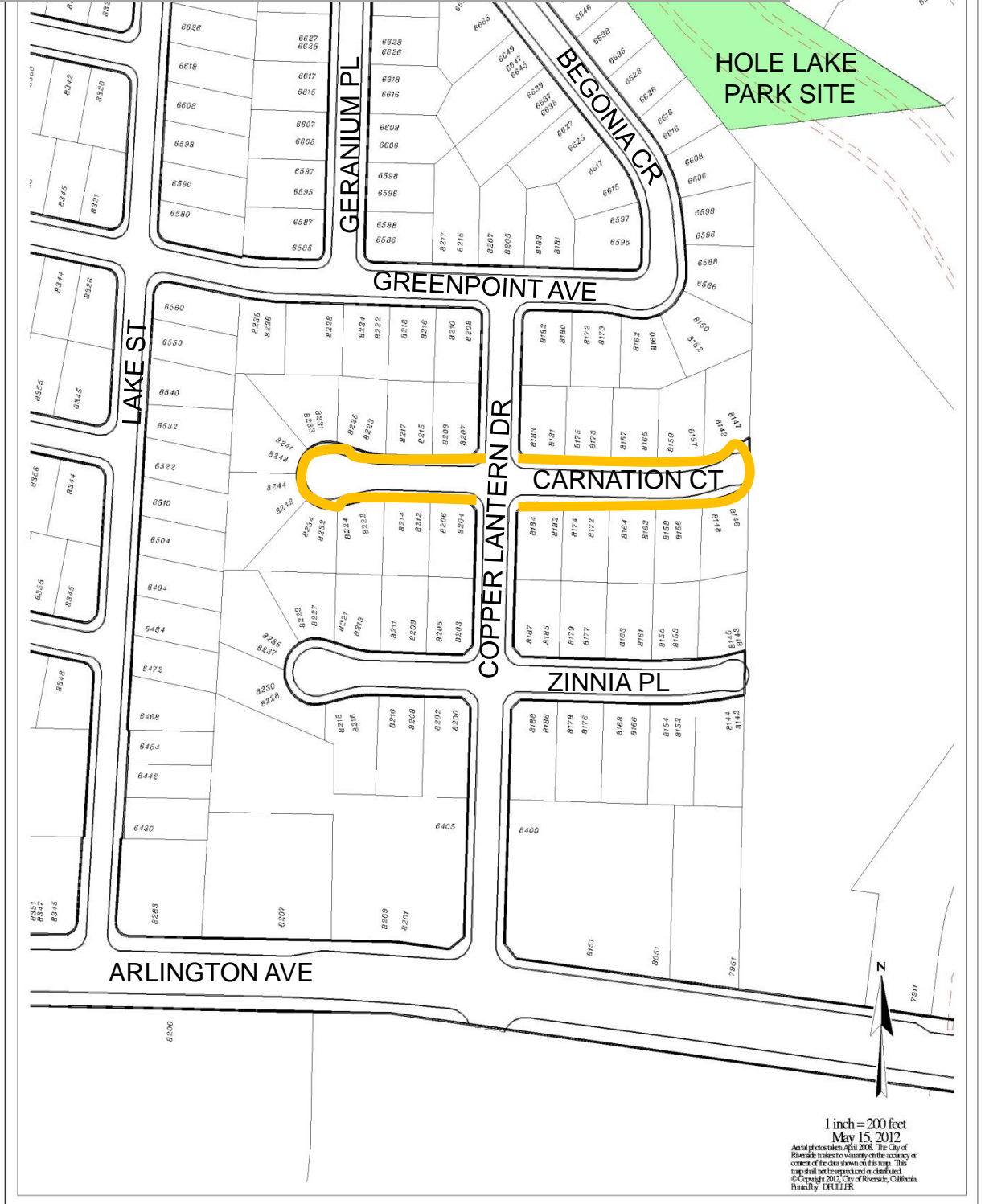

1 inch = 200 feet
May 15, 2012
Aerial photograph April 2008. The City of
Riverside makes no warranty on the accuracy or
content of the data shown on this map. This
map shall not be expanded or modified.
© Copyright 2012 City of Riverside, California
Filename: D:\CELL158