



## Quick 'n Clean Carwash

P17-0693 (Parcel Map), P17-0690 (General Plan Map Amendment),  
P17-0691 (Zoning Code Map Amendment), P17-0692 (Conditional Use  
Permit), P17-0694 (Design Review)

### Community & Economic Development Department

Planning Commission  
Agenda Item: 3  
September 19, 2019

RiversideCA.gov

## LOCATION MAP



2

RiversideCA.gov

## GENERAL PLAN

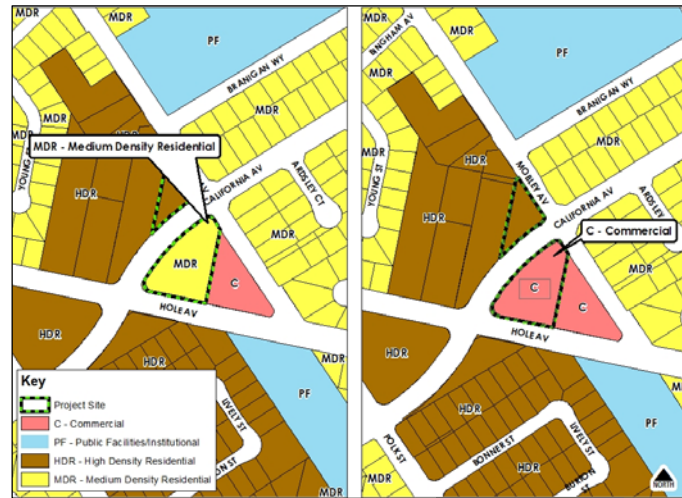

Existing

Proposed

3



RiversideCA.gov

## EXISTING/PROPOSED ZONING MAP

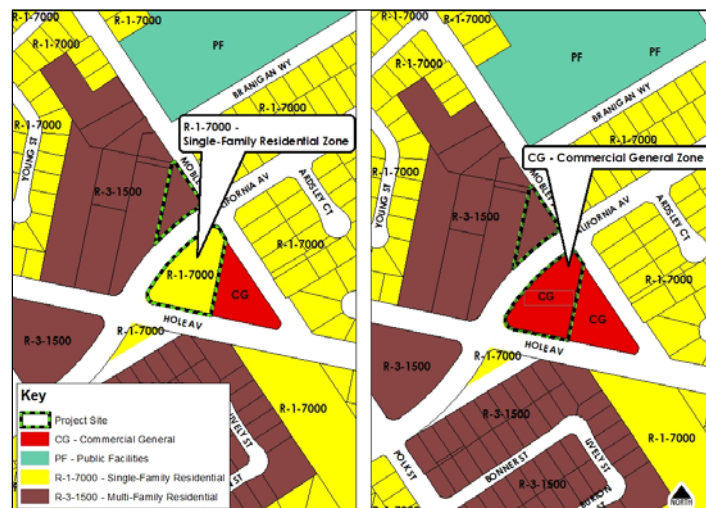

Existing

Proposed

4



RiversideCA.gov

## EXISTING SITE PHOTOS

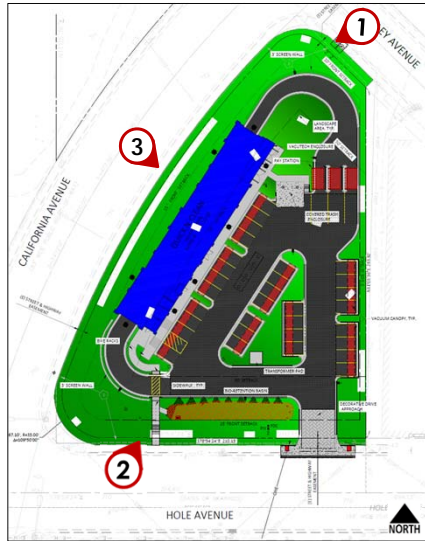

5

RiversideCA.gov

## SITE PLAN

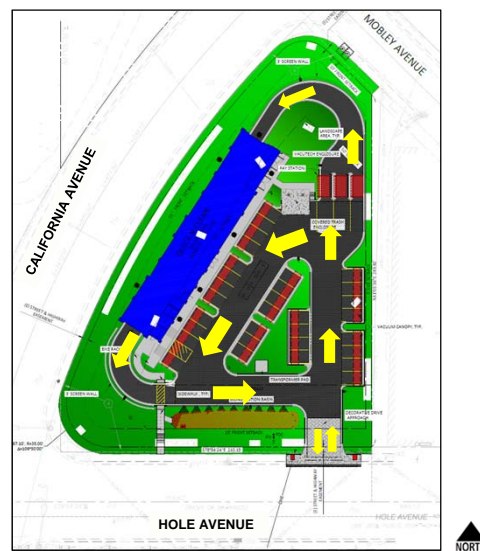

6

RiversideCA.gov

## FLOOR PLAN

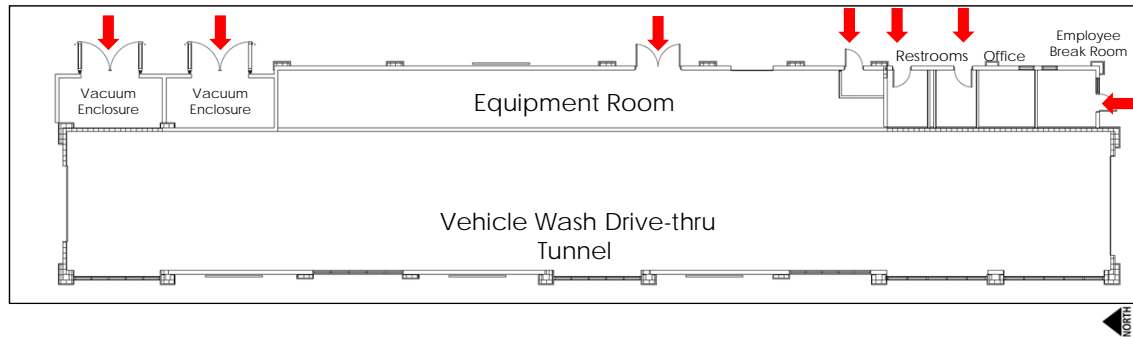

7

RiversideCA.gov

## ELEVATIONS



Northwest Elevation (California Avenue)



Southeast Elevation (Site Interior)



8

RiversideCA.gov

## CONCEPTUAL LANDSCAPE PLAN



9

RiversideCA.gov

## RECOMMENDATIONS

That the Planning Commission:

1. **RECOMMEND that the City Council DETERMINE** that the proposed project will not have a significant effect on the environment based on the findings set forth in the case record, and recommend that the City Council adopt a Negative Declaration; and
2. **RECOMMEND that the City Council APPROVE** Planning Cases P17-0690 (General Plan Map Amendment), P17-0691 (Zoning Code Map Amendment), P17-0692 (Conditional Use Permit), P17-0693 (Parcel Map), P17-0694 (Design Review), based on the findings outlined in the staff report and summarized in the attached findings and subject to the recommended conditions.



10

RiversideCA.gov

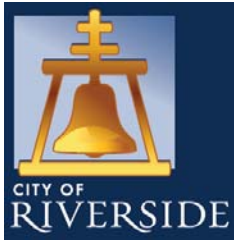

## Quick 'n Clean Carwash

P17-0693 (Parcel Map), P17-0690 (General Plan Map Amendment),  
P17-0691 (Zoning Code Map Amendment), P17-0692 (Conditional Use  
Permit), P17-0694 (Design Review)

### Community & Economic Development Department

Planning Commission  
Agenda Item: 3  
September 19, 2019

RiversideCA.gov

## ELEVATIONS

(FOR REFERENCE ONLY)



Northeast Elevation (Mobley Avenue)



Southwest Elevation (Hole Avenue)



12

RiversideCA.gov



# GRADING PLAN

(FOR REFERENCE ONLY)

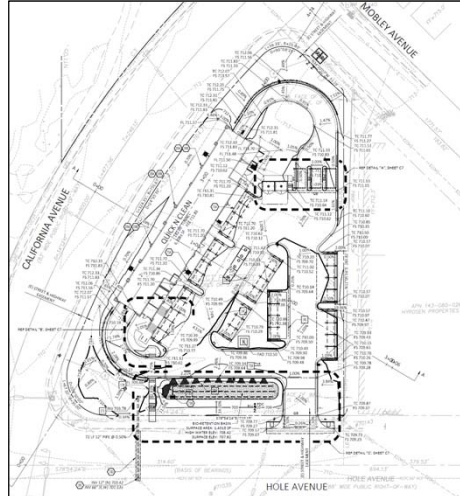

13

RiversideCA.gov