

# VAN BUREN BOULEVARD SEWER INSTALLATION – PROJECT UPDATE

Public Works Department

Mobility & Infrastructure Committee  
November 18, 2020

RiversideCA.gov

## BACKGROUND

Item	Year	Action
1	2010	Western Municipal Water District (WMWD) requested that the sewer service area be transferred from the City of Riverside to WMWD so they could pursue a sewer project
2	2011	WMWD attempted to setup an assessment district to fund the sewer project
3	2012	The assessment district was dissolved due to a legal challenge preventing bonds from being sold
4	2015	Developers requested that WMWD pursue constructing the Woodcrest Sewer
5	2015	WMWD purchased the lot at the northeasterly corner of Washington Street at Krameria Avenue to construct a sewer lift station to serve the Woodcrest Sewer Project
6	2016	The developers indicated that they could not fund the cost of the Woodcrest Sewer
7	2017	On March 21, 2017, the City Council approved a conceptual plan to provide new sewer facilities on Van Buren Boulevard between Wood Road and King Avenue and authorized the Public Works Department to begin engineering design, environmental clearance, and right-of-way acquisition for the construction of the new sewer facilities.

2



RiversideCA.gov

## BACKGROUND

Item	Year	Action
8	2019	On February 5, 2019, the City Council approved a Memorandum of Understanding with WMWD and the County of Riverside to purchase the property located at the northeasterly corner of Washington Street and Krameria Avenue to serve the Van Buren Boulevard Sewer Project, see attached MOU.
9	2019	On March 14 and on September 12, 2019, City staff attended Woodcrest Municipal Advisory Council (MAC) meetings to share the project details with the community including Riverside County residents
10	2020	On March 3, 2020, the City Council approved a Mitigated Negative Declaration and Mitigation Monitoring and Reporting program for the construction of the sewer pipeline, sewer lift station, and force main associated with the Van Buren Boulevard Sewer project.
11	2020	On June 17, 2020, the WMWD Board of Directors approved the sale of the property located at the northeasterly corner of Krameria Avenue and Washington Street to the City of Riverside for the purpose of constructing a sewer lift station.



3

RiversideCA.gov

## LOCATION MAP

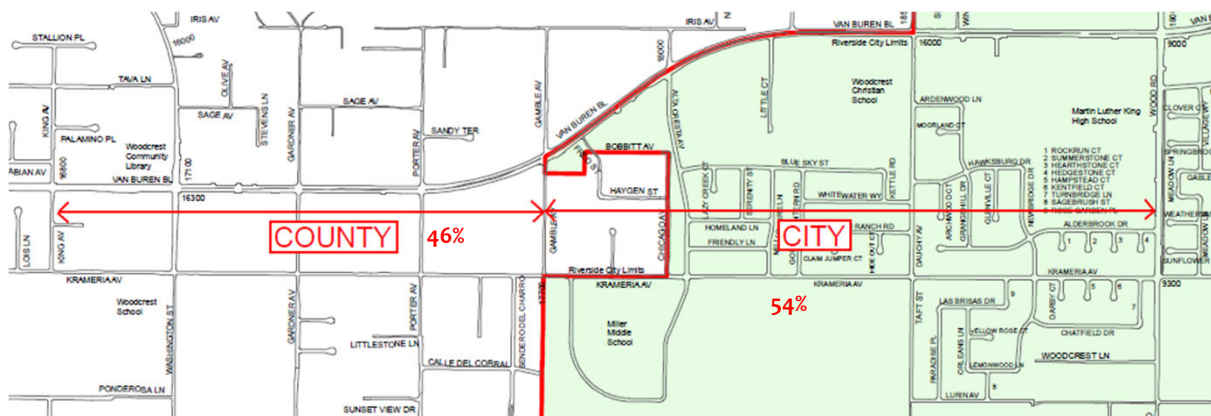

4

RiversideCA.gov

## PROJECT SCOPE



4

**RiversideCA.gov**

## PROJECT OVERVIEW / NEEDS

1. Requests from property owners within the City and County to establish public sewer services;
2. Increased environmental concerns with septic systems; potential to overflow during heavy rainstorms & impact health;
3. Public Sewer infrastructure will promote economic growth along the Van Buren Boulevard corridor;
4. Public Sewer project should be completed prior to the proposed Van Buren Boulevard Widening Project;



6

**RiversideCA.gov**

## PROJECT OVERVIEW / NEEDS

5. Would serve Woodcrest Elementary School (County) currently on septic and Woodcrest Christian High School (eliminate the existing sewer pump station);
6. Service Studies concluded that the City is the most economical sewer service purveyor;
7. Stakeholders Include: RUSD, WMWD, County of Riverside, Riverside Chamber of Commerce, business and residential community along Van Buren Boulevard; and
8. Project MOU between City, County, and WMWD.



7

RiversideCA.gov

## MEMORANDUM OF UNDERSTANDING FRAMEWORK

1. Project MOU developed between City, County of Riverside and Western Municipal Water District:
  - a. City to fund and construct the project;
  - b. Service area to include project frontage parcels and outer areas as required and capacity allows;
  - c. City will recover project costs through sewer connection and monthly sewer service charges;
  - d. WMWD will sell vacant parcel to the City for a new sewer pump station (NE quadrant at Washington Street at Krameria Avenue);



8

RiversideCA.gov

## MEMORANDUM OF UNDERSTANDING FRAMEWORK

- e. Sewer project to be constructed prior to or concurrently with the County's Van Buren Widening project from Wood Road to Washington Street; and
- f. The County would provide expedited and No-Fee project support, permitting, inspections, and easements as required.



9

RiversideCA.gov

## PUBLIC INPUT / CONCERNS

1. Sewer Pump Station Location
2. Sewer Pump Station Odor Control and Noise Level
3. Sewer Pump Station Redundancy to minimize failures
4. Impacts to the Neighborhood and Woodcrest Elementary School
5. Annexation of segments of County of Riverside
6. Use of Bond funds to construct the project



10

RiversideCA.gov

## PUBLIC INPUT / CONCERNS

7. Why should the City service County customers?
8. What are some of the primary benefits of the project?
9. Does the project make financial sense; what is the return on investment?
10. Can we request the County to financially contribute toward the project?
11. Can a Community Facilities District (CFD) fund the project?
12. How do City rate payers benefit from this project?



11

RiversideCA.gov

## SEWER PUMP STATION RENDERING

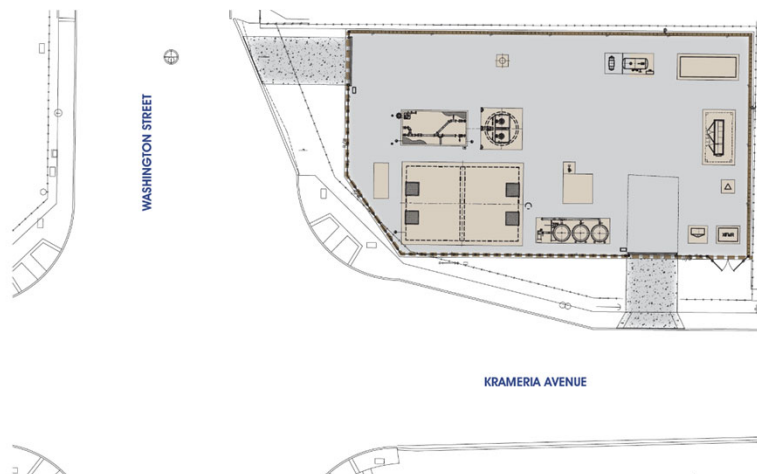

CONCEPTUAL SITE PLAN  
SCALE: 1" = 10'-0"

12



RiversideCA.gov

## SEWER PUMP STATION RENDERINGS



13



RiversideCA.gov

## SEWER PUMP STATION RENDERINGS



EXISTING SITE PERSPECTIVE 2



CONCEPTUAL SITE PERSPECTIVE 2

14



RiversideCA.gov

## SEWER PUMP STATION RENDERINGS



15



RiversideCA.gov

## NEXT STEPS / TIMELINE

1. City Council to approve the purchase of the sewer pump station lot in order for SCE to complete the electrical service design. Anticipated in November 2020.
2. Finalize the Plans, Specifications, and Estimate (PS&E) for the project by December 2020.
3. Bid and Award the Project by late Spring 2021.
4. Construction is estimated to be completed within 18-24 months after commencement.

16



RiversideCA.gov



## RECOMMENDATION

That the Mobility and Infrastructure Committee:

1. Receive and file the Van Buren Boulevard Sewer Installation Project Update; and
2. Recommend that City Council approve the purchase of the vacant lot at 16476 Washington Street to construct the Krameria Sewer Pump Station.



17

RiversideCA.gov