

GENERAL NOTES:

1. ALL EXTERIOR LIGHTING SHALL BE CONTROLLED VIA LIGHTING CONTROL PANEL WITH ASTRONOMICAL TIME CLOCK.
2. COORDINATE ALL EXTERIOR LIGHTING FIXTURE MOUNTING HEIGHTS WITH ARCHITECT & OWNER.
3. ALL EMERGENCY SHADED FIXTURES SHALL BE CONNECTED TO EMERGENCY INVERTER FOR EXTERIOR LIGHTING AND PRODUCE A MINIMUM OF 90 MIN EMERGENCY OPERATION.
4. REFER TO EXTERIOR LIGHTING FIXTURE SCHEDULE ON SHEET LTG-1.1 FOR TYPICAL FIXTURE MOUNTING HEIGHTS.

KEY NOTES:

1. INSTALL WALL PACK (WP1) CENTERED ABOVE SIGN LIGHT (OL2) AT HEIGHTS SPECIFIED ON LTG-1.1

LIGHTING CONSULTANT

JSA
JS & ASSOCIATES

535 PRINCELAND COURT
CORONA CA 92879
P: 951.340.2475
JSASSOCIATESINC.COM

COPYRIGHT NOTICE:

ALL DRAWINGS AND WRITTEN MATERIALS APPEARING HEREIN CONSTITUTE THE ORIGINAL UNPUBLISHED WORK OF JS & ASSOCIATES SERVICES AND THE SAME MAY NOT BE DUPLICATED, USED OR DISCLOSED WITHOUT THE EXPRESS WRITTEN CONSENT OF JS & ASSOCIATES.

OWNER:

GREENS
ATMAN KADAKIA
GREENS GROUP, INC.
9288 RESEARCH DRIVE
IRVINE, CALIFORNIA 92618
P: 949.829.4900 | C: 949.322.1760

PROJECT:



Residence Inn
Marriott

AC+RI
RIVERSIDE
3486 MISSION INN
RIVERSIDE, CA

DESCRIPTION

SITE LIGHTING & PHOTOMETRICS

DATE

2020.07.17

PRELIMINARY



NOT FOR
CONSTRUCTION

DRAWN BY: S.G.

CHECKED BY: J.S.

SCALE: AS SHOWN

SHEET TITLE:

SITE
LIGHTING PLAN

SHEET NO.:

LTG-1.0

AC+RESIDENCE-INN_RIVERSIDE_SITE 7/17/2020 11:24 AM

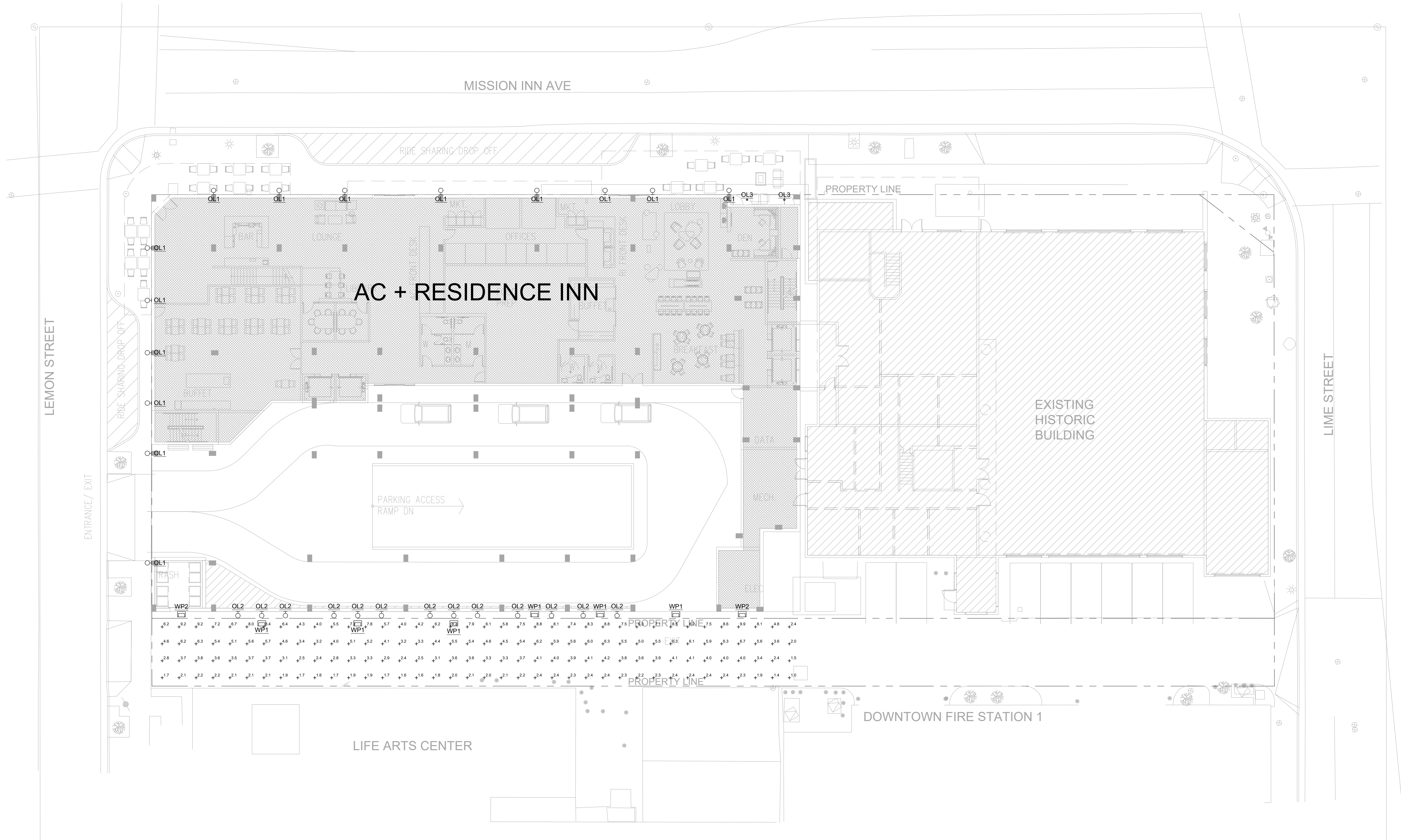

1 SITE PHOTOMETRICS
SCALE: 1/16" = 1'-0"

GENERAL NOTES:

1. CALCULATION ZONE @ ALLEY IS A 5'X5' GRID.

PHOTOMETRIC STATISTICS:

Location	Symbol	Avg	Max	Min	Max/Min	Avg/Min
Alley	+	4.4 fc	9.9 fc	1.0 fc	9.9:1	4.4:1

FIXTURE SCHEDULE:

OL1		LED GOOSENECK LIGHT 16W, 4000K, 1250 Lm @ 8'-0" A.F.G.
OL2		LED GOOSENECK SIGN LIGHT 27W, 4000K, 2000 Lm @ 9'-0" A.F.G.
OL3		
WP1		SLIM WALL PACK 28W, 4000K, 3480 Lm @ 14'-0" A.F.G.
WP2		SLIM WALL PACK 45W, 4000K, 5400 Lm @ 14'-0" A.F.G.

LIGHTING CONSULTANT

JSA

JS & ASSOCIATES

535 PRINCELAND COURT
CORONA CA 92879
P: 951.340.2475
JSASSOCIATESINC.COM

COPYRIGHT NOTICE:
ALL DRAWINGS AND WRITTEN MATERIALS APPEARING HEREIN CONSTITUTE THE ORIGINAL UNPUBLISHED WORK OF JS & ASSOCIATES SERVICES AND THE SAME MAY NOT BE DUPLICATED, USED OR DISCLOSED WITHOUT THE EXPRESS WRITTEN CONSENT OF JS & ASSOCIATES.

OWNER:

GREENS

ATMAN KADAKIA
GREENS GROUP, INC.
9289 RESEARCH DRIVE
IRVINE, CALIFORNIA 92618
P: 949.829.4900 | C: 949.322.1760

PROJECT:

AC HOTELS

Residence Inn

Marriott

AC+RI
RIVERSIDE
3486 MISSION INN
RIVERSIDE, CA

DESCRIPTION	SITE LIGHTING & PHOTOMETRICS				
DATE	2020.07.17				

PRELIMINARY

NOT FOR CONSTRUCTION

DRAWN BY:	S.G.
CHECKED BY:	J.S.
SCALE:	AS SHOWN
SHEET TITLE:	SITE PHOTOMETRICS
SHEET NO.:	LTG-1.1

GOOSENECK LIGHTING

MKT-0016, REV B

Timeless and practical, our vast selection of gooseneck arms provides the perfect angle and style for any setting. The curved arms evoke classic light styles while helping the shade direct light onto sidewalks, signs and more. Each gooseneck arm is crafted in our Florida-based manufacturing facility! Please Note: Select gooseneck arms cannot be used with certain designs and shades. For additional information, please visit the individual product listing. Additionally, gooseneck arms indicated with an asterisk are not available in copper and brass finishes.

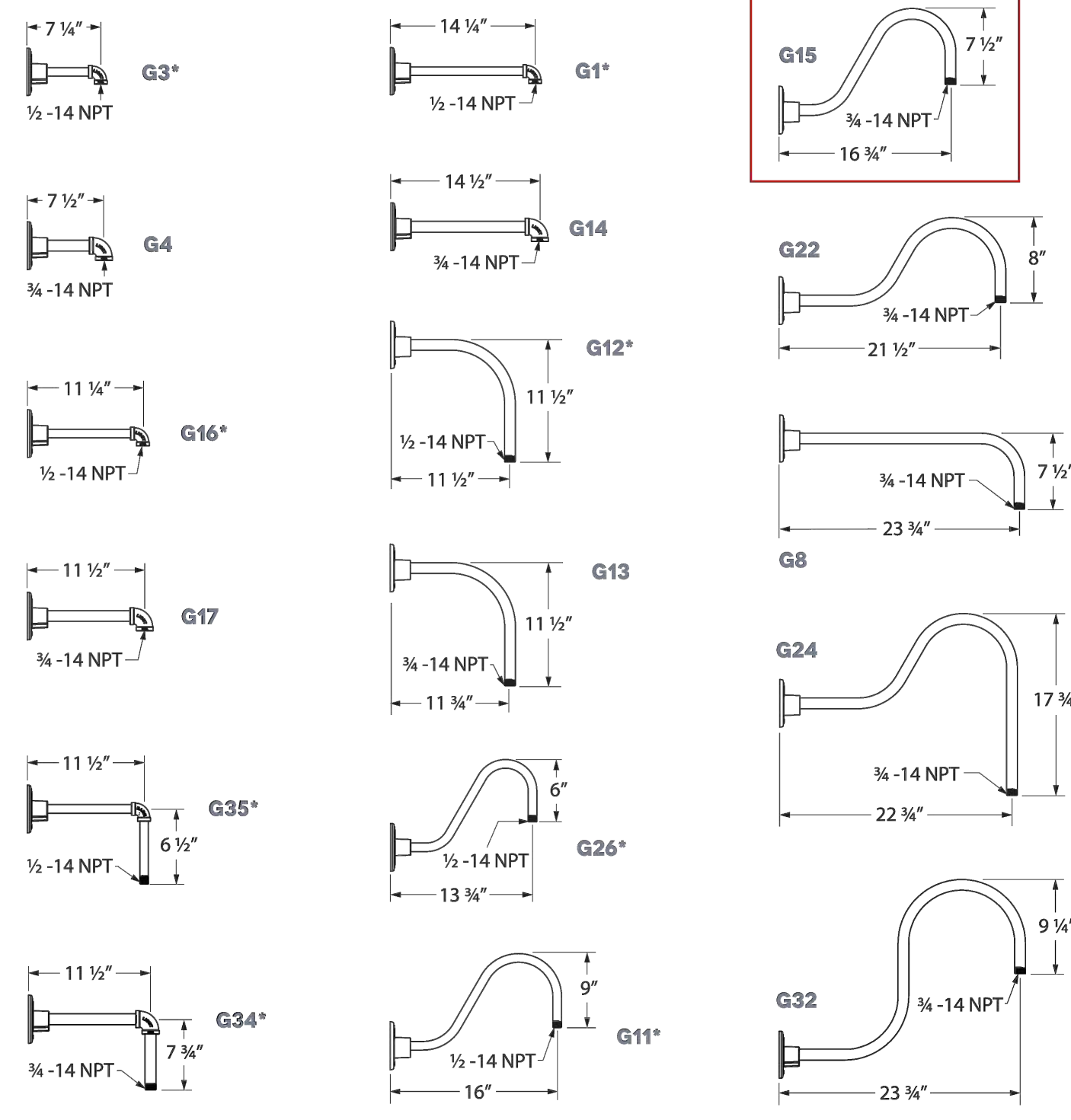

SALES@BARNLIGHT.COM (800) 407-8784 320 KNOX MCRAE DRIVE, TITUSVILLE, FL 32780 BARNLIGHT.COM

SPS-0489 REV A
DOMINION INTEGRATED LED SERIES
 JOB NAME: AC + RESIDENCE INN - RIVERSIDE FIXTURE TYPE: OL1

BLE - G - SBD14 - 100 - G15 - 100 - NA - NA - G -

NA - NA - LED16 - 4000K - FL - L

Order Example: BLE - F - SBD14 - 301 - FM - 307 - NA - WC - 700 - LED16 - 2700K - DL

A - MOUNTING STYLE	C - SHADE FINISH (CONTINUED)	D - MOUNTING (CONTINUED)	I - MOUNTING ACCESSORY
Cord Hung CN Chain Hung F Flush Mount G Gooseneck S Stem Mount	POWDER COAT FINISHES*: 700 Lavender 800 Industrial Grey 805 Charcoal Granite 810 Graphite 975 Galvanized 995 Raw Copper 996 Weathered Copper 997 Raw Brass 998 Weathered Brass 999 Oil-Rubbed Copper	STEM MOUNT OPTIONS: ST506 2" Stem Mount, 6" ST512 2" Stem Mount, 12" ST518 2" Stem Mount, 18" ST524 2" Stem Mount, 24" ST536 2" Stem Mount, 36" ST548 2" Stem Mount, 48" ST706 2.5" Stem Mount, 6" ST712 2.5" Stem Mount, 12" ST718 2.5" Stem Mount, 18" ST724 2.5" Stem Mount, 24" ST736 2.5" Stem Mount, 36" ST748 2.5" Stem Mount, 48"	Please Note: Mounting Accessories below are only available with select Mounting Styles. Please refer to product listings on our website for further detail. NA None/Not Applicable HSC Hang Strap/Canopy* LDBPC LED Decorative Backing Plate Cover* LDCHX LED Decorative Backing Plate Cover & Hex Cover*
B - SHADE SIZE DOMINION: SBD12 SBD14 SBD16	NATURAL METALS*: 995 Raw Copper 996 Weathered Copper 997 Raw Brass 998 Weathered Brass 999 Oil-Rubbed Copper	D - MOUNTING Please Note: If Flush Mount (F) is selected in Section A, please select NA. NA Not Applicable	J - LIGHT SOURCE LED11 850 Lumens, 11W LED LED16 1250 Lumens, 16W LED LED27 2000 Lumens, 27W LED LED38 3000 Lumens, 38W LED LED43 4000 Lumens, 43W LED
C - SHADE FINISH PORCELAIN FINISHES*: 150 Black 250 White 350 Vintage Green 355 Jadeite 455 Cherry Red 450 Yellow 650 Bronze 750 Cobalt Blue 765 Delphite Blue 850 Graphite 950 Metallic Chrome 1000 Powder Coat Finishes*: 105 Black 200 Textured Black 300 White 305 Dark Green 307 Emerald Green 311 Jadeite 370 Mint 380 Chantreuse 390 Teal 400 Barn Red 420 Orange 470 Watermelon 480 Blush Pink 490 Magenta 495 Sherbet Orange 500 Buttery Yellow 570 Sunflower 600 Bronze 601 Chocolate 605 Rust 615 Oil-Rubbed Bronze 700 Royal Blue 705 Navy 710 Cobalt Blue 715 Delphite Blue	D - MOUNTING Please Note: If Flush Mount (F) is selected in Section A, please select NA. NA Not Applicable	E - MOUNTING FINISH Please Note: See Section C for Finish Options. 980 Brushed Aluminum is also available for Gooseneck and Stem Mounting Styles. (If) If Powder Coat finished-to-match, Powder Coat shades feature are not available with a Natural Metal mounting style. (If) If Chain Hung (CN) Mounting Style, selection identifies arms and canopy finish. Natural Metals are not available. (If) If Stem Mount (SM) Mounting Style, selection identifies arms and canopy finish. Natural Metals are not available. (If) If Flush Mount (F) Mounting Style, selection identifies hex cover and canopy finish. Natural Metals are not available. 980 Brushed Aluminum	K - COLOR TEMPERATURE 2700K 2700K, Warm White 3000K 3000K, Neutral White 3500K 3500K, Bright White 4000K 4000K, Cool White
CSA LISTED CORDS: SBR Standard Black SWH Standard White CSB Black Cloth CSW White Cloth CMG Grey Cloth CSR Red Cloth CRZ Red Chevron Cloth CSBW Black & Brown Cloth CSBW Black & White Cloth CSGW Gold & White Cloth CSBG Black & Gold Cloth CSBW Black & White Cloth CSBP Black & Pink Cloth CSBW Blue & White Cloth 370 Mint 380 Chantreuse 390 Teal 400 Barn Red 420 Orange 470 Watermelon 480 Blush Pink 490 Magenta 495 Sherbet Orange 500 Buttery Yellow 570 Sunflower 600 Bronze 601 Chocolate 605 Rust 615 Oil-Rubbed Bronze 700 Royal Blue 705 Navy 710 Cobalt Blue 715 Delphite Blue	CSA LISTED CORDS: SBR Standard Black SWH Standard White CSB Black Cloth CSW White Cloth CMG Grey Cloth CSR Red Cloth CRZ Red Chevron Cloth CSBW Black & Brown Cloth CSBW Black & White Cloth CSGW Gold & White Cloth CSBG Black & Gold Cloth CSBW Black & White Cloth CSBP Black & Pink Cloth CSBW Blue & White Cloth 370 Mint 380 Chantreuse 390 Teal 400 Barn Red 420 Orange 470 Watermelon 480 Blush Pink 490 Magenta 495 Sherbet Orange 500 Buttery Yellow 570 Sunflower 600 Bronze 601 Chocolate 605 Rust 615 Oil-Rubbed Bronze 700 Royal Blue 705 Navy 710 Cobalt Blue 715 Delphite Blue	F - CORDS: NA Not Applicable Please Note: See Section D for all applicable CSA Listed Cord Options	L - LED LENS DL Domed Lens FL Flat Lens
GOOSENECK OPTIONS: G1 G1* G2* G3* G4* G5* G6* G7* G8* G9* G10* G11* G12* G13* G14* G15* G16* G17* G18* G19* G20* G21* G22* G23* G24* G25* G26* G27* G28* G29* G30* G31* G32* G33* G34* G35* G36* G37* G38* G39* G40* G41* G42* G43* G44* G45* G46* G47* G48* G49* G50* G51* G52* G53* G54* G55* G56* G57* G58* G59* G60* G61* G62* G63* G64* G65* G66* G67* G68* G69* G70* G71* G72* G73* G74* G75* G76* G77* G78* G79* G80* G81* G82* G83* G84* G85* G86* G87* G88* G89* G90* G91* G92* G93* G94* G95* G96* G97* G98* G99* G100* G101* G102* G103* G104* G105* G106* G107* G108* G109* G110* G111* G112* G113* G114* G115* G116* G117* G118* G119* G120* G121* G122* G123* G124* G125* G126* G127* G128* G129* G130* G131* G132* G133* G134* G135* G136* G137* G138* G139* G140* G141* G142* G143* G144* G145* G146* G147* G148* G149* G150* G151* G152* G153* G154* G155* G156* G157* G158* G159* G160* G161* G162* G163* G164* G165* G166* G167* G168* G169* G170* G171* G172* G173* G174* G175* G176* G177* G178* G179* G180* G181* G182* G183* G184* G185* G186* G187* G188* G189* G190* G191* G192* G193* G194* G195* G196* G197* G198* G199* G200* G201* G202* G203* G204* G205* G206* G207* G208* G209* G210* G211* G212* G213* G214* G215* G216* G217* G218* G219* G220* G221* G222* G223* G224* G225* G226* G227* G228* G229* G230* G231* G232* G233* G234* G235* G236* G237* G238* G239* G240* G241* G242* G243* G244* G245* G246* G247* G248* G249* G250* G251* G252* G253* G254* G255* G256* G257* G258* G259* G260* G261* G262* G263* G264* G265* G266* G267* G268* G269* G270* G271* G272* G273* G274* G275* G276* G277* G278* G279* G280* G281* G282* G283* G284* G285* G286* G287* G288* G289* G290* G291* G292* G293* G294* G295* G296* G297* G298* G299* G300* G301* G302* G303* G304* G305* G306* G307* G308* G309* G310* G311* G312* G313* G314* G315* G316* G317* G318* G319* G320* G321* G322* G323* G324* G325* G326* G327* G328* G329* G330* G331* G332* G333* G334* G335* G336* G337* G338* G339* G340* G341* G342* G343* G344* G345* G346* G347* G348* G349* G350* G351* G352* G353* G354* G355* G356* G357* G358* G359* G360* G361* G362* G363* G364* G365* G366* G367* G368* G369* G370* G371* G372* G373* G374* G375* G376* G377* G378* G379* G380* G381* G382* G383* G384* G385* G386* G387* G388* G389* G390* G391* G392* G393* G394* G395* G396* G397* G398* G399* G400* G401* G402* G403* G404* G405* G406* G407* G408* G409* G410* G411* G412* G413* G414* G415* G416* G417* G418* G419* G420* G421* G422* G423* G424* G425* G426* G427* G428* G429* G430* G431* G432* G433* G434* G435* G436* G437* G438* G439* G440* G441* G442* G443* G444* G445* G446* G447* G448* G449* G450* G451* G452* G453* G454* G455* G456* G457* G458* G459* G460* G461* G462* G463* G464* G465* G466* G467* G468* G469* G470* G471* G472* G473* G474* G475* G476* G477* G478* G479* G480* G481* G482* G483* G484* G485* G486* G487* G488* G489* G490* G491* G492* G493* G494* G495* G496* G497* G498* G499* G500* G501* G502* G503* G504* G505* G506* G507* G508* G509* G510* G511* G512* G513* G514* G515* G516* G517* G518* G519* G520* G521* G522* G523* G524* G525* G526* G527* G528* G529* G530* G531* G532* G533* G534* G535* G536* G537* G538* G539* G540* G541* G542* G543* G544* G545* G546* G547* G548* G549* G550* G551* G552* G553* G554* G555* G556* G557* G558* G559* G560* G561* G562* G563* G564* G565* G566* G567* G568* G569* G570* G571* G572* G573* G574* G575* G576* G577* G578* G579* G580* G581* G582* G583* G584* G585* G586* G587* G588* G589* G590* G591* G592* G593* G594* G595* G596* G597* G598* G599* G600* G601* G602* G603* G604* G605* G606* G607* G608* G609* G610* G611* G612* G613* G614* G615* G616* G617* G618* G619* G620* G621* G622* G623* G624* G625* G626* G627* G628* G629* G630* G631* G632* G633* G634* G635* G636* G637* G638* G639* G640* G641* G642* G643* G644* G645* G646* G647* G648* G649* G650* G651* G652* G653* G654* G655* G656* G657* G658* G659* G660* G661* G662* G663* G664* G665* G666* G667* G668* G669* G670* G671* G672* G673* G674* G675* G676* G677* G678* G679* G680* G681* G682* G683* G684* G685* G686* G687* G688* G689* G690* G691* G692* G693* G694* G695* G696* G697* G698* G699* G700* G701* G702* G703* G704* G705* G706* G707* G708* G709* G710* G711* G712* G713* G714* G715* G716* G717* G718* G719* G720* G721* G722* G723* G724* G725* G726* G727* G728* G729* G730* G731* G732* G733* G734* G735* G736* G737* G738* G739* G740* G741* G742* G743* G744* G745* G746* G747* G748* G749* G750* G751* G752* G753* G754* G755* G756* G757* G758* G759* G760* G761* G762* G763* G764* G765* G766* G767* G768* G769* G770* G771* G772* G773* G774* G775* G776* G777* G778* G779* G780* G781* G782* G783* G784* G785* G786* G787* G788* G789* G790* G791* G792* G793* G794* G795* G796* G797* G798* G799* G800* G801* G802* G803* G804* G805* G806* G807* G808* G809* G810* G811* G812* G813* G814* G815* G816* G817* G818* G819* G820* G821* G822* G823* G824* G825* G826* G827* G828* G829* G830* G831* G832* G833* G834* G835* G836* G837* G838* G839* G840* G841* G842* G843* G844* G845* G846* G847* G848* G849* G850* G851* G852* G853* G854* G855* G856* G857* G858* G859* G860* G861* G862* G863* G864* G865* G866* G867* G868* G869* G870* G871* G872* G873* G874* G875* G876* G877* G878* G879* G880* G881* G882* G883* G884* G885* G886* G887* G888* G889* G890* G891* G892* G893* G894* G895* G896* G897* G898* G899* G900* G901* G902* G903* G904* G905* G906* G907* G908* G909* G910* G911* G912* G913* G914* G915* G916* G917* G918* G919* G920* G921* G922* G923* G924* G925* G926* G927* G928* G929* G930* G931* G932* G933* G934* G935* G936* G937* G938* G939* G940* G941* G942* G943* G944* G945* G946* G947* G948* G949* G950* G951* G952* G953* G954* G955* G956* G957* G958* G959* G960* G961* G962* G963* G964* G965* G966* G967* G968* G969* G970* G971* G972* G973* G974* G975* G976* G977* G978* G979* G980* G981* G982* G983* G984* G985* G986* G987* G988* G989* G990* G991* G992* G993* G994* G995* G996* G997* G998* G999* G1000* G1001* G1002* G1003* G1004* G1005* G1006* G1007* G1008* G1009* G1010* G1011* G1012* G1013* G1014* G1015* G1016* G1017* G1018* G1019* G1020* G1021* G1022* G1023* G1024* G1025* G1026* G1027* G1028* G1029* G1030* G1031* G1032* G1033* G1034* G1035* G1036* G1037* G1038* G1039* G1040* G1041* G1042* G1043* G1044* G1045* G1046* G1047* G1048* G1049* G1050* G1051* G1052* G1053* G1054* G1055* G1056* G1057* G1058* G1059* G1060* G1061* G1062* G1063* G1064* G1065* G1066* G1067* G1068* G1069* G1070* G1071* G1072* G1073* G1074* G1075* G1076* G1077* G1078* G1079* G1080* G1081* G1082* G1083* G1084* G1085* G1086* G1087* G1088* G1089* G1090* G1091* G1092* G1093* G1094* G1095* G1096* G1097* G1098* G1099* G1100* G1101* G1102* G1103* G1104* G1105* G1106* G1107* G1108* G1109* G1110* G1111* G1112* G1113* G1114* G1115* G1116* G1117* G1118* G1119* G1120* G1121* G1122* G1123* G1124* G1125* G1126* G1127* G1128* G1129* G1130* G1131* G1132* G1133* G1134* G1135* G1136* G1137* G1138* G1139* G1140* G1141* G1142* G1143* G1144* G1145* G1146* G1147* G1148* G1149* G1150* G1151* G1152* G1153* G1154* G1155* G1156* G1157* G1158* G1159* G1160* G1161* G1162* G1163* G1164* G1165* G1166* G1167* G1168* G1169* G1170* G1171* G1172* G1173* G1174* G1175* G1176* G1177* G1178* G1179* G1180* G1181* G1182* G1183* G1184* G1185* G1186* G1187* G1188* G1189* G1190* G1191* G1192* G1193* G1194* G1195* G1196* G1197* G1198* G1199* G1200* G1201* G1202* G1203* G1204* G1205* G1206* G1207* G1208* G1209* G1210* G1211* G1212* G1213* G1214* G1215* G1216* G1217* G1218* G1219* G1220* G1221* G1222* G1223* G1224* G1225* G1226* G1227* G1228* G1229* G1230* G1231* G1232* G1233* G1234* G1235* G1236* G1237* G1238* G1239* G1240* G1241* G1242* G1243* G1244* G1245* G1246* G1247* G1248* G1249* G1250* G1251* G1252* G1253* G1254* G1255* G1256* G1257* G1258* G1259* G1260* G1261* G1262* G1263* G1264* G1265* G1266* G1267* G1268* G1269* G1270* G1271* G1272* G1273* G1274* G1275* G1276* G1277* G1278* G1279* G1280* G1281* G1282* G1283* G1284* G1285* G1286* G1287* G1288* G1289* G1290* G1291* G1292* G1293* G1294* G1295* G1296* G1297* G1298* G1299* G1300* G1301* G1302* G1303* G1304* G1305* G1306* G1307* G1308* G1309* G1310* G1311* G1312* G1313* G1314* G1315* G1316* G1317* G1318* G1319* G1320* G1321* G1322* G1323* G1324* G1325* G1326* G1327* G1328* G1329* G1330* G1331* G1332* G1333* G1334* G1335* G1336* G1337* G1338* G1339* G1340* G1341* G1342* G1343* G1344* G1345* G1346* G1347* G1348* G1349* G1350* G1351* G1352* G1353* G1354* G1355* G1356* G1357* G1358* G1359* G1360* G1361* G1362* G1363* G1364* G1365* G1366* G1367* G1368* G1369* G1370* G1371* G1372* G1373* G1374* G1375* G1376* G1377* G1378* G1379* G1380* G1381* G1382* G1383* G1384* G1385* G1386* G1387* G1388* G1389* G1390* G1391* G1392* G1393* G1394* G1395* G1396* G1397* G1398* G1399* G1400* G1401* G1402* G1403* G1404* G1405* G1406* G1407* G1408* G1409* G1410* G1411* G1412* G1413* G1414* G1415* G1416* G1417* G1418* G1419* G1420* G1421* G1422* G1423* G1424* G1425* G1426* G1427* G1428* G1429* G1430* G1431* G1432* G1433* G1434* G1435* G1436* G1437* G1438* G1439* G1440* G1441* G1442* G1443* G1444* G1445* G1446* G1447* G1448* G1449* G1450* G1451* G1452* G1453* G1454* G1455* G1456* G1457* G1458* G1459* G1460* G1461* G1462* G1463* G1464* G1465* G1466* G1467* G1468* G1469* G1470* G1471* G1472* G1473* G1474* G1475* G1476* G1477* G1478* G1479* G1480* G1481* G1482* G1483* G1484* G1485* G1486* G1487* G1488* G1489* G1490* G1491* G1492* G1493* G1494* G1495* G1496* G1497* G1498* G1499* G1500* G1501* G1502* G1503* G1504* G1505* G1506* G1507* G1508* G1509* G1510* G1511* G1512* G1513* G1514* G1515* G1516* G1517* G1518* G1519* G1520* G1521* G1522* G1523* G1524* G1525* G1526* G1527* G1528* G1529* G1530* G1531* G1532* G1533* G1534* G1535* G1536* G1537* G1538* G1539* G1540* G1541* G1542* G1543* G1544* G1545* G1546* G1547* G1548* G1549* G1550* G1551* G1552* G1553* G1554* G1555* G1556* G1557* G1558* G1559* G1560* G1561* G1562* G1563* G1564* G1565* G1566* G1567* G1568* G1569* G1570* G1571* G1572* G1573* G1574* G1575* G1576* G1577* G1578* G1579* G1580* G1581* G1582* G1583* G1584* G1585* G1586* G1587* G1588* G1589* G1590* G1591* G1592* G1593* G1594* G1595* G1596* G1597* G1598* G1599* G1600* G1601* G1602* G1603* G1604* G1605* G1606* G1607* G1608* G1609* G1610* G1611* G1612* G1613* G1614* G1615* G1616* G1617* G1618* G1619* G1620* G1621* G1622* G1623* G1624* G1625* G1626* G1627* G1628* G1629* G1630* G1631* G1632* G1633* G1634* G1635* G1636* G1637* G1638* G1639* G1640* G1641* G1642* G1643* G1644* G1645* G1646* G1647* G1648* G1649* G1650* G1651* G1652* G1653* G1654* G1655* G1656* G1657* G1658* G1659* G1660* G1661* G1662* G1663* G1664* G1665* G1666* G1667* G1668* G1669* G1670* G1671* G1672* G1673* G1674* G1675* G1676* G1677* G1678* G1679* G1680* G1681* G1682* G1683* G1684* G1685* G1686* G1687* G1688* G1689* G1690* G1691* G1692* G1693* G1694* G1695* G1696* G1697* G1698* G1699* G1700* G1701* G1702* G1703* G1704* G1705* G1706* G1707* G1708* G1709* G1710* G1711* G1712* G1713* G1714* G1715* G1716* G1717* G1718* G1719* G1720* G1721* G1722* G1723* G1724* G1725* G1726* G1727* G1728* G1729* G1730* G1731* G1732* G1733* G1734* G1735* G1736* G1737* G1738* G1739* G1740* G1741* G1742* G1743* G1744* G1745* G1746* G1747* G1748* G1749* G1750* G1751* G1752* G1753* G1754* G1755* G1756* G1757* G1758* G1759* G1760* G1761* G1762* G1763* G1764* G1765* G1766* G1767* G1768* G1769* G1770* G1771* G1772* G1773* G1774* G1775* G1776* G1777* G1778* G1779* G1780* G1781* G1782* G1783* G1784* G1785* G1786* G1787* G1788* G1789* G1790* G1791* G1792* G1793* G1794* G1795* G1796* G1			

LED
4th

■ SLIM WALL PACK (SWP)

MOUNTING / ACCESSORIES

SOLD SEPARATELY

Slip Fitter

- **P10076 MT-SF-SWP/DB**
(Slip Fitter Dark Bronze)
- **P10007 MT-SF-SWP/BK**
(Slip Fitter Black)

 Bronze
 Black

Swivel Bracket

- **P10074 MT-SB-SWP/DB**
(Swivel Bracket Dark Bronze)
- **P10005 MT-SB-SWP/BK**
(Swivel Bracket Black)

 Bronze
 Black

Knuckle Mount

- **P10075 MT-KNC-SWP/DB**
(3/4" NPT Knuckle Mount Dark Bronze)
- **P10006 MT-KNC-SWP/BK**
(3/4" NPT Knuckle Mount Black)

 Bronze
 Black

Photocell

- **P10096 SEN-PHO-ST-M/V**
(Button Photocell 120-277V)

PHOTOMETRICS CHART

15 Watt

Beam Spread (°) vs. Illuminance (fc)

Beam Spread (°)	Illuminance (fc)
10	11.75
15	5.00
20	2.78
25	1.56
30	0.89
35	0.50
40	0.28
45	0.16
50	0.09
55	0.05
60	0.03
65	0.02
70	0.01
75	0.01
80	0.01
85	0.01
90	0.01
95	0.01
100	0.01
105	0.01
110	0.01
115	0.01
120	0.01
125	0.01
130	0.01
135	0.01
140	0.01
145	0.01
150	0.01
155	0.01
160	0.01
165	0.01
170	0.01
175	0.01
180	0.01

28 Watt

Beam Spread (°) vs. Illuminance (fc)

Beam Spread (°)	Illuminance (fc)
10	20.00
15	8.89
20	4.76
25	2.67
30	1.48
35	0.83
40	0.47
45	0.27
50	0.15
55	0.08
60	0.05
65	0.03
70	0.02
75	0.01
80	0.01
85	0.01
90	0.01
95	0.01
100	0.01
105	0.01
110	0.01
115	0.01
120	0.01
125	0.01
130	0.01
135	0.01
140	0.01
145	0.01
150	0.01
155	0.01
160	0.01
165	0.01
170	0.01
175	0.01
180	0.01

45 Watt

Beam Spread (°) vs. Illuminance (fc)

Beam Spread (°)	Illuminance (fc)
10	40.00
15	17.78
20	9.52
25	5.26
30	2.96
35	1.63
40	0.93
45	0.52
50	0.29
55	0.16
60	0.09
65	0.05
70	0.03
75	0.02
80	0.01
85	0.01
90	0.01
95	0.01
100	0.01
105	0.01
110	0.01
115	0.01