

$$1/2^0 = 140^0$$
$$1/4^{\circ} = 14$$
$$1/4^{\theta} = 1/4^{\theta}$$
 $1/4^{\circ} = 15'$

**McKently
Malak**
ARCHITECTS

35 Hugus Alley Suite 200
Pasadena California 91103-3648
TEL 626 583 8348 FAX 626 583 8387

A PROJECT FOR:



133 PENN STREET
EL SEGUNDO, CALIFORNIA 90245
TEL. 310-807-3375

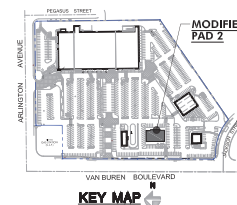

PHASE 2

Arlington @ Van Buren Plaza

6161 Van Buren Blvd.

SEC Van Buren Blvd. & Arlington Ave.
Riverside, California 92503

ISSUES / REVISIONS

[illegible]

AS INSTRUMENTS OF SERVICE, ALL DESIGNS, IDEAS, AND INFORMATION SHOWN ON THESE DRAWINGS ARE AND SHALL REMAIN THE PROPERTY OF MCKENTLY + ASSOCIATES. NO PART THEREOF SHALL BE COPIED, DISCLOSED TO OTHERS, OR USED IN CONNECTION WITH ANY WORK OR PROJECT OTHER THAN THE SPECIFIC PROJECT FOR WHICH THEY HAVE BEEN PREPARED AND DEVELOPED WITHOUT THE WRITTEN CONSENT OF MCKENTLY + ASSOCIATES. VISUAL CONTACT WITH THESE DRAWINGS SHALL CONSTITUTE CONCLUSIVE EVIDENCE OF ACCEPTANCE OF THESE RESTRICTIONS.

JOB NUMBER: 20055MMA

DRAWN BY: _____ CHECKED BY: H.M.

DATE: 03.23.2021

SHEET DESCRIPTION:

TRASH ENCLOSURE ENLARGED FLOOR PLAN ELEVATION AND SECTION

SHEET NUMBER:

A012

BASED ON SCHEME SP-16

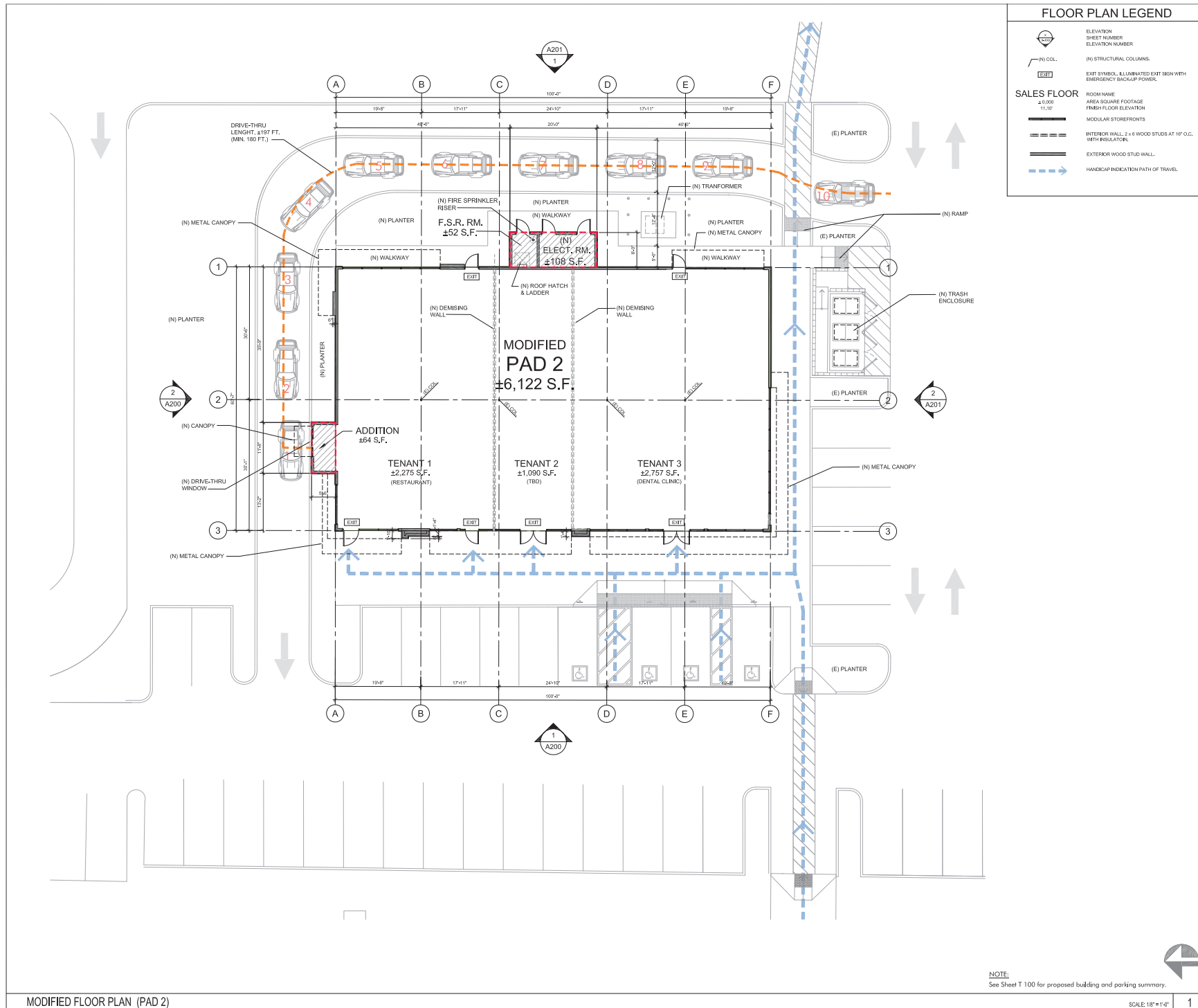

McKently Malak ARCHITECTS

35 Hugue Alley Suite 200
Pasadena California 91103-6648
TEL 626 883 8348 FAX 626 883 8387

A PROJECT FOR:

PARAGON
COMMERCIAL GROUP LLC

133 PENN STREET
EL SEGUNDO, CALIFORNIA 90245
TEL. 310-807-3375

KEY MAP

PHASE 2

Arlington @ Van Buren Plaza

6161 Van Buren Blvd.
SEC Van Buren Blvd. & Arlington Ave.
Riverside, California 92503

ISSUES / REVISIONS

No.	DATE	DESCRIPTION
01	02.12.2021	DESIGN REVIEW SUBMITTAL-PHASE 2
02	03.29.2021	DESIGN REVIEW RESUBMITTAL-PHASE 2

AS INSTRUMENTS OF SERVICE, ALL DESIGNS, IDEAS, AND INFORMATION SHOWN ON THESE DRAWINGS ARE AND SHALL REMAIN THE PROPERTY OF MCKENTLY + ASSOCIATES. NO PART THEREOF SHALL BE COPIED, REPRODUCED TO OTHERS, OR USED IN CONNECTION WITH ANY WORK OR PROJECT OTHER THAN THE SPECIFIC PROJECT FOR WHICH THEY HAVE BEEN PREPARED AND DEDICATED. WITHOUT THE WRITTEN CONSENT OF MCKENTLY + ASSOCIATES, NEITHER CONTRACT NOR THESE DRAWINGS SHALL CONSTITUTE CONCLUSIVE EVIDENCE OF ACCEPTANCE OF THESE RESTRICTIONS.

JOB NUMBER: 20055MMA
DRAWN BY: CHECKED BY: H.M.
DATE: 03.23.2021
SHEET DESCRIPTION:

MODIFIED FLOOR PLAN (PAD 2)

SHEET NUMBER:

A100

BASED ON SCHEME SP-16

ROOF PLAN LEGEND

- ELEVATION
SHEET NUMBER
ELEVATION NUMBER
- TOP OF PARAPET
- ROOF DRAIN AND OVERFLOW
- HVAC

**McKently
Malak
ARCHITECTS**

35 HUGO ALLEY, SUITE 200
PASADENA, CALIFORNIA 91103-5648
TEL 626 883 8348 FAX 626 883 8387

A PROJECT FOR:



133 PENN STREET
EL SEGUNDO, CALIFORNIA 90245
TEL 310-807-3375

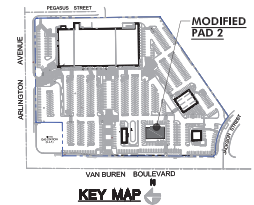

PHASE 2

Arlington @ Van Buren Plaza
6161 Van Buren Blvd.
SEC Van Buren Blvd. & Arlington Ave.
Riverside, California 92503

ISSUES / REVISIONS

No.	DATE	DESCRIPTION
01	02.12.2021	DESIGN REVIEW SUBMITTAL-PHASE 2
02	03.29.2021	DESIGN REVIEW RESUBMITTAL-PHASE 2

AS INSTRUMENTS OF SERVICE, ALL DESIGNS, IDEAS, AND INFORMATION SHOWN ON THESE DRAWINGS ARE AND SHALL REMAIN THE PROPERTY OF MCKENTLY + ASSOCIATES. NO PART THEREOF SHALL BE COPIED, REPRODUCED, OR USED IN CONNECTION WITH ANY WORK OR PROJECT OTHER THAN THE SPECIFIC PROJECT FOR WHICH THEY HAVE BEEN PREPARED AND DEDICATED. WITHOUT THE WRITTEN CONSENT OF MCKENTLY + ASSOCIATES, NO CONTRACT HEREIN THESE DRAWINGS SHALL CONSTITUTE CONCLUSIVE EVIDENCE OF ACCEPTANCE OF THESE RESTRICTIONS.

JOB NUMBER: 20055MMA
DRAWN BY: CHECKED BY: H.M.
DATE: 03.23.2021
SHEET DESCRIPTION:

**MODIFIED ROOF PLAN
(PAD 2)**

SHEET NUMBER:
A130
BASED ON SCHEME SP-16

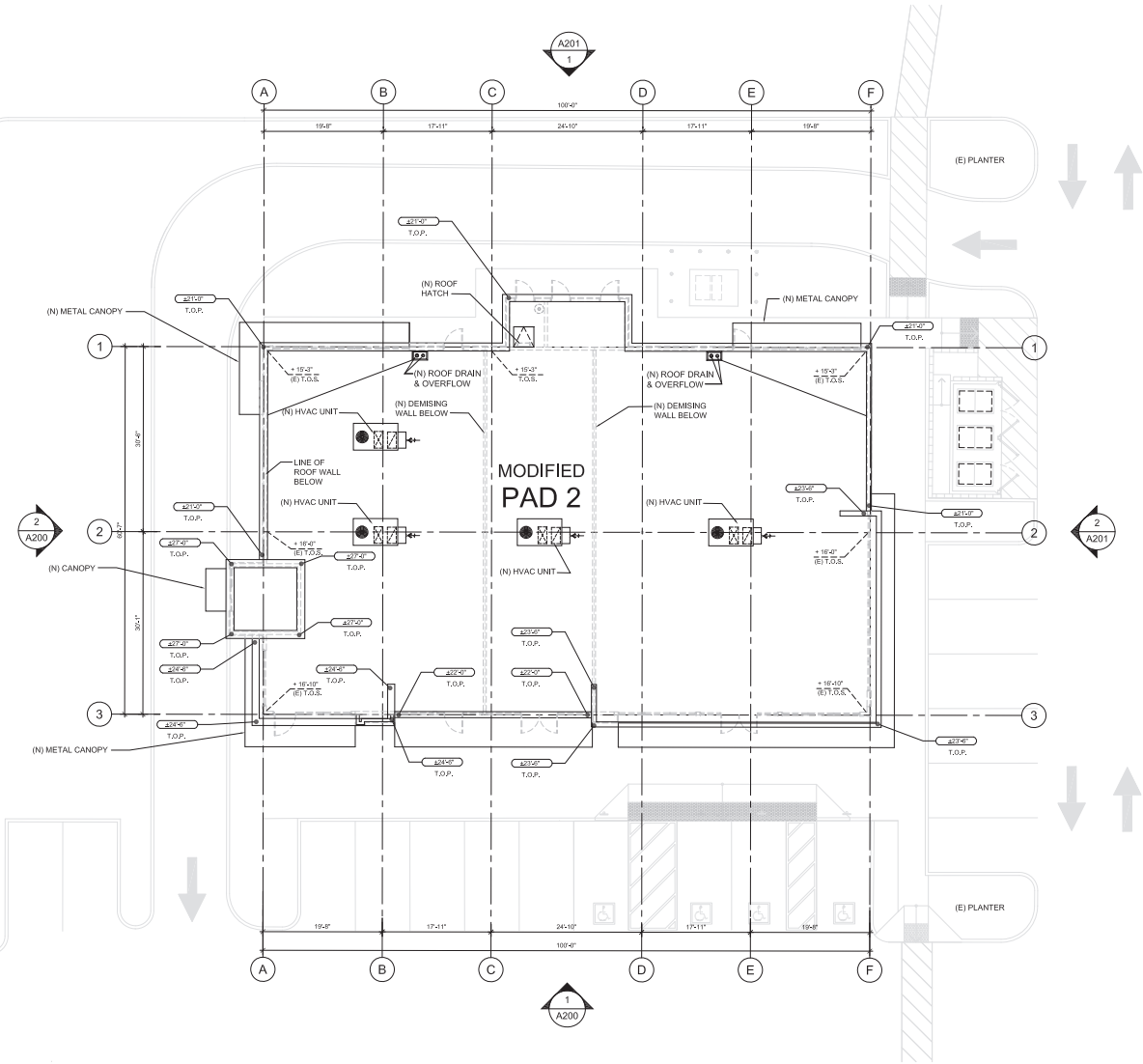

NOTE:
See Sheet T 100 for proposed building and parking summary.

SCALE: 1/8" = 1'-0"

1

MODIFIED ROOF PLAN (PAD 2)



--	--

BASED ON SCHEME SP-16