

**REIMBURSEMENT AGREEMENT
BY AND BETWEEN COGENT FIBER LLC AND CITY OF RIVERSIDE
FOR RELOCATION OF FIBER OPTIC CABLE FACILITIES RELATED TO CITY
THIRD STREET GRADE SEPARATION PROJECT**

THIS REIMBURSEMENT AGREEMENT (“Agreement”) is made and entered into and effective as of the date of the last signature on this Agreement and is by and between Cogent Fiber LLC, a Delaware limited liability company (fka Sprint Communications Company L.P.), and its successors and assigns (“Sprint”), whose mailing address is 2450 N Street, NW, 4th Floor, Washington, DC 20037, and the City of Riverside, a California charter city and municipal corporation (“City”) whose mailing address is 3900 Main Street, 4th Floor, Riverside, CA 92522. Sprint and City may be referred to individually as “Party” or collectively as the “Parties.”

BACKGROUND:

A. City is planning a grade separation project (“Project”) in the City of Riverside, California within Burlington Northern Santa Fe Railroad (“BNSF”) right of way (“ROW”) in the approximate area of Third Street and Commerce Streets, which Project may impact Sprint fiber optic cable and facilities located in the ROW. Sprint owns fiber optic cable within the ROW pursuant to a Memorandum of License Agreement with BNSF dated December 20, 1991.

B. As a result of the Project’s construction, it is necessary for Sprint to relocate its fiber optic cable facilities (“Facilities”) in accordance with, and as more particularly described in, the attached **Exhibit “A”** (“Engineering Drawing”) and **Exhibit “B”** (“Scope of Work”), both of which are attached hereto and incorporated herein by reference.

C. The Parties have previously executed a Preliminary Engineering Reimbursement Agreement (“PERA”) whereby City has prepaid Sprint \$143,928.00 relating to Sprint’s estimated costs to perform Preliminary Work (as defined in the PERA) necessary to accommodate the Project.

D. Sprint, under the terms stated in this Agreement, is willing to relocate its Facilities within the right of way and to accommodate Project work, if City reimburses Sprint for all of its actual costs, both direct and indirect, in performing the Relocation Work (defined herein).

AGREEMENT

In consideration of the promises and mutual covenants contained in this Agreement, and other good and valuable consideration the receipt and sufficiency of which is acknowledged, Sprint and City agree as follows:

1. Sprint will perform the necessary relocation work in accordance with the attached Exhibits “A” and “B” (together, “Relocation Work”) subject to the terms and provisions of this Agreement.

2. City represents and warrants to Sprint that Exhibits "A" and "B" accurately represent the Relocation Work requested of Sprint.

3. City may, at its own expense, inspect any construction by Sprint under this Agreement, to assure itself that the Relocation Work of Sprint is being performed in accordance with the Engineering Drawing and Scope of Work.

4. City will bear and be responsible for and pay in accordance herewith all direct and indirect costs incurred by Sprint and relating to the Relocation Work, including, but not limited to, preliminary engineering, labor, materials, construction, damages, administrative overhead, engineering review work, taxes, and legal fees.

5. The total cost of the Relocation Work is estimated to be \$1,203,543.00, as set forth in **Exhibit "C."** Final actual costs may be more or less than the estimate, which will not be construed as a limitation of costs for the Relocation Work. Sprint will promptly provide notice to City if it becomes obvious to Sprint that the final actual costs will exceed the estimate by more than twenty-five percent (25%).

6. Sprint shall be responsible for payment of all the Relocation Work costs as they are incurred. Within Forty-Five days (45) after Sprint pays invoices associated with the Relocation Work, Sprint may furnish an accounting of interim actual costs and provide City an invoice of the same. Each invoice shall be accompanied by detailed contractor invoices, or other demands for payment addressed to Sprint, and documents evidencing Sprint's payment of the invoices shall be retained for four (4) years and shall be made available for review by the City. City must pay the full amount of each such invoice within forty-five (45) days of receipt. Payments shall be sent to:

Sprint Communications Company L.P.
Cogent Fiber LLC
Attn: Walter Churaman
Cogent Communications
2450 N Street, NW Washington, DC 20037

7. All operations and work performed by City above or adjacent to the fiber optic cable location must be performed in a workmanlike and safe manner and in conformance with all applicable industry standards and government regulations, and in accordance with reasonable restrictions and conditions that may be imposed by Sprint from time to time. No work may be performed within the immediate right of way by City until the fiber optic cable and other equipment modifications have been completed.

8. This Agreement is further contingent upon Sprint's successful completion of obtaining any private easements or permits from neighboring property owners which are necessary to accomplish the fiber relocate. City agrees to provide reasonable assistance to Sprint in any and all efforts deemed necessary by Sprint in order to obtain said easements or permits and agrees to reimburse Sprint for any direct and indirect costs incurred by Sprint in obtaining said easements or permits, including, but not limited to, acquisition costs, acquisition or permitting fees, surveying

or engineering work, indirect or direct labor, damages, administrative overhead, taxes, and legal fees.

9. Once the Project is completed, should City perform any portion of the Project relocation work itself on behalf of Sprint, including but not limited to the placement of facilities, including conduit and related fiber optic materials, City agrees to promptly execute a bill of sale or such other agreements as are necessary to convey ownership of such facilities to Sprint.

10. Exclusive of Saturday, Sunday and legal holidays, notice must be given to Sprint by City contractors, at least 48 hours in advance of commencement of any work on or adjacent to the fiber optic cable. The notice shall be given to Sprint at telephone number 1-800-521-0579.

11. DELETED.

12. City will indemnify, defend, and hold Sprint, its officers directors, agents and employees harmless from all loss, claims, liability and costs incurred by Sprint, including, without limitation, losses resulting from claims for damages to property or injuries to or death of persons, judgments, court costs and attorneys' fees, which arise out of or are claimed to have arisen out of the acts or omissions of City, its contractors, subcontractors, representatives, agents, or employees with respect to the Relocation Work (collectively, "Claims"), including, but not limited to, the construction, maintenance, presence on the right of way, or other operations or activities of City (but this indemnity against third party Claims shall not extend to Claims resulting from the negligence or willful misconduct of Sprint or its contractors, agents or employees). Sprint will indemnify, defend, and hold City, its officers directors, agents and employees harmless from all loss, claims, liability and costs incurred by City, including, without limitation, losses resulting from claims for damages to property or injuries to or death of persons, judgments, court costs and attorneys' fees, which arise out of or are claimed to have arisen out of the acts or omissions of Sprint, its contractors, subcontractors, representatives, agents, or employees with respect to the Relocation Work (collectively, "Claims"), including, but not limited to, the construction, maintenance, presence on the right of way, or other operations or activities of Sprint (but this indemnity against third party Claims shall not extend to Claims resulting from the negligence or willful misconduct of City or its contractors, agents or employees).

13. The Parties expressly understand that Sprint is not abandoning any rights, title, or interest it may have in the right of way, all such rights, title, and interest being expressly reserved.

14. The Parties expressly understand that there is a shortage in the availability of fiber optic cable due to a reduction in supply. Sprint shall not be held responsible for Relocation Work delays due to delays in the availability of fiber optic cable or other components.

15. Except as otherwise specifically provided in this Agreement, neither Party shall be in default under this Agreement if and to the extent that any failure or delay in a Party's performance of one or more of its obligations hereunder, excepting City's obligation to make payments required under this Agreement, is caused by any of the following conditions, and such Party's performance of such obligation or obligations shall be excused and extended for and during the period of any such delays: unforeseen act of God; fire; flood; fiber, cable, conduit or other

material shortages or unavailability or other delay in delivery not resulting from the responsible Party's failure to timely place orders therefore; lack of or delay in transportation not resulting from the responsible Party's act or omission to act; government codes, ordinances, laws, rules, regulations or restrictions; war or civil disorder; any other cause beyond the reasonable control of such Party (each a "Force Majeure Event"). The Party claiming relief of a Force Majeure Event must promptly notify the other Party in writing of the existence of the event relied on and the cessation or termination of the event.

16. This Agreement supersedes every antecedent or concurrent oral and/or written declaration and/or understanding pertaining to the fiber optic cable Relocation Work by and between Sprint and City.

17. The terms of this Agreement shall be binding and inure to the benefits of the Parties to this Agreement and their successors and assigns.

18. Notwithstanding anything to the contrary contained in this Agreement, Sprint will not be required to perform any cable modification work contemplated by this Agreement during the period of November 15th of any year through January 2nd of the following year.

19. This Agreement may be executed in several counterparts, each of which shall be deemed an original, but all of which together shall constitute one and the same Agreement. The Parties agree that an electronic copy of a signed signature page of a counterpart agreement shall evidence and constitute valid execution of this Agreement and shall be binding on a Party to the same extent as the original signature counterpart copy. This Agreement may be accepted and signed in electronic form (e.g., by an electronic or digital signature or other means of demonstrating assent) and each Party's electronic acceptance and signature will be deemed binding between the Parties. Each Party acknowledges and agrees it will not contest the validity or enforceability of this Agreement, including under any applicable statute of frauds, because it was accepted and/or signed in electronic form. Electronic records of a Party when produced in hard copy form shall constitute business records and shall have the same validity as any other generally recognized business records.

20. Any notice required to be delivered pursuant to this Agreement shall be in writing and shall be deemed received when: (a) personally delivered (including delivery via commercial messenger service); (b) one business day after being deposited with a nationally recognized overnight courier service, charges prepaid, and properly addressed for next-day delivery; or (c) transmitted via e-mail to the applicable email address(es) set forth below. For purposes of this subsection, the addresses of each Party shall be that set forth above. Either Party may change its address for notice from time to time by delivery of at least ten (10) days prior notice of such change to the other Party in the manner prescribed in this Agreement.

a. City: Attn. Swetaben Patel
Department of Public Works
City of Riverside
3900 Main Street, 4th Floor
Riverside, CA 92522

- b. Sprint: Director of Infrastructure
Cogent Fiber LLC (fka Sprint Communications Company L.P.)
C/O Cogent Communications
2450 N Street, NW, 4th Floor
Washington, DC 20037

21. This Agreement shall be construed under and in accordance with the laws of the State where the Property is located, and all obligations of the Parties created under this Agreement are performable in the county where the Property is located.

22. Neither Party may assign this Agreement without the other Party's prior written consent, which consent may not be unreasonably withheld, conditioned, or delayed. Any purported assignment of this Agreement by a Party without the other Party's prior written consent shall be void.

23. In the event any one or more of the provisions contained in this Agreement shall for any reason be held to be invalid, illegal, or unenforceable in any respect, such invalidity, illegality, or unenforceability shall not affect any other provision of this Agreement and this Agreement shall be construed as if such invalid, illegal, or unenforceable provision had never been contained in this Agreement. Furthermore, in lieu of any such invalid, illegal, or unenforceable provision, a provision as similar to such invalid, illegal, or unenforceable provision as may be possible shall be automatically added to this Agreement and shall be valid, legal, and enforceable.

24. This Agreement constitutes the sole and only agreement of the Parties with respect to the subject matter of this Agreement and supersedes any prior understandings or written or oral agreements between the Parties respecting the subject matter of this Agreement and cannot be changed except by their written consent.

25. Whenever any determination is to be made or action to be taken on a date specified in this Agreement, if such date shall fall upon a Saturday, Sunday, or holiday observed by federal savings banks in the state where the Property is located, the date for such determination or action shall be extended to the first business day immediately following.

26. Each Party represents and warrants to the other that this Agreement has been validly entered into by it and that it has full legal power, right, and authority to perform its obligations under this Agreement.

27. Each Party represents and warrants to the other Party that the consent or approval of no third party, including, without limitation, a lender, is required with respect to the execution of this Agreement, or if any such third-party consent or approval is required, such Party has obtained any and all such consents or approvals.

28. Each Party represents and warrants to the other Party that the person executing this Agreement on behalf of such Party has the authority to execute this Agreement and bind such Party to the terms and provisions of this Agreement.

The Parties have caused this Agreement to be executed by their proper duly authorized officials as of the dates indicated below.

CITY OF RIVERSIDE,
a California charter city and
a municipal corporation

**COGENT FIBER LLC (fka SPRINT
COMMUNICATIONS COMPANY L.P.),**
Delaware limited liability company

BY: _____

BY: Dave Schaeffer
Dave Schaeffer (Feb 3, 2026 12:46:39 EST)

NAME: _____

NAME: David Schaeffer

TITLE: City Manager

TITLE: President & CEO

DATE: _____

DATE: 02/03/2026

ATTEST: _____
City Clerk

Certified as to Availability of Funds:

BY: Julia Nemes
Chief Financial Officer

BY: Robert Bowman
Robert Bowman (Feb 3, 2026 12:21:13 EST)

NAME: Robert Bowman

TITLE: Vice President

DATE: 02/03/2026

Approved as to Form:

By: Tan A. Taro
Deputy City Attorney

Exhibit A
Engineering Drawing



Sprint



3RD STREET GRADE SEPARATION
3310 VINE STREET
RIVERSIDE, CA 92507

PROJECT STATUS: PERMITTING

LOCATION MAP
RIVERSIDE, CA
RIVERSIDE COUNTY



PROJECT 111024-01

RIVERSIDE 180 FT GRADE SEPARATION
3310 VINE STREET
RIVERSIDE, CA 92507

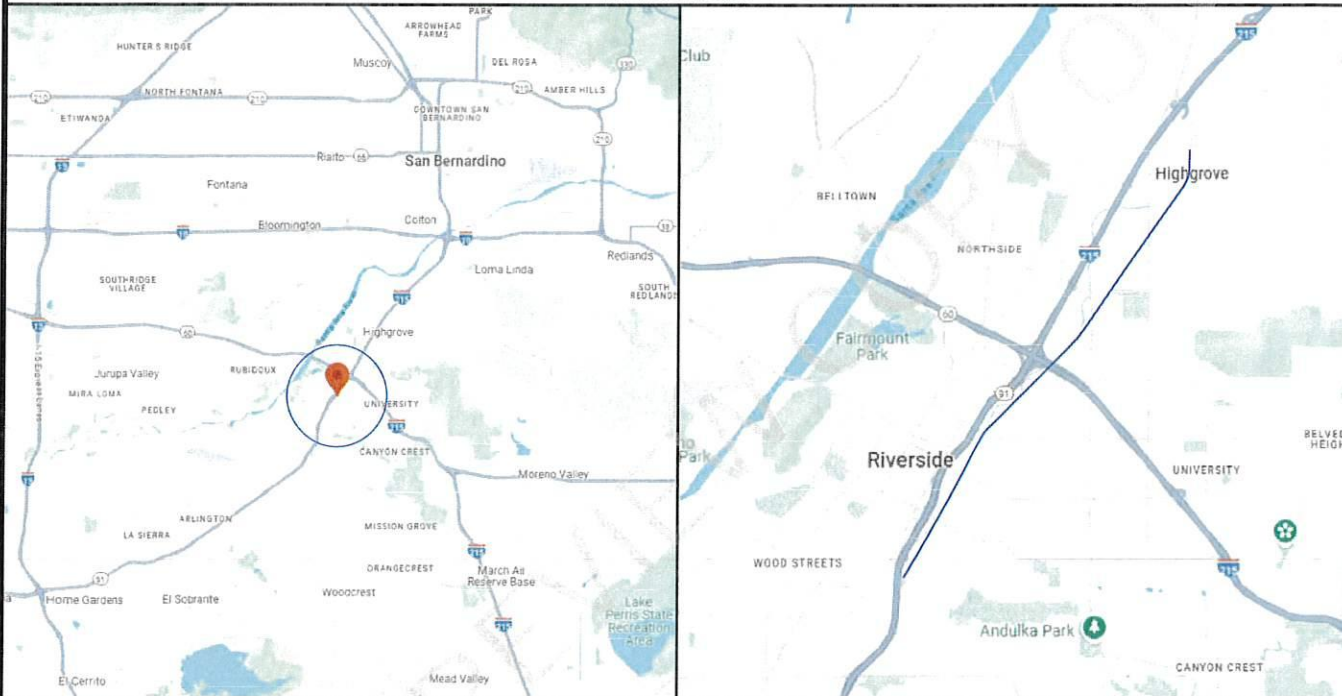

DATE 1/10/2024

ENGINEER: WOODMAN TELCOM

DRAWN BY: VLTG MW

REVISIONS

DATE	DISCIPLINE	BY	CHK
11/02/24	50% HORIZONTAL	N/A	N/A
03/11/25	100% PLANS	N/A	N/A

SCALE

HORIZONTAL 1"= N/A

VERTICAL 1"= N/A

MP TO MP

SHEET 02 OF 10

FILE 111024-1 0024

VICINITY MAP

RIVERSIDE, CA

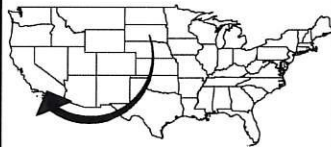

PROJECT MAP

SYMBOLS KEY

	EXISTING	PROPOSED
BURIED CABLE		
AERIAL CABLE		
SUBMARINE CABLE		
FOGWIRE CABLE		
DIRECT BURIED HDPE		
PVC OR SPLIT PVC CONDUIT		
BSP/GSP OR SPLIT BSP/GSP CONDUIT		
STEEL CASING		
REMOVE AND RESTORE ASPHALT OR CONCRETE (WIDTH AS INDICATED)		
CORE BORE		
JACK AND BORE		
DIRECTIONAL BORE		
FUTURE CABLE		
REMOVE CABLE		
TO BE REMOVED OR ABANDONED (SHOWN FOR HDPE)		
AERIAL UTILITY (ELECTRIC)		
UNDERGROUND UTILITY (TELEPHONE)		
MAIN TRACKS		
AUXILIARY TRACKS		
CENTERLINE		
RIGHT-OF-WAY		
EDGE OF PAVEMENT		
SIDEWALK		
DITCH LINE		
TAX DISTRICT		
CITY, COUNTY OR STATE BOUNDARY LINE		
PROPERTY LINE		
FENCE LINE		
GUARDRAIL		
TOP OF SLOPE		
TOE OF SLOPE		

- STEEL MARKER AND SIGN-(A)
- ALUMINUM "HUB"-STYLE MARKER-(B)
- FLAT MARKER-(C)
- TUBULAR MARKER-(D)
- TUBULAR MARKER, & ISOLATOR PROTECTOR-(E)
- MILE POST MARKER
- NOTE: DASHED = NOT FOUND IN FIELD
- PERMIT TRACKING FORM IDENTIFIER
- ROCK PROBE (DEPTH AS INDICATED)
- UTILITY COVER DEPTH
- HANDHOLE, MANHOLE OR PULLBOX
- POLE
- ANCHOR ONLY
- GUY ONLY
- OVERHEAD GUY (ARROW IN DIRECTION OF PULL)
- ANCHOR AND GUY
- SIDEWALK ANCHOR AND GUY
- FOREIGN ANCHOR AND GUY
- PUSH BRACE (EXISTING POLE)
- ACCOUNT CODE CHANGE (BURIED TO AERIAL)
- BOND AND GROUND
- CULVERT (SIZE AS INDICATED)
- BRIDGE
- WATER METER
- GAS VALVE
- FIRE HYDRANT
- RAILROAD SIGNAL CONTROL BOX
- CAUTION NOTE

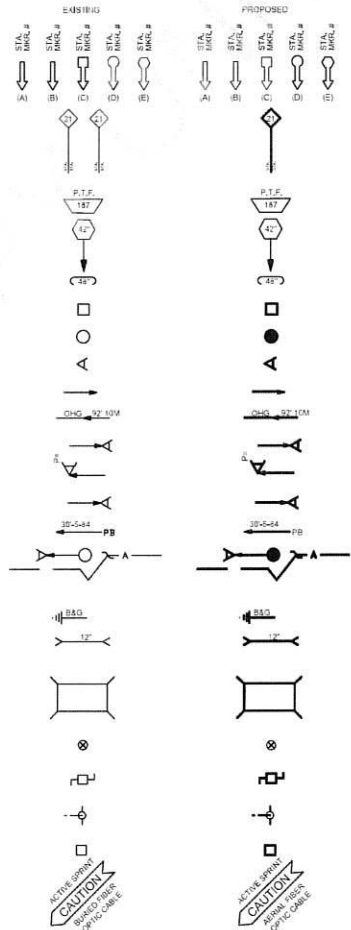

WOODMAN
INCORPORATED

PROJECT: 111024-01
 RIVERSIDE RD BY GRADE SEPARATION
 1310 VINE STREET
 RIVERSIDE, CA 92507

DATE	DESCRIPTION	INITIALS
11/19/24	30% HORIZONTAL	WV
09/19/24	100% PLAN & 50% V	WV

DATE: 11/19/2024
 ENGINEER: WOODMAN TELCOM
 DRAWN BY: WT,G MW

SCALE
 HORIZONTAL: 1"= N/A
 VERTICAL: 1"= N/A
 NP TO MP
 SHEET 01 OF 30
 FILE: 111024-01-005.A



INDEX SHEET
RIVERSIDE, CA
RIVERSIDE COUNTY



PROJECT: 111024-01

PA. GRADE AND ST. GRADE SEPARATION

3310 VINE STREET

RIVERSIDE, CA 92507

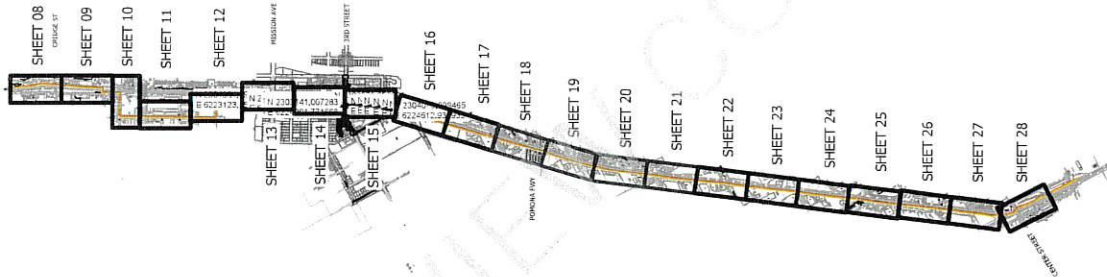

DATE: 11/10/2014

ENGINEER: ROSEMAN TELCOM

DRAWN BY: W.T.G. MW

REVISIONS

DATE	DESCRIPTION	BY
11/10/14	50% HORIZONTAL	MW
03/11/14	100% P. AUG.	MW

SCALE

HORIZONTAL: 1" = 100'

VERTICAL: 1" = 10'

MP TO MP

SHEET 07 OF 08

FILE: 111024-009A

RIVERSIDE, CA
RIVERSIDE COUNTY



PROJECT:	111024-01
RIVERSIDE 3RD ST GRADE SEPARATION	
3310 VINE STREET	
RIVERSIDE, CA 92507	
CLASSIFICATION NO.	QUANTITY
PULL FIBER	1222
REMOVE FIBER	1222



DATE: 11/09/2024
ENGINEER: WOODMAN TELCOM
DRAWN BY: A.T.O. MVA

DATE	DESCRIPTION	BY
11/09/24	90% HORIZONTAL	MVA
03/10/26	100% PLANS	MVA

SCALE

HORIZONTAL: 1" = 80'
VERTICAL: 1" = N/A

MP TO MP
SHEET 02 OF 30
FILE: 111024-1-035A

SEE SHEET 08 TO MATCH SURVEY STA. 10+48

SEE SHEET 10 TO MATCH SURVEY STA. 22+68

PULL 900 (1) - 350' FOC THRU EX. SPRINT (42" DUCT SYSTEM)
AFTER CUT-OVER REMOVE 900 EX. 100' FOC

PULL 300 (1) - 300' FOC THRU EX. SPRINT (42" DUCT SYSTEM)
AFTER CUT-OVER REMOVE 300 EX. 100' FOC

STA. 19+00
EMIT TO SPRINT M-H
ACCESS EX. VAULT TO PLACE NEW FIBER CABLE
+ 100' COI

UNDERGROUND UTILITIES HAVE BEEN PLOTTED FROM AVAILABLE RECORDS AND FIELD OBSERVATIONS BUT ARE NOT NECESSARILY EXACT. IT IS THE CONTRACTOR'S RESPONSIBILITY TO FIELD LOCATE ALL UNDERGROUND OBSTRUCTIONS AND UTILITIES PRIOR TO CONSTRUCTION. COMPLETE REPAIR OF ANY AND ALL DAMAGES INCURRED SHALL BE AT THE EXPENSE OF THE CONTRACTOR.

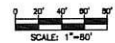

SCALE: 1" = 80'



CALL BEFORE YOU DIG
800-4-A-DIG
72 HOURS NOTICE REQUIRED

RIVERSIDE, CA
RIVERSIDE COUNTY



PROJECT 111024-01

OVERHEAD TRD ST GRADE SEPARATION

3310 VINE STREET

RIVERSIDE, CA 92507

CLASSIFICATION NO. QUANTITY

PULL FIBER 1098

REMOVE FIBER 1098



DATE 11/10/2024

ENGINEER WOODMAN TELCOM

DRAWN BY V.T.O. MW

NOT TO SCALE
DATE 11/10/2024
ENGINEER WOODMAN TELCOM
DRAWN BY V.T.O. MW

SCALE
HORIZONTAL 1" = 80'
VERTICAL 1" = N/A

MP TO MP
SHEET 10 OF 10
FILE: 111024-1 009A

UNDERGROUND UTILITIES HAVE BEEN PLOTTED FROM AVAILABLE RECORDS AND FIELD OBSERVATIONS BUT ARE NOT NECESSARILY EXACT. IT IS THE CONTRACTOR'S RESPONSIBILITY TO FIELD LOCATE ALL UNDERGROUND OBSTRUCTIONS AND UTILITIES PRIOR TO CONSTRUCTION. COMPLETE REPAIR OF ANY AND ALL DAMAGES INCURRED SHALL BE AT THE EXPENSE OF THE CONTRACTOR.

SEE SHEET 11 TO MATCH SURVEY STA. 33+66

PULL 554 (1) - 36CT FOC THRU EX. SPRINT (4-2" DUCT SYSTEM AFTER CUT-OVER REMOVE 554 EX. 36CT FOC.

STA. 33+14
EXISTING SPRINT 900
ACCESS EX. VALV 1" TO PLACE NEW FIBER CABLE + 100' COIL

PULL 544 (1) - 36CT FOC THRU EX. SPRINT (4-2" DUCT SYSTEM AFTER CUT-OVER REMOVE 544 EX. 36CT FOC.

SEE SHEET 09 TO MATCH SURVEY STA. 22+68

0 20 40 60 80
SCALE: 1" = 80'

CALL BEFORE YOU DIG
1-800-4-A-DIG
12 HOURS NOTICE REQUIRED

RIVERSIDE, CA
RIVERSIDE COUNTY



PROJECT 111024-01
RIVERSIDE TRD ST GRADE SEPARATION
3310 VINE STREET
RIVERSIDE, CA 92507

CLASSIFICATION NO.	QUANTITY
PULL FIBER	1124
REMOVE FIBER	1124



DATE 11/10/2024
ENGINEER WOODMAN TELCOM
DRAWN BY K.T.G MW

DATE	DESCRIPTION	BY
11/10/24	60% HORIZONTAL	MS
03/11/25	100% PLANS	MS

SCALE
HORIZONTAL 1" = 60'
VERTICAL 1" = N/A

MP	TO MP
SHEET 11	OF 26

FILE 111024-009A

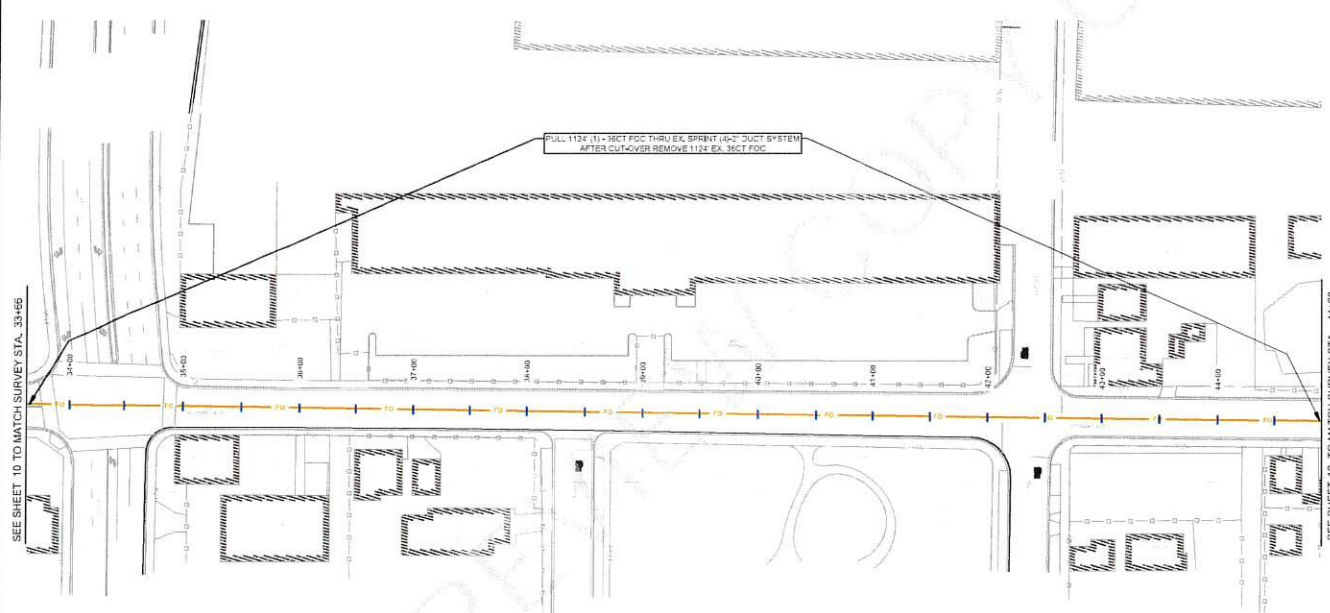

SEE SHEET 10 TO MATCH SURVEY STA. 33+65

SEE SHEET 12 TO MATCH SURVEY STA. 44+90

UNDERGROUND UTILITIES HAVE BEEN PLOTTED FROM AVAILABLE RECORDS AND FIELD OBSERVATIONS BUT ARE NOT NECESSARILY EXACT. IT IS THE CONTRACTOR'S RESPONSIBILITY TO FIELD LOCATE ALL UNDERGROUND OBSTRUCTIONS AND UTILITIES PRIOR TO CONSTRUCTION. COMPLETE REPAIR OF ANY AND ALL DAMAGES INCURRED SHALL BE AT THE EXPENSE OF THE CONTRACTOR.

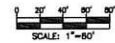

SCALE: 1"=60'



CALL BEFORE YOU DIG
800-4-A-DIGIT-1111
72 HOURS NOTICE REQUIRED

RIVERSIDE, CA
RIVERSIDE COUNTY



PROJECT: 111024-01
RIVERSIDE 3RD ST GRADE SEPARATION
3310 VINE STREET
RIVERSIDE, CA 92507

CLASSIFICATION NO.	QUANTITY
PULL FIBER	1722
REMOVE FIBER	1638
PLACE MANHOLE	1
DIRECTIONAL BORE	250
TRENCH	252
PLACE DUCT	542



DATE: 11/10/2014
ENGINEER: WOODMAN TELCOM
DRAWN BY: VLT, G MW

DATE	DESCRIPTION	INITIALS
11/10/14	80% HORIZONTAL	MM
03/11/15	100% PLANS	MM

SCALE
HORIZONTAL: 1" = 80'
VERTICAL: 1" = N/A
MP TO MP
SHEET 13 OF 30
FILE: 111024-1.DWG

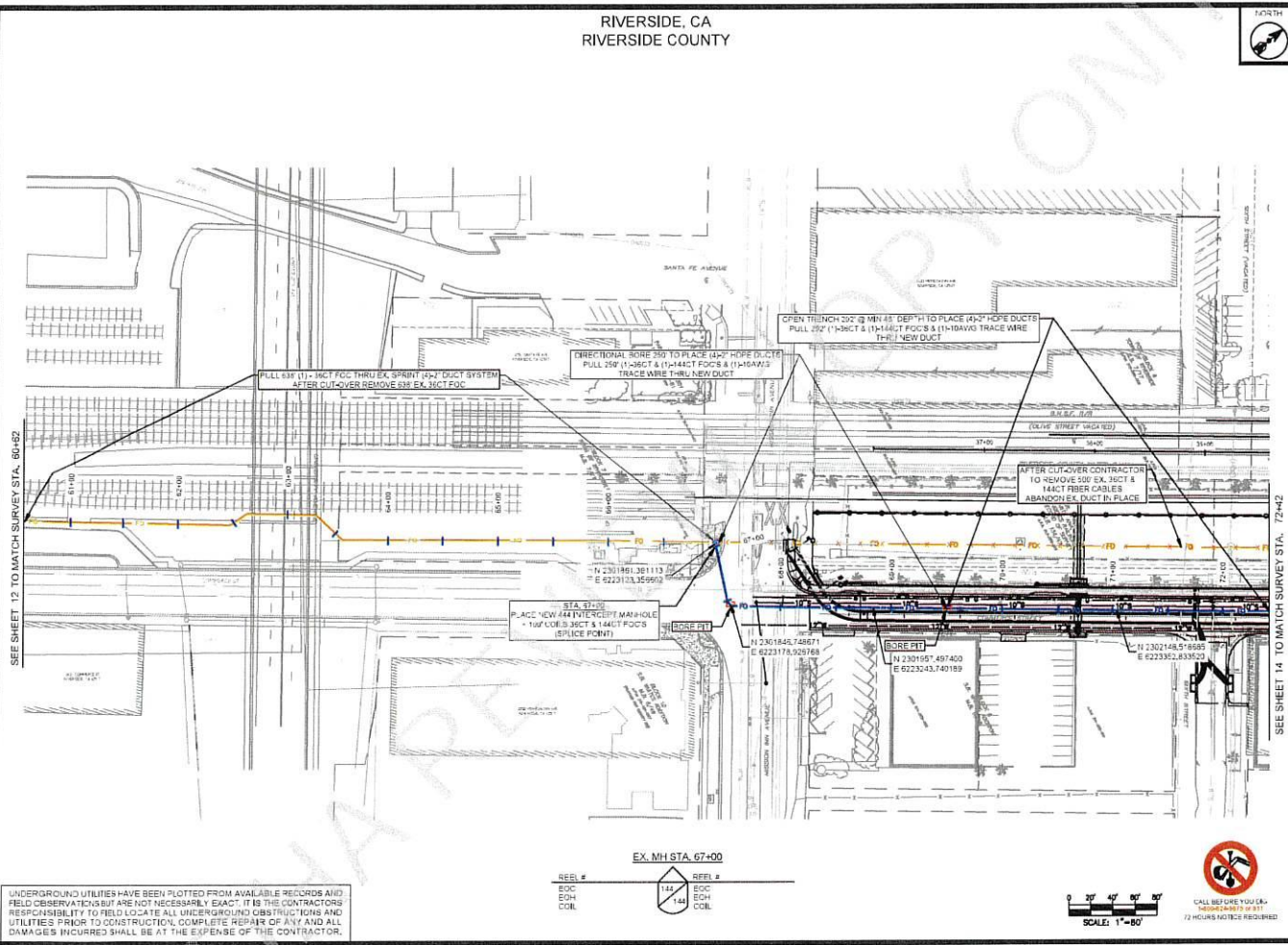

SEE SHEET 12 TO MATCH SURVEY STA. 66+82

SEE SHEET 14 TO MATCH SURVEY STA. 72+42

UNDERGROUND UTILITIES HAVE BEEN PLOTTED FROM AVAILABLE RECORDS AND FIELD OBSERVATIONS BUT ARE NOT NECESSARILY EXACT. IT IS THE CONTRACTOR'S RESPONSIBILITY TO FIELD LOCATE ALL UNDERGROUND OBSTRUCTIONS AND UTILITIES PRIOR TO CONSTRUCTION. COMPLETE REPAIR OF ANY AND ALL DAMAGES INCURRED SHALL BE AT THE EXPENSE OF THE CONTRACTOR.

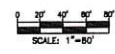
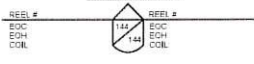

RIVERSIDE, CA
RIVERSIDE COUNTY



PROJECT 111024-01
RIVERSIDE 1RD ST GRACE SEPARATION
3310 VINE STREET
RIVERSIDE, CA 92507

CLARIFICATION NO.	QUANTITY
PULL FIBER	2288
REMOVE FIBER	2248
PLACE MANHOLE	1
DIRECTIONAL BORE	426
TRENCH	708
PLACE DUCT	1134
STEEL CASING	426



DATE 11/19/2024
ENGINEER WOODMAN TELCOM
DRAWN BY V.L.T.G MW

DATE	DESCRIPTION	BY/APP
11/19/24	80% HORIZONTAL	ML
03/11/25	100% PLANS	ML

SCALE
HORIZONTAL: 1"= 80'
VERTICAL: 1"= NA

MP	TO MP
SHEET 14	OF 30
FILE 111024-01.DWG	

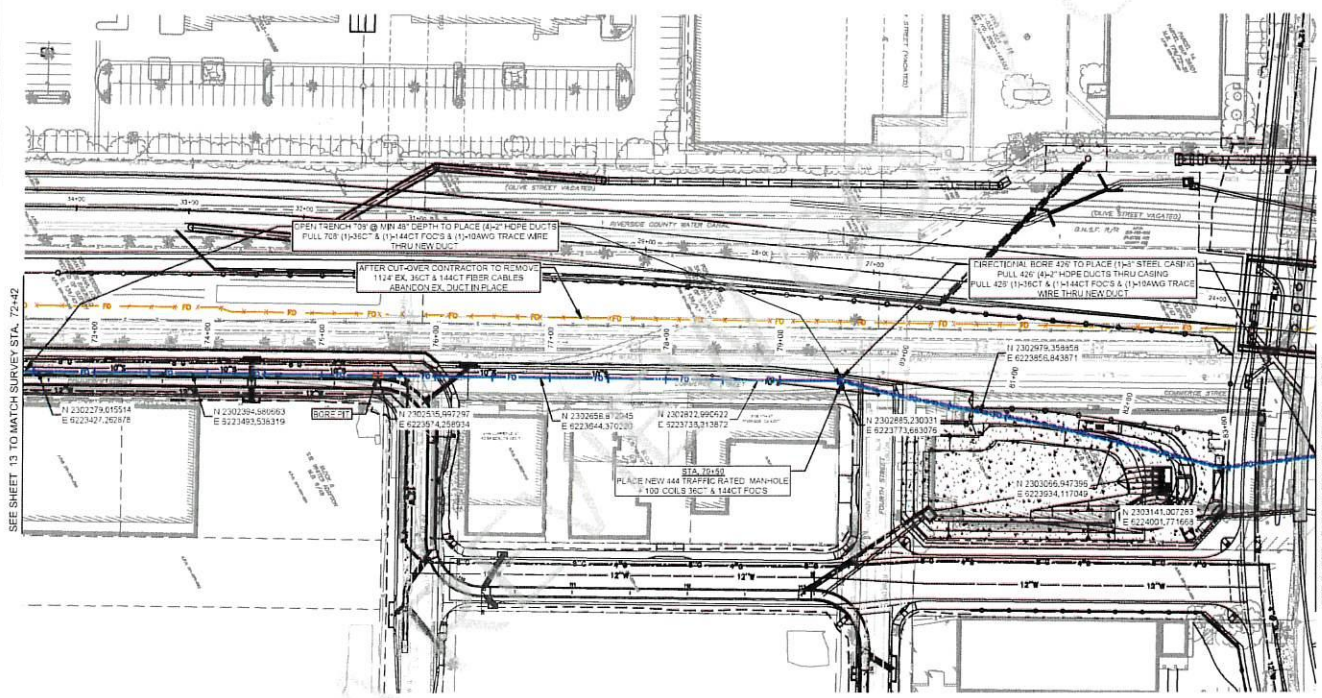

SEE SHEET 13 TO MATCH SURVEY STA. 72+42

SEE SHEET 15 TO MATCH SURVEY STA. 83+75

UNDERGROUND UTILITIES HAVE BEEN PLOTTED FROM AVAILABLE RECORDS AND FIELD OBSERVATIONS BUT ARE NOT NECESSARILY EXACT. IT IS THE CONTRACTORS RESPONSIBILITY TO FIELD LOCATE ALL UNDERGROUND OBSTRUCTIONS AND UTILITIES PRIOR TO CONSTRUCTION. COMPLETE REPAIR OF ANY AND ALL DAMAGES INCURRED SHALL BE AT THE EXPENSE OF THE CONTRACTOR.

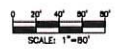

RIVERSIDE, CA
RIVERSIDE COUNTY



PROJECT: 111024-01
H-RIVERSIDE 1RD ST GRADE SEPARATION
3310 VINE STREET
RIVERSIDE, CA 92507

CLASSIFICATION NO.	QUANTITY
PULL FIBER	2975
REMOVE FIBER	2342
PLACE MANHOLE	1
DIRECTIONAL BORE	1134'
TRENCH	0
PLACE DUCT	133
STEEL CASING	224'



DATE: 11/10/2024
ENGINEER: WOODMAN TELCOM
DRAWN BY: V.T.G. MW

DATE	DESCRIPTION	BY
11/10/24	REV. HORIZONTAL	AW
01/10/25	100% PLANS	AW

NOTE: ALL WORK SHALL BE IN ACCORDANCE WITH THE LATEST EDITIONS OF THE CALIFORNIA STANDARD SPECIFICATIONS FOR HIGHWAY CONSTRUCTION AND THE LATEST EDITIONS OF THE CALIFORNIA STANDARD SPECIFICATIONS FOR STRUCTURES AND BRIDGES. CALL BEFORE YOU DIG. 72 HOURS NOTICE REQUIRED.

SCALE

HORIZONTAL	1" = 60'
VERTICAL	1" = N/A
MP	TO MP
SHEET	15 OF 30
FILE	111024-1.DWG

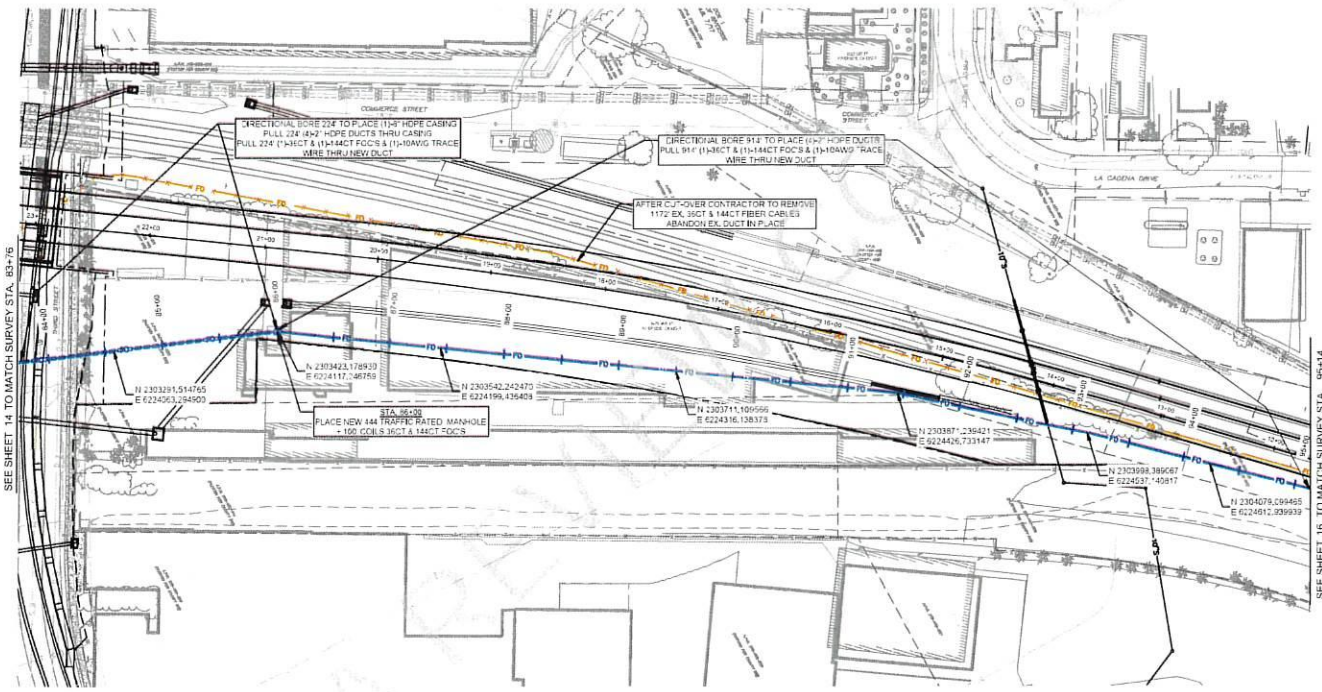

SEE SHEET 14 TO MATCH SURVEY STA. 68+75

SEE SHEET 16 TO MATCH SURVEY STA. 95+14

UNDERGROUND UTILITIES HAVE BEEN PLOTTED FROM AVAILABLE RECORDS AND FIELD OBSERVATIONS BUT ARE NOT NECESSARILY EXACT. IT IS THE CONTRACTOR'S RESPONSIBILITY TO FIELD LOCATE ALL UNDERGROUND OBSTRUCTIONS AND UTILITIES PRIOR TO CONSTRUCTION. COMPLETE REPAIR OF ANY AND ALL DAMAGES INCURRED SHALL BE AT THE EXPENSE OF THE CONTRACTOR.

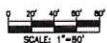

CALL BEFORE YOU DIG
72 HOURS NOTICE REQUIRED

RIVERSIDE, CA
RIVERSIDE COUNTY



PROJECT: 111024-01
RIVERSIDE 1RD ST GRADE SEPARATION
3310 VINE STREET
RIVERSIDE, CA 92507

CLASSIFICATION NO.	QUANTITY
PULL FIBER	1165
REMOVE FIBER	1149
PLACE MANHOLE	0
DIRECTIONAL BORE	26'
TRENCH	0
PLACE DUCT	26'



DATE: 11/10/2024
ENGINEER: WOODMAN TELCOM
DRAWN BY: V.L.T.G. MW

DATE	DESCRIPTION	BY
11/10/24	90% HORIZONTAL	ML
03/11/25	100% PLANS	ML

SCALE
HORIZONTAL: 1" = 80'
VERTICAL: 1" = N/A

MP TO MP
SHEET 16 OF 30
FILE: 111024-1 0304

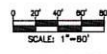
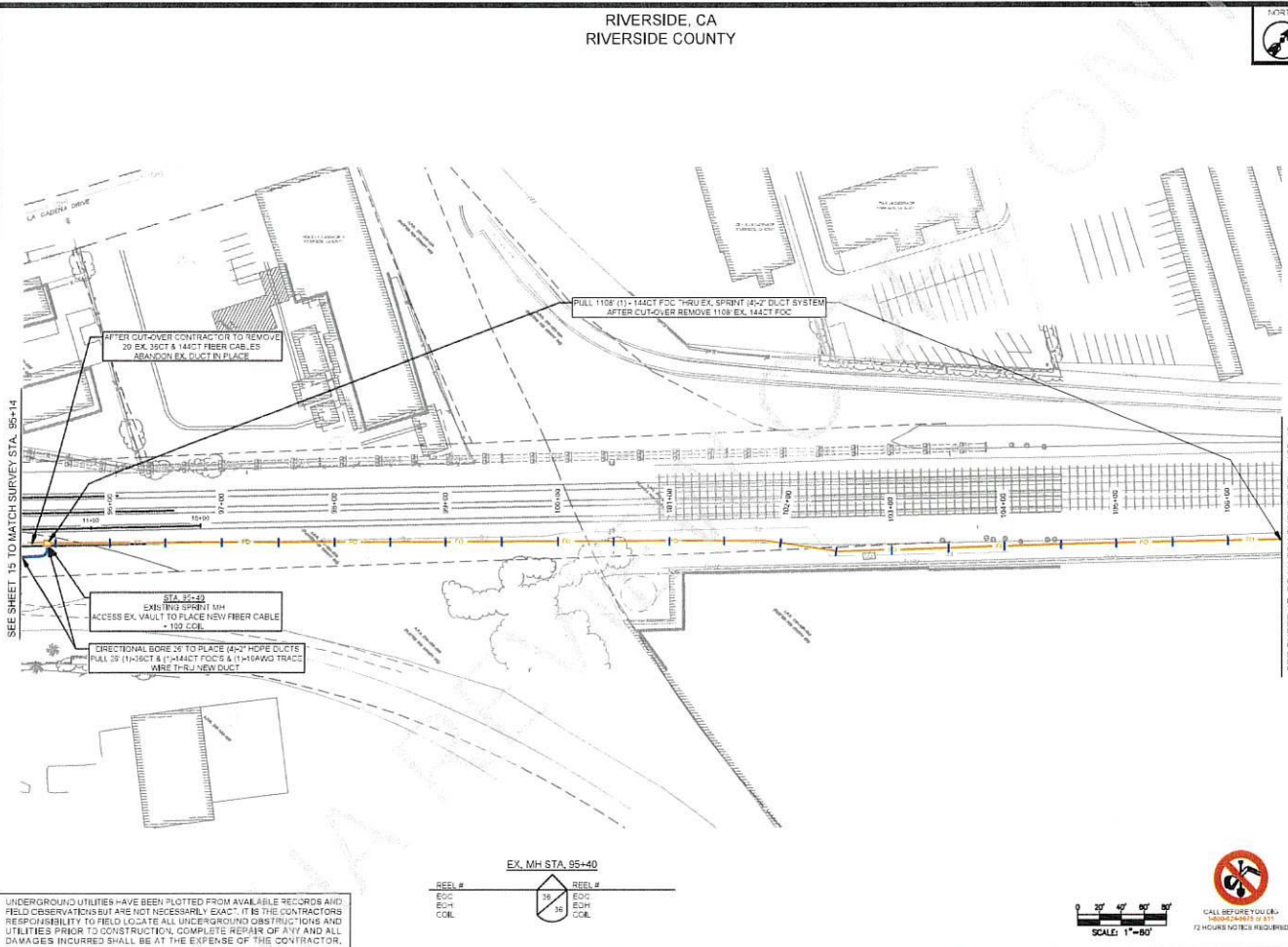

RIVERSIDE, CA
RIVERSIDE COUNTY



PROJECT 111024-01

RIVERSIDE 1RD ST GRADE SEPARATION
3310 VINE STREET
RIVERSIDE, CA 92507

CLASSIFICATION NO.	QUANTITY
PULL FIBER	1124
REMOVE FIBER	1124
PLACE MANHOLE	0
DIRECTIONAL BORE	0
TRENCH	0
PLACEDUCT	0



DATE 11/19/2024

ENGINEER WOODMAN TELCOM

DRAWN BY V.T.G MW

REVISIONS

DATE	DESCRIPTION	INITIALS
11/19/24	80% HORIZONTAL	ML
03/11/25	100% PLANS	ML

NOTE: ALL REVISIONS SHALL BE MADE IN ACCORDANCE WITH THE STANDARD SPECIFICATIONS FOR PUBLIC WORKS, LATEST EDITION, AND SHALL BE MADE IN THE FIELD PRIOR TO CONSTRUCTION. COMPLETE REPAIR OF ANY AND ALL DAMAGES INCURRED SHALL BE AT THE EXPENSE OF THE CONTRACTOR.

SCALE

HORIZONTAL: 1" = 80'

VERTICAL: 1" = N/A

MP TO MP

SHEET 17 OF 30

FILE: 111024-030A

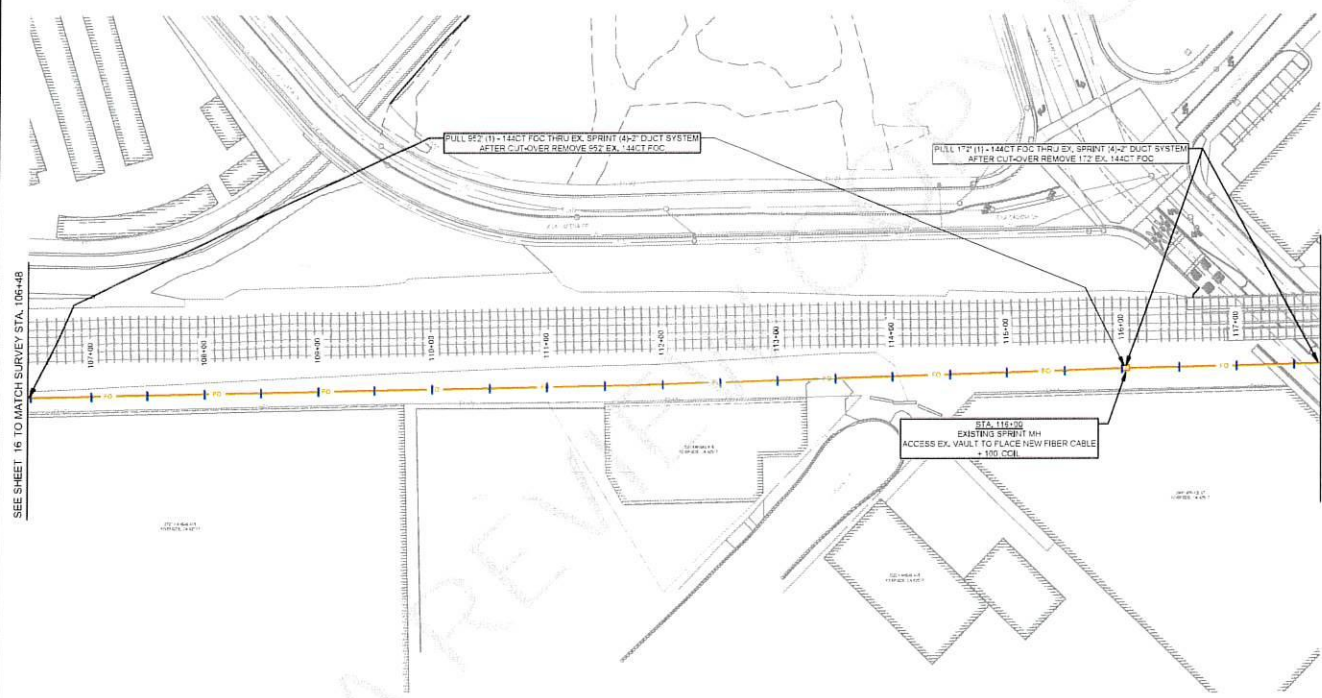

SEE SHEET 16 TO MATCH SURVEY STA. 106+48

SEE SHEET 18 TO MATCH SURVEY STA. 117+72

UNDERGROUND UTILITIES HAVE BEEN PLOTTED FROM AVAILABLE RECORDS AND FIELD OBSERVATIONS BUT ARE NOT NECESSARILY EXACT. IT IS THE CONTRACTOR'S RESPONSIBILITY TO FIELD LOCATE ALL UNDERGROUND OBSTRUCTIONS AND UTILITIES PRIOR TO CONSTRUCTION. COMPLETE REPAIR OF ANY AND ALL DAMAGES INCURRED SHALL BE AT THE EXPENSE OF THE CONTRACTOR.

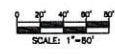

SCALE: 1"=80'



CALL BEFORE YOU DIG
UNDEGROUND UTILITIES
72 HOURS NOTICE REQUIRED

RIVERSIDE, CA
RIVERSIDE COUNTY



PROJECT: 111024-01
RIVERSIDE 1RD AT GRADE SEPARATION
3310 VINE STREET
RIVERSIDE, CA 92507

CLARIFICATION NO.	QUANTITY
PULL FIBER	1124
REMOVE FIBER	1124
PLACE MANHOLE	0
DIRECTIONAL BORE	0
TRENCH	0
PLACE DUCT	0



DATE	DESCRIPTION	BY
11/10/2024	100% PLANS	MMW

DATE	DESCRIPTION	BY
11/10/24	100% PLANS	MMW

SCALE

HORIZONTAL: 1" = 80'

VERTICAL: 1" = N/A

MP TO MP

SHEET 18 OF 30

FILE: 111024-1 030A

PULL 1124 (1) - 1440CT FOC THRU EX. SPRINT (48") DUCT SYSTEM
AFTER CUT-OVER REMOVE 1124 EX. 1440CT FOC

SEE SHEET 17 TO MATCH SURVEY STA. 117+72

SEE SHEET 19 TO MATCH SURVEY STA. 128+95

UNDERGROUND UTILITIES HAVE BEEN PLOTTED FROM AVAILABLE RECORDS AND FIELD OBSERVATIONS BUT ARE NOT NECESSARILY EXACT. IT IS THE CONTRACTOR'S RESPONSIBILITY TO FIELD LOCATE ALL UNDERGROUND OBSTRUCTIONS AND UTILITIES PRIOR TO CONSTRUCTION. COMPLETE REPAIR OF ANY AND ALL DAMAGES INCURRED SHALL BE AT THE EXPENSE OF THE CONTRACTOR.

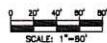

CALL BEFORE YOU DIG
72 HOURS NOTICE REQUIRED

RIVERSIDE, CA
RIVERSIDE COUNTY



PROJECT	111024-01
RIVERSIDE 3RD ST GRADE SEPARATION	
3310 VINE STREET	
RIVERSIDE, CA 92507	
CLASSIFICATION NO.	QUANTITY
PULL FIBER	1126
REMOVE FIBER	1126
PLACE MAN-HOLE	0
DIRECTIONAL BORE	0
TRENCH	0
PLACE DUCT	0



DATE	11/16/2024	
ENGINEER	WOODMAN TELCOM	
DRAWN BY	A.T.G. MW	
REVISIONS		
DATE	DESCRIPTION	BY
11/16/24	90% HORIZONTAL	MS
02/11/25	100% PLANS	MS

SCALE	
HORIZONTAL	1" = 80'
VERTICAL	1" = N/A
MP	TO MP
SHEET	25 OF 30
FILE	111024-1 009A

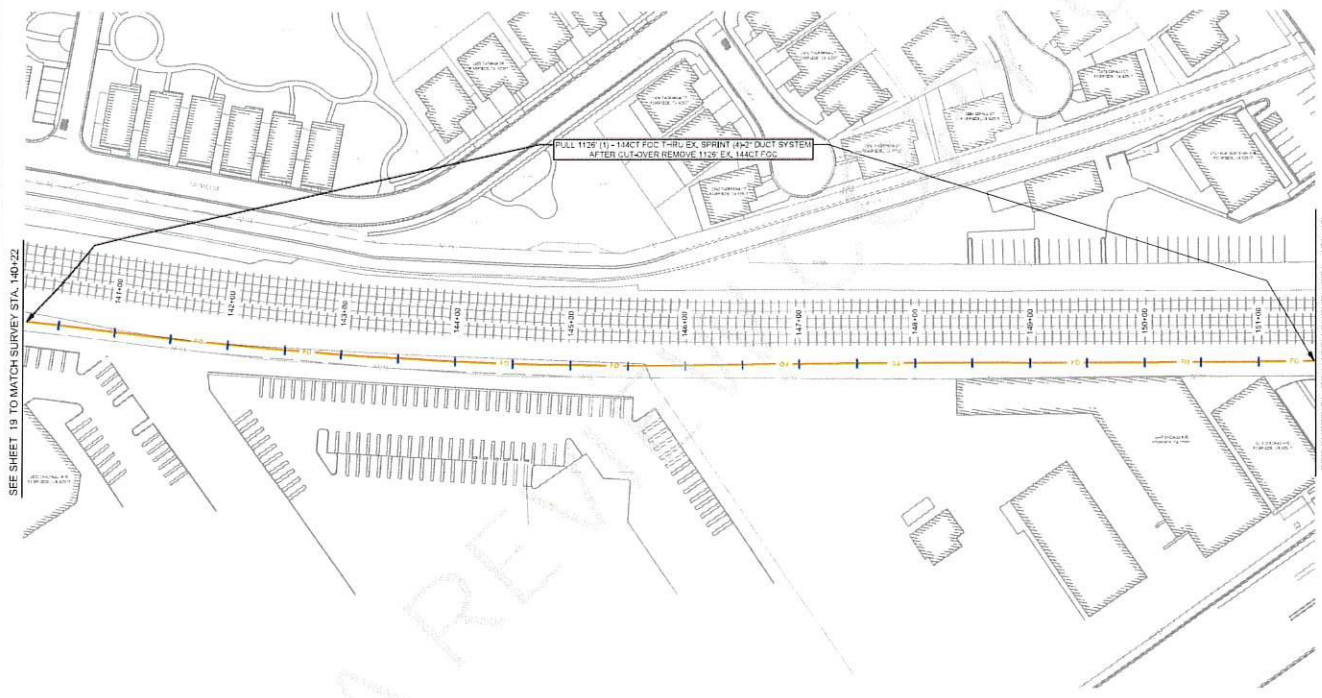

SEE SHEET 19 TO MATCH SURVEY STA. 140+22

SEE SHEET 21 TO MATCH SURVEY STA. 151+48

UNDERGROUND UTILITIES HAVE BEEN PLOTTED FROM AVAILABLE RECORDS AND FIELD OBSERVATIONS BUT ARE NOT NECESSARILY EXACT. IT IS THE CONTRACTOR'S RESPONSIBILITY TO FIELD LOCATE ALL UNDERGROUND OBSTRUCTIONS AND UTILITIES PRIOR TO CONSTRUCTION. COMPLETE REPAIR OF ANY AND ALL DAMAGES INCURRED SHALL BE AT THE EXPENSE OF THE CONTRACTOR.

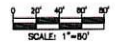

CALL BEFORE YOU DIG
1-800-4-A-DIG
72 HOURS NOTICE REQUIRED

RIVERSIDE, CA
RIVERSIDE COUNTY



PROJECT 111024-01
RIVERSIDE 3RD ST GRADE SEPARATION
3310 VINE STREET
RIVERSIDE, CA 92507

CLASSIFICATION NO.	QUANTITY
PULL FIBER	1128
REMOVE FIBER	1128
PLACE MANHOLE	0
DIRECTIONAL BORE	0
TRENCH	0
PLACE DUCT	0



DATE 11/10/2024
ENGINEER WOODMAN TELCOM
DRAWN BY A.L.G. MW

DATE	DESCRIPTION	BY
11/10/24	80% HORIZONTAL	AW
03/11/25	100% PLANS	MW

SCALE
HORIZONTAL 1" = 80'
VERTICAL 1" = N/A

MP TO MP
SHEET 21 OF 30
FILE 111024-1 309A

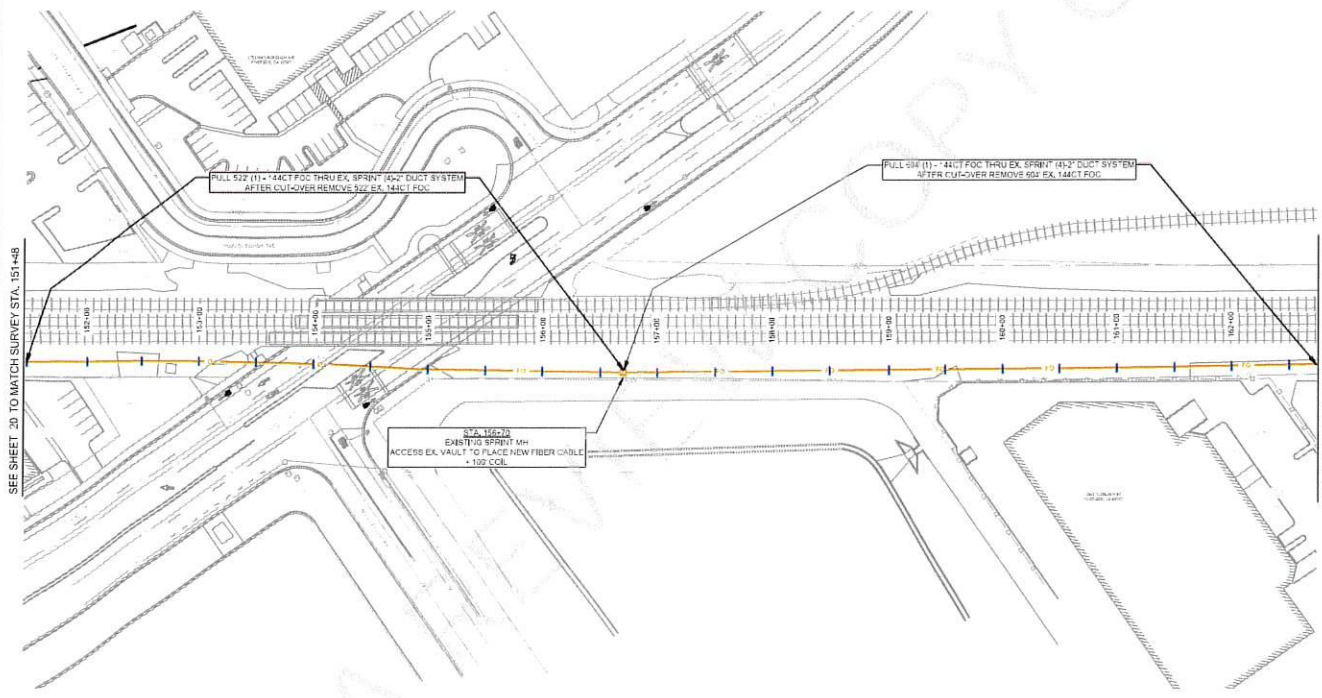

SEE SHEET 20 TO MATCH SURVEY STA. 181+48

SEE SHEET 22 TO MATCH SURVEY STA. 162+74

UNDERGROUND UTILITIES HAVE BEEN PLOTTED FROM AVAILABLE RECORDS AND FIELD OBSERVATIONS BUT ARE NOT NECESSARILY EXACT. IT IS THE CONTRACTOR'S RESPONSIBILITY TO FIELD LOCATE ALL UNDERGROUND OBSTRUCTIONS AND UTILITIES PRIOR TO CONSTRUCTION. COMPLETE REPAIR OF ANY AND ALL DAMAGES INCURRED SHALL BE AT THE EXPENSE OF THE CONTRACTOR.



CALL BEFORE YOU DIG
800-4-A-DIG or 811
72 HOURS NOTICE REQUIRED

RIVERSIDE, CA
RIVERSIDE COUNTY



PROJECT	111624-01
3/10 VINE STREET	
RIVERSIDE, CA 92507	
CLASSIFICATION NO.	QUANTITY
PULL FIBER	124
REMOVE FIBER	124
PLACE MANHOLE	0
DIRECTIONAL BORE	0
TRENCH	0
PLACE DUCT	0



DATE	11/10/2024	
ENGINEER	WOODMAN TELCOM	
DRAWN BY	P.T.G. MW	
REVISIONS		
DATE	DESCRIPTION	REVISION
11/10/24	80% HORIZONTAL	100
03/11/25	100% PLANS	100

SCALE	
HORIZONTAL	1" = 80'
VERTICAL	1" = NA
MP	TO MP
SHEET	22 OF 30
FILE	111024-1 008A

PULL 124 114 144CT FOC FROM EX. SPRINT 48" DUCT SYSTEM
AFTER CUT-OVER REMOVE 114 EX. 144CT FOC

SEE SHEET 21 TO MATCH SURVEY STA. 162+74

SEE SHEET 23 TO MATCH SURVEY STA. 173+98

UNDERGROUND UTILITIES HAVE BEEN PLOTTED FROM AVAILABLE RECORDS AND FIELD OBSERVATIONS BUT ARE NOT NECESSARILY EXACT. IT IS THE CONTRACTOR'S RESPONSIBILITY TO FIELD LOCATE ALL UNDERGROUND OBSTRUCTIONS AND UTILITIES PRIOR TO CONSTRUCTION. COMPLETE REPAIR OF ANY AND ALL DAMAGES INCURRED SHALL BE AT THE EXPENSE OF THE CONTRACTOR.

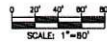

SCALE: 1" = 80'



CALL BEFORE YOU DIG
800-4-A-DIG-9111
72 HOURS NOTICE REQUIRED

RIVERSIDE, CA
RIVERSIDE COUNTY



PROJECT: 111024-01

75' WIDE 150 FT SPACE SEPARATION
3310 VINE STREET

RIVERSIDE, CA 92507

CLASSIFICATION NO.	QUANTITY
PULL FIBER	1124
REMOVE FIBER	1124
PLACE MANHOLE	0
DIRECTIONAL BORE	0
TRENCH	0
PLACE DUCT	0

DATE	DESCRIPTION	BY
11/19/24	80% HORIZONTAL	MAV
03/11/25	100% PLANS	MAV



DATE: 11/19/2024

ENGINEER: WOODMAN TELCOM

DRAWN BY: JLT/G MW

DATE	DESCRIPTION	BY
11/19/24	80% HORIZONTAL	MAV
03/11/25	100% PLANS	MAV

SCALE
HORIZONTAL: 1" = 80'
VERTICAL: 1" = N/A

MP TO MP
SHEET 23 OF 30

FILE: 111024-1.009A

SEE SHEET 22 TO MATCH SURVEY STA. 173+98

SEE SHEET 24 TO MATCH SURVEY STA. 185+22

PULL 322 (11)-144CT FOC THRU EX. SPRINT 48" DUCT SYSTEM
AFTER CUTOVER REMOVE 322 EX. 144CT FOC

PULL 802 (11)-144CT FOC THRU EX. SPRINT 48" DUCT SYSTEM
AFTER CUTOVER REMOVE 802 EX. 144CT FOC

SEA-117206
EXISTING SPRINT V.H.
ACCESS EX. VAULT TO PLACE NEW FIBER CABLE
- 10' COIL

UNDERGROUND UTILITIES HAVE BEEN PLOTTED FROM AVAILABLE RECORDS AND FIELD OBSERVATIONS BUT ARE NOT NECESSARILY EXACT. IT IS THE CONTRACTOR'S RESPONSIBILITY TO FIELD LOCATE ALL UNDERGROUND OBSTRUCTIONS AND UTILITIES PRIOR TO CONSTRUCTION. COMPLETE REPAIR OF ANY AND ALL DAMAGES INCURRED SHALL BE AT THE EXPENSE OF THE CONTRACTOR.



SCALE: 1" = 80'



CALL BEFORE YOU DIG
800-4-A-DIG or 811
72 HOURS NOTICE REQUIRED

RIVERSIDE, CA
RIVERSIDE COUNTY



PROJECT 111024-01

RIVERSIDE 1RD ST GRADE SEPARATION

3310 WINE STREET

RIVERSIDE CA 92507

CLASSIFICATION NO. QUANTITY

PULL FIBER 1125

REMOVE FIBER 1125

PLACE MANHOLE 0

DIRECTIONAL BORE 0

TRENCH 0

PLACE DUCT 0

PULL 1125 (1" x 1440' FOC THRU EX. SPRINT (48") DUCT SYSTEM)
AFTER DUCT-ONES REMOVE 1125 EX. 1440' FOC

SEE SHEET 23 TO MATCH SURVEY STA. 195+22

SEE SHEET 25 TO MATCH SURVEY STA. 195+48



DATE 11/10/2024

ENGINEER WOODMAN TELCOM

DRAWN BY Z.T.G. 100%

REVISIONS

DATE	DESCRIPTION	INITIALS
11/10/24	80% HORIZONTAL	LSV
03/11/25	100% PLANS	LSV

11/10/24 80% HORIZONTAL LSV

03/11/25 100% PLANS LSV

SCALE

HORIZONTAL 1" = 50'

VERTICAL 1" = N/A

MP TO MP

SHEET 26 OF 36

FILE 111024-1 2024

UNDERGROUND UTILITIES HAVE BEEN PLOTTED FROM AVAILABLE RECORDS AND FIELD OBSERVATIONS BUT ARE NOT NECESSARILY EXACT. IT IS THE CONTRACTOR'S RESPONSIBILITY TO FIELD LOCATE ALL UNDERGROUND OBSTRUCTIONS AND UTILITIES PRIOR TO CONSTRUCTION. COMPLETE REPAIR OF ANY AND ALL DAMAGES INCURRED SHALL BE AT THE EXPENSE OF THE CONTRACTOR.

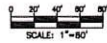

SCALE: 1" = 50'



CALL BEFORE YOU DIG
800-485-8888 or 811
72 HOURS NOTICE REQUIRED

RIVERSIDE, CA
RIVERSIDE COUNTY



PROJECT 111024-01
RIVERGATE 3RD ST GRADE SEPARATION
3310 VINE STREET
RIVERSIDE, CA 92507

CLASSIFICATION NO.	QUANTITY
PULL FIBER	1124
REMOVE FIBER	1124
PLACE MANHOLE	0
DIRECTIONAL BORE	0
TRENCH	0
PLACE DUCT	0



DATE 11/10/2024
ENGINEER WOODMAN TELCOM

DATE	DESCRIPTION	REVISION
11/10/24	90% INSTRUMENTAL	MSL
03/11/25	100% PLANS	MSL

NOT SCALE. SEE INSTRUMENTAL FOR EXACT QUANTITIES. THIS DRAWING AND INSTRUMENTAL REPRESENT THE INTENT OF THE PROJECT. CONTRACTOR SHALL VERIFY ALL DIMENSIONS AND CONDITIONS OF ALL UTILITIES PRIOR TO CONSTRUCTION.

SCALE	
HORIZONTAL	1" = 80'
VERTICAL	1" = N/A
MP	TO MP
SHEET	25 OF 30
FILE	111024-1 0204

SEE SHEET 24 TO MATCH SURVEY STA. 196+48

SEE SHEET 26 TO MATCH SURVEY STA. 307+72

PULL 180' (1) - 1440T FOC T-RU EX SPRINT 1440' DUCT SYSTEM
AFTER CUT-OVER REMOVE 180' EX. 1440T FOC

PULL 344' (1) - 1440T FOC THRU EX SPRINT 1440' DUCT SYSTEM
AFTER CUT-OVER REMOVE 344' EX. 1440T FOC

STA. 199+78
EXISTING SPRINT MH
ACCESS EX. VAULT TO PLACE NEW FIBER CABLE
- 120' COIL

UNDERGROUND UTILITIES HAVE BEEN PLOTTED FROM AVAILABLE RECORDS AND FIELD OBSERVATIONS BUT ARE NOT NECESSARILY EXACT. IT IS THE CONTRACTOR'S RESPONSIBILITY TO FIELD LOCATE ALL UNDERGROUND OBSTRUCTIONS AND UTILITIES PRIOR TO CONSTRUCTION. COMPLETE REPAIR OF ANY AND ALL DAMAGES INCURRED SHALL BE AT THE EXPENSE OF THE CONTRACTOR.

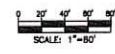

RIVERSIDE, CA
RIVERSIDE COUNTY



PROJECT: 111024-01
RIVERSIDE 1RD ST GRADE SEPARATION
331D VINE STREET
RIVERSIDE, CA 92507

CLARIFICATION NO.	QUANTITY
PULL FIBER	1124
REMOVE FIBER	1124
PLACE MANHOLE	0
DIRECTIONAL BORE	0
TRENCH	0
PLACE DUCT	0



DATE: 11/10/2024
ENGINEER: WOODMAN TELCOM
DRAWN BY: VLTG MW

DATE	DESCRIPTION	BY
11/10/24	80% HORIZONTAL	MW
09/11/23	100% PLANS	MW

NOTE: ALL UTILITIES SHOWN ARE BASED ON AVAILABLE RECORDS AND FIELD OBSERVATIONS. IT IS THE CONTRACTOR'S RESPONSIBILITY TO RELOCATE ALL UNDERGROUND OBSTRUCTIONS AND UTILITIES PRIOR TO CONSTRUCTION. COMPLETE REPAIR OF ANY AND ALL DAMAGES INCURRED SHALL BE AT THE EXPENSE OF THE CONTRACTOR.

SCALE
HORIZONTAL: 1" = 80'
VERTICAL: 1" = N/A
MP TO MP
SHEET 26 OF 35
FILE: 111024-01.DWG



CALL BEFORE YOU DIG
1-800-4-A-DIG
72 HOURS NOTICE REQUIRED

SEE SHEET 25 TO MATCH SURVEY STA. 207+72

SEE SHEET 27 TO MATCH SURVEY STA. 218+98

BULL 1124 (1) - 144CT FOC THRU EX. SPRINT (42") DUC. SYSTEM
AFTER PUT-OVER REMOVE 1124 EX. 144CT FOC

UNDERGROUND UTILITIES HAVE BEEN PLOTTED FROM AVAILABLE RECORDS AND FIELD OBSERVATIONS BUT ARE NOT NECESSARILY EXACT. IT IS THE CONTRACTOR'S RESPONSIBILITY TO RELOCATE ALL UNDERGROUND OBSTRUCTIONS AND UTILITIES PRIOR TO CONSTRUCTION. COMPLETE REPAIR OF ANY AND ALL DAMAGES INCURRED SHALL BE AT THE EXPENSE OF THE CONTRACTOR.

RIVERSIDE, CA
RIVERSIDE COUNTY



PROJECT: 111024-01
RIVERSIDE 1RD ST GRADE SEPARATION
3310 VINE STREET
RIVERSIDE, CA 92507

CLASSIFICATION NO.	QUANTITY
PULL FIBER	1125
REMOVE FIBER	1125
PLACE MAN-HOLE	0
DIRECTIONAL BORE	0
TRENCH	0
PLACE DUCT	5



DATE: 11/10/2024
ENGINEER: WOODMAN TELCOM

DRAWN BY: VLT, JG MW

DATE	DESCRIPTION	BY
11/10/24	60% HORIZONTAL	MSL
09/11/23	100% PLANS	MSL

SCALE

HORIZONTAL: 1" = 80'

VERTICAL: 1" = N/A

MP TO MP

SHEET 27 OF 30

FILE: 111024-01.DWG

SEE SHEET 26 TO MATCH SURVEY STA. 218+95

SEE SHEET 28 TO MATCH SURVEY STA. 230+24

PULL 122' (1) * 144CT FOC THRU EX SPRINT (4x2" DUCT SYSTEM)
AFTER CUT-OVER REMOVE 122' EX 144CT FOC

PULL 100' (1) * 44CT FOC THRU EX SPRINT (4x2" DUCT SYS'EM)
AFTER CUT-OVER REMOVE 100' EX 144CT FOC

SEA. HOLE
EXISTING SPRINT MH
ACCESS EX. WALL TO PLACE NEW FIBER CABLE
+ 100' COIL

UNDERGROUND UTILITIES HAVE BEEN PLOTTED FROM AVAILABLE RECORDS AND FIELD OBSERVATIONS BUT ARE NOT NECESSARILY EXACT. IT IS THE CONTRACTOR'S RESPONSIBILITY TO FIELD LOCATE ALL UNDERGROUND OBSTRUCTIONS AND UTILITIES PRIOR TO CONSTRUCTION, COMPLETE REPAIR OF ANY AND ALL DAMAGES INCURRED SHALL BE AT THE EXPENSE OF THE CONTRACTOR.



SCALE: 1"=80'



CALL BEFORE YOU DIG
800-4-A-DIGIT-1111
72 HOURS NOTICE REQUIRED

RIVERSIDE, CA
RIVERSIDE COUNTY



PROJECT 111024-01
RIVERSIDE 3RD ST GRACE SEPARATION
3310 VINE STREET
RIVERSIDE, CA 92507

CLARIFICATION NO.	QUANTITY
PULL FIBER	973
REMOVE FIBER	973
PLACE MANHOLE	0
DIRECTIONAL BORE	0
TRENCH	0
PLACE D-JCT	0



DATE 11/19/2024
ENGINEER WOODMAN TELCOM
DRAWN BY V.T.G MW

DATE	BY	REVISIONS
11/19/24	6558-SP/SPW	ISS
03/11/25	1024-PLANS	ISS

SCALE
HORIZONTAL: 1"= 80'
VERTICAL: 1"= N/A

MP TO MP
SHEET 28 OF 30
FILE: 111024-039A

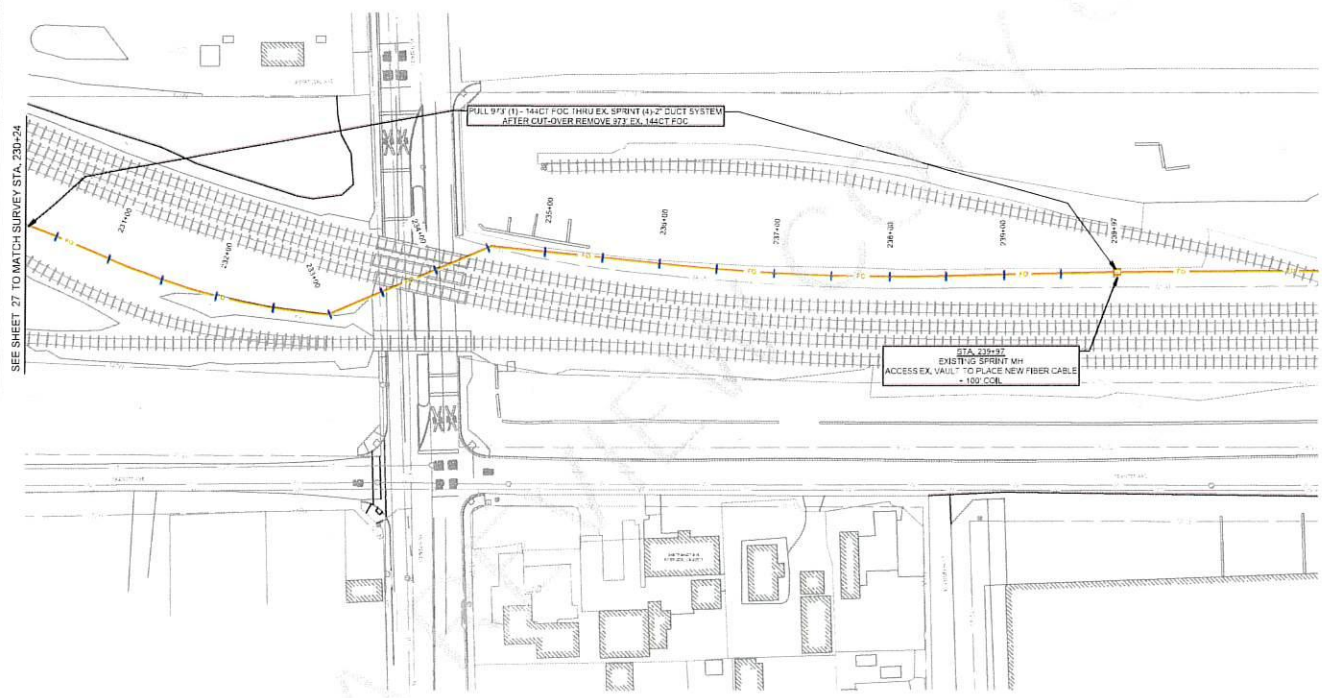

SEE SHEET 27 TO MATCH SURVEY STA. 230+24

UNDERGROUND UTILITIES HAVE BEEN PLOTTED FROM AVAILABLE RECORDS AND FIELD OBSERVATIONS BUT ARE NOT NECESSARILY EXACT. IT IS THE CONTRACTOR'S RESPONSIBILITY TO FIELD LOCATE ALL UNDERGROUND OBSTRUCTIONS AND UTILITIES PRIOR TO CONSTRUCTION. COMPLETE REPAIR OF ANY AND ALL DAMAGES INCURRED SHALL BE AT THE EXPENSE OF THE CONTRACTOR.

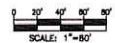
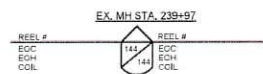

CALL BEFORE YOU DIG!
1-800-485-4811
72 HOURS NOTICE REQUIRED

Exhibit B
Scope of Work

CONFIDENTIAL

EXHIBIT "B"

PROJECT DESCRIPTION, LOCATION AND SCOPE OF WORK

TITLE: CA RIVERSIDE 3RD ST GRADE SEPARATION SPRINT RELOCATION PROJECT

Sprint Work Order No.: 92766SWII-020

1.0 DESCRIPTION AND LOCATION

- 1.1 The City of Riverside, CA. has proposed a grade separation project at 3rd street to cross under the existing BNSF Railroad tracks. The existing Sprint Fiber Optic running line that runs along the south side of the BNSF ROW will be relocated due to the proposed construction at this crossing.
- 1.2 The contractor shall relocate approximately 2,840' of the Sprint running line around the proposed construction at 3rd Street.
- 1.3 The contractor shall place (4) 2" conduits along the relocation route within the City of Riverside and BNSF Right of Way as shown on the Sprint Relocation Plans.
- 1.4 The Contractor shall Place (1) intercept manholes and (2) new manholes along the new relocation route.
- 1.5 The contractor shall place two new fiber optic cables as shown on the Sprint Proposed Construction Plan.
- 1.6 The contractor shall be present to assist the Sprint splicing team during the splicing of the two fiber optic cables on BNSF Right of Way.
- 1.7 The contractor shall remove all the old fiber optic cable within the abandoned Sprint running line on BNSF Right of Way.
- 1.8 The contractor shall remove the top half of all manholes being abandoned in place along the BNSF Right of Way due to the Sprint relocation at the 3rd street grade separation project.

2.0 SPECIFICATIONS

- 2.1 The work shall be performed in strict accordance with the Sprint Specifications for Construction, TS-0213 Construction, Installation and Splicing of Fiber Cable, Rev. 6-2019. Please note that this document contains references to specifications and manufacturers that may be out of date. Please refer all questions and inquiries regarding interpretations of this document to the Sprint Outside Plant Engineer.
- 2.2 Work within BNSF R.O.W. shall conform to BNSF standards. The contractor is hereby notified that all personnel entering the METRO/SCRRA R.O.W. must have current BNSF safety certification.
- 2.3 This JOB IS SUBJECT TO THE REQUIREMENTS OF BUY AMERICA as set forth in 23 USC 313 and 23 CFR 635. At the time of delivery of any iron or steel products which become a permanent part of this project, the Contractor shall provide documentation sufficient to meet the requirements of 23 CFR 635 certifying the iron or steel products were produced domestically. Prior to invoicing for material provided under this agreement, the contractor shall provide a full set of certification documents that are required by an auditor or any other relevant governmental entity to prove compliance with this requirement. Additionally, the contractor shall assure that the same degree of documentation is provided by all subcontractors and suppliers working under the

3.0 MATERIALS

- 3.1 The contractor shall provide all materials in accordance with the Specification stated in the TS-0213 Construction, Installing and Splicing USSCIS NO. SCIMOSP REV. 99-1.

- 3.2 The contractor shall provide all materials as may be needed to complete this project except cable, cable splicing hardware, route marker signs and any items proprietary to Sprint.

4.0 PERMITS

- 4.1 The contractor shall obtain any required BNSF Railroad approvals/Permits. This should include any flagging cost for the duration of the project and Safety Training for all personnel working on site.
- 4.2 The contractor shall obtain any City of Riverside Permits/Traffic Control plans as required for the project within the City of Riverside, CA. Due to the project being part of the 3rd Street Grade separation for the City of Riverside. This will be a NO FEE Permit.
- 4.3 Sprint shall pay the contractor the actual cost of the permit plus a 15% markup for all permits required for this project.
- 4.4 The contractor shall provide copies of all permits to Sprint prior to proceeding with the work and shall provide copies of all final acceptance documents after the work is completed and before final invoicing.

5.0 BILLING AND COMMERCIAL TERMS

- 5.1 The contractor shall submit invoices via email. Invoice payment terms shall be net 60 days from the date the invoice is submitted via email to OSP Engineer. Contractor shall submit a "paper" invoice to the OSP Engineer for review and approval. It is preferred that they are emailed PDF documents.
- 5.2 Prior to billing for any work that is subject to a preliminary lien notice, the contractor shall secure and provide an unconditional release for each preliminary notice. Contractor shall notify all suppliers that they may provide preliminary lien notices to Sprint. The appropriate address for Sprint is 282 S. Sycamore Ave, Rialto, CA 92376 ATTN : Jeffrey York

6.0 LOCATES

- 6.1 The contractor shall be responsible for all locates of other utilities and/or substructures. No excavation work shall be permitted until all locates are performed. All existing substructures shall be positively identified prior to and during excavation activity.
- 6.2 Note that this work is within BNSF right of way that contains signal facilities. The contractor is responsible for securing and keeping current dig tickets for BNSF. Call before you dig is 800-336-9193. BNSF Signal Department # 800-832-5452.

7.0 THE WORK

- 7.1 The contractor shall survey the proposed running line as needed for the relocation. A third-party contractor can be used for the survey if needed.
- 7.2 The contractor shall use a directional bore or trench to place 2,190' LF of (4) 2" HDPE conduit along the proposed path shown of the Relocation Plans.
- 7.3 The contractor shall place an Edison Mix Concrete Encasement around the newly installed conduit system at all locations where the conduit system is trenched in. This includes bore pit locations.
- 7.4 The contractor shall use a wire line bore to place 644 LF of 8" HDPE under the proposed grade separation at 3rd street. Due to the depth of the bore 760' of 8" HDPE pipe will be ordered to complete this bore. 4-2" HDPE innerduct shall be placed inside the 8" HDPE pipe. One 1 ¼ " HDPE will be pulled in on the outside of the 8" for the locate wire to be installed.
- 7.5 The contractor shall have compaction testing as required by the City of Riverside for all trench work being performed.
- 7.6 The contractor shall butt weld each segment of 8" steel pipe for the bore under 3rd street prior to installation.

- 7.7 The contractor shall prove the existing conduit system and the new relocation path for the installation of the new 144c and 36c fiber optic cable from splice to splice. Once the grade separation project has been completed by the City of Riverside the contractor shall return and prove the 2-2" vacant HDPE from the beginning of the relocation at MH #30 to MH #29. Refer to the Proposed Relocation Construction Plans for details. (Approximately 70,000' of 3/4" mule tape to be placed)
- 7.8 The contractor shall request and install a water meter from the City of Riverside during the construction of the Sprint relocation for the 3rd street project.
- 7.9 The contractor shall place (1) 4'x6'x6' intercept manholes and (2) 4'x6'x6' new manholes along the relocation path as shown on the Relocation Plans. The contractor shall be responsible for installing the manhole so that the manhole cover is at final grade. The depth of the excavation needed shall include 6" minimum below the bottom of the manhole for pea gravel placement. Each manhole requires 18" of grade rings below the steel ring and cover. Each manhole requires a 9'- 5/8" copper ground rod to be installed inside the box. The new lid must have the SPRINT logo. Refer to the Proposed Relocation Plans for details for the manhole installation.
- 7.10 The contractor shall replace the curb and gutter and sidewalk after the installation of the MH at Sta. 67+00 on Mission Inn Avenue.
- 7.11 The contractor shall place a 8'x8' concrete apron at both intercept manhole location if required. Refer to the Proposed Relocation Plans for details.
- 7.12 The contractor shall place (12) 2" true nominal Jackmoon Blank Duct Plugs and (12) true nominal Jackmoon Simplex Duct Plugs at each new manhole location.
- 7.13 The contractor shall place 18,068' of 144c Fiber Optic cable through existing manhole locations on BNSF ROW and City of Riverside Streets. This includes 66' of slack at each pull through manhole and 120' of slack at each splice point. Refer to the Proposed Relocation Plans.
- 7.14 The contractor shall have an overnight guard for (3) nights to watch over the 144c fiber optic reel and the 36c reel during the installation.
- 7.15 The contractor shall place 14,047' of 36c Fiber Optic cable through existing manhole locations on BNSF ROW and City of Riverside Streets. This includes 66' of slack at each pull through manhole and 120' of slack at each splice point. Refer to the Proposed Relocation Plans
- 7.16 The contractor shall have a crew on site for (2) days to Support the Sprint splicing crew and provide safety measures at each manhole location. The contractor shall bolt, and weld shut each manhole at the end of each workday and once splicing is complete. Support crew shall provide OSHA required safety measures and equipment, open each affected manhole, retrieve, and clean the affected cable that is to be spliced, and hand it to the splicers before the splicing. Once splicing is complete, the crew will retrieve the cable from the splicers, neatly rack it in the manhole, stow the splice case to the Sprint Inspector's satisfaction, close, bolt and weld the manhole cover shut.
- 7.17 The contractor shall remove 18,050' of 144c fiber from the existing Sprint R/L along the BNSF ROW. Refer to the Proposed Relocation Plans.
- 7.18 The contractor shall remove 14,500' of 36c fiber from the existing Sprint R/L along the BNSF ROW. Refer to the Proposed Relocation Plans.
- 7.19 The contractor shall legally dispose of a total of 32,550' of fiber optic cable. This is an OPEX expense.
- 7.20 The contractor shall remove the ring and cover, grade rings and the top section of the (2) abandoned Sprint manholes along the BNSF ROW and back fill with 0-Sac concrete mix to grade for 100% compaction at these sites. All material must be legally disposed of by the contractor.
- 7.21 The contractor shall place (6) 9' galvanized steel signpost: 2.5lbs/ft with 3/8" holes, each 1" apart. Signs and trifold markers will be provided by Sprint.
- 7.22 The contractor shall place one neck mounted fink at MH Sta. 79+50 and one neck mounted fink at MH Sta 86+00 and terminate to ground Rod in each MH.
- 7.23 The contractor shall place 800' of 10AWG COPPER LOCATE WIRE between MH 79+50 and MH 86+00. This wire will connect to the finks at both ends of the deep bore for locating purposes.

The contractor shall clean up any construction debris and shall leave the construction sites neat and clean each day.

Extreme caution shall be used when performing any work on or near the conduits and cables. Under NO circumstances shall any work be performed that may cause the cable(s) to be damaged or cut. All work involving live fiber optic cables and conduits shall be performed under the direct supervision of the owner of the cable.

8.0 Notices

8.1 The contractor shall contact the following, one full week prior to commencing construction:

Underground Service Alert of California (800) 227-2600
BNSF Signal.
JEFF YORK – SPRINT OSP ENGINEER WEST – 213-943-9831
BRIAN SMITH – ASSISTANT OSP ENGINEER – 949-226-1980
SCOTT BACSIKIN -PE HDR – 714-345-4609

END SCOPE OF WORK

MATERIAL LIST

This is a guide and may not include all materials to complete the project. (See the Engineer for Sprint Materials List for acceptable materials.)

MATERIAL SUPPLIED BY THE CONTRACTOR

- 13,000' OF 2" SDR-11 HDPE CONDUIT (ORANGE)
- DURALINE 2" COUPLERS AS NEEDED FOR THE HDPE CONDUIT INSTALL. <https://www.duraline.com/accessories/Couplers/Clear-Lock-4091>
- 800' OF 8" HDPE to fit (4) 2" HDPE
- 800' of 1.25" HDPE
- 800' of 10AWG COPPER LOCATE WIRE
- Copper wire as needed to Ground out the two FINKS inside MH STA 79+50 and Sta. 86+00
- (1) 4'X6'X6' INTERCEPT MANHOLES WITH A MINIMUM OF 18" OF GRADE RINGS PER SPRINT PROTOCOL. RING AND COVER WITH THE SPRINT LOGO. (REFER TO THE CONSTRUCTION PACKAGE FOR MANHOLE DETAILS)
- (2) 4'X6'X6' MANHOLES WITH A MINIMUM OF 18" OF GRADE RINGS PER SPRINT PROTOCOL. RING AND COVER WITH THE SPRINT LOGO. (REFER TO THE CONSTRUCTION PACKAGE FOR DETAILS)
- 1/4" WASHED PEA GRAVEL FOR THE BASE OF EACH MANHOLE PLACEMENT.
- (4) 9'x 5/8" GROUNDING RODS. ONE FOR EACH NEW MANHOLE PLACED.

- JOINT SEALING COMPOUNDS AND WHITE LATEX PAINT FOR THE INTERIOR OF THE NEW MANHOLE
- (12) 2" JACKMOON SIMPLEX DUCT PLUGS
- (12) 2" JACKMOON VACANT DUCT PLUG
- EDISON MIX CONCRETE TO ENCASE THE (4) 2" HDPE CONDUIT IF INSTALLED BY TRENCH. (STANDARD ENCASEMENT IS 3" ON EACH SIDE OF THE CONDUIT, 3" BELOW THE CONDUIT AND 6" ON TOP OF THE CONDUIT).
- CONCRETE FOR THE PLACEMENT OF THE 8'X8' APRON AT BOTH INTERCEPT MH LOCATIONS ON THE BNSF ROW
- SLURRY BACKFILL AROUND ALL MH'S INSTALLED
- (6) 9' GALVANIZED STEEL SIGNPOST: 2.5LBS/FT WITH 3/8" HOLES, EACH 1" APART. SIGNS WILL BE PROVIDED BY SPRINT

MATERIAL SUPPLIED BY SPRINT

- 144 Count Fiber Reel (18,068' / 5,507M)
- 36 Count Fiber Reel (14,047' / 4,282M)
- (2) Neck Mounting FINK
- Sprint Warning tape (As Needed)
- EMS Markers (As Needed)
- Sprint Signs (As Needed)
- All splicing material

**Exhibit C
Cost Estimate**

CONFIDENTIAL

'Exhibit C'

PROJECT 92766SWII-020 CONSTRUCTION ESTIMATE
RIVERSIDE, CA. 3RD STREET GRADE SEPARATION SPRINT RELOCATION PROJECT
SPRINT CONSTRUCTION COST ESTIMATE
ESTIMATE SEPT. 22, 2025

This is an estimate for funding the construction of the relocation of the Sprint system for the Riverside 3rd street grade separation project. The Sprint contractor will be relocation 2,840' from Mission Inn Ave. working east along Commerce street and under the proposed 3rd street grade separation meeting back on to the BNSF right of way. Two new Fiber Optic cables will be placed from existing splice to splice per Sprint protocol during the relocation and the existing system along the BNSF right of way will be abandoned in place as shown on the Proposed Construction Plan. BNSF Approval Still Pending. Any changes by BNSF could impact this estimate.

The work included :

1. Labor, material cost.
2. Engineering, Inspection cost/As-Built update.
3. Coordination with the City of Riverside, BNSF and HDR
4. Sprint internal cost (G & A Overhead).

All work on Sprint's facilities will need to be performed by Sprint personnel and/or Sprint approved contractors.

This estimate includes all cost associated with the construction to take place in the City of Riverside, CA, and along BNSF ROW. The proposed relocation plans have been approved by the City of Riverside and it's construction coordinator contractor HDR. BNSF Approval Still Pending.

					Const. Agmt
Sprint Labor - Internal					
Outside Plant Engineer	40	hours	\$95	\$3,800	
Technician, stand by	260	hours	\$95	\$24,700	
Engineering Records	24	hours	\$95	\$760	
Subtotal					\$29,260
Sprint Contract Professional Services					
Engineering / Inspection	700	hours	\$100	\$70,000	
Legal Fees - Stinson	1	Estimate		\$46,000	
Subtotal					\$115,000
Sprint Contract Vendor Labor, Equipment and Material					
Contractor construction estimate	0	Estimate	\$0	\$669,950	
BNSF Railroad Flagging/Permits	0	hours	\$0	\$92,000	
Subtotal					\$761,950
Sprint Materials					
Splice / Materials				\$3,000.00	
Fiber Optic Cable (16 weel Lead)	4800	meters	\$2.33	\$11,184.00	
Fiber Optic Cable (16 weel Lead)	6100	meters	\$3.50	\$21,350.00	
Cable Reel Lagging	2	ea	\$125	\$250.00	
MISC WARNING SIGNS/TAPE/FIN	1		\$1,000	\$1,000.00	
Subtotal					\$36,784
Project Subtotal					\$942,994
G & A Overhead @27.63% of overall project cost					\$260,549
Project Total					\$1,203,543









Riverside, CA (Reimbursement Agreement) Cogent Cover Sheet

Final Audit Report

2026-02-03

Created:	2026-02-03
By:	Kevin Stoneman (kstoneman@cogentco.com)
Status:	Signed
Transaction ID:	CBJCHBCAABAAoy345uuJ9tBn27GpoX732wFSnVoEQsst

"Riverside, CA (Reimbursement Agreement) Cogent Cover Sheet" History

-  Document created by Kevin Stoneman (kstoneman@cogentco.com)
2026-02-03 - 4:03:49 PM GMT - IP address: 38.5.4.34
-  Document emailed to dtimm@cogentco.com for signature
2026-02-03 - 4:13:14 PM GMT
-  Email viewed by dtimm@cogentco.com
2026-02-03 - 5:03:37 PM GMT - IP address: 38.5.4.34
-  Signer dtimm@cogentco.com entered name at signing as Doug Timm
2026-02-03 - 5:04:02 PM GMT - IP address: 38.5.4.34
-  Document e-signed by Doug Timm (dtimm@cogentco.com)
Signature Date: 2026-02-03 - 5:04:04 PM GMT - Time Source: server- IP address: 38.5.4.34
-  Document emailed to dkapp@cogentco.com for signature
2026-02-03 - 5:04:16 PM GMT
-  Email viewed by dkapp@cogentco.com
2026-02-03 - 5:10:28 PM GMT - IP address: 149.127.109.2
-  Signer dkapp@cogentco.com entered name at signing as David Kapp
2026-02-03 - 5:11:47 PM GMT - IP address: 149.127.109.2
-  Document e-signed by David Kapp (dkapp@cogentco.com)
Signature Date: 2026-02-03 - 5:11:49 PM GMT - Time Source: server- IP address: 149.127.109.2- Signature captured from device with phone number XXXXXXX3037

 Document emailed to Robert Bowman (rbowman@cogentco.com) for signature

2026-02-03 - 5:12:03 PM GMT

 Email viewed by Robert Bowman (rbowman@cogentco.com)

2026-02-03 - 5:26:49 PM GMT- IP address: 66.28.3.2

 Document e-signed by Robert Bowman (rbowman@cogentco.com)

Signature Date: 2026-02-03 - 5:27:15 PM GMT - Time Source: server- IP address: 66.28.3.2

 Document emailed to mhayden@cogentco.com for signature

2026-02-03 - 5:27:28 PM GMT

 Email viewed by mhayden@cogentco.com

2026-02-03 - 5:37:23 PM GMT- IP address: 136.33.148.172

 Signer mhayden@cogentco.com entered name at signing as Melissa Hayden

2026-02-03 - 5:38:37 PM GMT- IP address: 136.33.148.172

 Document e-signed by Melissa Hayden (mhayden@cogentco.com)

Signature Date: 2026-02-03 - 5:38:39 PM GMT - Time Source: server- IP address: 136.33.148.172

 Document emailed to dschaeffer@cogentco.com for signature

2026-02-03 - 5:38:51 PM GMT

 Email viewed by dschaeffer@cogentco.com

2026-02-03 - 5:43:58 PM GMT- IP address: 66.28.3.2

 Signer dschaeffer@cogentco.com entered name at signing as Dave Schaeffer

2026-02-03 - 5:46:28 PM GMT- IP address: 66.28.3.2

 Document e-signed by Dave Schaeffer (dschaeffer@cogentco.com)

Signature Date: 2026-02-03 - 5:46:30 PM GMT - Time Source: server- IP address: 66.28.3.2

 Agreement completed.

2026-02-03 - 5:46:30 PM GMT