

EXHIBIT "A"
Legal Description

Project: Whittier Place Vacation

Location: Whittier Place between the Northwestern line of Market Street
and Southeasterly, of Vacated Chestnut Street

That certain real property located in the City of Riverside, County of Riverside, State of California, described as follows:

That portion of Whittier Place, 23 feet in width, lying Southeasterly of the Southwesterly prolongation of the Northwestern line of Lot 25 in Block 2 of DR. C. WHITTIER'S SUBDIVISION, on file in Book 3 of Maps, at Page 7 (formerly referred to as Page 8) thereof, Records of San Bernardino County, California, and lying Northwesternly of the Southwesterly prolongation of the Southeasterly line of Lot 1 in Block 1 of said DR. C. WHITTIER'S SUBDIVISION.

Area = 10,895 sq. ft.

This description was prepared by me or under my direction in conformance with the requirements of the Land Surveyors Act.

DBW 12/3/2025 Prep. dbw
Douglas B. Webber, L.S. 9477 Date



EXHIBIT A

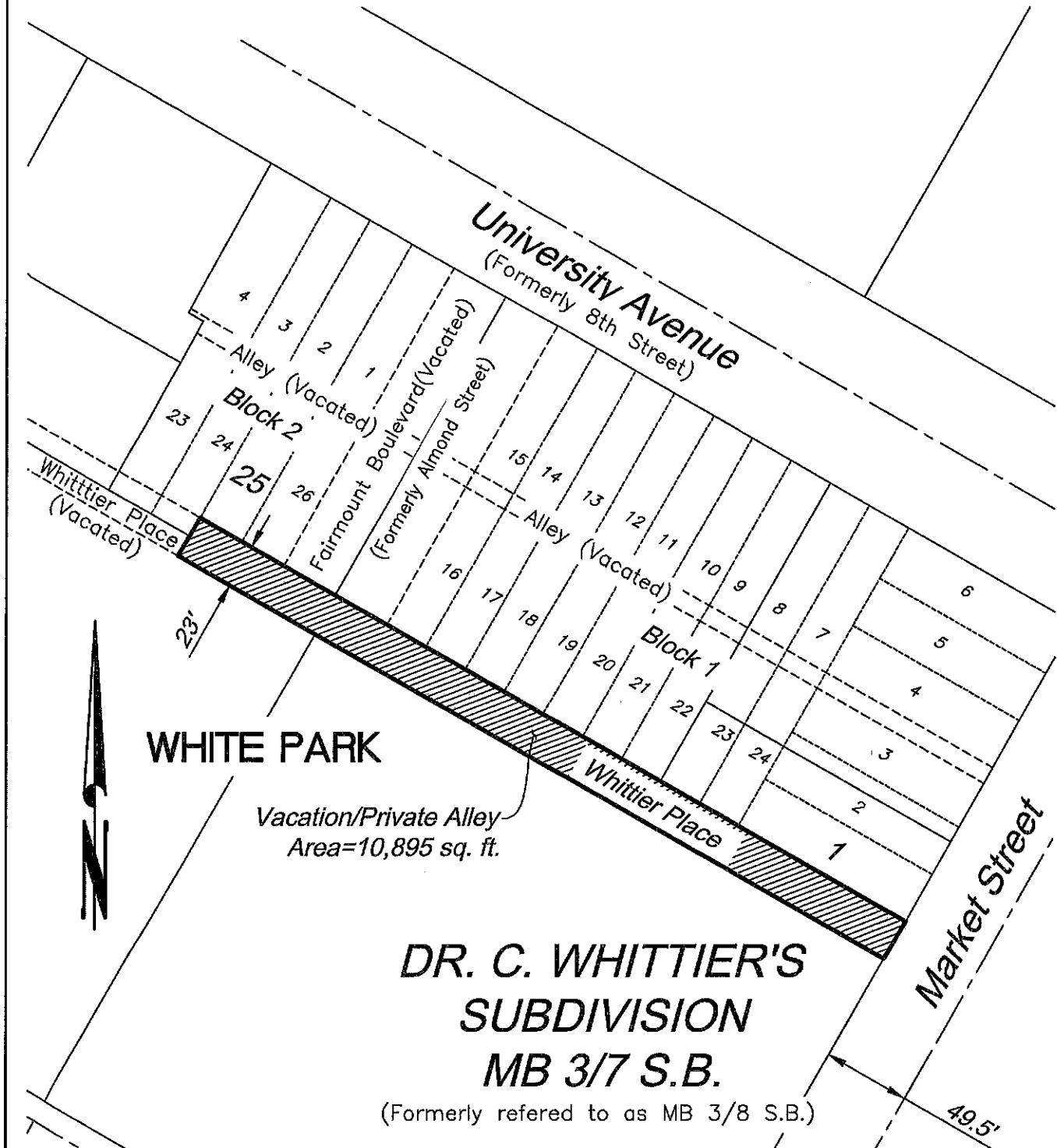

• CITY OF RIVERSIDE, CALIFORNIA •

THIS PLAT IS SOLELY AN AID IN LOCATING THE PARCEL(S) DESCRIBED IN THE ATTACHED DOCUMENT. IT IS NOT A PART OF THE WRITTEN DESCRIPTION THEREIN.

SHEET 1 OF 1

SCALE: 1' = 80'

DRAWN BY: dbw DATE: 6/11/25

SUBJECT: Whittier Place - Vacation