

McKenna et al.

History/Archaeology/Architectural History/Ethnography/Paleontology

Jeanette A. McKenna, MA
Reg. Professional Archaeologist
Owner and Principal Investigator

January 28, 2014

Soboba Band of Luiseno Indians
Attn: Joseph Ontiveros, Cultural Resources Dept.
P.O. Box 487
San Jacinto, California 92581

RE: 8.8 Acre Development, Riverside, Riverside County, CA.

Mr. Ontiveros:

McKenna et al. is initiating the cultural resources investigations for an 8.8 acre property in the City of Riverside, Riverside County, CA. The property is located at the intersection of La Sierra Avenue and Victoria Avenue and has been historically used for citrus growth (see attached aerial photograph). Although there has been some minor alterations to the property in recent years, there has never been a structure on the property and a previous survey yielded no evidence of prehistoric resources.

Illustrated on the attached USGS Riverside West Quadrangle, the project area is identified as being within Township 3 South, Range 6 West, and within portions of Sections 24 and 25. The surrounding properties have been redeveloped as residential properties (post-1980) and the Victoria Avenue right-of-way has been identified by the City as a locally significant resource.

Please review your records and inform me of any concerns or issues you may have with respect to this property. Comments received will be incorporated into the final report and, therefore, I request you respond in writing for the official record. Please do not hesitate to contact me should you need additional information regarding this project.

Sincerely,

Jeanette A. McKenna

Jeanette A. McKenna, Principal
McKenna et al.

February 4, 2014

Attn: Jeanette A. McKenna, Principal
McKenna et al.
6008 Friends Avenue
Whittier, CA 90601-3724



Re: 8.8 acre Development on the southeast corner of Victoria and La Sierra, City of Riverside, Riverside County

The Soboba Band of Luiseño Indians appreciates your observance of Tribal Cultural Resources and their preservation in your project. The information provided to us on said project has been assessed through our Cultural Resource Department, where it was concluded that although it is outside the existing reservation, the project area does fall within the bounds of our Tribal Traditional Use Areas.

Soboba Band of Luiseño Indians is requesting the following:

1. To initiate a consultation with the Project Developer and Land owner.
2. The transfer of information to the Soboba Band of Luiseño Indians regarding the progress of this project should be done as soon as new developments occur.
3. Soboba Band of Luiseño Indians continues to act as a consulting tribal entity for this project.
4. Working in and around traditional use areas intensifies the possibility of encountering cultural resources during the construction/excavation phase. For this reason the Soboba Band of Luiseño Indians requests that Native American Monitor(s) from the Soboba Band of Luiseño Indians Cultural Resource Department to be present during any ground disturbing proceedings. **Including surveys and archaeological testing.**
5. Request that proper procedures be taken and requests of the tribe be honored (Please see the attachment)

Sincerely,

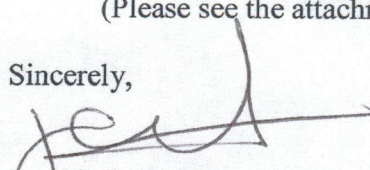
Joseph Ontiveros
Director of Cultural Resources
Soboba Band of Luiseño Indians
P.O. Box 487
San Jacinto, CA 92581
Phone (951) 654-5544 ext. 4137
Cell (951) 663-5279
jontiveros@soboba-nsn.gov

Cultural Items (Artifacts). Ceremonial items and items of cultural patrimony reflect traditional religious beliefs and practices of the Soboba Band. The Developer should agree to return all Native American ceremonial items and items of cultural patrimony that may be found on the project site to the Soboba Band for appropriate treatment. In addition, the Soboba Band requests the return of all other cultural items (artifacts) that are recovered during the course of archaeological investigations. When appropriate and agreed upon in advance, the Developer's archeologist may conduct analyses of certain artifact classes if required by CEQA, Section 106 of NHPA, the mitigation measures or conditions of approval for the Project. This may include but is not limited or restricted to include shell, bone, ceramic, stone or other artifacts.

The Developer should waive any and all claims to ownership of Native American ceremonial and cultural artifacts that may be found on the Project site. Upon completion of authorized and mandatory archeological analysis, the Developer should return said artifacts to the Soboba Band within a reasonable time period agreed to by the Parties and not to exceed (30) days from the initial recovery of the items.

Treatment and Disposition of Remains.

A. The Soboba Band shall be allowed, under California Public Resources Code § 5097.98 (a), to (1) inspect the site of the discovery and (2) make determinations as to how the human remains and grave goods shall be treated and disposed of with appropriate dignity.

B. The Soboba Band, as MLD, shall complete its inspection within twenty-four (24) hours of receiving notification from either the Developer or the NAHC, as required by California Public Resources Code § 5097.98 (a). The Parties agree to discuss in good faith what constitutes "appropriate dignity" as that term is used in the applicable statutes.

C. Reburial of human remains shall be accomplished in compliance with the California Public Resources Code § 5097.98 (a) and (b). The Soboba Band, as the MLD in consultation with the Developer, shall make the final discretionary determination regarding the appropriate disposition and treatment of human remains.

D. All parties are aware that the Soboba Band may wish to rebury the human remains and associated ceremonial and cultural items (artifacts) on or near, the site of their discovery, in an area that shall not be subject to future subsurface disturbances. The Developer should accommodate on-site reburial in a location mutually agreed upon by the Parties.

E. The term "human remains" encompasses more than human bones because the Soboba Band's traditions periodically necessitated the ceremonial burning of human remains. Grave goods are those artifacts associated with any human remains. These items, and other funerary remnants and their ashes are to be treated in the same manner as human bone fragments or bones that remain intact.

Coordination with County Coroner's Office. The Lead Agencies and the Developer should immediately contact both the Coroner and the Soboba Band in the event that any human remains are discovered during implementation of the Project. If the Coroner recognizes the human remains to be those of a Native American, or has reason to believe that they are those of a Native American, the Coroner shall ensure that notification is provided to the NAHC within twenty-four (24) hours of the determination, as required by California Health and Safety Code § 7050.5 (c).

Non-Disclosure of Location Reburials. It is understood by all parties that unless otherwise required by law, the site of any reburial of Native American human remains or cultural artifacts shall not be disclosed and shall not be governed by public disclosure requirements of the California Public Records Act. The Coroner, parties, and Lead Agencies, will be asked to withhold public disclosure information related to such reburial, pursuant to the specific exemption set forth in California Government Code § 6254 (r).

Ceremonial items and items of cultural patrimony reflect traditional religious beliefs and practices of the Soboba Band. The Developer agrees to return all Native American ceremonial items and items of cultural patrimony that may be found on the project site to the Soboba Band for appropriate treatment. In addition, the Soboba Band requests the return of all other cultural items (artifacts) that are recovered during the course of archaeological investigations. Where appropriate and agreed upon in advance, Developer's archeologist may conduct analyses of certain artifact classes if required by CEQA, Section 106 of NHPA, the mitigation measures or conditions of approval for the Project. This may include but is not limited or restricted to include shell, bone, ceramic, stone or other artifacts.

McKenna et al.

History/Archaeology/Architectural History/Ethnography/Paleontology

Jeanette A. McKenna, MA
Reg. Professional Archaeologist
Owner and Principal Investigator

January 28, 2014

Gabrielino/Tongva Nation
Attn: Sam Dunlap, Cultural Resources Director
P.O. Box 86908
Los Angeles, California 90086

RE: 8.8 Acre Development, Riverside, Riverside County, CA.

Mr. Dunlap:

McKenna et al. is initiating the cultural resources investigations for an 8.8 acre property in the City of Riverside, Riverside County, CA. The property is located at the intersection of La Sierra Avenue and Victoria Avenue and has been historically used for citrus growth (see attached aerial photograph). Although there has been some minor alterations to the property in recent years, there has never been a structure on the property and a previous survey yielded no evidence of prehistoric resources.

Illustrated on the attached USGS Riverside West Quadrangle, the project area is identified as being within Township 3 South, Range 6 West, and within portions of Sections 24 and 25. The surrounding properties have been redeveloped as residential properties (post-1980) and the Victoria Avenue right-of-way has been identified by the City as a locally significant resource.

Please review your records and inform me of any concerns or issues you may have with respect to this property. Comments received will be incorporated into the final report and, therefore, I request you respond in writing for the official record. Please do not hesitate to contact me should you need additional information regarding this project.

Sincerely,

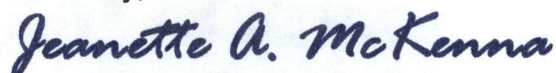

Jeanette A. McKenna, Principal
McKenna et al.

APPENDIX D:
Paleontological Overview

APPENDIX D:
Paleontological Overview



NATURAL HISTORY MUSEUM
OF LOS ANGELES COUNTY

Vertebrate Paleontology Section
Telephone: (213) 763-3325
FAX: (213) 746-7431
e-mail: smcleod@nhm.org

4 August 2004

McKenna et al.
6008 Friends Avenue
Whittier, California 90601-3724

Attn: Jeanette A. McKenna

re: Paleontological resources for the proposed residential development in the La Sierra area, Riverside County, (Sect. 9+10, T 3 S, R 6 W), project area

Dear Jeanette:

I have conducted a thorough search of our paleontology collection records for the locality and specimen data for the proposed residential development in the La Sierra area, Riverside County, (Sect. 9+10, T 3 S, R 6 W), project area as outlined on the section of the Corona North USGS topographic quadrangle map that you sent to me on 30 July 2004. We do not have any vertebrate fossil localities that lie directly within the proposed project boundaries, but we do have a locality nearby that occurs in sedimentary deposits similar to those that occur in the proposed project area.

Almost all of the proposed project area has bedrock composed of various types of plutonic granitic rocks that, of course, will be devoid of fossils. In the eastern-most part of the proposed project area, however, there are deposits of older terrestrial Quaternary (Late Pleistocene) alluvial fan deposits derived from the hills immediately west. Our closest fossil vertebrate locality from similar Quaternary deposits is LACM 1207, west-southwest of the proposed project area immediately north of Corona in the Temescal Wash, that produced a fossil specimen of deer, *Odocoileus*.

Excavations in the granitic bedrock occurring throughout almost all of the proposed project area will not encounter any fossils. Excavations in the older Quaternary sediments in the eastern-most portion of the proposed project area, however, may well encounter significant vertebrate fossils, similar to those from the Rancho La Brea asphalt deposits in Los Angeles, and thus should be monitored closely to quickly and professionally recover any fossil remains discovered while not impeding development. The University of California at Riverside Department of Geology (collections and records now at the University of California at Berkeley Museum of Paleontology) may also have records that further document fossil vertebrate localities in the area. Any fossils recovered during mitigation should be deposited in an accredited and permanent scientific institution for the benefit of current and future generations.

This records search covers only the vertebrate paleontology records of the Natural History Museum of Los Angeles County. It is not intended to be a thorough paleontological survey of the proposed project area covering other institutional records, a literature survey, or any potential on-site survey.

Sincerely,

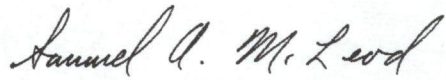
A handwritten signature in cursive script that reads "Samuel A. McLeod". The signature is written in black ink and is positioned above the typed name.

Samuel A. McLeod, Ph.D.
Vertebrate Paleontology

enclosure: invoice

APPENDIX E:
Supplemental Research Data

APPENDIX E:
Supplemental Research Data

(W. 1/2 of) Rancho el Sobrante de San Jacinto.

S. J. Estate, Ltd.

Scale: 1 in = 40 chains.

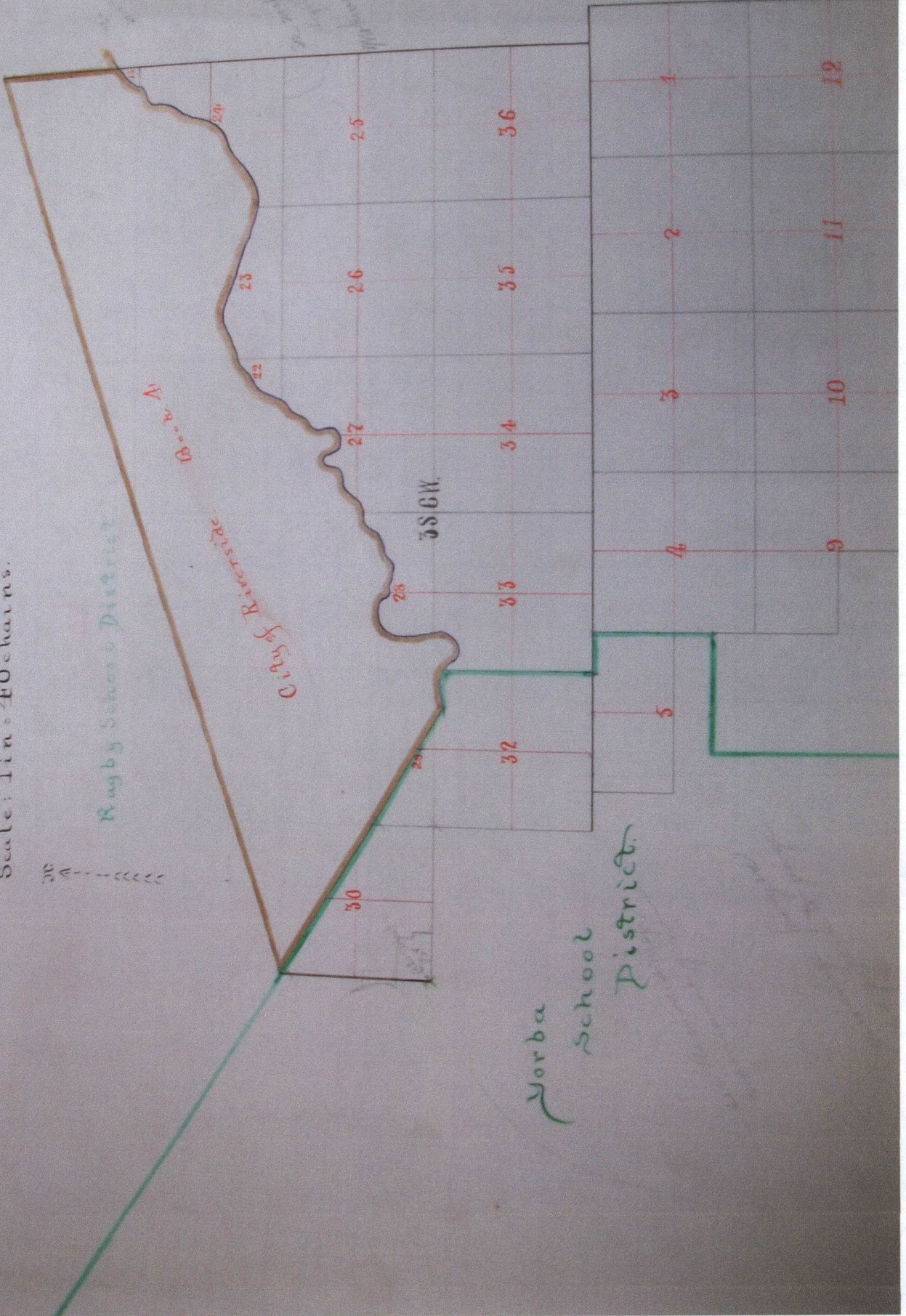
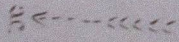

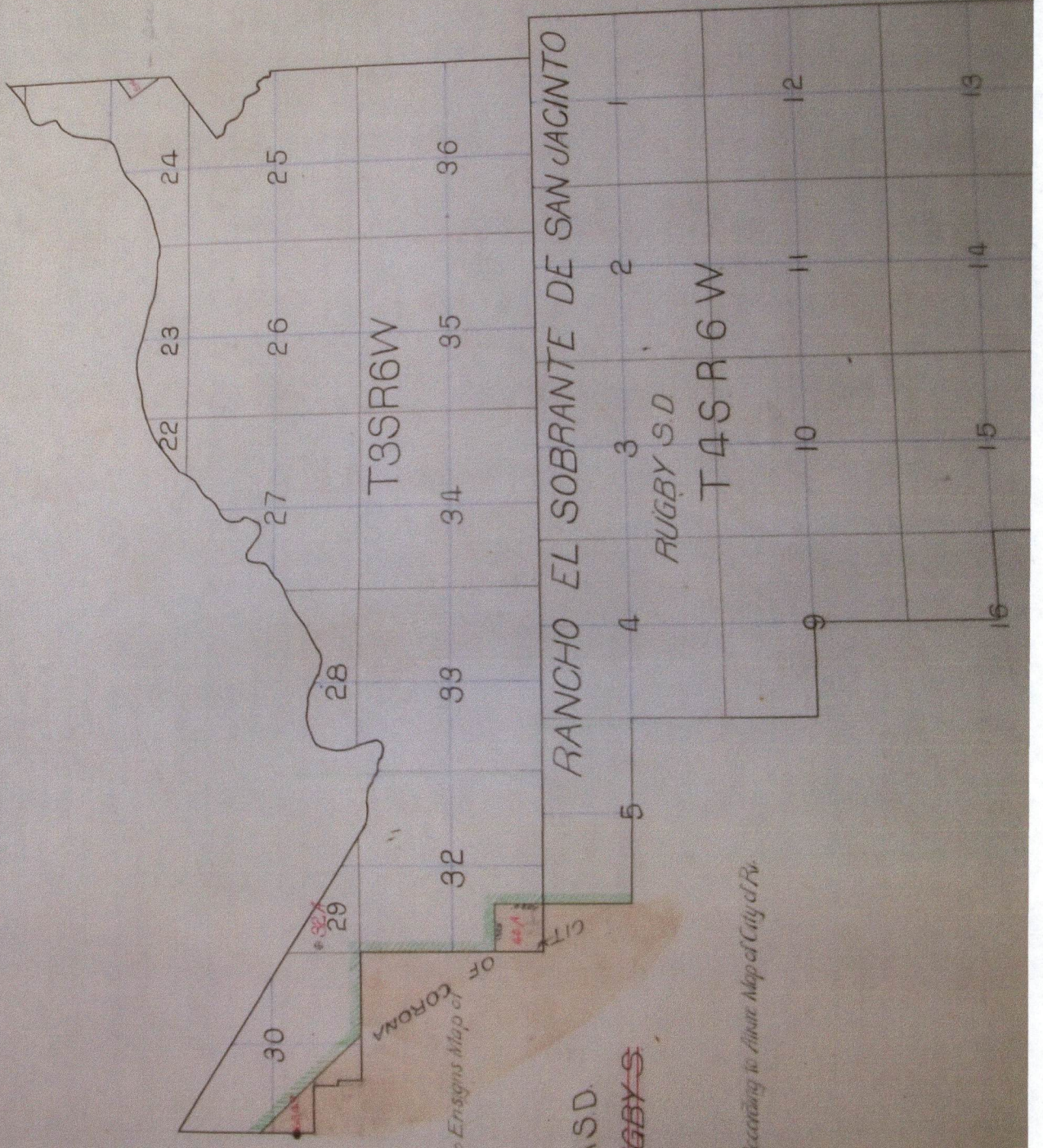

According to Ensigns Map of Rancho

YORBA S.D.

~~RUGBY S.~~

According to Abbot Map of City of Pa.

