

WROUGHT IRON FENCE ELEVATION

NTS. - NOTE SEPARATION BETWEEN WROUGHT IRON RODS IS 4" THEREFORE MESH TO DECREASE THE OPENING TO 1" MAX

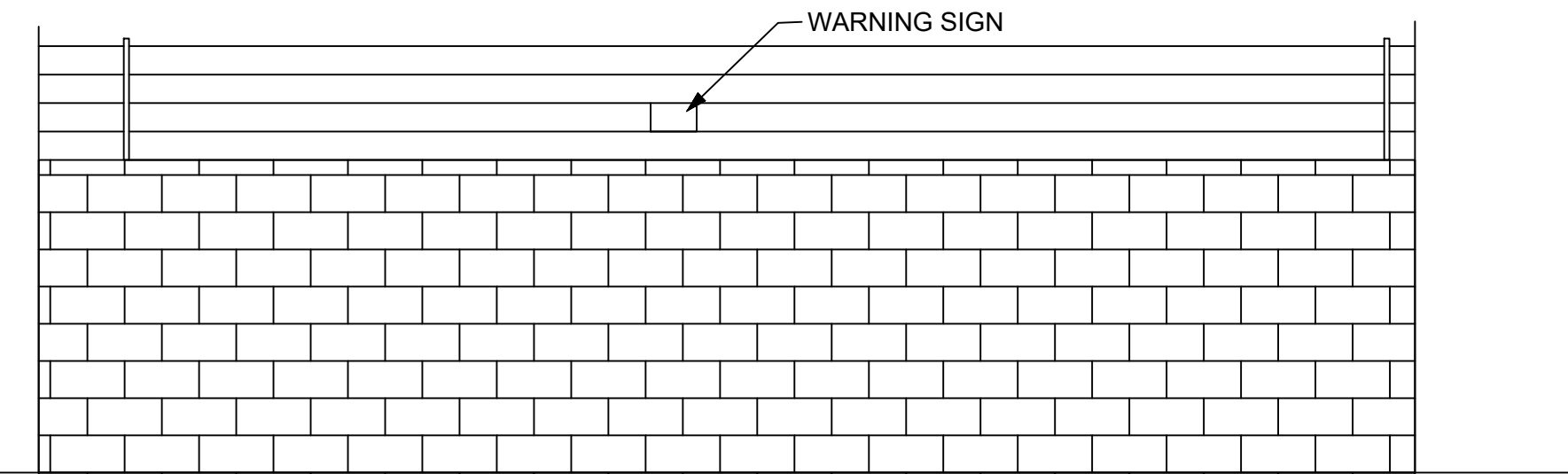

MASONRY WALL ELEVATION

NTS.

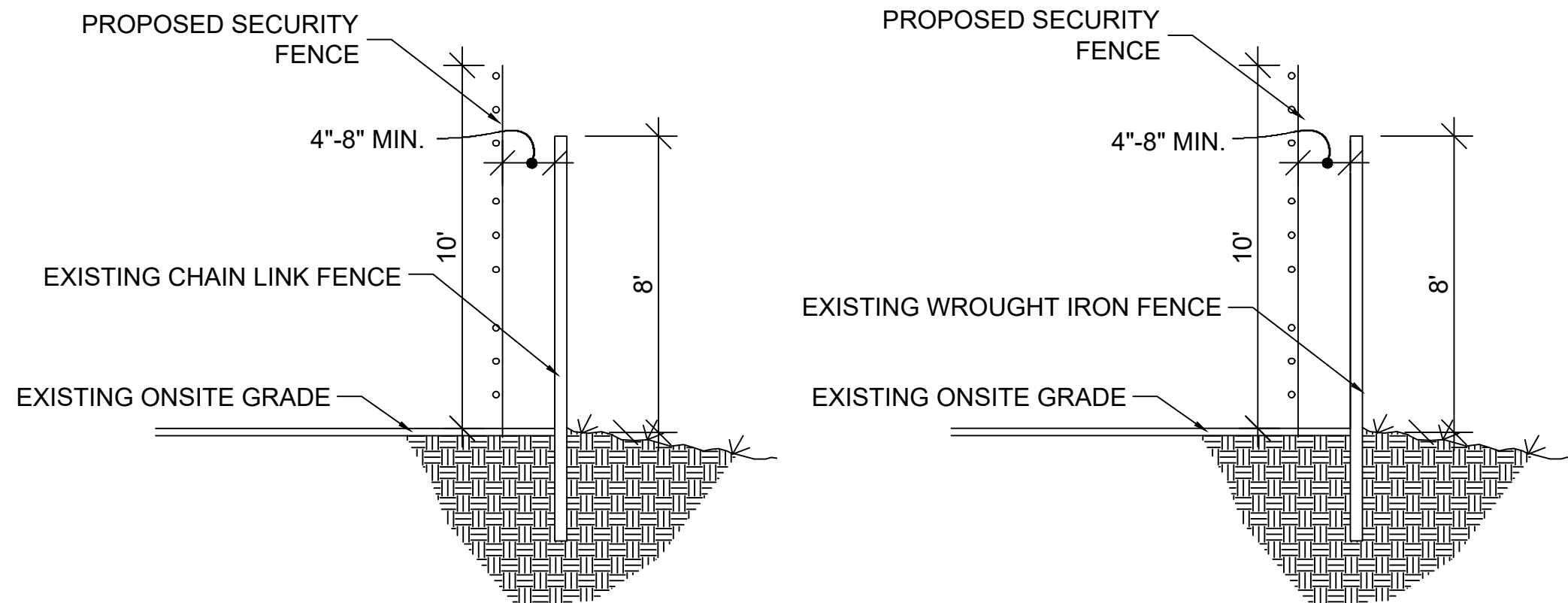

1 PERIMETER FENCE SECTION

NTS.

2 PERIMETER FENCE SECTION

NTS.

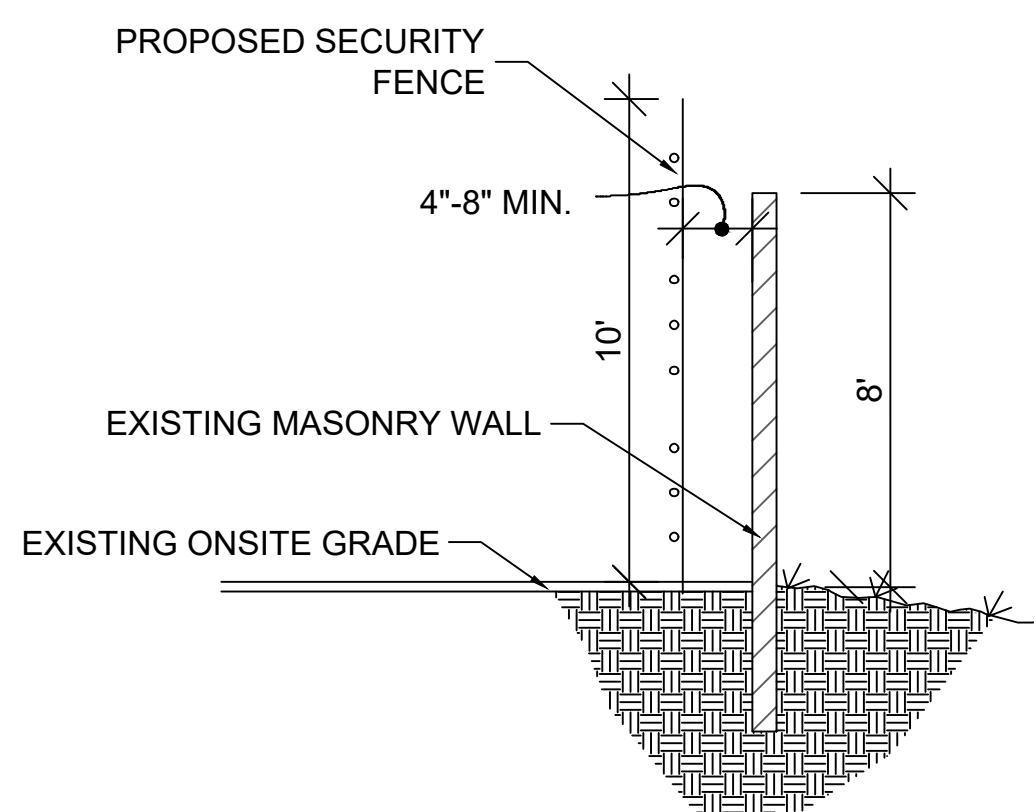

3 PERIMETER FENCE SECTION

NTS.

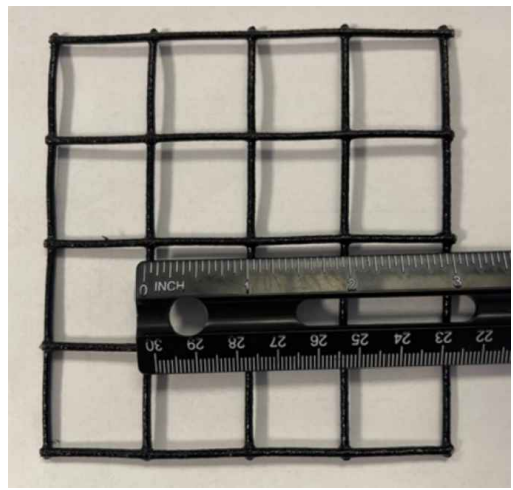

1x1 STEEL MESH

NOTES

POLE LOCATIONS:
STEEL POLES: TO BE LOCATED
APPROXIMATELY ON EACH SIDE OF GATE(S) &
EVERY 90° (OR GREATER) TURN IN FENCE LINE.
FIBERGLASS/INTERMEDIATE POLES: TO BE
LOCATED APPROXIMATELY EVERY 30'

DISCLAIMER:
POLE LOCATIONS MAY SLIGHTLY DEVIATE
FROM STIPULATIONS ABOVE DUE TO ON-SITE
CONDITIONS

THE PROPOSED PROJECT SHALL FULLY
COMPLY WITH THE 2022 VERSION OF THE
CALIFORNIA BUILDING, PLUMBING,
MECHANICAL, ELECTRICAL, GREEN, ENERGY,
AND FIRE CODES, AS ADOPTED AND
AMENDED BY THE CITY OF RIVERSIDE; OR THE
VERSION OF THESE CODES IN EFFECT AT THE
TIME A NEW PERMIT APPLICATION IS FILED.

PROPERTY OWNER

QUINN GROUP INC./JOHNSON MACHINERY CO
10006 ROSE HILLS RD,
CITY OF INDUSTRY CA 90601

PROJECT DATA

APN: 247-130-010 APN: 247-130-014 APN: 247-130-015
ACRES: 3.07 ACRES: 0.48 ACRES: 4.46

ZONING: BMP-SP -Business Manufacturing Park and
Specific Plan (Hunter Business Park) Overlay Zones

LAND USE: Rental and Sales of Equipment

SITE PLAN REQUEST TO AUTHORIZE A
10FT FENCE SECURITY SYSTEM FOR:
QUINN POWER SYSTEMS
656 E LA CADENA DRIVE
RIVERSIDE, CA 92507

LEGEND

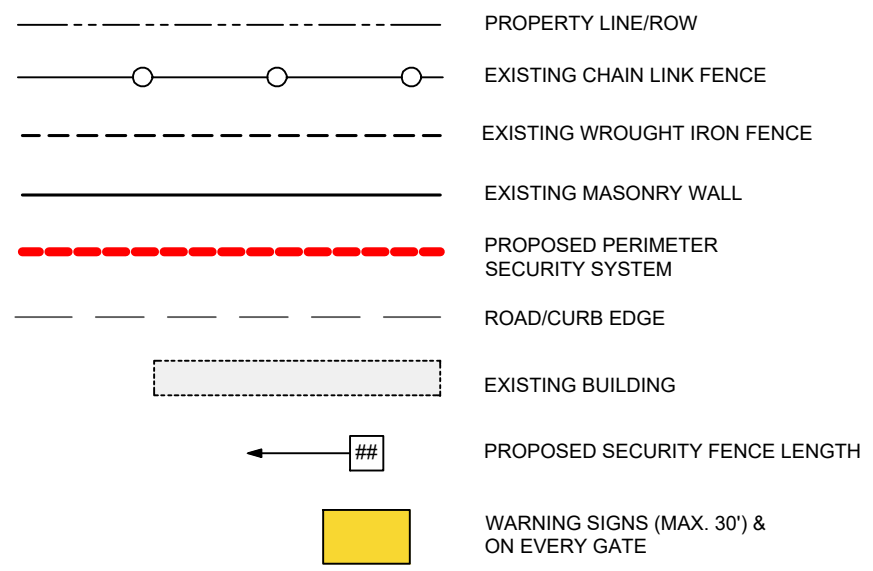

*PROPOSED LOCATION OF ELECTRONICS ONLY, SUBJECT TO CHANGE
BASED ON SITE CONDITIONS.
*PROPOSED LOCATION OF KNOX DEVICE ONLY, SUBJECT TO CHANGE
BASED ON SITE CONDITIONS.

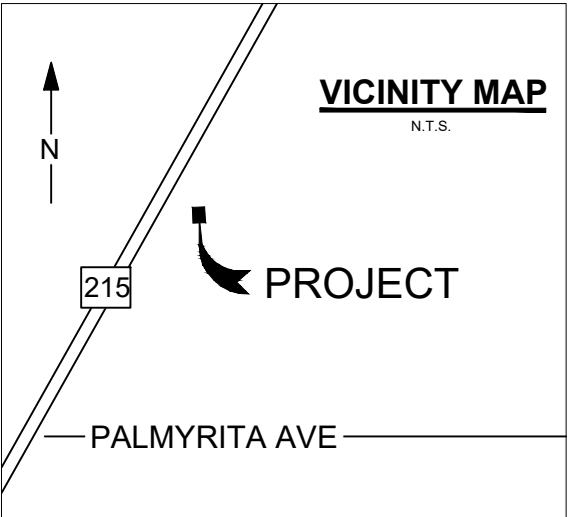

KNOX INSTRUCTIONS FOR FIRE DEPT:

FIRE DEPT SWITCH WILL BE INSTALLED AT
THE MAIN GATE FOR EMERGENCY CUTOFF
OF ELECTRIC GUARD DOG SECURITY FENCE.

WHEN ENTERING THE PROPERTY:

1. KNOX SWITCH WILL BE TURNED TO THE
OFF POSITION TO TURN THE SECURITY
FENCE OFF (DE-ENERGIZE).

THIS WILL ALLOW FIRST RESPONDERS TO
THEN UNLOCK THE GATE AND ENTER THE
PROPERTY.

EXISTING RAZOR WIRE TO BE REMOVED &
FIRE DEPARTMENT ACCESS SHALL BE
MAINTAINED DURING ALL PHASES OF
CONSTRUCTION.

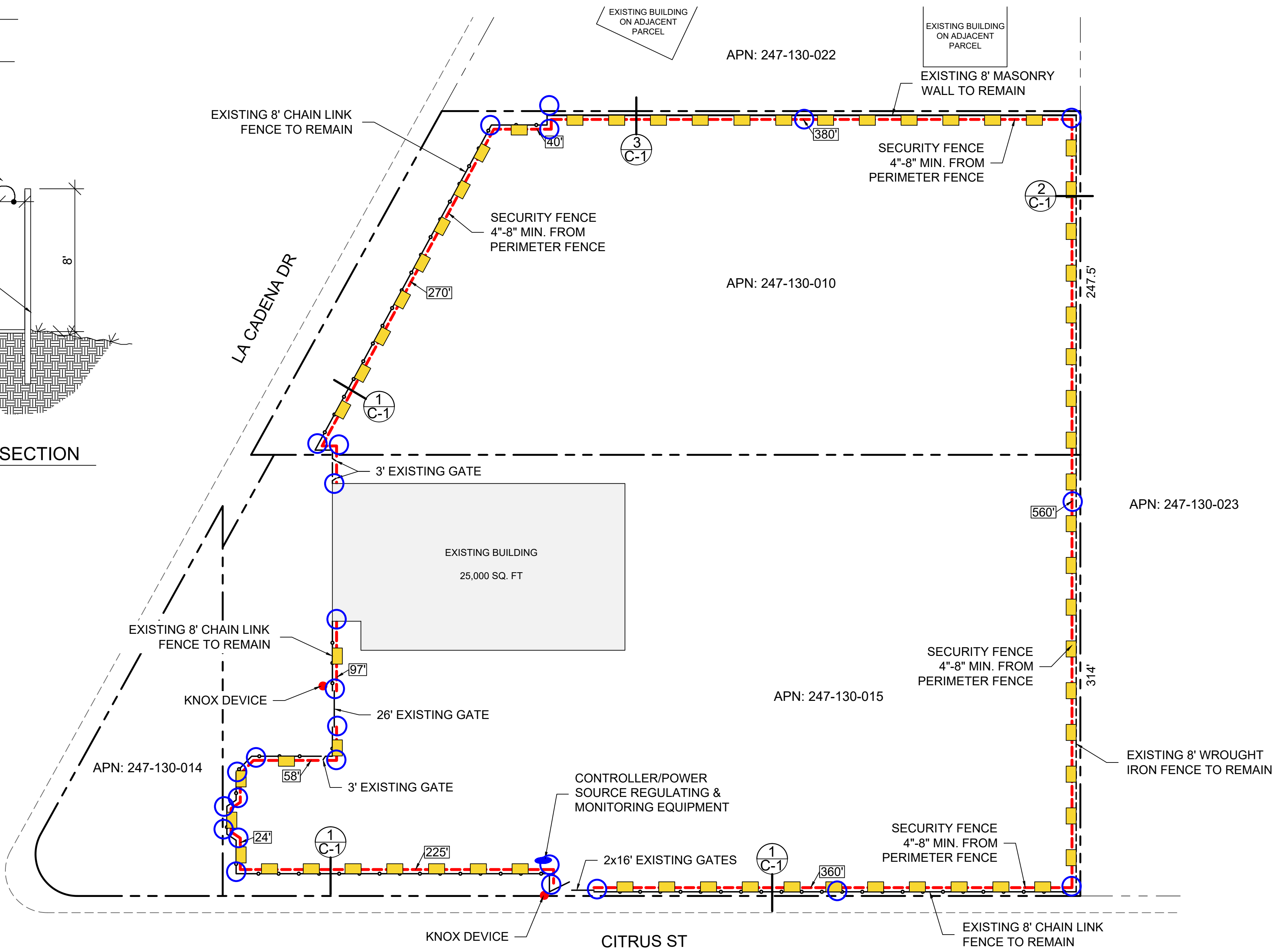

SITE PLAN

SCALE: 1" = 50'

0 25' 50' 100'

#	DATE / DESCRIPTION

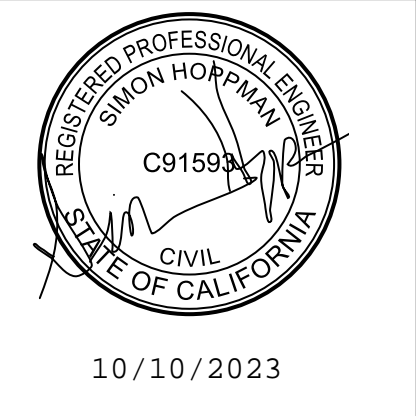

AMAROK
ULTIMATE PERIMETER SECURITY

550 Assembly Street, 5th Floor Columbia, SC 29201 PH: 803-786-6333

PROJECT:
QUINN POWER SYSTEMS
656 E LA CADENA DRIVE
RIVERSIDE, CA 92507

SHEET TITLE: SITE PLAN

APPLICANT: AMAROK
550 ASSEMBLY ST 5TH FL
COLUMBIA SC 29201
803-404-6189

ENGINEER: FDR ENGINEERS PLLC
121 KITTY HAWK DRIVE
MORRISVILLE, NC 27560
919-857-6100

DATE: 09/29/2023
SCALE: SEE PLAN

SHEET

C-1

1 of 3

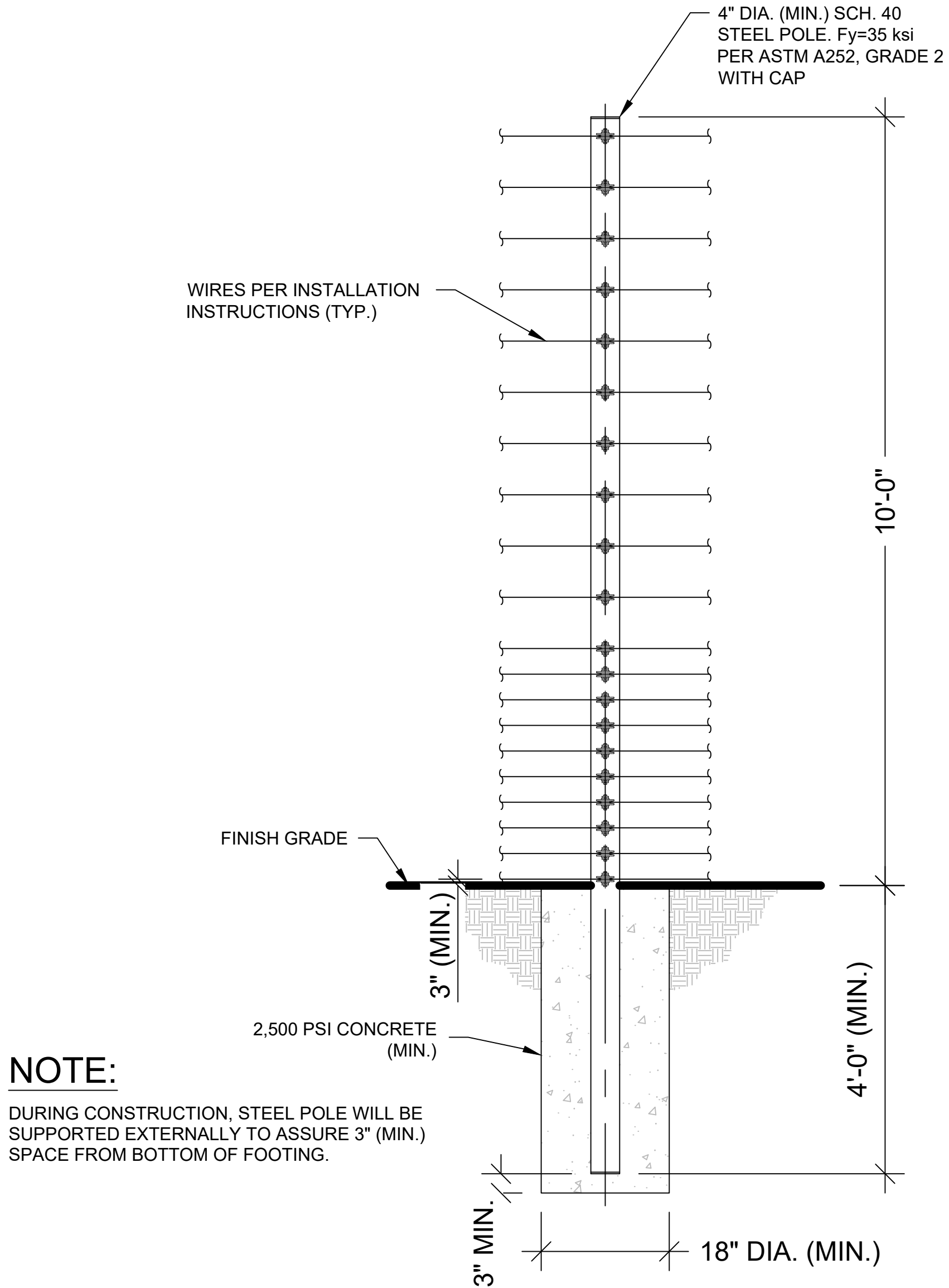

STEEL POLE DETAIL
SCALE: NONE
(STRUCTURAL)

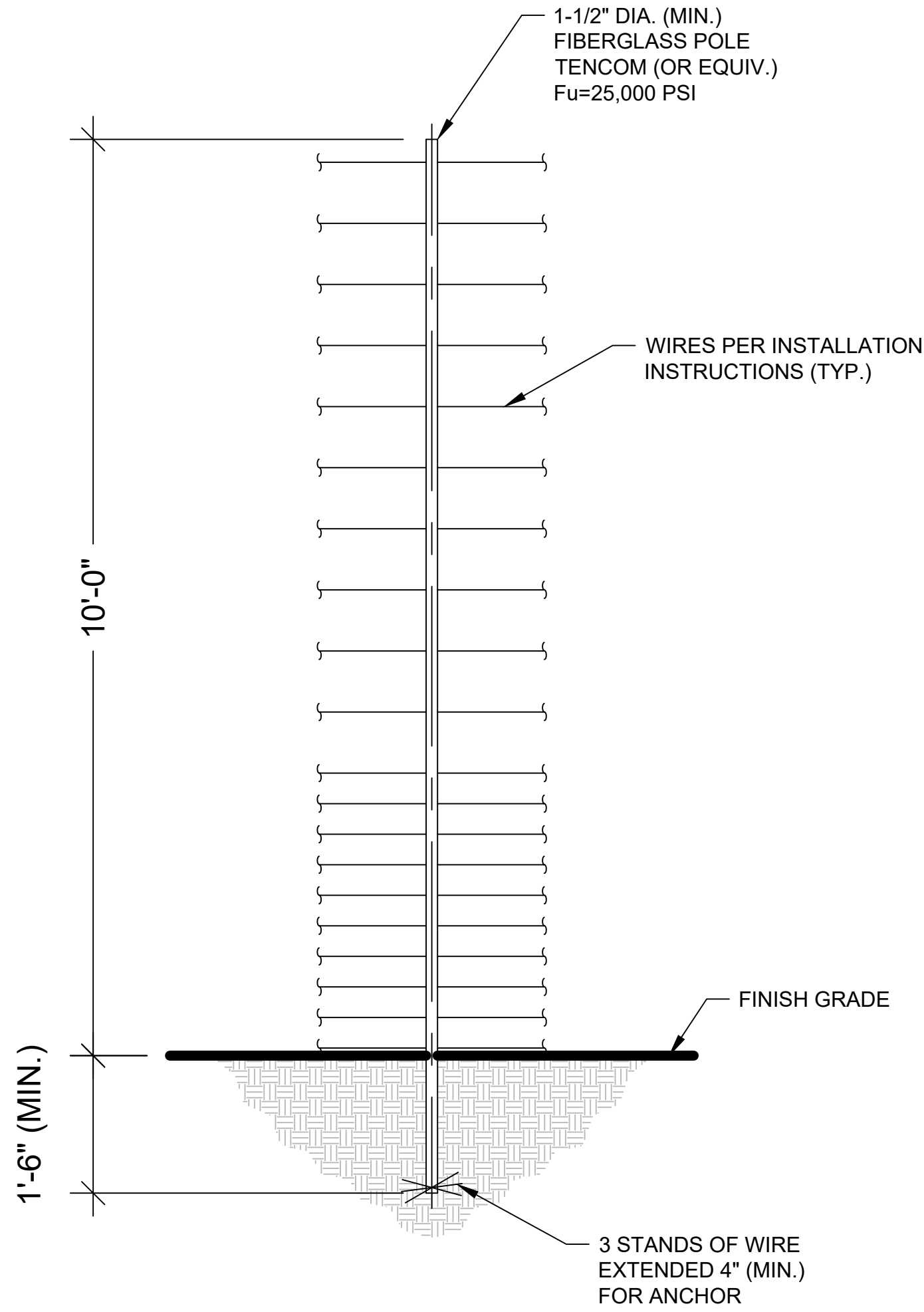

FIBERGLASS POLE DETAIL
SCALE: NONE
(NON-STRUCTURAL, NON-LOAD BEARING WIRE SEPARATOR)

GATE DETAIL NOTES:

- BRACE BANDS ARE INSTALLED AS HIGH AS POSSIBLE UNDER #3 AND #9, 2" (MIN.) UNDER #12, #15, AND #17, UNDER #19 AND AS HIGH ON THE GATE AS POSSIBLE. MAXIMUM DISTANCE OF 2' BETWEEN BRACE BANDS.
- SPRINGS ARE LOCATED ON HINGE SIDE OF SWING GATE AND REAR OF SLIDE GATE.
- ALL CONTACTS MUST INCLUDE SPRINGS.
- ALL CONTACTS MUST HAVE BOLT THROUGH FIBERGLASS (NO SET SCREWS).
- ALL BRACE BANDS HOOKED TO CHAIN LINK MUST HAVE SET SCREW.
- EVERY GATE PANEL MUST HAVE A SIGN.
- ALL GATE CONTACTS MUST BE SECURE IN A MANOR THAT ENSURES CONTACT WILL EASILY BE MADE.
- GATE MOUNTS WILL NOT IMPACT THE FUNCTIONALITY OF THE GATE.

RAPID TIGHTENERS

RAPID TIGHTENERS ARE INSTALLED IN EVERY SECTION - BETWEEN 6" INCHES AND 3 FEET FROM A FIBERGLASS POLE - TOWARD THE CENTER OF THE RUN.

THE TIGHTENERS ARE ALTERNATED ON OPPOSITE SIDES OF THE POLE TO PREVENT GROUNDS FROM HITTING WIRES WITH CURRENT.

WIRE SHOULD BE WRAPPED TWO OR THREE TIMES AROUND EACH TIGHTENER.

WARNING SIGNS

WARNING SIGNS MUST BE INSTALLED EVERY 30 FEET, WHICH IS THE MAXIMUM DISTANCE BETWEEN SIGNS.

ALL WARNING SIGNS SHOULD BE MOUNTED EITHER BETWEEN WIRES 15 & 16 OR AT BEST VISIBLE HEIGHT.

IF INSTALLED BEHIND A SOLID FENCE, WARNING SIGNS SHOULD ALSO BE PLACED ON OR ABOVE THE PERIMETER FENCE.

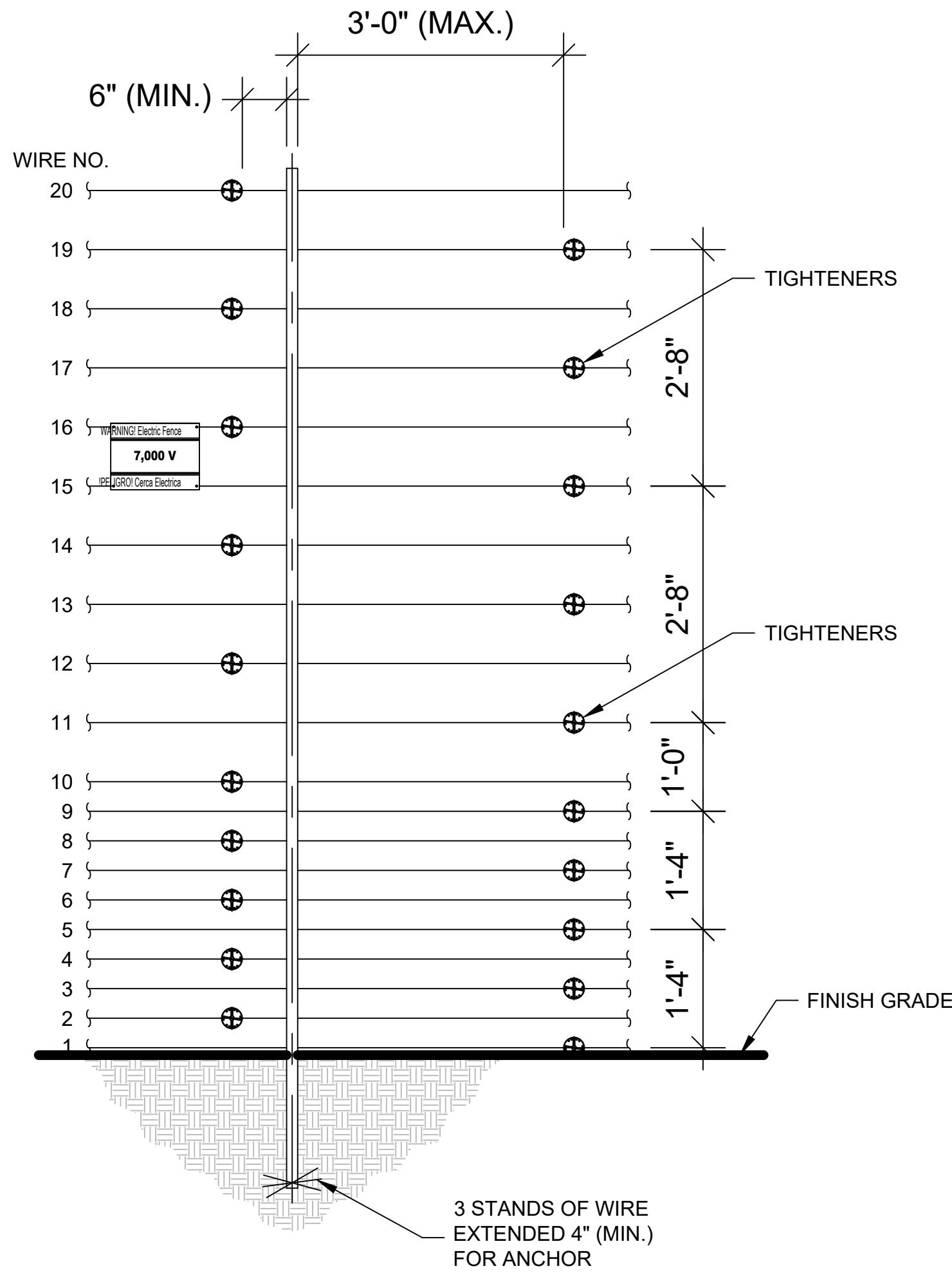

WIRE CONNECTIONS
SCALE: NONE
(FIBERGLASS POLE)

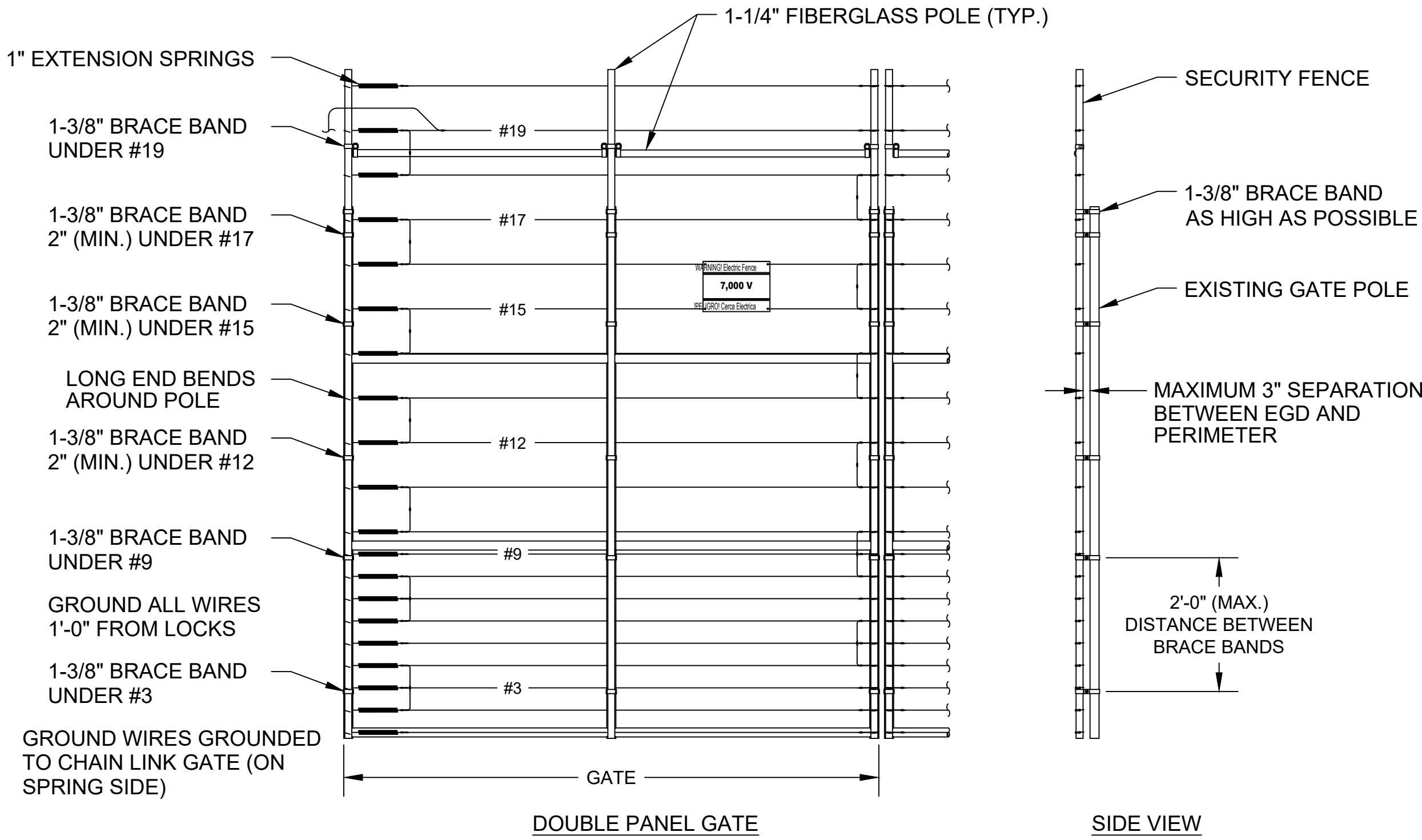

GATE DETAIL
SCALE: NONE

#	DATE / DESCRIPTION



AMAROK
ULTIMATE PERIMETER SECURITY

550 Assembly Street, 5th Floor Columbia, SC 29201 PH: 803-786-6333

PROJECT: QUINN POWER SYSTEMS
656 E LA CADENA DRIVE
RIVERSIDE, CA 92507

SHEET TITLE: TYPICAL DETAILS

APPLICANT: AMAROK
550 ASSEMBLY ST 5TH FL
COLUMBIA SC 29201
803-404-6189

ENGINEER: FDR ENGINEERS PLLC
121 KITTY HAWK DRIVE
MORRISVILLE, NC 27560
919-857-5100

DATE: 07/14/2023
SCALE: SEE PLAN

SHEET

C-2

2 of 3

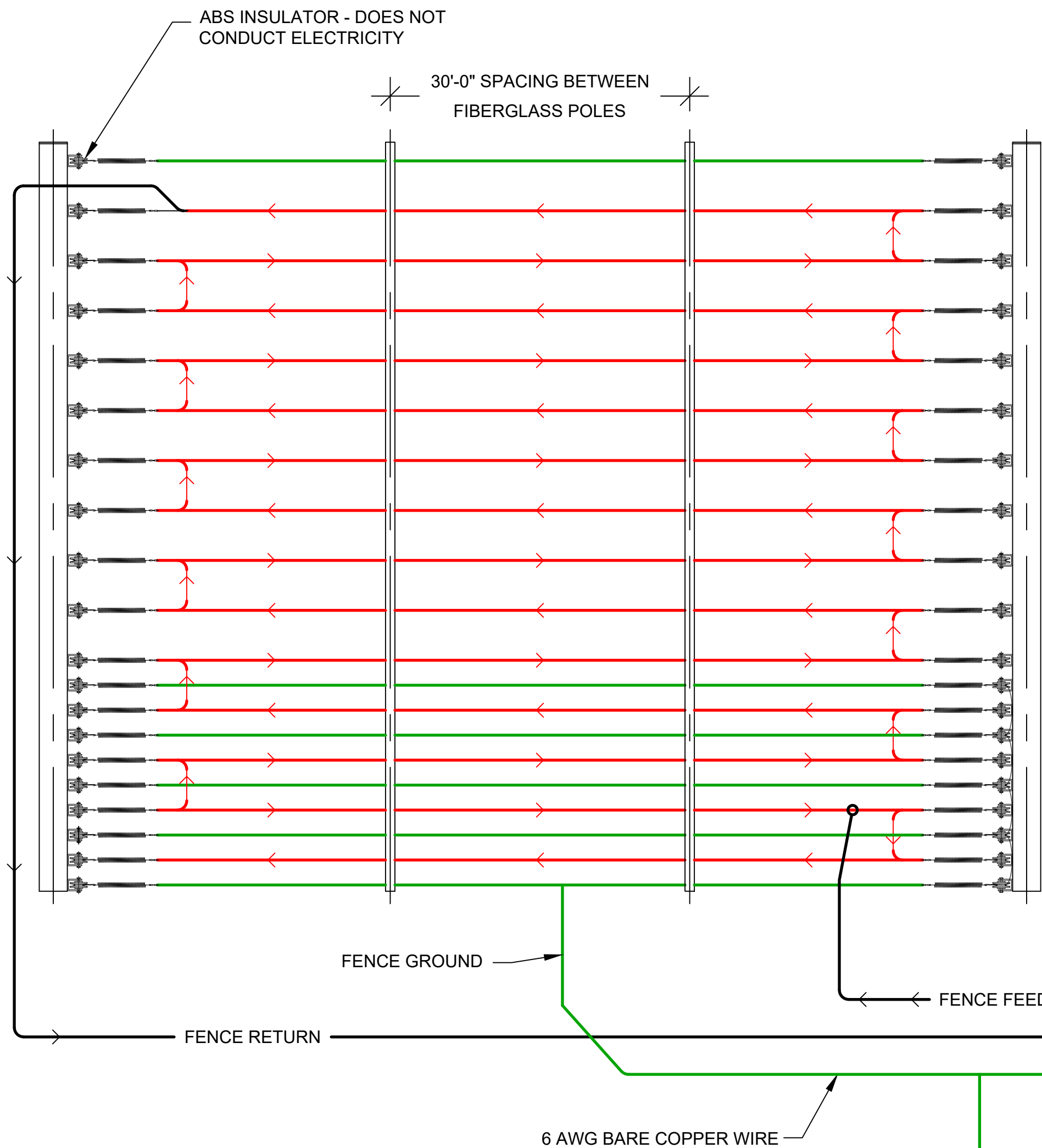

GENERAL NOTE:

EQUIPMENT ARRANGEMENT AND ELEVATION SHOWN ARE FOR REFERENCE ONLY. ACTUAL EQUIPMENT ARRANGEMENT, SHAPE, SIZE, LOCATION, AND QUANTITY ARE CUSTOMER SITE SPECIFIC AND CAN VARY FROM DRAWING DEPICTION.

CONNECTION NOTES:

A: FENCE CONTROLLER ENCLOSURE - HOUSES THE FENCE ENERGIZER OR EQUIVALENT. THIS BOX CONNECTS TO "A" / ALARM PANEL ENCLOSURE USING THE APS WHIP / 10 CONDUCTOR CABLE. ENCLOSURE WEIGHT 22 LBS. (MAX.).

B: ALARM PANEL ENCLOSURE - HOUSES THE ALARM CONTROL PANEL. THIS BOX INTERCONNECTS TO "B" / FENCE CONTROLLER ENCLOSURE USING THE APS WHIP / 10 CONDUCTOR CABLE AND "C" / SOLAR CHARGE CONTROLLER USING TWO CONDUCTOR CABLE. ENCLOSURE WEIGHT 21 LBS. (MAX.).

C: SOLAR CHARGE CONTROLLER ENCLOSURE - HOUSES POWER ELEMENTS FOR SOLAR CHARGE CONTROLLER AND DISCONNECTS FOR SOLAR, BATTERY, AND LOAD CONNECTIONS. POWER UP PROCEDURE: TURN ON BATTERY BREAKER FIRST, THEN TURN ON SOLAR BREAKER. THE ELECTRONICS POWER IS CONTROLLED BY THE LOAD BREAKER. ENCLOSURE WEIGHT 25 LBS. (MAX.).

D: BATTERY ENCLOSURE - HOUSES THE BATTERIES AND INTERCONNECTS TO "C" / SOLAR CHARGE CONTROLLER ENCLOSURE USING TWO CONDUCTOR 14G AND 10G THWN WIRES. ENCLOSURE WEIGHT 145 LBS. (MAX.).

E: KEYPAD ENCLOSURE - HOUSES THE KEYPAD. THIS BOX INTERCONNECTS TO "B" USING 10 CONDUCTOR / 18 AWG WIRE. ENCLOSURE WEIGHT 12 LBS. (MAX.).

F: WIRELESS CONTROLLER ENCLOSURE - HOUSES THE WIRELESS RADIO CONTROLLER AND RELAYS. CONNECTS TO "A" / SOLAR CHARGE CONTROLLER ENCLOSURE USING TWO CONDUCTOR 14G THWN WIRES. ENCLOSURE WEIGHT 21 LBS. (MAX.).

NOTES:

MOUNT 4 SILVER BOXES TO A PAIR OF HSS TUBE 4"x4"x10 GA (0.134" WALL THICKNESS) ASTM A500 GRADE B OR C 55 KSI YIELD (MIN.) STEEL POLES. BOTTOM OF THE LOWEST BOX MUST BE A MINIMUM OF 3 FEET ABOVE GROUND LEVEL. THE SUPPORT POLES MUST BE EMBEDDED AT A MINIMUM OF 3'-10" BELOW GROUND LEVEL.

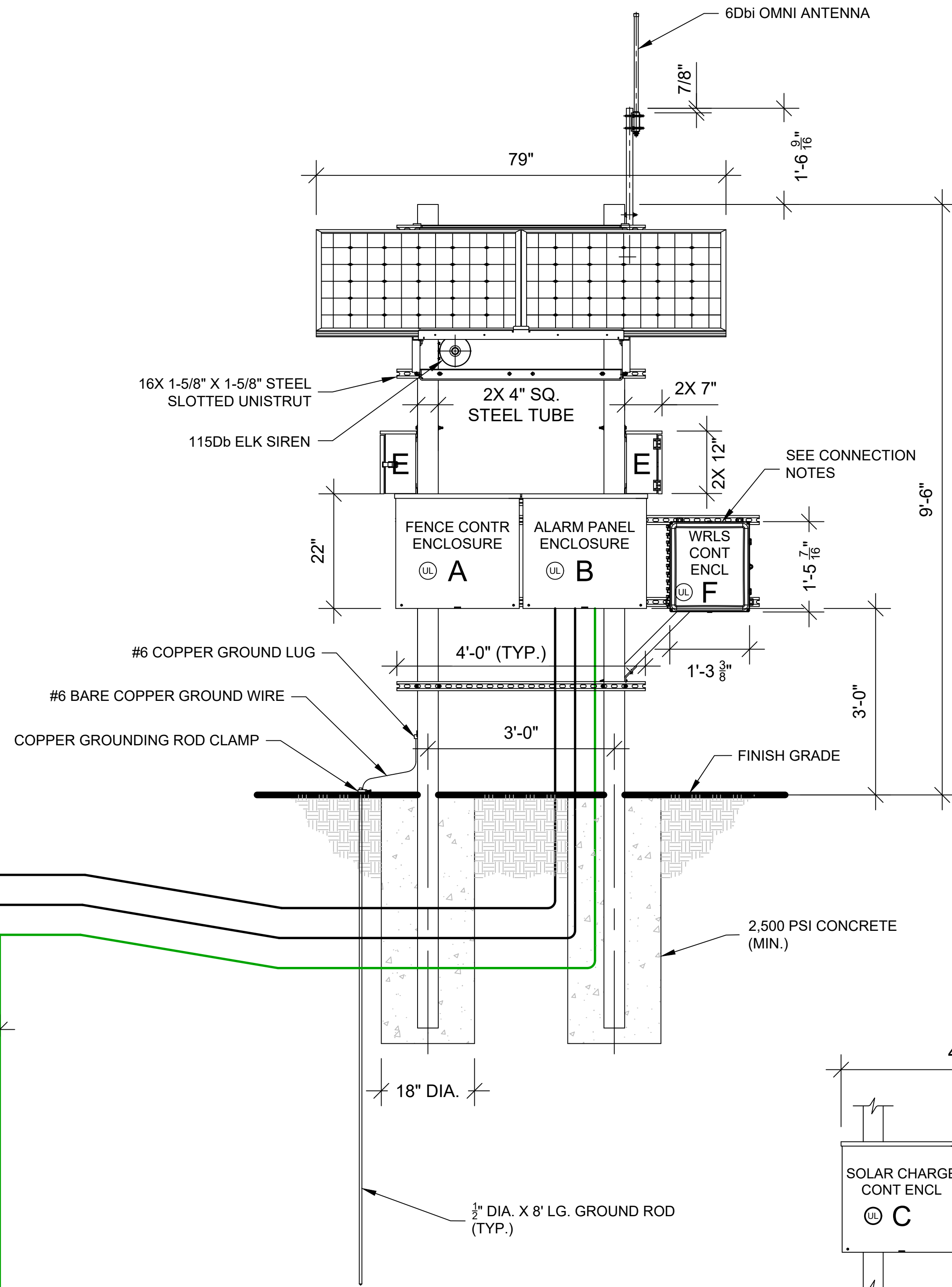

FRONT ELEVATION

ASSEMBLY WEIGHT CHART	
DESCRIPTION	WEIGHT (LBS.)
SOLAR PANELS	61.6
SOLAR PANEL MTG. KIT	27.0
UNISTRUT	108.8
OMNI ANTENNA ASSEMBLY	3.59
SIREN	1.5

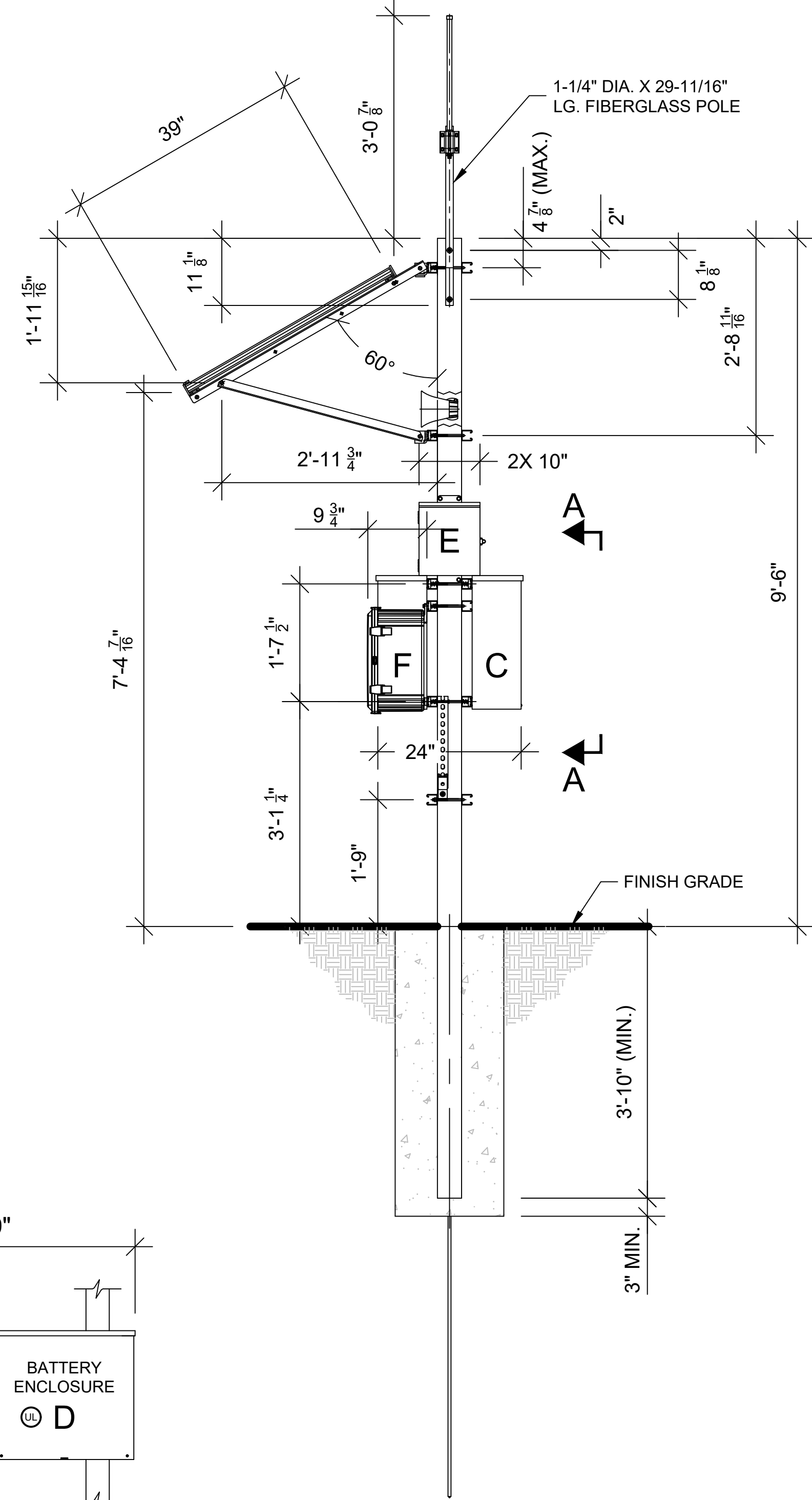

RIGHT SIDE ELEVATION

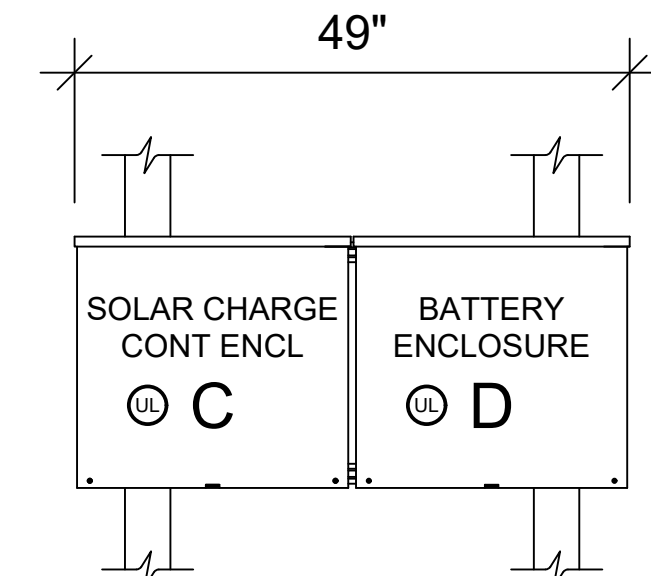

VIEW A-A
(KEYPAD/WIRELESS CONTROLLER ENCLOSURES REMOVED FOR CLARITY)

ELECTRONICS ARMATURE	
LOCATION	DESCRIPTIVE NAME
MAIN GATE	HEAD-END ELECTRONICS

#	DATE / DESCRIPTION



AMAROK
ULTIMATE PERIMETER SECURITY

550 Assembly Street, 5th Floor Columbia, SC 29201 PH: 803-786-6333

PROJECT: QUINN POWER SYSTEMS
656 E LA CADENA DRIVE
RIVERSIDE, CA 92507

SHEET TITLE: TYPICAL DETAILS

APPLICANT: AMAROK
550 ASSEMBLY ST 5TH FL
COLUMBIA SC 29201
803-404-6189

ENGINEER: FDR ENGINEERS PLLC
121 KITTY HAWK DRIVE
MORRISVILLE, NC 27560
919-857-5100

DATE: 07/14/2023
SCALE: SEE PLAN

SHEET

C-3

3 of 3

08/07/2023

City of Riverside
Community & Economic Development Department Planning Division
ATTN: Daniel Palafox
3900 Main Street
Riverside, CA 92522

Project Description for Quinn Power Systems – 656 E La Cadena Drive – CUP Submittal

Quinn Power Systems is a commercial power equipment sales and rental company that has been in business since 1919. Quinn's operations span seventeen counties throughout Central and Southern California, covering over 75,000 square miles and representing 48% of the State of California. The company serves its customers through a dedicated employee population of more than 1,200 based out of 22 locations. From Salinas to Murrieta, Quinn is a one-stop shop for all earthmoving, agriculture, engine, lift truck, and equipment rental service needs.

AMAROK, on behalf of Quinn Power Systems, seeks to install a low voltage, battery powered (12V DC) 10' tall perimeter monitored electrified security fence per CA Civil Code Section 835, which will be safely located inside of the existing 8' chain link fence to secure the property during non-business hours. In addition, the monitored electrified security system will enhance the safety and welfare of the business and surrounding community. The proposed security system aligns with the goals and objectives of the General Plan to create a sustainable, resilient, and livable Riverside through public safety, business retention, and crime prevention.

As it pertains to the hours of operation, any site improvements, business operations, use of property, zoning and parcel information for the project site and surrounding parcels, please note the following:

- This site operates from 7am – 5pm.
- There are no site improvements related to the perimeter security fence.
- The land use is for retail trade and commercial purposes.
- This project site is zoned BMP (Business and Manufacturing Park) with a Specific Plan of Hunter Business Park.
- The surrounding parcels are also zoned BMP with a Specific Plan of Hunter Business Park.

Much more effective and reliable than other means of security, a monitored security system will provide Quinn Power Systems with a feasible means to secure their assets and employees. The installation of the system will secure the property, increase the security of the surrounding properties and the immediate area by deterring the criminal element from targeting the neighborhood. In turn, this will allow them to invest financial resources into further growth, resulting in continued employment and an increased tax base for the community. With Quinn Power Systems' extensive theft and loss history, they require our effective security system immediately to remain a viable business for the community of Riverside. The business is a

reputable business, located in the appropriate zoning and complies with all other local ordinances. Quinn Power Systems is a reputable business and needs your approval to remain so.

Please reach out with any questions.

Kind Regards,



Sydney Tooker
Compliance Manager
Mobile: 803-830-0807



ULTIMATE PERIMETER SECURITY