

GENERAL NOTES

1. DRAWING PROVIDED FOR LAND USE PERMIT APPLICATION ONLY AND IS NOT TO BE USED FOR PERMITTING OR CONSTRUCTION.
2. PHOTOMETRIC ANALYSIS PROVIDED BASED ON COMPUTER GENERATED MODEL TO EVALUATE PERFORMANCE OF SELECTED LIGHTING SCHEMES.

| REV | DATE | DESCRIPTION |
|-----|------------|-------------------|
| 1 | 01/17/2022 | BACKGROUND UPDATE |
| 2 | 06/06/2022 | RESUBMITTAL #1 |
| 3 | 08/04/2022 | RESUBMITTAL #2 |

| DATE | SCALE | DRAWN BY | CHECKED BY |
|------------|--------------|----------|------------|
| 03/24/2021 | 1" = 100'-0" | SC | |

VICINITY MAP

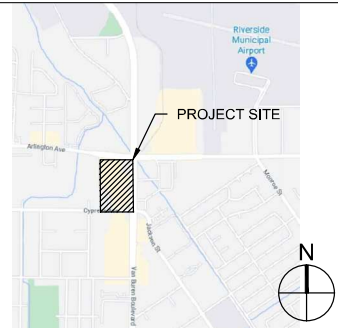

SITE PLAN
VAN BUREN BLVD
 6008-6390 VAN BUREN BLVD, RIVERSIDE, CA 92503

L1

CYPRESS AVE.

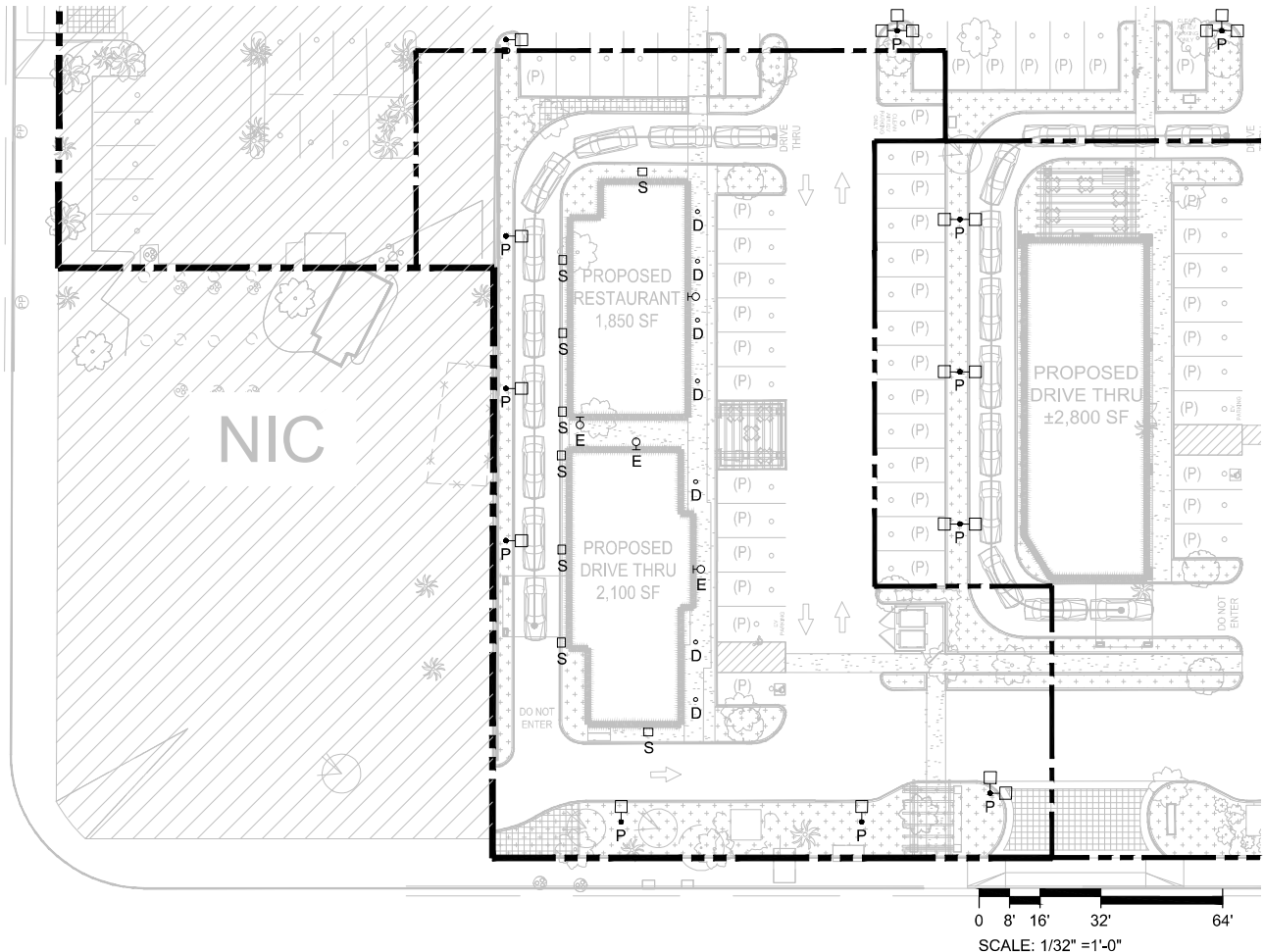

GENERAL NOTES

1. DRAWING PROVIDED FOR LAND USE PERMIT APPLICATION ONLY AND IS NOT TO BE USED FOR PERMITTING OR CONSTRUCTION.
2. ALL FIXTURES ARE NEW UNLESS NOTED OTHERWISE.
3. LIGHT FIXTURE SPECIFICATION PROVIDED FOR REFERENCE ONLY, BASED ON AVAILABLE PHOTOGRAPHS AND VISUAL INSPECTIONS. EXACT MANUFACTURER AND MODEL OF EXISTING FIXTURES SHALL BE VERIFIED DURING DESIGN.
4. LIGHT SOURCES SHALL BE SHIELDED TO MINIMIZE OFF-SITE GLARE, SHALL NOT DIRECT LIGHT UPWARD, AND SHALL BE DIRECTED AWAY FROM ADJACENT PROPERTIES AND PUBLIC RIGHT-OF-WAYS.
5. HEIGHT OF POLE-MOUNTED LIGHTING FIXTURES SHALL NOT EXCEED 14'-0" ABOVE FINISHED GROUND.

| REV | DATE | DESCRIPTION |
|-----|------------|-------------------|
| 1 | 01/17/2022 | BACKGROUND UPDATE |
| 2 | 06/06/2022 | RESUBMITTAL #1 |
| 3 | 08/04/2022 | RESUBMITTAL #2 |

| DATE | SCALE | DRAWN BY | CHECKED BY |
|------------|---------------|----------|------------|
| 03/24/2021 | 1/32" = 1'-0" | SC | |

VICINITY MAP

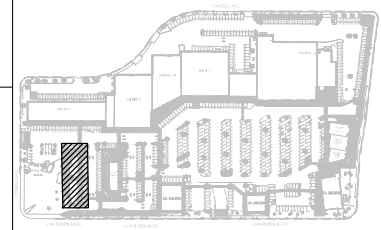

LIGHT FIXTURE SCHEDULE

| MARK | DESCRIPTION | MOUNTING HEIGHT | LAMPS | WATTS | LUMENS | MANUFACTURER | CATALOG NUMBER |
|------|---------------------------------------|-----------------|-------|-------|--------|--------------|-----------------------|
| D | 6" UNDER CANOPY DOWNLIGHT | 14' AFG | LED | 19.7 | 2,000 | GOTHAM | EVO6-40/20-AR-WD-LD |
| E | BUILDING MOUNT FIXTURE EM WALL LIGHTS | 10' AFG | LED | 24.0 | 500 | PHILIPS | PLEMBZ |
| S | WALL SCONCE | 11' AFG | LED | 15.5 | 1,039 | COOPER | 303-W2-LEDB2-4000K-T4 |
| P | POLE-MOUNTED LIGHT | 14' AFG | LED | 111.0 | 17,427 | LITHONIA | RSX2 LED-P2-40K-R4-HS |

PARCEL 2 LIGHTING PLAN
 VAN BUREN BLVD
 6008-6390 VAN BUREN BLVD, RIVERSIDE, CA 92503

L2

CYPRESS AVE.

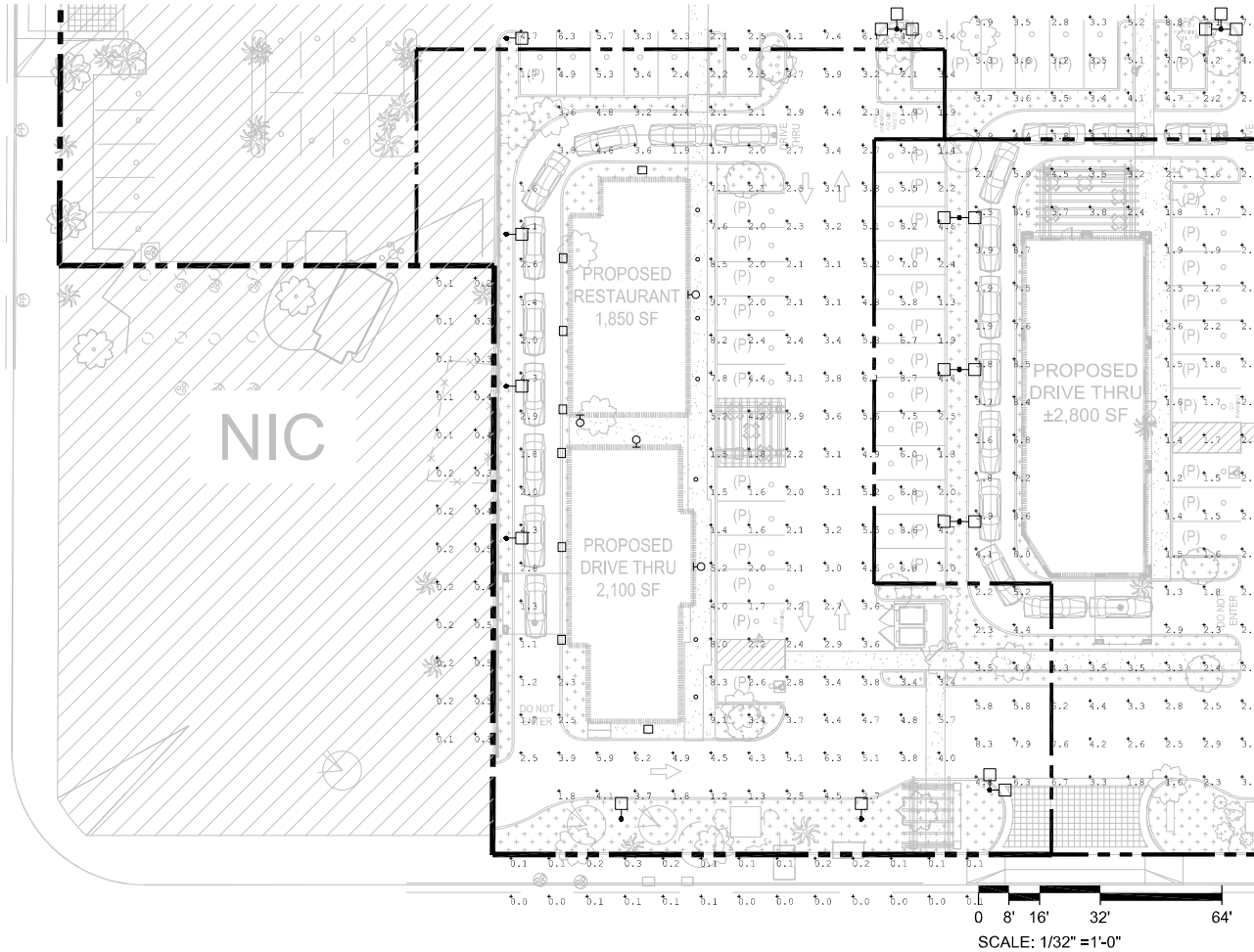

PHOTOMETRIC CALCULATION SUMMARY

| LABEL | CALCULATION TYPE | UNITS | MIN | AVG | MAX | AVG/MIN |
|----------|------------------|-------|-----|------|-----|---------|
| PARCEL 2 | ILLUMINANCE | FC | 1.1 | 3.77 | 9.7 | 3.43 |

GENERAL NOTES

1. DRAWING PROVIDED FOR LAND USE PERMIT APPLICATION ONLY AND IS NOT TO BE USED FOR PERMITTING OR CONSTRUCTION.
2. ALL ON-SITE LIGHTING SHALL PROVIDE MINIMUM INTENSITY OF 1 FOOT-CANDLES AND A MAXIMUM OF 10 FOOT-CANDLES AT GROUND LEVEL THROUGHOUT THE AREAS SERVING THE PUBLIC AND USED FOR PARKING.
3. RATIO OF AVERAGE LIGHT TO MINIMUM LIGHT SHALL BE NOT MORE THAN 4.

| REV | DATE | DESCRIPTION |
|-----|------------|-------------------|
| 1 | 01/17/2022 | BACKGROUND UPDATE |
| 2 | 06/06/2022 | RESUBMITTAL #1 |
| 3 | 08/04/2022 | RESUBMITTAL #2 |

| | | |
|------------|---------------|------------|
| 03/24/2021 | 1/32" = 1'-0" | SC |
| DATE | SCALE | DRAWN BY |
| | | CHECKED BY |

VICINITY MAP

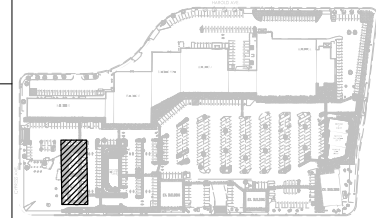

PARCEL 2 PHOTOMETRIC
 VAN BUREN BLVD
 6008-6390 VAN BUREN BLVD, RIVERSIDE, CA 92503

L2P

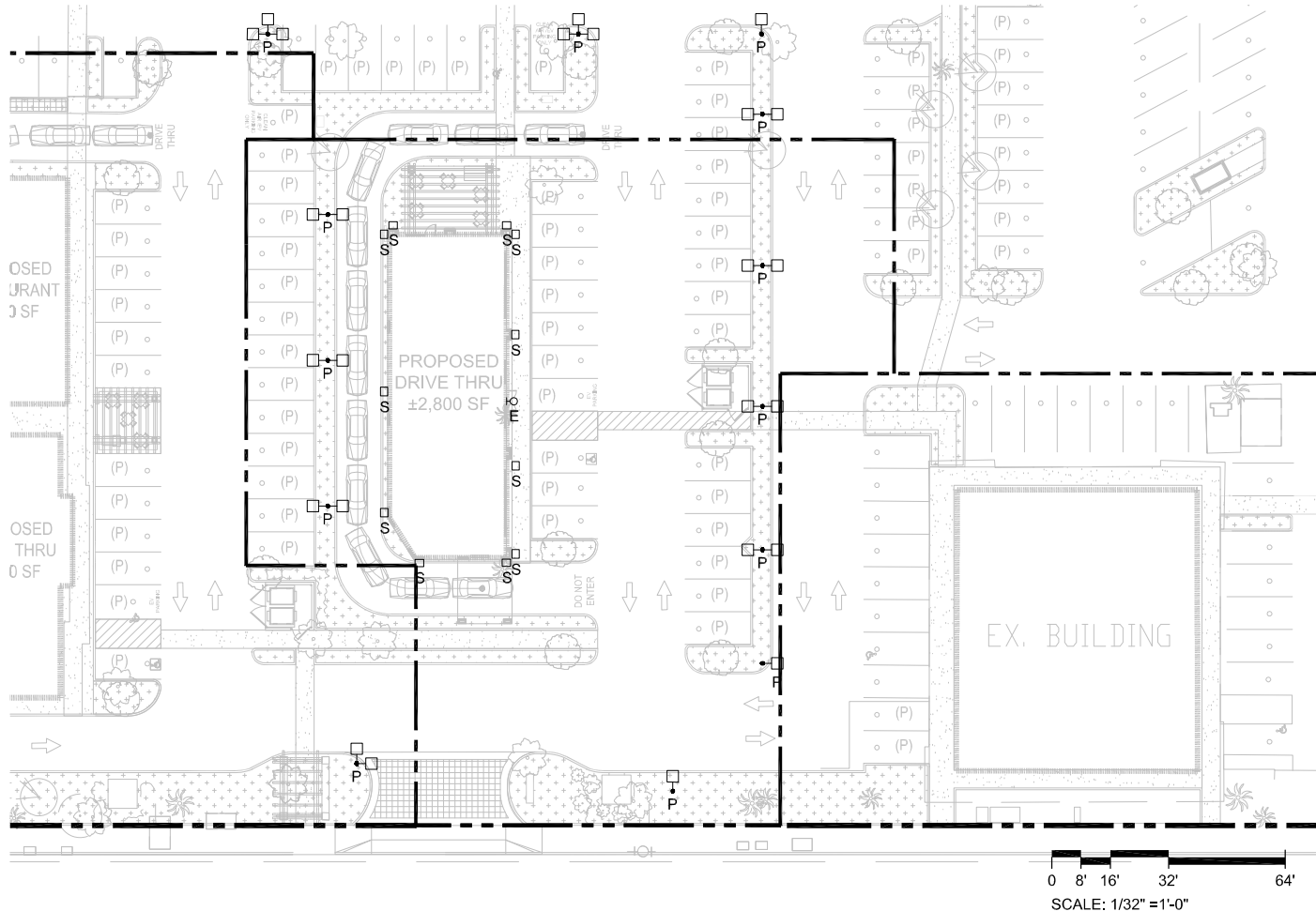

GENERAL NOTES

1. DRAWING PROVIDED FOR LAND USE PERMIT APPLICATION ONLY AND IS NOT TO BE USED FOR PERMITTING OR CONSTRUCTION.
2. ALL FIXTURES ARE NEW UNLESS NOTED OTHERWISE.
3. LIGHT FIXTURE SPECIFICATION PROVIDED FOR REFERENCE ONLY, BASED ON AVAILABLE PHOTOGRAPHS AND VISUAL INSPECTIONS. EXACT MANUFACTURER AND MODEL OF EXISTING FIXTURES SHALL BE VERIFIED DURING DESIGN.
4. LIGHT SOURCES SHALL BE SHIELDED TO MINIMIZE OFF-SITE GLARE, SHALL NOT DIRECT LIGHT UPWARD, AND SHALL BE DIRECTED AWAY FROM ADJACENT PROPERTIES AND PUBLIC RIGHT-OF-WAYS.
5. HEIGHT OF POLE-MOUNTED LIGHTING FIXTURES SHALL NOT EXCEED 14'-0" ABOVE FINISHED GROUND.

| REV | DATE | DESCRIPTION |
|-----|------------|-------------------|
| 1 | 01/17/2022 | BACKGROUND UPDATE |
| 2 | 06/06/2022 | RESUBMITTAL #1 |
| 3 | 08/04/2022 | RESUBMITTAL #2 |

| DATE | SCALE | DRAWN BY | CHECKED BY |
|------------|---------------|----------|------------|
| 03/24/2021 | 1/32" = 1'-0" | SC | |

VICINITY MAP

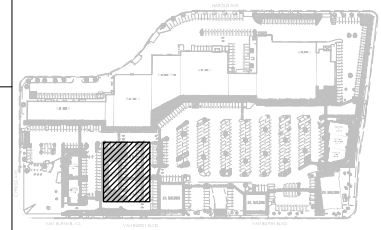

LIGHT FIXTURE SCHEDULE

| MARK | DESCRIPTION | MOUNTING HEIGHT | LAMPS | WATTS | LUMENS | MANUFACTURER | CATALOG NUMBER |
|------|---------------------------------------|-----------------|-------|-------|--------|--------------|-----------------------|
| E | BUILDING MOUNT FIXTURE EM WALL LIGHTS | 10' AFG | LED | 24.0 | 500 | PHILIPS | PLEMBZ |
| S | WALL SCONCE | 11' AFG | LED | 15.5 | 1,039 | COOPER | 303-W2-LED32-4000K-T4 |
| P | POLE-MOUNTED LIGHT | 14' AFG | LED | 111.0 | 17,427 | LITHONIA | RSX2 LED-P2-40K-R4-HS |

PARCEL 3 LIGHTING PLAN
 VAN BUREN BLVD
 6008-6390 VAN BUREN BLVD, RIVERSIDE, CA 92503

L3

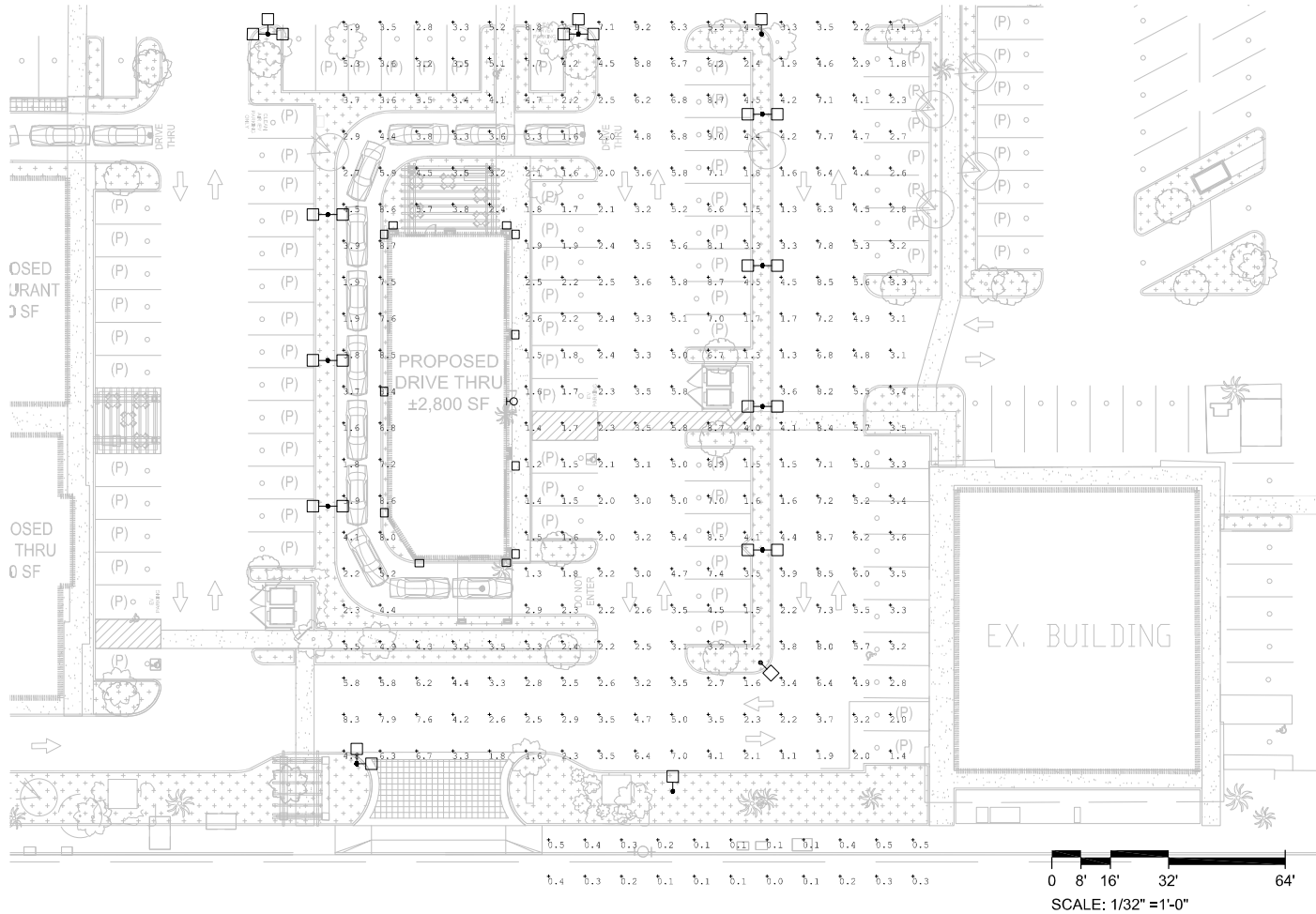

PHOTOMETRIC CALCULATION SUMMARY

| LABEL | CALCULATION TYPE | UNITS | MIN | AVG | MAX | AVG/MIN |
|----------|------------------|-------|-----|------|-----|---------|
| PARCEL 3 | ILLUMINANCE | FC | 1.1 | 4.10 | 9.2 | 3.73 |

GENERAL NOTES

1. DRAWING PROVIDED FOR LAND USE PERMIT APPLICATION ONLY AND IS NOT TO BE USED FOR PERMITTING OR CONSTRUCTION.
2. ALL ON-SITE LIGHTING SHALL PROVIDE MINIMUM INTENSITY OF 1 FOOT-CANDLES AND A MAXIMUM OF 10 FOOT-CANDLES AT GROUND LEVEL THROUGHOUT THE AREAS SERVING THE PUBLIC AND USED FOR PARKING.
3. RATIO OF AVERAGE LIGHT TO MINIMUM LIGHT SHALL BE NOT MORE THAN 4.

| REV | DATE | DESCRIPTION |
|-----|------------|-------------------|
| 1 | 01/17/2022 | BACKGROUND UPDATE |
| 2 | 06/06/2022 | RESUBMITTAL #1 |
| 3 | 08/04/2022 | RESUBMITTAL #2 |

| | | |
|------------|---------------|------------|
| 03/24/2021 | 1/32" = 1'-0" | SC |
| DATE | SCALE | DRAWN BY |
| | | CHECKED BY |

VICINITY MAP

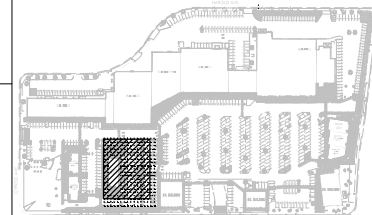

PARCEL 3 PHOTOMETRIC
 VAN BUREN BLVD
 6008-6390 VAN BUREN BLVD, RIVERSIDE, CA 92503

L3P

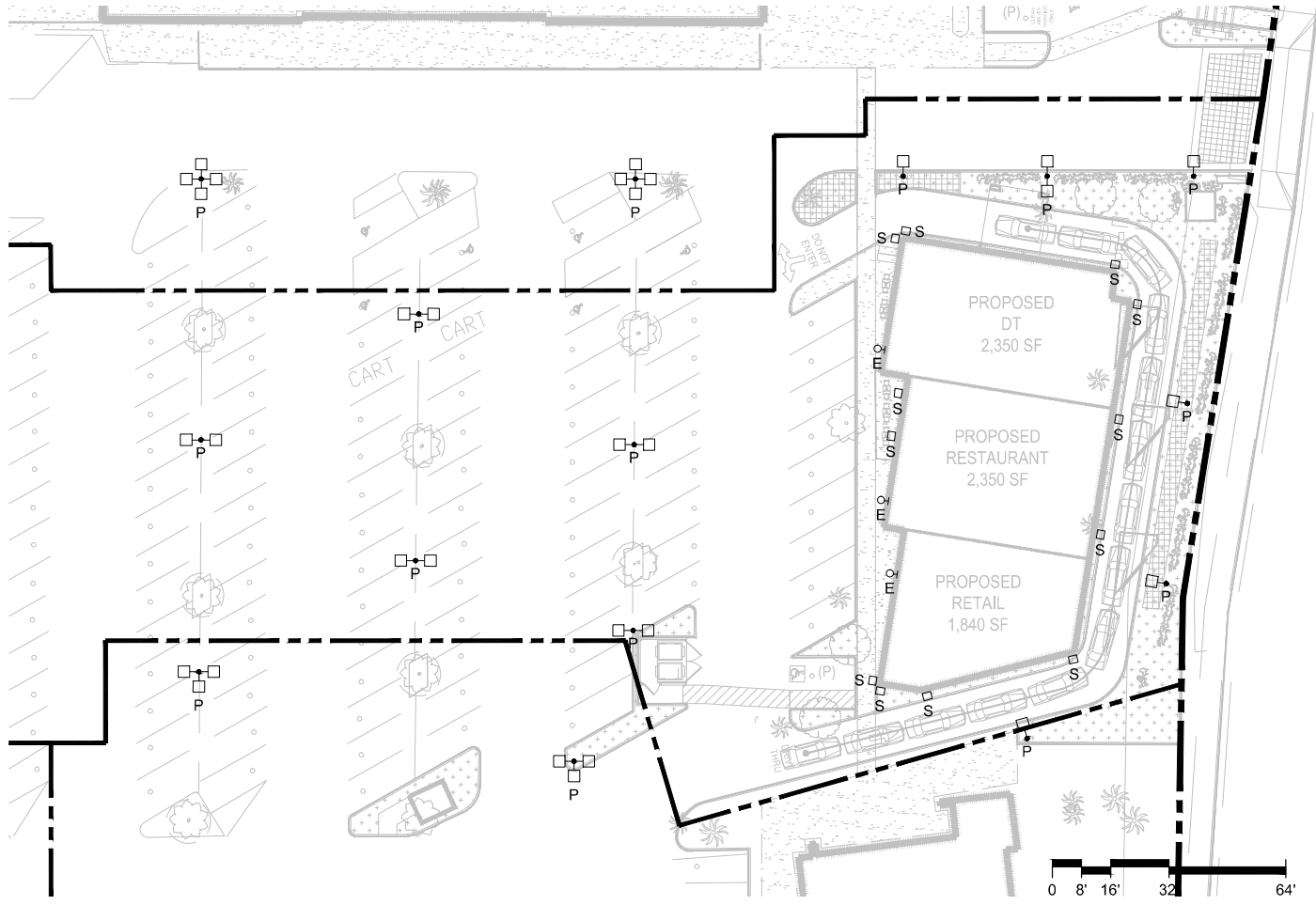

GENERAL NOTES

1. DRAWING PROVIDED FOR LAND USE PERMIT APPLICATION ONLY AND IS NOT TO BE USED FOR PERMITTING OR CONSTRUCTION.
2. ALL FIXTURES ARE NEW UNLESS NOTED OTHERWISE.
3. LIGHT FIXTURE SPECIFICATION PROVIDED FOR REFERENCE ONLY, BASED ON AVAILABLE PHOTOGRAPHS AND VISUAL INSPECTIONS. EXACT MANUFACTURER AND MODEL OF EXISTING FIXTURES SHALL BE VERIFIED DURING DESIGN.
4. LIGHT SOURCES SHALL BE SHIELDED TO MINIMIZE OFF-SITE GLARE, SHALL NOT DIRECT LIGHT UPWARD, AND SHALL BE DIRECTED AWAY FROM ADJACENT PROPERTIES AND PUBLIC RIGHT-OF-WAYS.
5. HEIGHT OF POLE-MOUNTED LIGHTING FIXTURES SHALL NOT EXCEED 14'-0" ABOVE FINISHED GROUND.

| REV | DATE | DESCRIPTION |
|-----|------------|-------------------|
| 1 | 01/17/2022 | BACKGROUND UPDATE |
| 2 | 06/06/2022 | RESUBMITTAL #1 |
| 3 | 08/04/2022 | RESUBMITTAL #2 |

| DATE | SCALE | DRAWN BY | CHECKED BY |
|------------|---------------|----------|------------|
| 03/24/2021 | 1/32" = 1'-0" | SC | |

VICINITY MAP

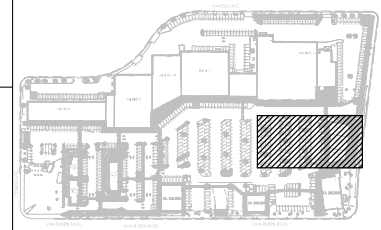

LIGHT FIXTURE SCHEDULE

| MARK | DESCRIPTION | MOUNTING HEIGHT | LAMPS | WATTS | LUMENS | MANUFACTURER | CATALOG NUMBER |
|------|---------------------------------------|-----------------|-------|-------|--------|--------------|-----------------------|
| E | BUILDING MOUNT FIXTURE EM WALL LIGHTS | 10' AFG | LED | 24.0 | 500 | PHILIPS | PLEMBZ |
| S | 5" TALL WALL SCONCE | 11' AFG | LED | 15.5 | 1,039 | COOPER | 303-W2-LEDB2-4000K-T4 |
| P | POLE-MOUNTED LIGHT | 14' AFG | LED | 111.0 | 17,427 | LTHONIA | RSX2 LED-P2-40K-R4-HS |

PARCEL 7 LIGHTING PLAN
 VAN BUREN BLVD
 6008-6390 VAN BUREN BLVD, RIVERSIDE, CA 92503
L4

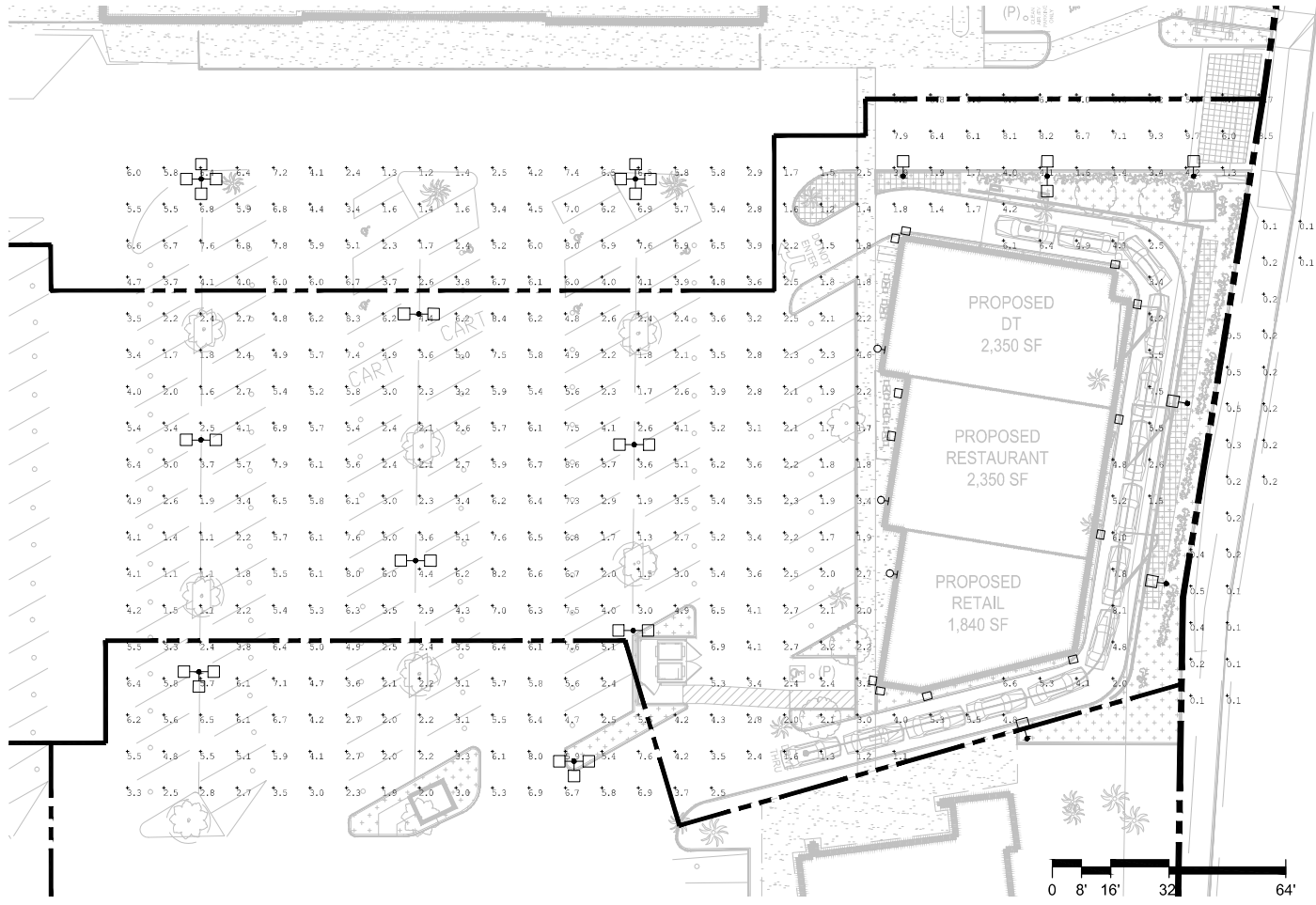

PHOTOMETRIC CALCULATION SUMMARY

| LABEL | CALCULATION TYPE | UNITS | MIN | AVG | MAX | AVG/MIN |
|----------|------------------|-------|-----|------|-----|---------|
| PARCEL 7 | ILLUMINANCE | FC | 1.1 | 4.29 | 9.7 | 3.90 |

GENERAL NOTES

1. DRAWING PROVIDED FOR LAND USE PERMIT APPLICATION ONLY AND IS NOT TO BE USED FOR PERMITTING OR CONSTRUCTION.
2. ALL ON-SITE LIGHTING SHALL PROVIDE MINIMUM INTENSITY OF 1 FOOT-CANDLES AND A MAXIMUM OF 10 FOOT-CANDLES AT GROUND LEVEL THROUGHOUT THE AREAS SERVING THE PUBLIC AND USED FOR PARKING.
3. RATIO OF AVERAGE LIGHT TO MINIMUM LIGHT SHALL BE NOT MORE THAN 4.

| REV | DATE | DESCRIPTION |
|-----|------------|-------------------|
| 1 | 01/17/2022 | BACKGROUND UPDATE |
| 2 | 06/06/2022 | RESUBMITTAL #1 |
| 3 | 08/04/2022 | RESUBMITTAL #2 |

| | | |
|------------|---------------|------------|
| 03/24/2021 | 1/32" = 1'-0" | SC |
| DATE | SCALE | DRAWN BY |
| | | CHECKED BY |

VICINITY MAP

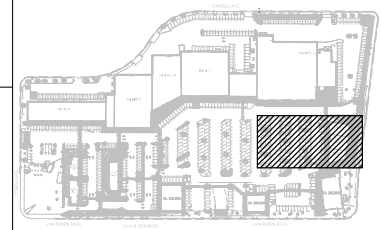

PARCEL 7 PHOTOMETRIC
 VAN BUREN BLVD
 6008-6390 VAN BUREN BLVD, RIVERSIDE, CA 92503

L4P

GENERAL NOTES

- DRAWING PROVIDED FOR LAND USE PERMIT APPLICATION ONLY AND IS NOT TO BE USED FOR PERMITTING OR CONSTRUCTION.
- ALL FIXTURES ARE NEW UNLESS NOTED OTHERWISE.
- LIGHT FIXTURE SPECIFICATION PROVIDED FOR REFERENCE ONLY, BASED ON AVAILABLE PHOTOGRAPHS AND VISUAL INSPECTIONS. EXACT MANUFACTURER AND MODEL OF EXISTING FIXTURES SHALL BE VERIFIED DURING DESIGN.
- LIGHT SOURCES SHALL BE SHIELDED TO MINIMIZE OFF-SITE GLARE, SHALL NOT DIRECT LIGHT UPWARD, AND SHALL BE DIRECTED AWAY FROM ADJACENT PROPERTIES AND PUBLIC RIGHT-OF-WAYS.
- HEIGHT OF POLE-MOUNTED LIGHTING FIXTURES SHALL NOT EXCEED 14'-0" ABOVE FINISHED GROUND.

| REV | DATE | DESCRIPTION |
|-----|------------|-------------------|
| 1 | 01/17/2022 | BACKGROUND UPDATE |
| 2 | 06/06/2022 | RESUBMITTAL #1 |
| 3 | 08/04/2022 | RESUBMITTAL #2 |

| DATE | SCALE | DRAWN BY | CHECKED BY |
|------------|---------------|----------|------------|
| 03/24/2021 | 1/32" = 1'-0" | SC | |

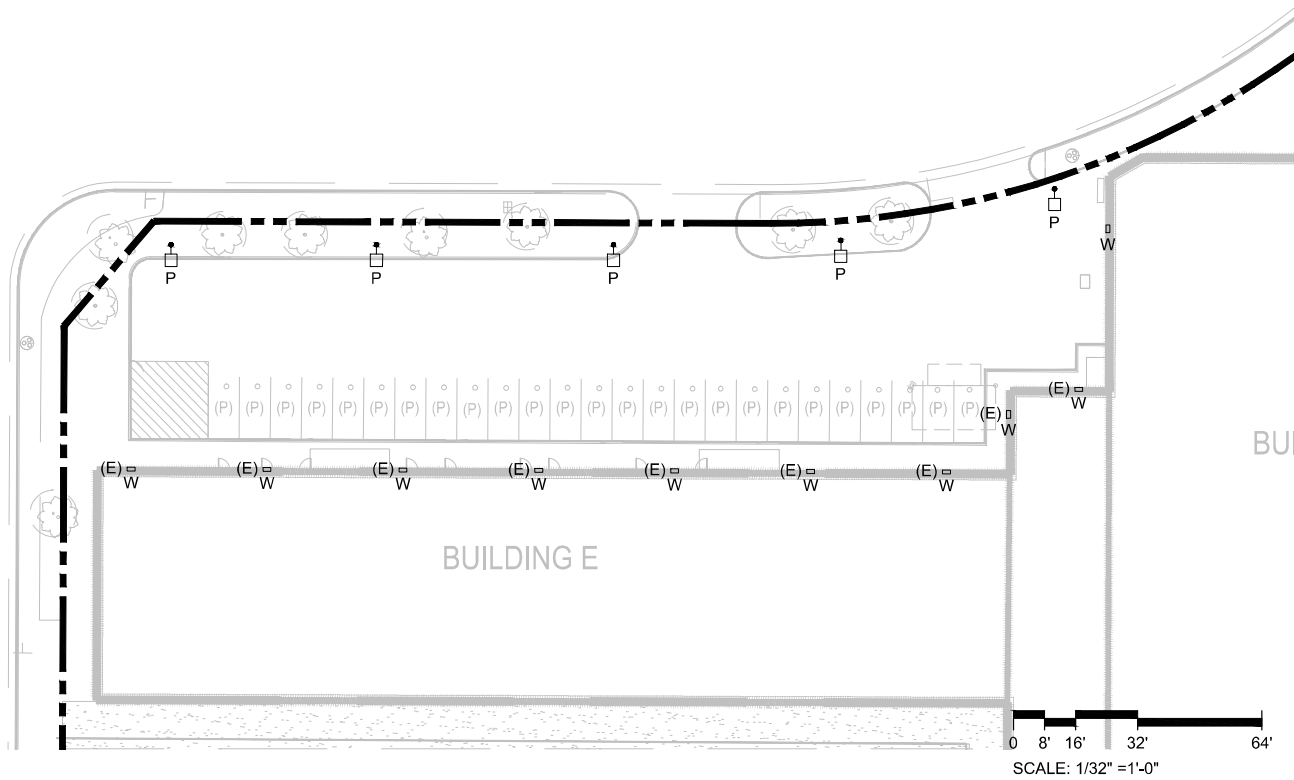

VICINITY MAP

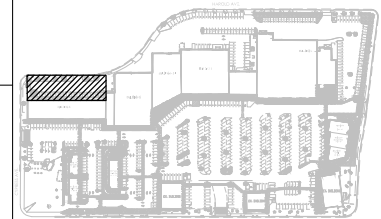

BLDG E LIGHTING
VAN BUREN BLVD
 6008-6390 VAN BUREN BLVD, RIVERSIDE, CA 92503
L5

LIGHT FIXTURE SCHEDULE

| MARK | DESCRIPTION | MOUNTING HEIGHT | LAMPS | WATTS | LUMENS | MANUFACTURER | CATALOG NUMBER |
|------|----------------------------|-----------------|-------|-------|--------|--------------|-----------------------|
| P | POLE-MOUNTED LIGHT | 14' AFG | LED | 111.0 | 17,427 | LITHONIA | RSX2 LED-P2-40K-R4-HS |
| W | BUILDING-MOUNTED WALL PACK | 20' AFG | LED | 51.0 | 7,100 | LITHONIA | TWR2 LED-4-40K |

GENERAL NOTES

1. DRAWING PROVIDED FOR LAND USE PERMIT APPLICATION ONLY AND IS NOT TO BE USED FOR PERMITTING OR CONSTRUCTION.
2. ALL ON-SITE LIGHTING SHALL PROVIDE MINIMUM INTENSITY OF 1 FOOT-CANDLES AND A MAXIMUM OF 10 FOOT-CANDLES AT GROUND LEVEL THROUGHOUT THE AREAS SERVING THE PUBLIC AND USED FOR PARKING.
3. RATIO OF AVERAGE LIGHT TO MINIMUM LIGHT SHALL BE NOT MORE THAN 4.

| REV | DATE | DESCRIPTION |
|-----|------------|-------------------|
| 1 | 01/17/2022 | BACKGROUND UPDATE |
| 2 | 06/06/2022 | RESUBMITTAL #1 |
| 3 | 08/04/2022 | RESUBMITTAL #2 |

| | |
|------------|---------------|
| DATE | 03/24/2021 |
| SCALE | 1/32" = 1'-0" |
| DRAWN BY | SC |
| CHECKED BY | |

| | |
|------------|---------------|
| DATE | 03/24/2021 |
| SCALE | 1/32" = 1'-0" |
| DRAWN BY | SC |
| CHECKED BY | |

BLDG E LIGHTING
 VAN BUREN BLVD
 6008-6390 VAN BUREN BLVD, RIVERSIDE, CA 92503
L5P

VICINITY MAP

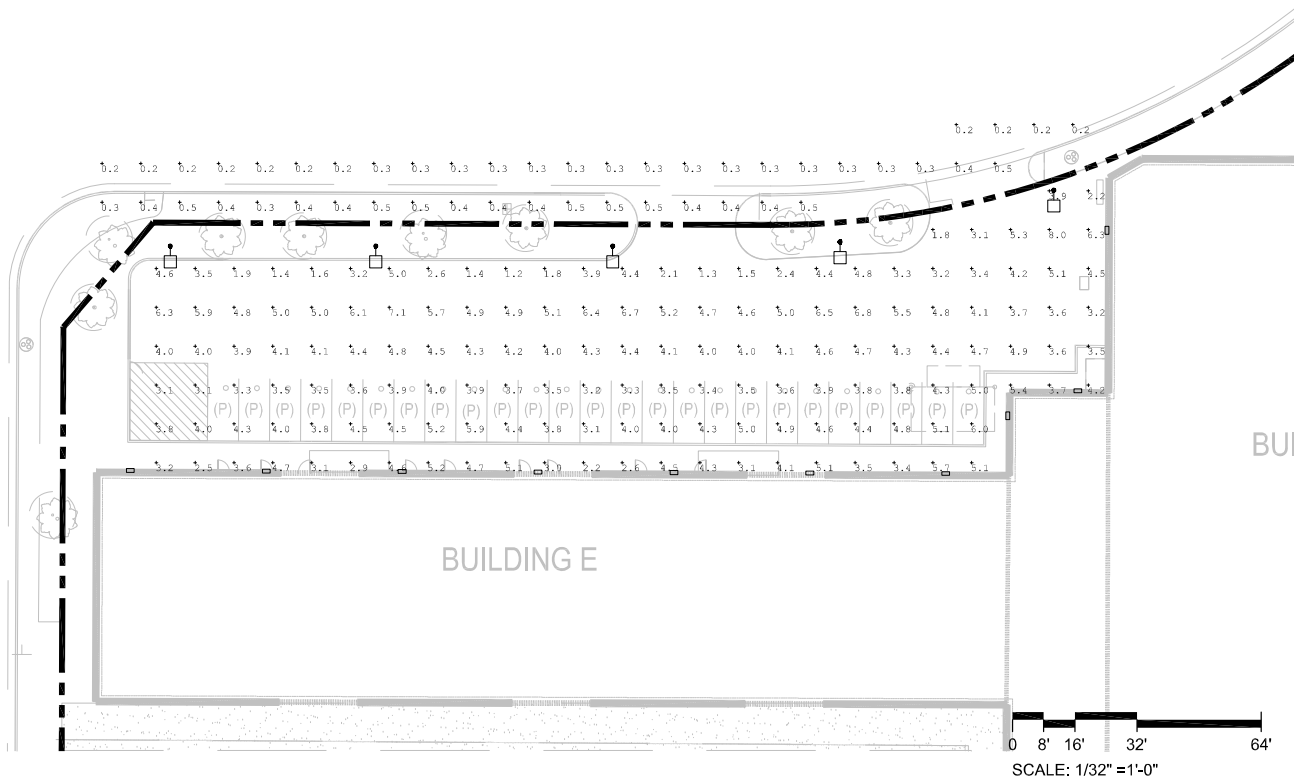
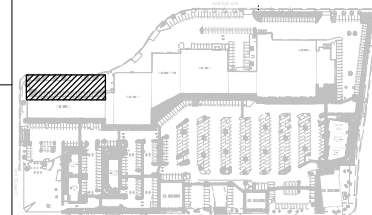

PHOTOMETRIC CALCULATION SUMMARY

| LABEL | CALCULATION TYPE | UNITS | MIN | AVG | MAX | AVG/MIN |
|------------|------------------|-------|-----|------|-----|---------|
| BUILDING E | ILLUMINANCE | FC | 1.2 | 4.13 | 8.0 | 3.44 |

HAROLD AVE.

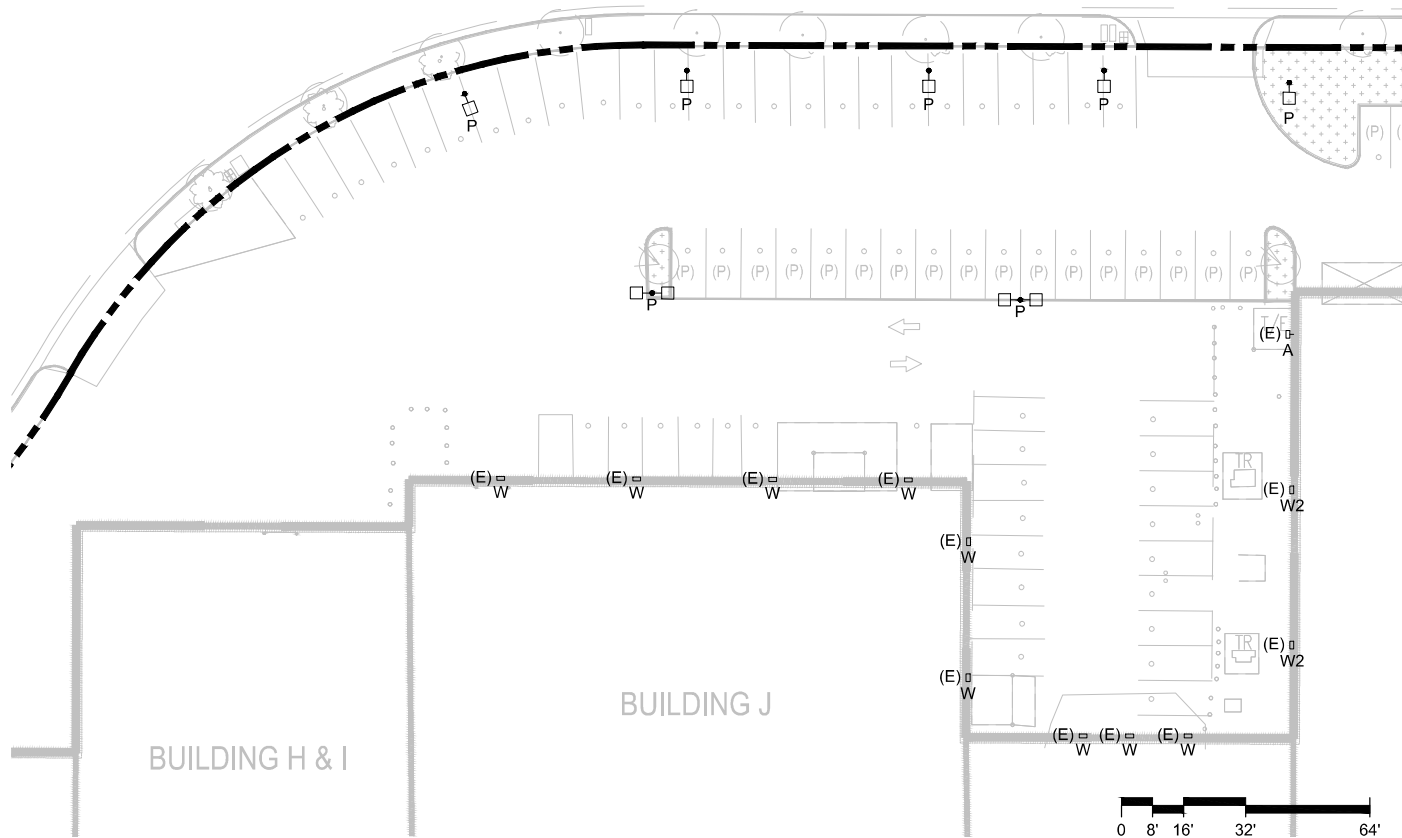

GENERAL NOTES

1. DRAWING PROVIDED FOR LAND USE PERMIT APPLICATION ONLY AND IS NOT TO BE USED FOR PERMITTING OR CONSTRUCTION.
2. ALL FIXTURES ARE NEW UNLESS NOTED OTHERWISE.
3. LIGHT FIXTURE SPECIFICATION PROVIDED FOR REFERENCE ONLY, BASED ON AVAILABLE PHOTOGRAPHS AND VISUAL INSPECTIONS. EXACT MANUFACTURER AND MODEL OF EXISTING FIXTURES SHALL BE VERIFIED DURING DESIGN.
4. LIGHT SOURCES SHALL BE SHIELDED TO MINIMIZE OFF-SITE GLARE, SHALL NOT DIRECT LIGHT UPWARD, AND SHALL BE DIRECTED AWAY FROM ADJACENT PROPERTIES AND PUBLIC RIGHT-OF-WAYS.
5. HEIGHT OF POLE-MOUNTED LIGHTING FIXTURES SHALL NOT EXCEED 14'-0" ABOVE FINISHED GROUND.

| REV | DATE | DESCRIPTION |
|-----|------------|-------------------|
| 1 | 01/17/2022 | BACKGROUND UPDATE |
| 2 | 06/06/2022 | RESUBMITTAL #1 |
| 3 | 08/04/2022 | RESUBMITTAL #2 |

| DATE | SCALE | DRAWN BY | CHECKED BY |
|------------|---------------|----------|------------|
| 03/24/2021 | 1/32" = 1'-0" | SC | |

VICINITY MAP

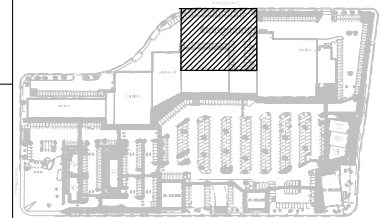

LIGHT FIXTURE SCHEDULE

| MARK | DESCRIPTION | MOUNTING HEIGHT | LAMPS | WATTS | LUMENS | MANUFACTURER | CATALOG NUMBER |
|------|----------------------------|-----------------|-------|-------|--------|--------------|--------------------------|
| A | SIZE 1 FLOOD LUMINAIRE | 20' AFG | LED | 21.0 | 2,295 | LITHONIA | OFL1 LED-P1-40K |
| P | POLE-MOUNTED LIGHT | 14' AFG | LED | 111.0 | 17,427 | LITHONIA | RSX2 LED-P2-40K-R4-HS |
| W | BUILDING-MOUNTED WALL PACK | 20' AFG | LED | 51.0 | 7,100 | LITHONIA | TWR2 LED - 4- 40K |
| W2 | BUILDING-MOUNTED WALL PACK | 20' AFG | LED | 39.0 | 3,377 | LITHONIA | TWH LED-10C-1000-40K-T3M |

BLDG J LIGHTING
 VAN BUREN BLVD
 6008-6390 VAN BUREN BLVD, RIVERSIDE, CA 92503

L6

HAROLD AVE.

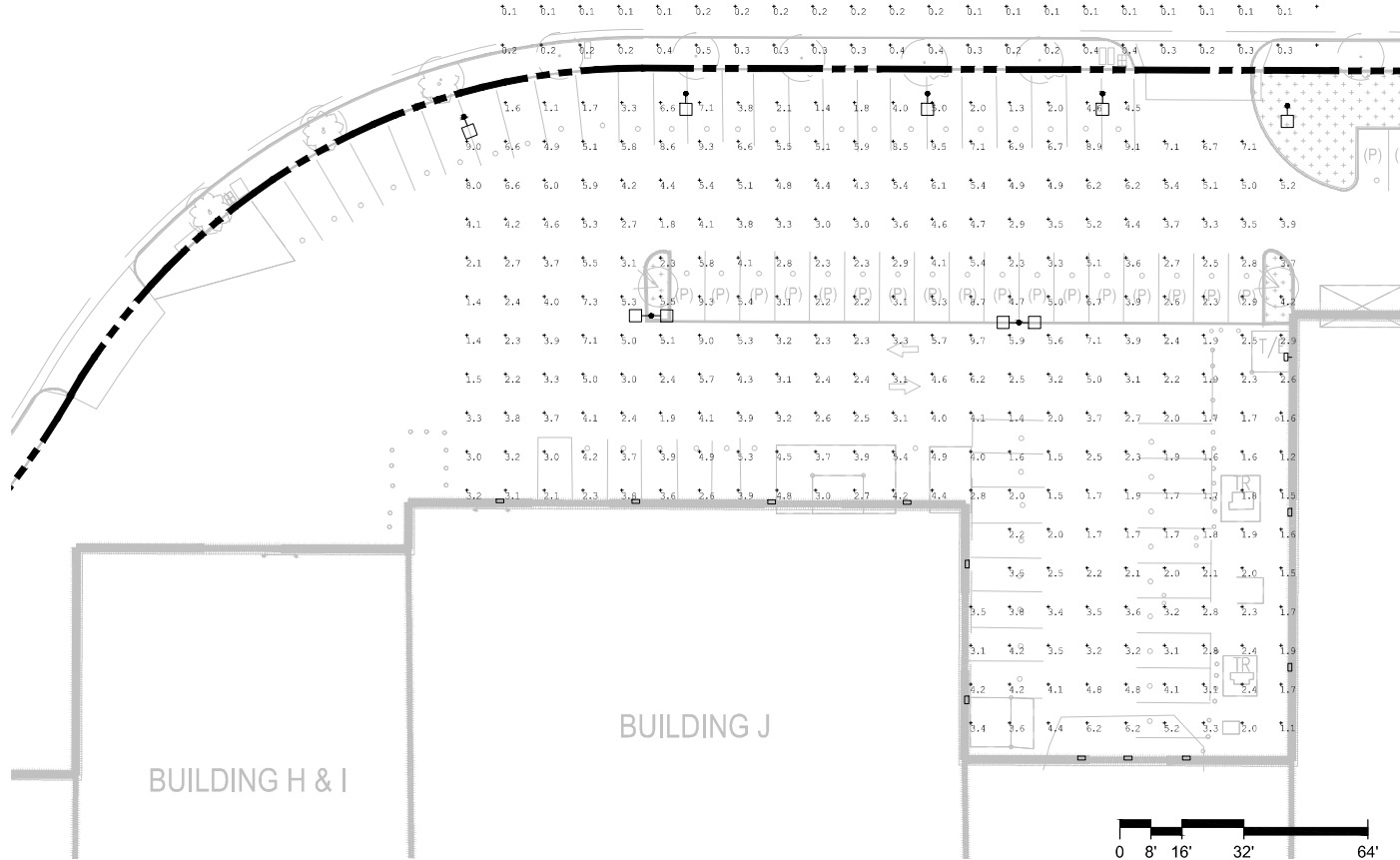

| PHOTOMETRIC CALCULATION SUMMARY | | | | | | |
|---------------------------------|------------------|-------|-----|------|-----|---------|
| LABEL | CALCULATION TYPE | UNITS | MIN | AVG | MAX | AVG/MIN |
| BUILDING J | ILLUMINANCE | FC | 1.1 | 3.82 | 9.7 | 3.47 |

GENERAL NOTES

- DRAWING PROVIDED FOR LAND USE PERMIT APPLICATION ONLY AND IS NOT TO BE USED FOR PERMITTING OR CONSTRUCTION.
- ALL ON-SITE LIGHTING SHALL PROVIDE MINIMUM INTENSITY OF 1 FOOT-CANDLES AND A MAXIMUM OF 10 FOOT-CANDLES AT GROUND LEVEL THROUGHOUT THE AREAS SERVING THE PUBLIC AND USED FOR PARKING.
- RATIO OF AVERAGE LIGHT TO MINIMUM LIGHT SHALL BE NOT MORE THAN 4.

| REV | DATE | DESCRIPTION |
|-----|------------|-------------------|
| 1 | 01/17/2022 | BACKGROUND UPDATE |
| 2 | 06/06/2022 | RESUBMITTAL #1 |
| 3 | 08/04/2022 | RESUBMITTAL #2 |

| | | |
|------------|---------------|------------|
| 03/24/2021 | 1/32" = 1'-0" | SC |
| DATE | SCALE | DRAWN BY |
| | | CHECKED BY |

VICINITY MAP

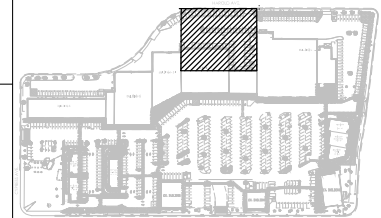

BLDG J PHOTOMETRIC
 VAN BUREN BLVD
 6008-6390 VAN BUREN BLVD, RIVERSIDE, CA 92503

L6P

AVE.

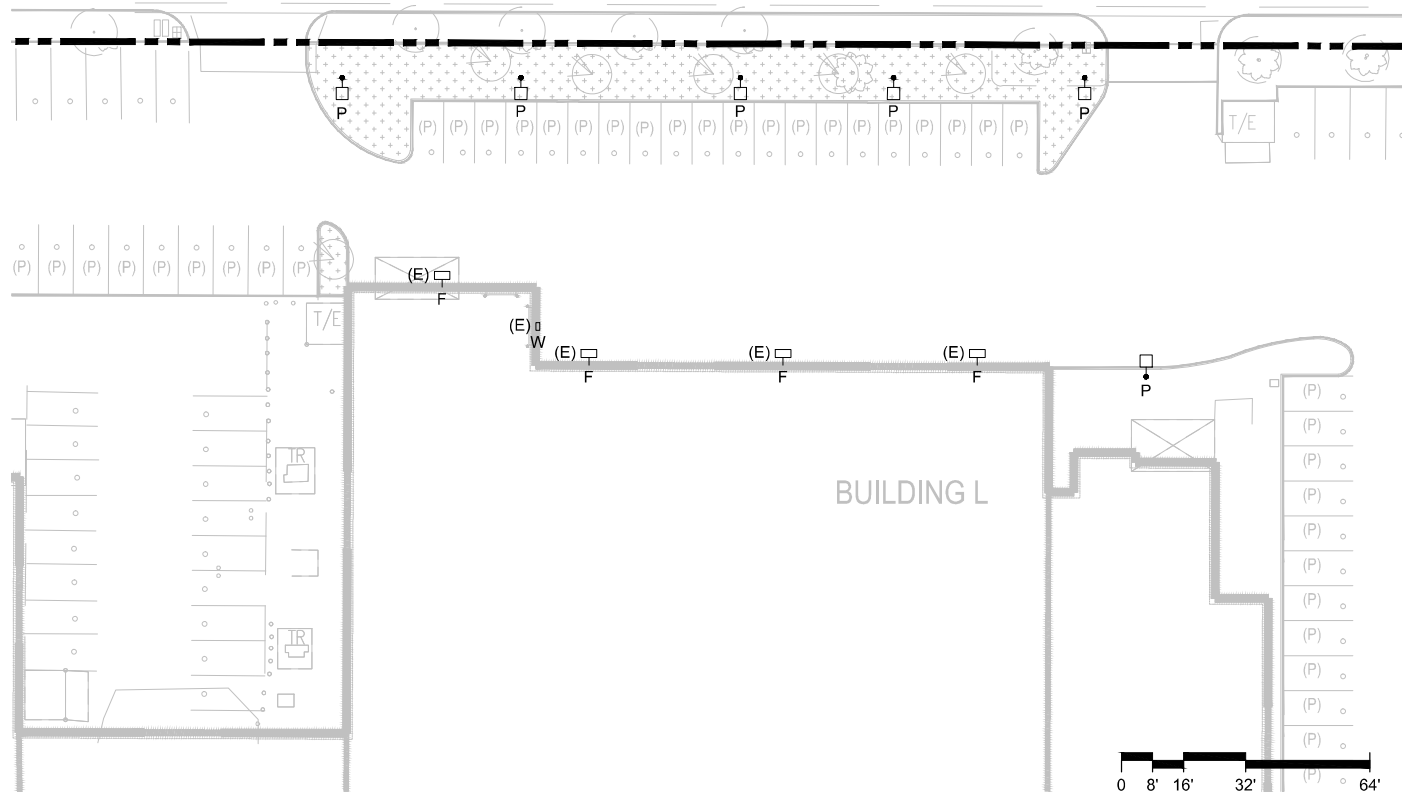

GENERAL NOTES

1. DRAWING PROVIDED FOR LAND USE PERMIT APPLICATION ONLY AND IS NOT TO BE USED FOR PERMITTING OR CONSTRUCTION.
2. ALL FIXTURES ARE NEW UNLESS NOTED OTHERWISE.
3. LIGHT FIXTURE SPECIFICATION PROVIDED FOR REFERENCE ONLY, BASED ON AVAILABLE PHOTOGRAPHS AND VISUAL INSPECTIONS. EXACT MANUFACTURER AND MODEL OF EXISTING FIXTURES SHALL BE VERIFIED DURING DESIGN.
4. LIGHT SOURCES SHALL BE SHIELDED TO MINIMIZE OFF-SITE GLARE, SHALL NOT DIRECT LIGHT UPWARD, AND SHALL BE DIRECTED AWAY FROM ADJACENT PROPERTIES AND PUBLIC RIGHT-OF-WAYS.
5. HEIGHT OF POLE-MOUNTED LIGHTING FIXTURES SHALL NOT EXCEED 14'-0" ABOVE FINISHED GROUND.

| REV | DATE | DESCRIPTION |
|-----|------------|-------------------|
| 1 | 01/17/2022 | BACKGROUND UPDATE |
| 2 | 06/06/2022 | RESUBMITTAL #1 |
| 3 | 08/04/2022 | RESUBMITTAL #2 |

| DATE | SCALE | DRAWN BY | CHECKED BY |
|------------|---------------|----------|------------|
| 03/24/2021 | 1/32" = 1'-0" | SC | |

VICINITY MAP

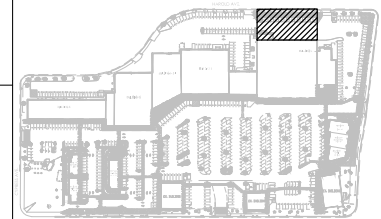

LIGHT FIXTURE SCHEDULE

| MARK | DESCRIPTION | MOUNTING HEIGHT | LAMPS | WATTS | LUMENS | MANUFACTURER | CATALOG NUMBER |
|------|-------------------------------|-----------------|-------|-------|--------|--------------|-----------------------|
| F | BUILDING-MOUNTED FLOOD LIGHTS | 24' AFG | LED | 94.0 | 13,200 | LITHONIA | TFX2-LED-40K |
| P | POLE-MOUNTED LIGHT | 14' AFG | LED | 111.0 | 17,427 | LITHONIA | RSX2 LED-P2-40K-R4-HS |
| W | BUILDING-MOUNTED WALL PACK | 20' AFG | LED | 51.0 | 7,100 | LITHONIA | TWR2 LED - 4- 40K |

BLDG L LIGHTING - N
VAN BUREN BLVD
 6008-6390 VAN BUREN BLVD, RIVERSIDE, CA 92503

L7

AVE.

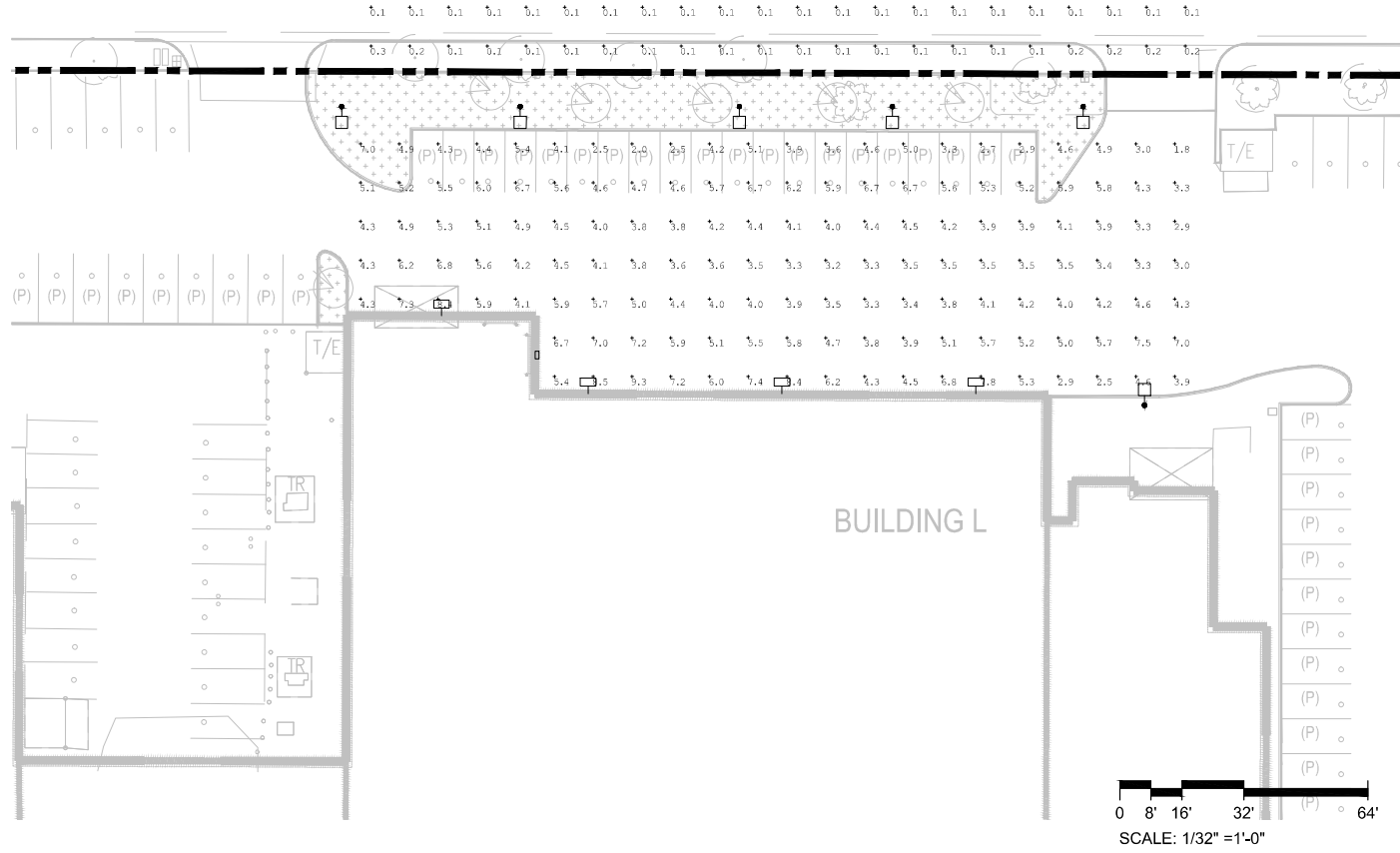

PHOTOMETRIC CALCULATION SUMMARY

| LABEL | CALCULATION TYPE | UNITS | MIN | AVG | MAX | AVG/MIN |
|----------------|------------------|-------|-----|------|-----|---------|
| BUILDING L - N | ILLUMINANCE | FC | 1.8 | 4.78 | 9.3 | 2.66 |

GENERAL NOTES

1. DRAWING PROVIDED FOR LAND USE PERMIT APPLICATION ONLY AND IS NOT TO BE USED FOR PERMITTING OR CONSTRUCTION.
2. ALL ON-SITE LIGHTING SHALL PROVIDE MINIMUM INTENSITY OF 1 FOOT-CANDLES AND A MAXIMUM OF 10 FOOT-CANDLES AT GROUND LEVEL THROUGHOUT THE AREAS SERVING THE PUBLIC AND USED FOR PARKING.
3. RATIO OF AVERAGE LIGHT TO MINIMUM LIGHT SHALL BE NOT MORE THAN 4.

| REV | DATE | DESCRIPTION |
|-----|------------|-------------------|
| 1 | 01/17/2022 | BACKGROUND UPDATE |
| 2 | 06/06/2022 | RESUBMITTAL #1 |
| 3 | 08/04/2022 | RESUBMITTAL #2 |

| | | |
|------------|---------------|------------|
| 03/24/2021 | 1/32" = 1'-0" | SC |
| DATE | SCALE | DRAWN BY |
| | | CHECKED BY |

VICINITY MAP

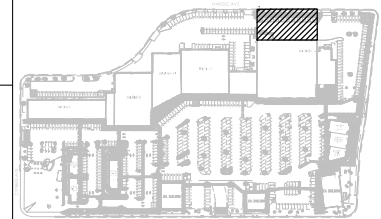

BLDG L PHOTOMETRIC - N
 VAN BUREN BLVD
 6008-6390 VAN BUREN BLVD, RIVERSIDE, CA 92503

L7P

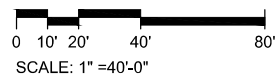
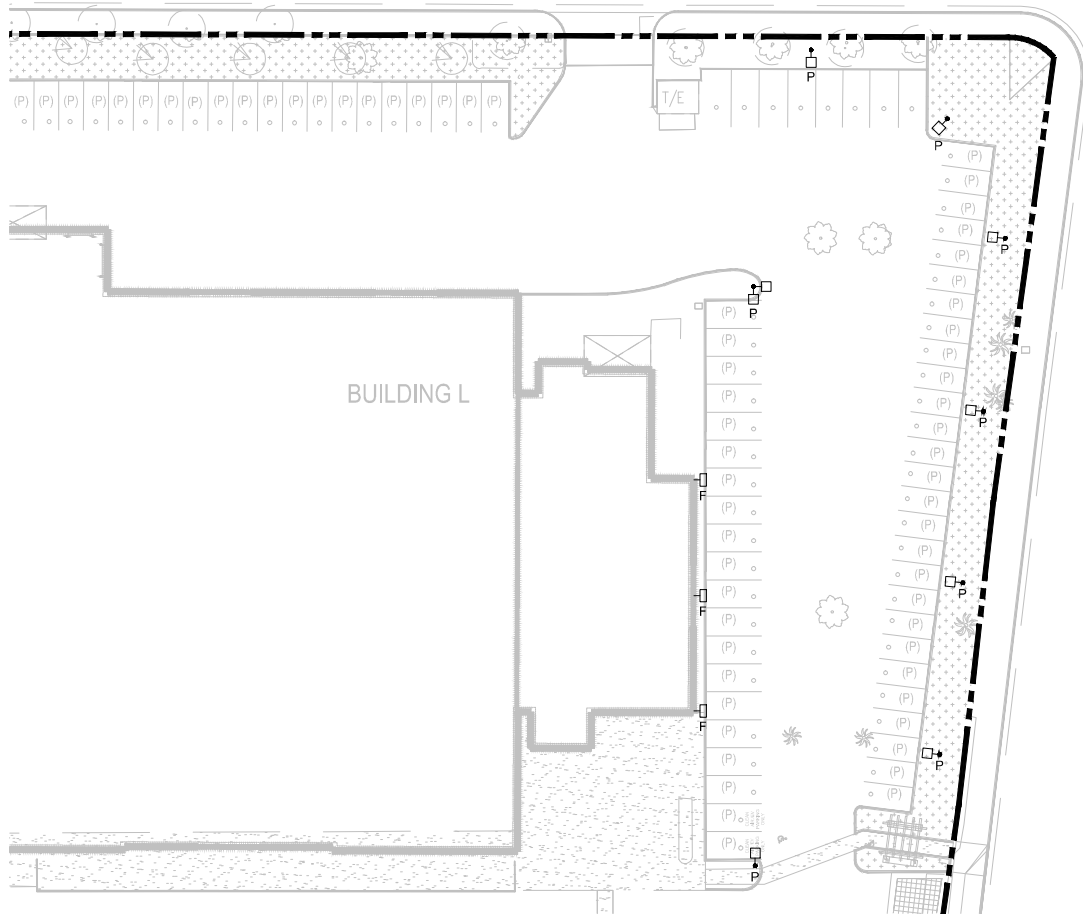

GENERAL NOTES

1. DRAWING PROVIDED FOR LAND USE PERMIT APPLICATION ONLY AND IS NOT TO BE USED FOR PERMITTING OR CONSTRUCTION.
2. ALL FIXTURES ARE NEW UNLESS NOTED OTHERWISE.
3. LIGHT FIXTURE SPECIFICATION PROVIDED FOR REFERENCE ONLY, BASED ON AVAILABLE PHOTOGRAPHS AND VISUAL INSPECTIONS. EXACT MANUFACTURER AND MODEL OF EXISTING FIXTURES SHALL BE VERIFIED DURING DESIGN.
4. LIGHT SOURCES SHALL BE SHIELDED TO MINIMIZE OFF-SITE GLARE, SHALL NOT DIRECT LIGHT UPWARD, AND SHALL BE DIRECTED AWAY FROM ADJACENT PROPERTIES AND PUBLIC RIGHT-OF-WAYS.
5. HEIGHT OF POLE-MOUNTED LIGHTING FIXTURES SHALL NOT EXCEED 14'-0" ABOVE FINISHED GROUND.

| REV | DATE | DESCRIPTION |
|-----|------------|-------------------|
| 1 | 01/17/2022 | BACKGROUND UPDATE |
| 2 | 06/06/2022 | RESUBMITTAL #1 |
| 3 | 08/04/2022 | RESUBMITTAL #2 |

| DATE | SCALE | DRAWN BY | CHECKED BY |
|------------|-------------|----------|------------|
| 03/24/2021 | 1" = 40'-0" | SC | |

VICINITY MAP

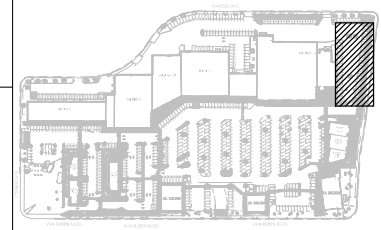

BLDG L LIGHTING - E
VAN BUREN BLVD
 6008-6390 VAN BUREN BLVD, RIVERSIDE, CA 92503

L8

LIGHT FIXTURE SCHEDULE

| MARK | DESCRIPTION | MOUNTING HEIGHT | LAMPS | WATTS | LUMENS | MANUFACTURER | CATALOG NUMBER |
|------|-------------------------------|-----------------|-------|-------|--------|--------------|-----------------------|
| F | BUILDING-MOUNTED FLOOD LIGHTS | 24' AFG | LED | 94.0 | 13,200 | LITHONIA | TFX2-LED-40K |
| P | POLE-MOUNTED LIGHT | 14' AFG | LED | 111.0 | 17,427 | LITHONIA | RSX2 LED-P2-40K-R4-HS |

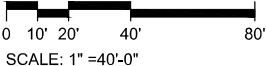
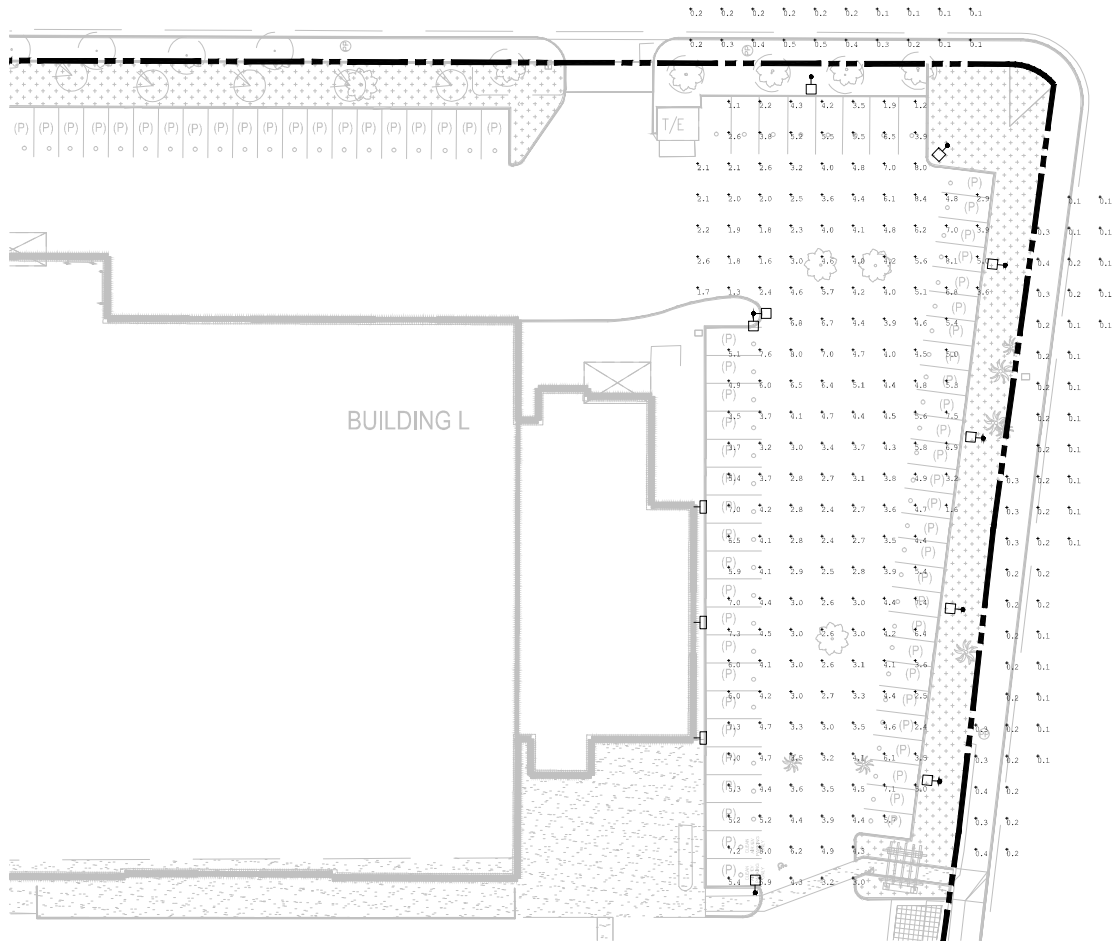

BUILDING L

GENERAL NOTES

1. DRAWING PROVIDED FOR LAND USE PERMIT APPLICATION ONLY AND IS NOT TO BE USED FOR PERMITTING OR CONSTRUCTION.
2. ALL ON-SITE LIGHTING SHALL PROVIDE MINIMUM INTENSITY OF 1 FOOT-CANDLES AND A MAXIMUM OF 10 FOOT-CANDLES AT GROUND LEVEL THROUGHOUT THE AREAS SERVING THE PUBLIC AND USED FOR PARKING.
3. RATIO OF AVERAGE LIGHT TO MINIMUM LIGHT SHALL BE NOT MORE THAN 4.

| REV | DATE | DESCRIPTION |
|-----|------------|-------------------|
| 1 | 01/17/2022 | BACKGROUND UPDATE |
| 2 | 06/06/2022 | RESUBMITTAL #1 |
| 3 | 08/04/2022 | RESUBMITTAL #2 |

| | | |
|------------|---------------|------------|
| 03/24/2021 | 1/32" = 1'-0" | SC |
| DATE | SCALE | DRAWN BY |
| | | CHECKED BY |

VICINITY MAP

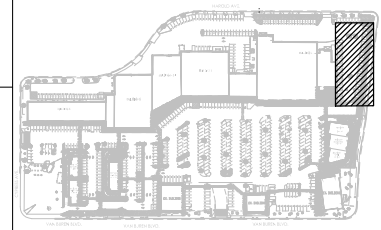

| PHOTOMETRIC CALCULATION SUMMARY | | | | | | |
|---------------------------------|------------------|-------|-----|------|-----|---------|
| LABEL | CALCULATION TYPE | UNITS | MIN | AVG | MAX | AVG/MIN |
| BUILDING L - E | ILLUMINANCE | FC | 1.1 | 4.31 | 8.4 | 3.92 |

BLDG L PHOTOMETRIC - E
 VAN BUREN BLVD
 6008-6390 VAN BUREN BLVD, RIVERSIDE, CA 92503

L8P